

So Small, It's Practically Invisible!

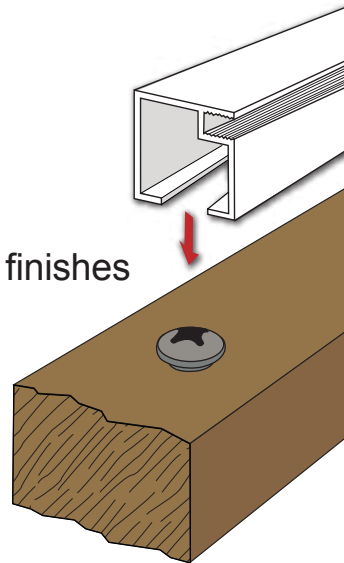

- **NEW... Innovative** 2 part system with **100% Hidden Fasteners**
- **Unlimited Trim Possibilities** perfect for all architectural styles
- **Perfect for higher elevations** with interior or exterior installation
- Ultra low-profile 3/4" x 3/4" channels for great views
- Extruded aluminum channels come in white or bronze powder coated finishes



This ULTRA low profile screening system with completely hidden fasteners is perfect for higher elevations and various second story applications. MINI Track 3/4" x 3/4" channels and screw/clips work well with any housing style and trend, blending in without obstructions to create a clean, seamless look. MINI Track channels come in 5', 6', 8', 10', and 12' lengths.

This easy 2 part aluminum screening system is truly unique.

100% Hidden Fasteners for a clean & professional look!

Low Profile Aluminum Framing System!

EASY Installation Steps:

1. Attach SCREW/CLIPS to Porch Frame

Measure, pre-mark, and pre-drill screw/clip locations on the frame with a level ruler or string to keep the screw/clips aligned at desired location on the frame for proper channel installation. Place screw/clips 2" from the corners and every 8" - 10" evenly spaced apart. Do not overtighten. (Do not exceed a maximum of 40 square feet per screened in area.)



2. Attach MINITrack™ CHANNEL to SCREW/CLIPS

Now MINITrack Channel pieces should be cut to desired lengths. Install the left & right channel vertical's by just "snapping" them over clips directly attached to the frame using a rubber mallet.

Next, install both the top and bottom MINITrack channel horizontal's (See A Diagrams for details)

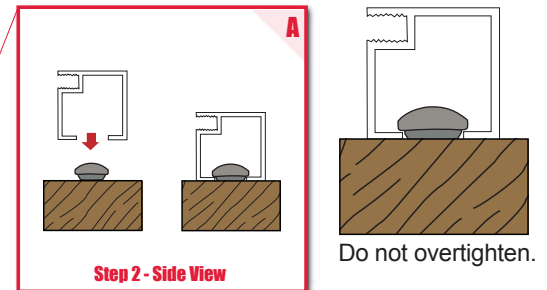

3. Roll SCREEN into MINITrack™ CHANNEL

Now using the spline, Rollerknife™ Screening Tool & screen mesh material, simply roll the spline into the groove of the MINITrack channel to hold in the fabric. Starting with the top, working your way to the sides and bottom of each section to be screened.

4. Simply trim off the excess screen mesh and you're done!

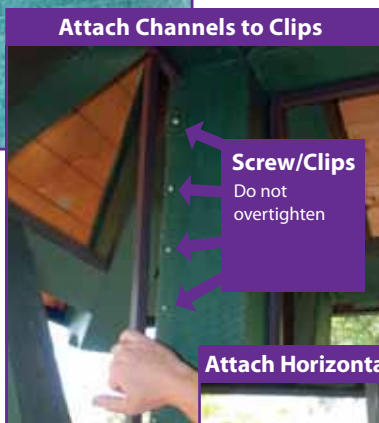
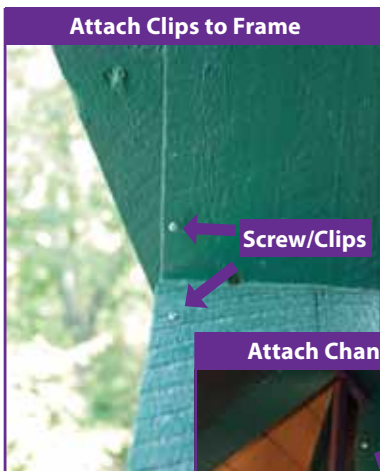
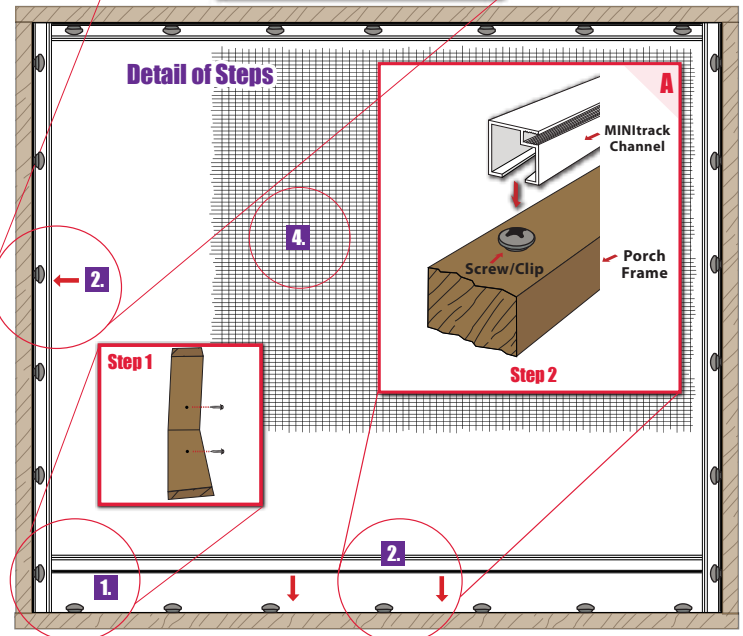

Attach Horizontals 1st, Verticals 2nd



Tools & Other Materials Needed:

- Chop Saw
- Rollerknife™
- Spline
- Screw Driver/Drill
- Rubber Mallet
- Fasteners
- Fiberglass Screen

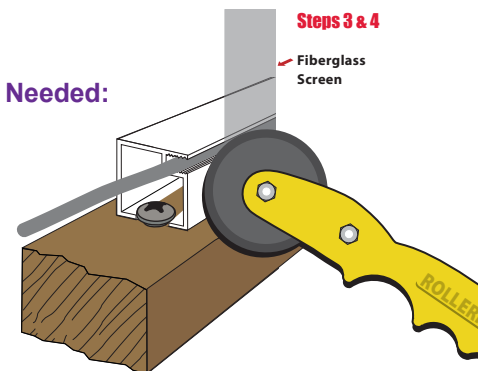

For more information please visit us on our website www.screentight.com. Thank you.

