



StoGuard®
Fully Adhered Air and
Moisture Barrier

for Residential New Construction



StoGuard® is the simplest, most effective way to protect your homes from moisture.

Don't be lulled into believing you have moisture-resistant home construction just because you are using housewrap. Housewrap has limitations that can affect performance. It only takes your crew one off-day to open the door to moisture problems and even bigger problems with call backs.

Housewrap

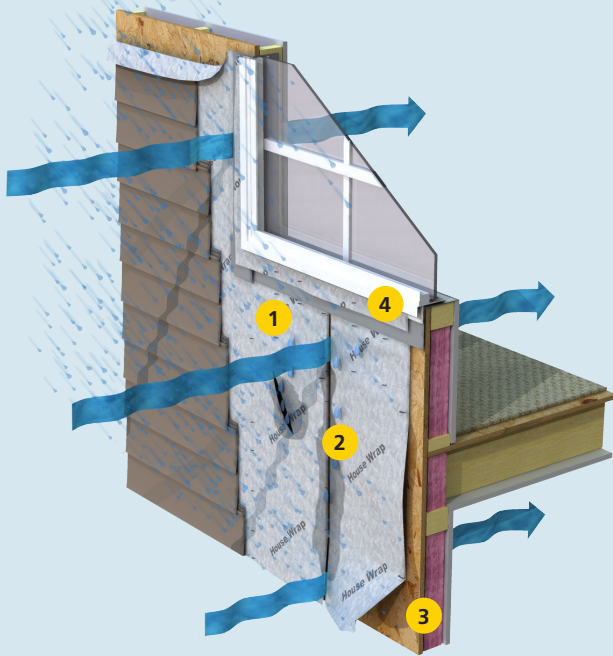

Installation practices that lead to problems:

1. Use of nails or staples creates hundreds of openings.
2. Seams are often not fully or correctly taped.
3. Housewrap that has been torn by high winds must be repaired.
4. Window and door openings require attention to detail and special housewrap products designed for these openings.

StoGuard®

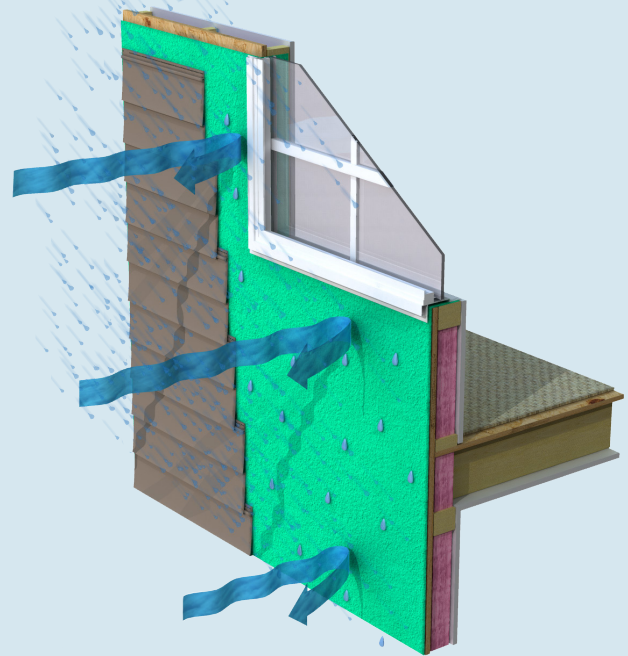

How StoGuard® protects you from moisture problems*:

1. No nail or staple holes.
2. No seams.
3. No tears from high winds.
4. Saves on installation.

*Building codes require additional components, such as building paper or felt, for some claddings like stucco and AMV (Adhered Masonry Veneer). Refer to our Tech Hotlines on Moisture Control (No. 0603-BSc) and Critical Detail Checklist for Wall Assemblies (No. 0403-BSc) for more information.

Build a better performing home with StoGuard®.

Give your homes an added layer of protection from the damaging effects of moisture with StoGuard® fully adhered air and moisture barrier. StoGuard® is the next generation of air and moisture control and ensures that your homes offer the highest level of moisture protection. Not only will you build better homes, you'll be building your reputation as a builder.

StoGuard® fully adhered air and moisture barrier adds a layer of protection that will differentiate you and your homes by ensuring the highest level of moisture protection.

StoGuard® is also easy to install with a roller or spray gun in less time than it takes to properly install housewrap. **Learn more at storesidential.com**

Ready for the simplest, most effective way to protect from moisture call backs?

StoGuard® fully adhered air and moisture barrier is for those builders who are committed to building the highest quality homes with attention to what's inside the wall for maximum moisture protection, energy efficiency and homeowner comfort. If you want to further protect yourself from moisture problems, you may want to consider moving up from housewraps to StoGuard® fully adhered air and moisture barrier.

StoGuard® vs. Wraps

Feature	StoGuard®	Spun Bonded Polyolefin
Tear proof/Durable	Yes	No
Seamless	Yes	No
Structural/Adhesive Attachment	Yes	No
Structural Integrity (ASTM E-1233)	Yes	Not Reported
Waterproof	Yes	No
Water Penetration Testing (AATCC-127)	845 cm	280 cm
Vapor Permeable/Breathable (ASTM E-96)	Yes	Yes
Air Barrier (ASTM E-2178)	Yes	Yes
Energy Savings	Yes	Yes
Mold Growth (ASTM D-3273)	No	No
Low Flame Spread (ASTM E-84)	Yes	Yes

Add another layer of protection to your walls with Sto DrainScreen drainage mat.

Sto DrainScreen is a drainage mat between the cladding and the StoGuard® fully adhered air and moisture barrier. Should water reach the back of the cladding, it can drain from the wall assembly via the drainage mat, which also helps speed the drying. Drainage and drying can be particularly important in hot and humid climates and in areas with wind-driven rain.

- Promotes drainage and drying in stucco, cement board stucco, stone, siding and thin brick veneer wall assemblies
- Water vapor moves freely through the drainage mat layer
- Easy to handle, carry and roll onto the wall

Sto Corp.

3800 Camp Creek Parkway SW
 Building 1400, Suite 120
 Atlanta, GA 30331
 Phone 404-346-3666
 Toll Free 800-221-2397
 Fax 404-346-3119
www.stocorp.com



Sto | Building with conscience.

Water intrusion into wall assemblies has become a growing concern in the construction industry, yet water intrusion can be prevented simply by following sound construction practices as illustrated below. StoGuard® can make it easier to follow these practices.

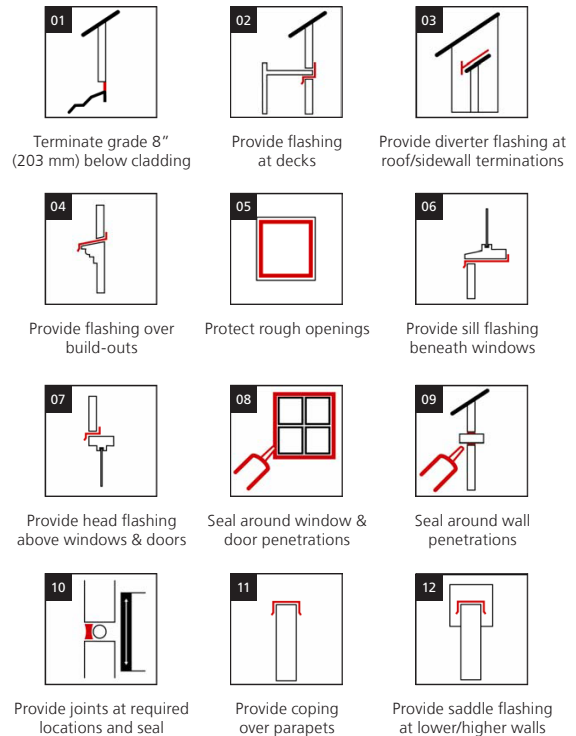

ATTENTION

This product is intended for use by qualified professional contractors, not consumers, as a component of a larger construction assembly as specified by a qualified design professional, general contractor or builder. It should be installed in accordance with those specifications and Sto's instructions. Sto Corp. disclaims all, and assumes no, liability for on-site inspections, for its products applied improperly, or by unqualified persons or entities, or as part of an improperly designed or constructed building, for the nonperformance of adjacent building components or assemblies, or for other construction activities beyond Sto's control. Improper use of this product or use as part of an improperly designed or constructed larger assembly or building may result in serious damage to this product, and to the structure of the building or its components. **STO CORP. DISCLAIMS ALL WARRANTIES EXPRESSED OR IMPLIED EXCEPT FOR EXPLICIT LIMITED WRITTEN WARRANTIES ISSUED TO AND ACCEPTED BY BUILDING OWNERS IN ACCORDANCE WITH STO'S WARRANTY PROGRAMS WHICH ARE SUBJECT TO CHANGE FROM TIME TO TIME.** For the fullest, most current information on proper application, clean-up, mixing and other specifications and warranties, cautions and disclaimers, please refer to the Sto Corp. website, www.stocorp.com.