

POWER INFORMATION

Input Voltage: 100-240 V AC
Input Frequency: 50/60 Hz
Power Supply Output Voltage: 12 V DC
Amperage: 0.800 A
Electric Consumption: 9.6 W
Power Supply Capacity: 2.08 A

SIZING INFORMATION

-specified by daily ice production-
IZ-X-10: ice and water dispensers
IZ-X-20: up to 400 lbs
IZ-X-30: >400 lbs
-high yeast environments may require a larger model

FEATURES

UL Listed
NSF Certified
HACCP Certified
LED Status Indicators

APPLICATIONS

Ice Machines
Ice Bins
Beverage Dispensers

MOUNTING OPTIONS

Top, side, back, internal, and wall-mount configurations available

WARRANTY

Warranty valid in United States and Canada.
Contact factory for warranty in other countries.
One year Parts and Labor on entire unit.

ONLINE RESOURCES



<http://www.biozonescientific.com/products/icezone/>

Product Certifications:



IceZone®-X Sanitation System



IZ-X-20
Shown



IZ-X-20
Shown installed on ice machines

- Prevent slime and mold
- Keep ice machines, ice bins, and beverage dispensers clean
- Reduce equipment cleanings and associated costs
- Reduce bacteria, yeast, and other microorganisms
- Decrease technical malfunctions and equipment downtime
- Completely automated and chemical-free
- Maintenance free – requires a simple annual UV lamp replacement

© BioZone Scientific International, Inc.

7616 Southland Blvd
Suite 114
Orlando, FL 32809
USA



IceZone® X- 10, 20, 30
Product Family: IceZone®
Model: X-10, X-20, X-30
Description: Sanitation System

BIOZONE®

REORDER INFORMATION

Replacement UV Lamps

IZ-X-10: 10-08025

IZ-X-20: 10-08050

IZ-X-30: 10-08100

Replacement Power Supply

White (standard): 16-2000

Black (alternate): 16-2001

SPECIFICATIONS

Length: 12"
 Width: 4.25"
 Height: 2.2"
 Weight: 1.3 lbs

CONTENTS

- IceZone®
- Power Supply
- UV Lamp (pre-installed)
- Lock Key
- Owner's Manual and Installation Guide
- Installation Kit
 - includes NSF compliant:
 - tubing
 - fittings
 - clamps



IZ-X-20 Mounting Options

Shown installed on (L-R) side, internal, and wall-mount

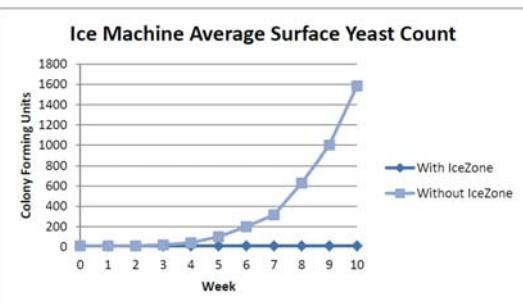
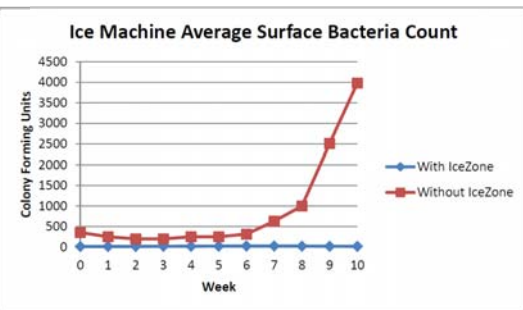
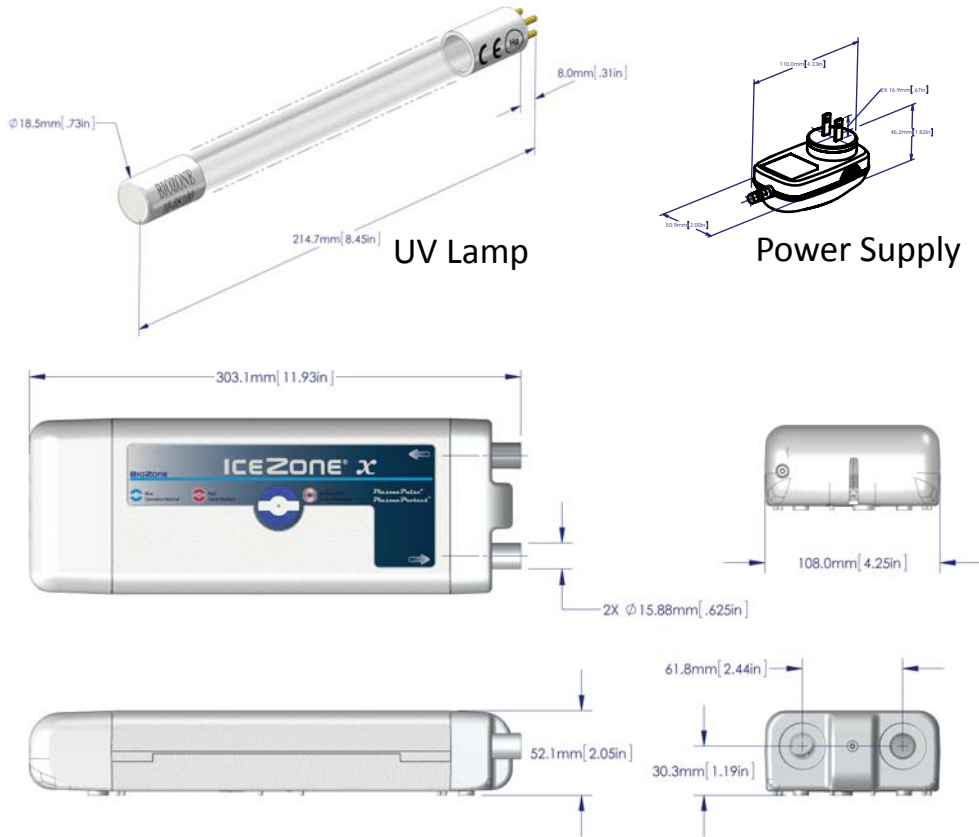

Compatible with all Major Ice Machine Manufacturers including:

- Follett
- Hoshizaki
- Ice-O-Matic
- Manitowoc
- Scotsman

(new and retrofit installations of ice machine and ice bins)

© BioZone Scientific International, Inc.

7616 Southland Blvd
 Suite 114
 Orlando, FL 32809
 USA

