

# Linear Foot Log Package Components

## Pioneer Log Wall

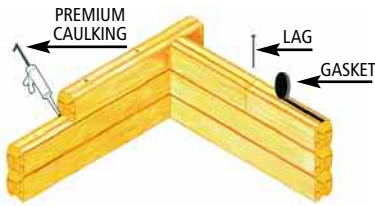

## Pioneer Log & Beams



\$15-\$20 SQ. FT.

## Pioneer Plus

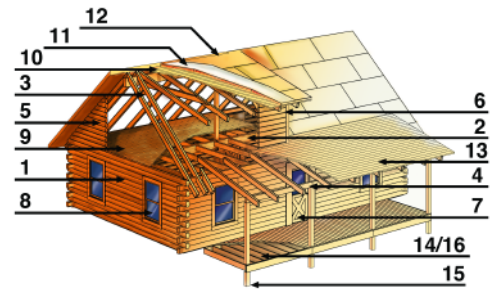

\$35-\$40 SQ. FT.

### PACKAGE INCLUDES:

1. **LOG WALL:** includes linear foot logs (door/window openings and corners are field cut); premium caulk and gasket; timber lags. Logs are grade stamped and pressure treated with ClearTreat sodium borate. Precut corners are available.

#### STANDARD LOG CORNER



6" TRADITIONAL

### PACKAGE INCLUDES:

1. **LOG WALL:** includes linear foot logs (door/window openings and corners are field cut); premium caulk and gasket; timber lags. Logs are grade stamped and pressure treated with ClearTreat sodium borate. Precut corners are available.
2. **LOFT FRAMING:** includes exposed timber frame joists, girder beams, support posts; timber lags.
3. **RAFTER FRAMING:** includes exposed timber frame rafters; solid rafter collar ties; ridge beam; support posts.
4. **PORCH FRAMING:** includes exposed timber frame rafters, top plate and support posts. All items are borate pressure treated.
5. **EXTERIOR GABLE:** includes 2" log siding.
6. **DORMER:** includes dormer rafters, kick rafters and exterior log siding.

### PACKAGE INCLUDES:

1. **LOG WALL:** includes linear foot logs (door/window openings and corners are field cut); premium caulk and gasket; timber lags. Logs are grade stamped and pressure treated with ClearTreat sodium borate. Precut corners are available.
2. **LOFT FRAMING:** includes exposed timber frame joists, girder beams, support posts; timber lags.
3. **RAFTER FRAMING:** includes exposed timber frame rafters; solid rafter collar ties; ridge beam; support posts.
4. **PORCH FRAMING:** includes exposed timber frame rafters, top plate and support posts. All items are borate pressure treated.
5. **EXTERIOR GABLE:** borate pressure treated 2" exterior log siding.
6. **DORMERS:** Shed dormers include exposed timber frame rafters and kick rafters. Doghouse dormers include exposed timber frame ridge beam and rafters. All dormers include borate pressure treated 2" exterior log siding.
7. **EXTERIOR PREHUNG DOORS.**
8. **WINDOWS:** Low-E aluminum clad units with screens. Optional stationary glass (circle top, trapezoid) is available.
9. **LOFT FLOOR DECKING:** 2x6 Tongue & Groove graded #2 & better (graded on V-edge side).
10. **ROOF DECKING:** 2x6 Tongue & Groove graded #2 & better.
11. **ROOF INSULATION:** 4x8x8' sheets of 3" foil faced Isocyanurate rigid foam insulation. R-19
12. **ROOF SHEATHING.**
13. **PORCH ROOF DECKING:** 2x6 Tongue & Groove graded #2 & better.
14. **PORCH FLOOR:** includes pressure treated joists, sill and 5/4 flooring.
15. **FOUNDATION POSTS:** includes 6x6 pressure treated posts for porch and/or deck per plan.
16. **DECK:** includes pressure treated joists, sill and 5/4 flooring.

### All Pioneer Packages include:

- borate pressure treated grade stamped logs
- (3) sets of blueprints

Other log home building components are available as options and may be priced by your Appalachian Log Structures representative.

Such as:

- other log profiles
- precut corners
- hardware items, such as joist hangers, thru-bolts, adjusters, drill guide & bits
- base log with wiring channel
- exterior stain/sealer
- 1" trim lumber for baseboard, doors/windows & fascia
- perimeter log siding
- door/window jambs
- additional roof insulation

**APPALACHIAN**  
LOG STRUCTURES  
**1.866.LOG.HOME**  
[www.applog.com](http://www.applog.com)

# Precut Log Package Components

## Premier Log Wall

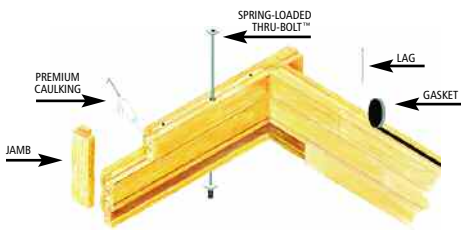

### PACKAGE INCLUDES:

- LOG WALL:** includes logs that are precut to length with shiplap butt joints; precut corners; precut door/window openings with 4" shiplap jambs; precut sills and headers; 2" exterior log siding to cover perimeter band; 1" lumber for base log wiring channel; premium caulk and gasket; timber lags; spring loaded Thru bolts; drill guide and bits. Logs are grade stamped and pressure treated with ClearTreat sodium borate. Also includes exterior stain and 5/25 year written warranty.

### STANDARD LOG CORNER



6" TRADITIONAL

### OPTIONAL LOG CORNERS



AUTHENTIC



SADDLELOK

### All Premier Packages include:

- 5/25 year warranty
- borate pressure treated grade-stamped logs
- (3) set of blueprints
- construction manual
- construction video
- one day on-site technical assistance

## Premier Log & Beams

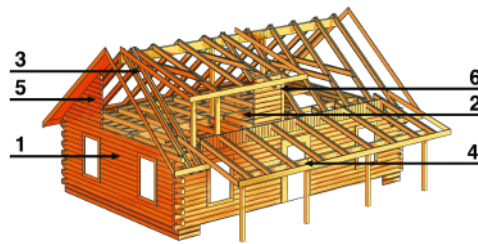

\$20-\$25 SQ. FT.

### PACKAGE INCLUDES:

- LOG WALL:** includes logs that are precut to length with shiplap butt joints; precut corners; precut door/window openings with 4" shiplap jambs; precut sills and headers; 2" exterior log siding to cover perimeter band; 1" lumber for base log wiring channel; premium caulk and gasket; timber lags; spring loaded Thru bolts; drill guide and bits. Logs are grade stamped and pressure treated with ClearTreat sodium borate. Also includes exterior stain and 5/25 year written warranty.
- LOFT FRAMING:** includes precut exposed timber frame joists and girder beams; support posts with adjusters; joist and girder hangers; girder connector plates per plan.
- RAFTER FRAMING:** includes precut exposed timber frame rafters; solid rafter collar ties (4x8) with bolts; ridge beam and ridge connector plates per plan; support posts with adjusters; timber lags; frieze boards; fascia trim.
- PORCH FRAMING:** includes precut exposed timber frame rafters, top plate and support posts; 1" lumber for board & batten trim. All of these items are borate pressure treated and include exterior stain.
- EXTERIOR GABLE:** includes borate pressure treated 2" exterior log siding and exterior stain.
- DORMERS:** shed dormers include precut exposed timber frame rafters and kick rafters; precut sills, plates and posts; kick rafters. Doghouse dormers include precut exposed timber frame ridge beam and rafters; precut sills, plates and posts. All dormers include borate pressure treated 2" exterior log siding and exterior stain.

## PremierPlus

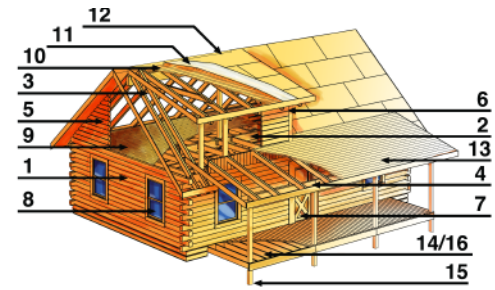

\$45-\$50 SQ. FT.

### PACKAGE INCLUDES:

- LOG WALL:** includes logs that are precut to length with shiplap butt joints; precut corners; precut door/window openings with 4" shiplap jambs; precut sills and headers; 2" exterior log siding to cover perimeter band; 1" lumber for base log wiring channel; premium caulk and gasket; timber lags; spring loaded Thru bolts; drill guide and bits. Logs are grade stamped and pressure treated with ClearTreat sodium borate. Also includes exterior stain and 5/25 year written warranty.
- LOFT FRAMING:** includes precut exposed timber frame joists and girder beams; support posts with adjusters; joist and girder hangers; girder connector plates per plan.
- RAFTER FRAMING:** includes precut exposed timber frame rafters; solid rafter collar ties (4x8) with bolts; ridge beam and ridge connector plates per plan; support posts with adjusters; timber lags; frieze boards; fascia trim.
- PORCH FRAMING:** includes precut exposed timber frame rafters, top plate and support posts; 1" lumber for board & batten trim. All of these items are borate pressure treated and include exterior stain.
- EXTERIOR GABLE:** includes borate pressure treated 2" exterior log siding and exterior stain.
- DORMERS:** shed dormers include precut exposed timber frame rafters and kick rafters; precut sills, plates and posts; kick rafters. Doghouse dormers include precut exposed timber frame ridge beam and rafters; precut sills, plates and posts. All dormers include borate pressure treated 2" exterior log siding and exterior stain.
- EXTERIOR PREHUNG DOORS:** includes interior and exterior 1" trim lumber.
- WINDOWS:** premium Low-E aluminum clad units with screens. Includes interior and exterior 1" trim lumber. Optional stationary glass (circle top, trapezoid) is available.
- LOFT FLOOR DECKING:** 2x6 Tongue & Groove graded #2 & better (graded on V-edge side).
- ROOF DECKING:** 2x6 Tongue & Groove graded #2 & better.
- ROOF INSULATION:** 4x8x8' sheets of 3" foil faced Isocyanurate rigid foam insulation. R-19
- ROOF SHEATHING.**
- PORCH ROOF DECKING:** 2x6 Tongue & Groove graded #2 & better.
- PORCH FLOOR:** includes pressure treated joists, sill and 5/4 flooring.
- FOUNDATION POSTS:** includes 6x6 pressure treated posts for porch and/or deck per plan.
- DECK:** includes pressure treated joists, sill and 5/4 flooring.

**APPALACHIAN**  
LOG STRUCTURES  
**1.866.LOG.HOME**  
[www.applog.com](http://www.applog.com)