



ROOF MASTERS INC

"Serving Southern California for over 50 Years!"

1525 Railroad Ave.
Los Angeles, CA 90021
800.820.5656
actforms@sbcglobal.net
CA License No. 999999
(C39) Roofing Contractor

Mr. & Mrs. Thomas J. Homeowner
47622 Wisteria Lane
Los Angeles, CA 90021

Dear Mr. & Mrs. Homeowner,

Thank you for the opportunity to bid on the re-roofing of your home.

Please find enclosed our estimate for the complete re-roofing of your home and the installation of new copper gutters and downspouts. Assuming that you do not change your mind on the premium roofing and guttering materials chosen, this bid represents your final cost. I have also included some information about our company and past clients as well as copies of our limited labor warranty and Tamko's Material warranty on the roofing material you choose.

This is our 52nd year protecting and beautifying homes throughout Southern California using the finest roofing materials installed with the latest manufacturers recommended procedures by our experienced, highly trained and certified technicians. This bid will be good for 30 days only due to the volatile nature of the pricing for petroleum based roofing materials.

We hope to hear from you soon.

Regards,

Jim Phillips, Contractor
Roof Masters Inc.
www.RoofMasters.bs



"Serving Southern California for over 50 Years!"

1525 Railroad Ave.
Los Angeles, CA 90021
800.820.5656
actforms@sbcglobal.net
CA License No. 999999
(C39) Roofing Contractor

Owner: Thomas J. Homeowner	Job Address: 47622 Wisteria Lane
Phone Numbers: 999.999.9999	Inspected by: Joe Salesman

We inspected the areas you requested on 8-01-09. We discovered some problems that we wanted you to look at. Below are photographs taken during that inspection.



The main leak you are experiencing is a result of loose, missing and broken shingles in this area shown to the left. At this point in the life of your roof, 26 years old, we recommend a complete re-roof. You will not have to worry about this problem happening again for the life of the new roof. If you choose Lamarite composite slate shingles, the expected roof life will be 50 years!

The second leak you have is a result of improper flashing done around your chimney as it penetrates the roof. As part of your re-roof, WE will insure that **ALL** flashing is replaced and correctly installed everywhere on your roof. You will not have to worry about this problem happening again for the life of the new roof. The picture to the right shows the type of copper flashing we will install around your chimney.





"Serving Southern California for over 50 Years!"

1525 Railroad Ave.
Los Angeles, CA 90021
800.820.5656
actforms@sbcglobal.net
CA License No. 999999
(C39) Roofing Contractor

Owner's Name: Mr. & Mrs. Thomas J. Homeowner		Owner's Address: 47622 Wisteria Lane	
Owner's City: Los Angeles	Owner's Zip Code: 90021	Owner's Phone: 999.999.9999	Owner's Work Phone: 800.820.5656
Project Name & Address: single family residence at the above address			Email: jim@calform.com

a. Scope of Work: Roof Masters, Inc. hereby submits the following specifications and estimates:

1. Roof Type: gable hip flat other _____
2. Roof Pitch & Height 4 /12 28 ft. high
3. Roof Area: 2464 s.f.
4. Existing Roof Covering: comp.shgl. shake b.u.r. other
cedar shake with 1x6 space sheathing
5. Tear off existing roof
6. Go over existing roof
7. New Roof Covering (specify): open valley closed valley
Install Tamko Lamarite 12" uniform exposure shingles color slate green
8. New Ridge (specify): Lamarite Ridge
9. Install New Sheathing 1/2" plywood 1/2" OSB
 other _____ quantity 2485 s.f.
10. Install New Gutters style O.G. 6 INCH copper
11. Install New Metal Roof Edging color Brown
12. Install New Pipe Flashings
13. Install New Valley Flashings
14. Install Other Flashing (specify):
Install copper counterflashing around chimney All Flashing to be copper.
15. Seal and Paint Pipes
16. Clean up and dispose of debris

Purchase permit from City of Los Angeles Building Department. Remove old cedar jumbo shakes and ridge. Remove all flashing and gutters. Haul away and properly dispose of all removed roofing materials and debris. Provide and Install 1/2" plywood sheathing over existing 1"x6" space sheathing. Provide and Install seismic straps across ridge as required by code. Provide and Install new copper flashing for chimney, pipes, and around new roof ventilator. Provide and Install new roof ventilator Powervent Model 77A in position as shown on Job Planning Sheet. **Note: Electrical connection to new Powervent to be done by others.** Provide and install new 2"x8" rough sawn cedar fascia to replace dry-rotted fascia boards on west and east side of home (approx. 40 l/f) as shown in red on Job Planning Sheet. Prime and paint fascia boards with paint and primer supplied by Owner prior to installation.

Provide and install 2464 sf of Lamarite 6" & 12" offset exposure Composite Slate Shingles in Slate Green Color. Provide and install matching Lamarite ridge (approx 56 lf). Provide and install metal roof edge prefinished brown, over gutter sides and provide and install matching Lamarite gable edge on gable sides. Seal all pipes and paint with matching slate green paint. Provide and install new copper guttering along west and east sides of home. Provide and install new copper leaders at south and north ends of the sides of the home that are guttered (4 leaders total). Tie leaders into existing drainage system on home.

Clean up and haul away all debris. Run magnetic broom over adjacent surfaces to pick up any loose nails. Do an owners walk through after completion and correct any items pointed out by owner.

b. Not Included: *This proposal does not include:* Any work on the existing attached covered deck at the rear of the house.

c. Roofing Material Manufacturers Warranty: 50 Year Limited Warranty on Lamarite Shingles through Tamko (see attached)

d. WE PROPOSE to furnish material, equipment and labor in accordance with the above specifications for the sum of:

22,856.75 dollars

NOTE: This proposal may be withdrawn if not accepted within 30 days from 8-10-2009 date.

Respectfully submitted by: _____
Company Representative

e. WE ACCEPT the prices, specifications, and terms as stated in this bid proposal are approved. We authorize you to draw up all necessary contract documents so work can be commenced.

approved and accepted (owner or owner's authorized agent) date

approved and accepted (second owner- if any) date



ROOF MASTERS INC

JOB PLANNING SHEET NO. 489

"Serving Southern California for over 50 Years!"

1525 Railroad Ave.
Los Angeles, CA 90021
800.820.5656
actforms@sbcglobal.net
CA License No. 999999
(C39) Roofing Contractor

Owner's Name: Mr. & Mrs. Thomas J. Homeowner		Owner's Address: 47622 Wisteria Lane	
Owner's City: Los Angeles	Owner's Zip Code: 90021	Owner's Phone: 999.999.9999	Owner's Work Phone: 800.820.5656
Project Name & Address: single family residence at the above address			Email: jim@calform.com

Job #1 Description:	Tear-off old wood shingles and gutting and install 1/2" plywood sheathing over 1 x 6 space sheathing on entire roof (2464 sf)
Job #2 Description:	Replace flashing around chimney to stop leakage around this area.
Job #3 Description:	Replace damaged fascia boards (approximately 14) where buckled on east side of house as shown (red).
Job #4 Description:	Replace damaged fascia boards (approximately 26") where buckled on west side of house as shown (red).
Job #5 Description:	Purchase and Install Powervent Model 74A Attic Ventilation System
Job #6 Description:	Re-Roof using Lamarite composite shingles and ridge, uniform exposure 12" shingles in slate green as shown below. Install copper gutting, leaders, and flashing on entire roof.

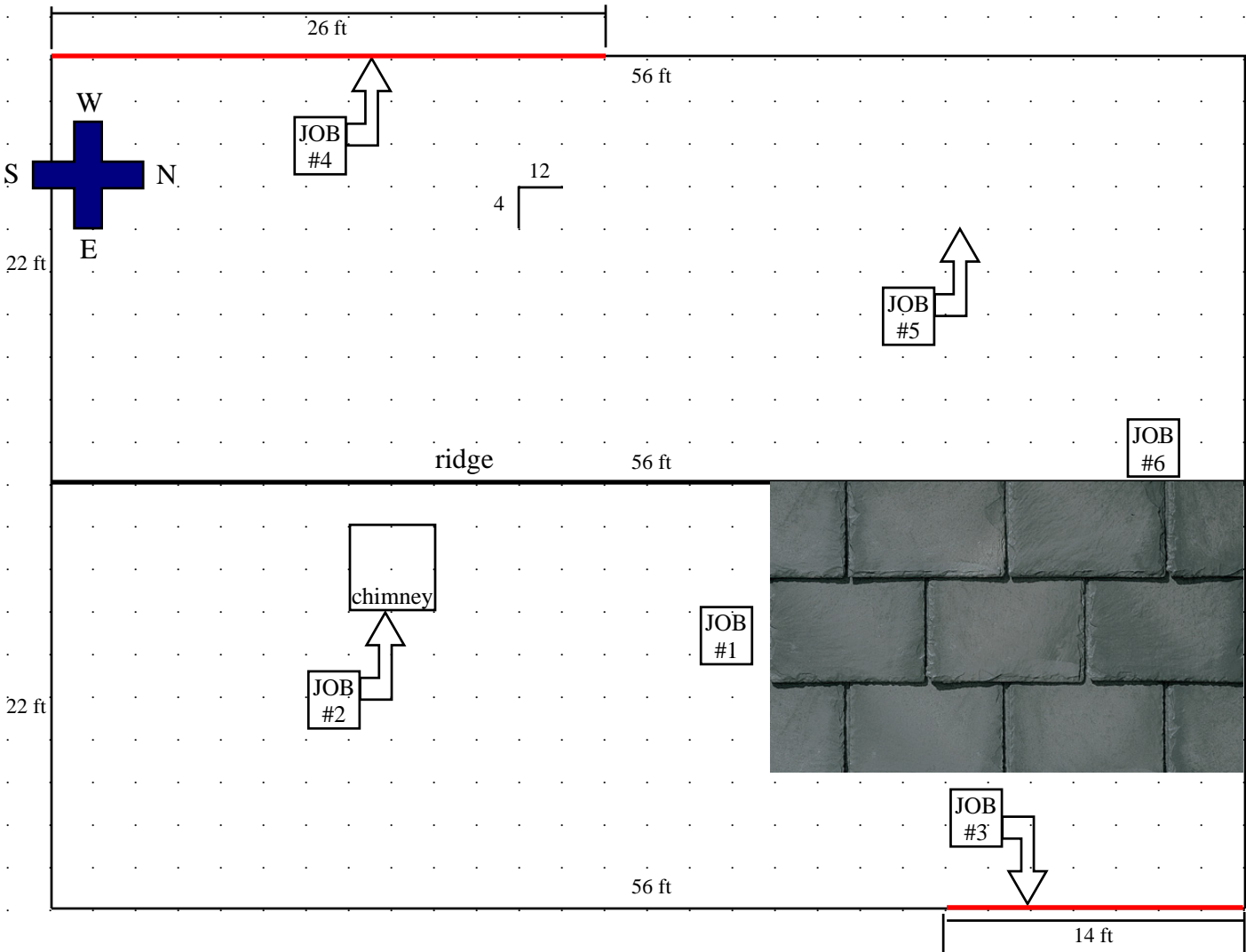



"Serving Southern California for over 50 Years!"

1525 Railroad Ave.
Los Angeles, CA 90021
800.820.5656
actforms@sbcglobal.net
CA License No. 999999
(C39) Roofing Contractor

Our Privacy Policy

The customers listed below have agreed to participate in our list of references. Please respect their privacy. We ask that you always contact them by telephone before contacting them in person. As common courtesy, we ask that you do not telephone them before 8:00 am or after 9:00 pm. Please treat these nice people the way you will want to be treated after you become our customer!

James T. Homeowner
52233 Cozy Lane
Anytown, CA 9xxxx

(707) 747-4735

Complete re-roof with Grand Shingle #400 fifty year shingles completed 4-08.

Please do not call before 2:30 pm, Mr. Homeowner works nights and sleeps in the morning. Thank You!

Delores P. Homeowner
655224 Hammer Lane
Sometown, CA 9xxxx

(510) 925-xxxx

Complete re-roof using Lamarite Slate Composite shingles in Natural Sand COOL COLOR

William Businessowner
617 Enterprise Plaza
Big City, CA 9xxxx

(213) 666-xxxx

Complete re-roof using Tamko Stonecrest Steel Slate Shingles in sequoia redwood color.

Mr. Denny Crain
1475 Leaf Place
Socal, CA 9xxxx

(805) 222-xxxx

Complete re-roof using Heritage Vintage laminated asphalt shingles in fossil grey color.

James T. Homeowner
52233 Cozy Lane
Anytown, CA 9xxxx

(707) 747-4735

Complete re-roof with Grand Shingle #400 fifty year shingles completed 4-08.

Please do not call before 2:30 pm, Mr. Homeowner works nights and sleeps in the morning. Thank You!

Delores P. Homeowner
655224 Hammer Lane
Sometown, CA 9xxxx

(510) 925-xxxx

Complete re-roof using Lamarite Slate Composite shingles in Natural Sand COOL COLOR

William Businessowner
617 Enterprise Plaza
Big City, CA 9xxxx

(213) 666-xxxx

Complete re-roof using Tamko Stonecrest Steel Slate Shingles in sequoia redwood color.

Mr. Denny Crain
1475 Leaf Place
Socal, CA 9xxxx

(805) 222-xxxx

Complete re-roof using Heritage Vintage laminated asphalt shingles in fossil grey color.



ROOF MASTERS INC

"Serving Southern California for over 50 Years!"

ROOFING LIMITED WORKMANSHIP WARRANTY

CA License No. 999999 (C39) Roofing Contractor

Owner's Name: Mr. & Mrs. Thomas J. Homeowner

Job Completion Date: 4.30.09

Job Address: 47622 Wisteria Lane, Los Angeles, CA 90021

This warranty applies to: Complete tear-off, install full sheathing and re-roof

Material Used: Tamko Lamarite shingle (color Natural Sand) with 50 Year Limited Warranty from Tamko

In addition to any separate warranty that may be extended by the roofing materials manufacturer used on your job, **Roof Masters Inc.**, hereinafter referred to as "Contractor", warrants the work against roof leaks caused by defective workmanship for a period of 5 years from the above stated job completion date. If a defect covered by this warranty occurs resulting in a roof leak, Contractor will repair the roof leak at no charge to the Owner. To obtain service under this limited warranty, Owner must give written notice to Contractor identifying the original work performed, the date of job completion, and the nature of the problem. Such written notice shall be given to Contractor at **1525 Railroad Avenue, Los Angeles, CA 90021**.

This limited warranty covers roof leaks caused by defective workmanship and does not include roof leaks caused by: (1) Obstruction or impairment of proper drainage of the roof by debris buildup, ice & snow buildup, structural "low spots", etc., that results in leaks caused by standing water or "ponding"; (2)

Excessive walking on the roof and/or walking on the roof by persons who do so improperly; (3) Improper flashing or sealing of any roof penetrations made after the work done by Contractor has been completed (such as heating & air conditioning systems and ducts installed after Contractor's work has been completed); (4) Any physical damage of whatever nature to the roofing material; (5) Work done on the roof by persons other than Contractor

NOTICE TO OWNER: This limited warranty covers workmanship only and excludes all materials used. The roofing materials selected are NOT covered by this limited warranty. Please see the manufacturers warranty for details about warranties on the roofing materials. Owner is hereby informed that Contractor does not agree with or endorse the manufacturer's warranty of the roofing materials selected by the Owner. Consequently, Contractor shall not be held in any way responsible or liable for any defects in the roofing materials.



This certifies that

purchased

TAMKO® Lamarite® Slate Composite Shingles

on

Lamarite Slate Composite Shingles
come with a

50-Year Limited Warranty

from

TAMKO Building Products, Inc.

P.O. Box 1404

Joplin, Missouri 64802

1-800-641-4691

Contractor/Company

Date of Installation

Street Address

Number of Squares Installed

City, State, ZIP

Phone

Contractor's Signature