

# PRODUCT CATALOG

1.866.648.9336

[www.simtekfence.com](http://www.simtekfence.com)



# THE SIMTEK ADVANTAGE



SimTek has reinvented fence manufacturing with its patented design of rotationally-molded fencing allowing realistic granite-stone appearance and superior performance.

What makes our **EcoStone** fence unique?



**Patented Construction**

Made with proprietary Linear Low Density Polyethylene Plastic (LLDPE) and reinforced with galvanized steel



**Superior Wind Rating**

Can withstand constant hurricane force winds up to 110 mph and 130 mph gusts - meets Miami-Dade County wind load requirements



**Excellent Sound Barrier**

Blocks 98% of direct sound - with an (STC) sound transmission class of 26



**Durable in Any Temperature**

Very stable in hot and cold extremes. Has been tested and performs well at temperatures ranging from -40 F to 140 F



**Fade Resistant**

Contains UV-12 inhibitors for a lifetime of vibrant colors



**Solid Privacy and Security**

EcoStone provides exceptional privacy and security for your loved ones



**Easy Installation**

One of the most user-friendly fences on the market



**Graffiti Resistant**

Graffiti is easily removed using a high-powered pressure washer



**Eco-Friendly**

EcoStone is made with recycled and recyclable polyethylene plastic



**Maintenance-Free**

EcoStone will never need painting, staining and will not warp, fade or crack



**Twenty-five Year & Lifetime Warranty**

A maintenance-free solution. Twenty-five and lifetime warranties available



**Made in the USA**

Proudly made in the United States of America



EcoStone

ENHANCE YOUR SURROUNDINGS





# THE BEAUTY AND DURABILITY OF **STONE**



## ADD **VALUE** TO YOUR HOME

- **SOLID PRIVACY AND SECURITY FOR YOUR LOVED ONES**
- **EASY TO INSTALL**
- **EXTREMELY DURABLE IN ANY TEMPERATURE**
- **ECO-FRIENDLY**





# ENGINEERED GATES

# CONCRETE SURFACE MOUNTS



## Concrete Mounting Brackets

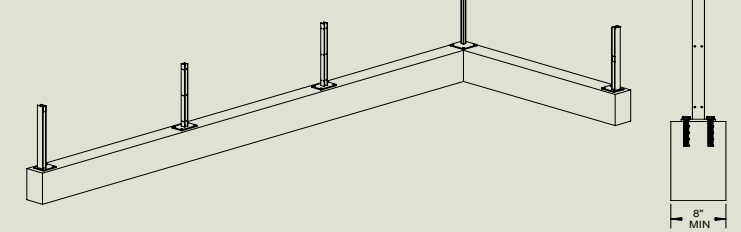

- EcoStone may be mounted on concrete or a retaining wall by using our engineered concrete mounting brackets and decorative skirts
- For more information and specifications, please visit our website at [www.simtekfence.com](http://www.simtekfence.com)



## Steel Reinforced Gates

- Gates come in 3ft, 4ft, 5ft and 6ft widths and may be double hung for 7ft, 8ft, 9ft, 10ft, 11ft or 12ft openings
- Internal steel frame provides an extra rigid structure
- Hinges thread directly into the interior metal frame of the gate
- Our spring loaded, self-closing hinges meet national pool codes

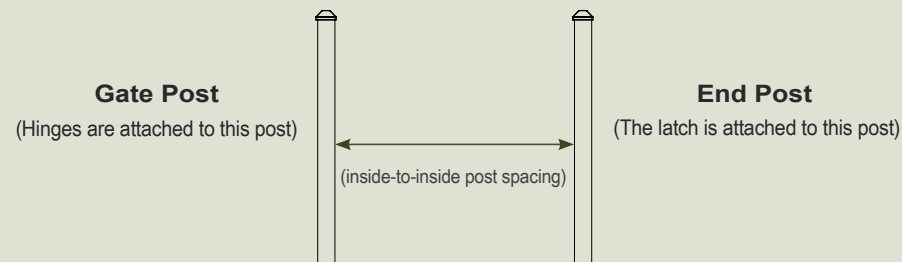

Gate Width	Single Opening	Double Drive w/3' Gate	Double Drive w/4' Gate	Double Drive w/5' Gate	Double Drive w/6' Gate
3ft Wide Gate	38.5"	76.0"	88.0"	100.0"	112.0"
4ft Wide Gate	50.5"	88.0"	100.0"	112.0"	124.0"
5ft Wide Gate	62.5"	99.5"	111.5"	122.5"	134.5"
6ft Wide Gate	73.5"	110.5"	123.5"	134.5"	145.5"



## Concrete Surface Mounts & Cover Skirts

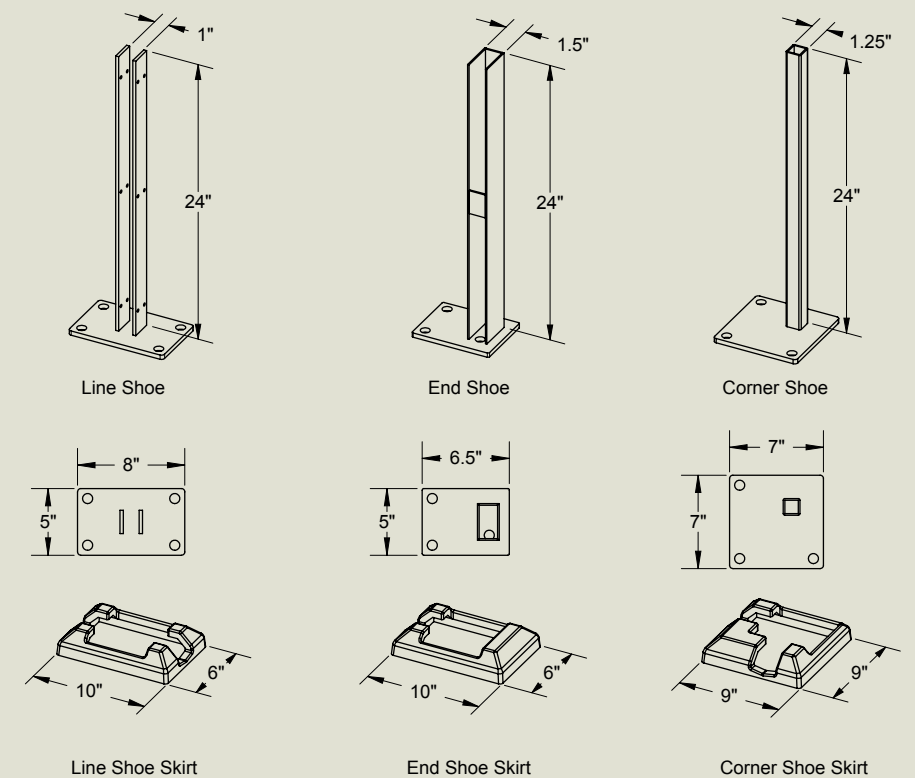



# ECO-FRIENDLY AND MAINTENANCE-FREE COMMERCIAL SOLUTIONS



## ENHANCE YOUR PROPERTY

- EXCELLENT SOUND BARRIER WITH AN STC RATING OF 26
- GRAFFITI RESISTANT
- EXTREMELY DURABLE WITH SUPERIOR STRENGTH
- RESISTS HURRICANE FORCE WINDS







## PANELS

- Panels come in 3ft x 6ft, 6ft x 6ft, and 4ft x 8ft
- All panels contain high-grade galvanized steel in both top and bottom rails
- Panel heights cannot be modified; however, panels can be cut to any custom width
- Our panels have been engineered to allow stacking to create 8ft, 12ft and 16ft high walls

## POSTS

- Posts come in 8.5ft and 12ft heights and have a five-inch outer diameter
- All posts contain full-length internal molded steel stiffeners for optimum strength
- Posts are made from 50% recycled polyethylene plastic
- For 12ft, and 16ft high projects, we supply metal I-beams with matching plastic posts sleeves



Scan QR Code to see specifications & drawings

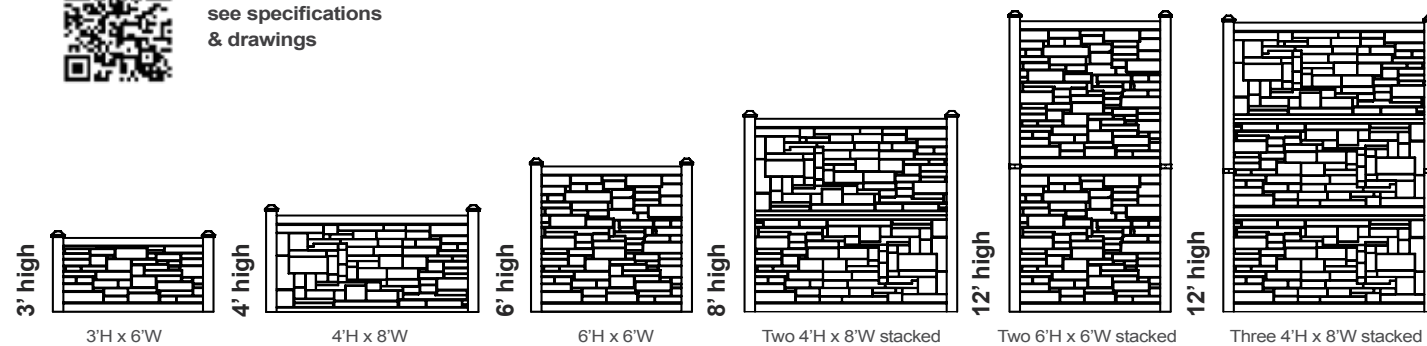

Brown Granite



Dark Brown Granite

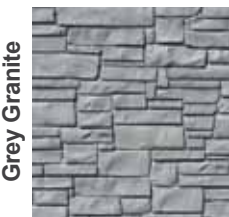

Grey Granite



Beige Granite



Black Granite



Desert Granite



White Granite

## CREATE THE YARD OF YOUR DREAMS

### 1. VIEW OUR PHOTO GALLERY ONLINE

Check out our website, [www.simtekfence.com](http://www.simtekfence.com) and visit our photo galleries for project ideas and inspiration.

### 2. DESIGN YOUR OWN FENCE

Create you own fence by using our fence calculator. This tool will provide all the materials you will need for your fence project.

### 3. ORDER COLOR SAMPLES

Go online and request more product info or call our toll-free number: 1.866.648.9336. Our representatives will be happy to assist you.



Scan QR Code and request a free color sample

[www.simtekfence.com](http://www.simtekfence.com)



NOA Approval  
12-125.02



Since 2007

U.S. Patents  
7,478,797 / 7,635,114  
Foreign Patents Pendings

Toll Free 1.866.648.9336  
Tel. 1.801.655.5236  
Fax 1.801.655.5240  
[www.simtekfence.com](http://www.simtekfence.com)





### **Corporate Headquarters**

**SimTek Fence  
1330 West 400 North  
Orem, UT 84057  
Toll Free 1.866.648.9336  
Tel. 1.801.655.5236  
Fax 1.801.655.5240  
info@simtekfence.com  
www.simtekfence.com**

### **Authorized Dealer**