

# **Brake** *Quip*

////// INNOVATIVE SOLUTIONS FOR AUTOMOTIVE PLUMBING

The One Stop Shop for  
Automotive Plumbing

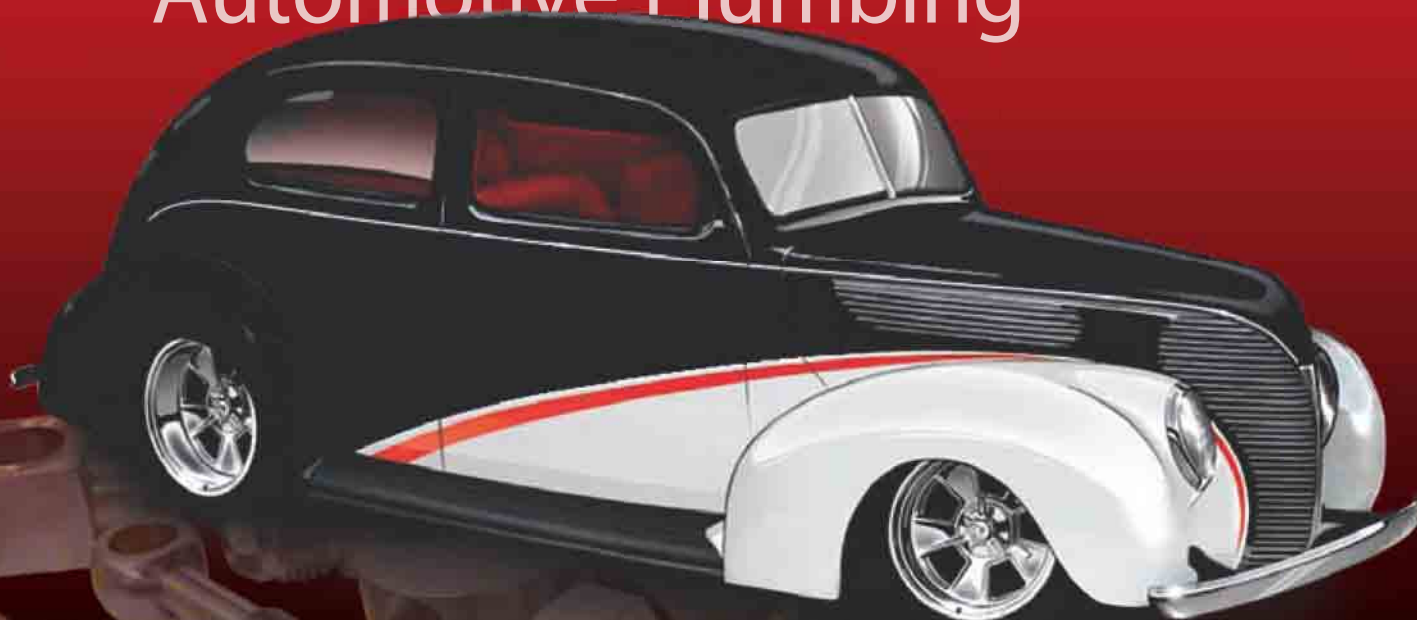

Lab Tested - Tuff!



AUTOMOTIVE PLUMBING CATALOG  
[www.hfeweb.com](http://www.hfeweb.com)

©Copyright 2010

\$1.50 USA

## Tube Nuts

Most BrakeQuip tube nuts have two distinct features for easier installation & dismantling.

1. **A small step on end of the thread**  
– This allows for easier installation because the step acts as a guide & makes it easier to start the thread. It also gives the thread clearance at the end which eliminates the problem of flaring out when over tightened. If this happens, the nut can be very difficult to remove & can some times destroy the thread when removed.
2. **A thread relief under the hex** – apart from looking more professional, this allows the nut to be screwed down right up to the hex if necessary.

### FEATURES:

- Male & Female
- Imperial & Metric Threads
- Various tube sizes
- Zinc plated for corrosion resistance

Assortment kit available.

To order see Part No.

BQ7005 & BQ7006.

See page 8 for Assortment Kit



### Male Tube Nuts

PART NO.	THREAD	A	B	C
BQ72	M10 x 1	14mm	10mm	3/16" DIN
BQ2577	7/16" x 24NS	13mm	7/16"	1/4"
BQ2578	1/2" x 20NF	12mm	1/2"	5/16"
BQ4276	3/8" x 20BSF	16mm	3/8"	3/16"
BQ4277	7/16" x 20NF	18mm	7/16"	1/4"
BQ4285	3/8" x 24NF	16mm	3/8"	3/16"
BQ4510	M9 x 1	14mm	10mm	3/16"
BQ4511	M10 x 1	14mm	10mm	3/16"
BQ4511-11	M10 x 1	12mm	11mm	3/16"
BQ4511LT	M10 x 1	14mm	10mm	3/16"
BQ4512	M10 x 1.25	15mm	10mm	3/16"
BQ4513	M12 x 1	15mm	12mm	1/4"
BQ5555	3/8" x 24NF	10mm	3/8"	3/16"
BQ5842	7/16" x 24NS	10mm	7/16"	3/16"
BQ6118	7/16" x 20NF	18mm	7/16"	3/16"
BQ9169	M12 x 1	15mm	14mm	1/4" DIN
BQ9180	M12 x 1	15mm	12mm	3/16"
BQ9181	5/8" x 18NF	14mm	5/8"	3/8"
BQ9182	M12 x 1.5	13mm	12mm	1/4"
BQ9183	M14 x 1.5	15mm	14mm	1/4"
BQ9184	1/2" x 20NF	13mm	1/2"	3/16"
BQ9185	9/16" x 18NF	14mm	9/16"	3/16"
BQ9186	9/16" x 18NF	14mm	9/16"	1/4"
BQ9187	1/2" x 20NF	14mm	1/2"	1/4"
BQ9188	M10 x 1.5	15mm	10mm	3/16"
BQ9189	M11 x 1.0	15mm	11mm	3/16"
BQ9190	M11 x 1.25	15mm	11mm	3/16"
BQ9191	M11 x 1.5	15mm	11mm	3/16"
BQ9192	M12 x 1.25	15mm	12mm	3/16"
BQ9193	M12 x 1.5	15mm	12mm	3/16"
BQ9194	M13 x 1.0	15mm	13mm	3/16"
BQ9195	M13 x 1.25	15mm	13mm	3/16"
BQ9196	M13 x 1.5	15mm	13mm	3/16"
BQ9197	M14 x 1.5	15mm	14mm	5/16"
BQ9198	M16 x 1.5	16mm	16mm	5/16"
BQ9199	M18 x 1.5	16mm	18mm	5/16"

### Female Tube Nuts

PART NO.	THREAD	A	B	C
BQ55	3/8" x 24NF	8mm	1/2"	3/16"
BQ57	7/16" x 20NF	3/8"	9/16"	1/4"
BQ9174	M12 x 1	10mm	16mm	3/16"
BQ9175	M10 x 1	10mm	1/2"	3/16"
BQ9176	3/8" x 24NF	10mm	1/2"	3/16"
BQ9177	1/2" x 20NF	7/16"	5/8"	5/16"
BQ9178	M12 x 1.5	10mm	16mm	1/4"
BQ9179	M12 x 1	10mm	16mm	1/4"

## Stainless Steel Tube Nuts

Give your vehicle the professional look of non rusting stainless steel.

- Bright finish
- Professional design
- Long lasting

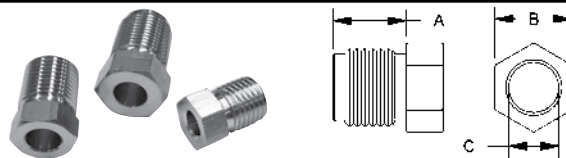

PART NO.	TYPE	THREAD	A	B	C
BQ2577SS	Male	7/16" x 24NS	13mm	7/16"	1/4"
BQ4511SS	Male	M10 x 1	14mm	10mm	3/16"
BQ4513SS	Male	M12 x 1	15mm	12mm	1/4"
BQ5555SS	Male	3/8" x 24NF	10mm	3/8"	3/16"
BQ5842SS	Male	7/16" x 24NS	10mm	7/16"	3/16"

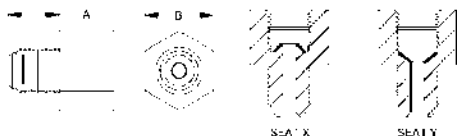

## Male – Female Thread Adapters

Save time & hassle when adapting different threads quickly & easily. Universal Male thread can be sealed with all sealing combinations.

### FEATURE S:

- Imperial & Metric Threads
- Inverted seat & drill point seats available
- Zinc plated for corrosion resistance

Assortment kit available.

To order see Part No.

BQ7004.

See page 8 for Assortment Kit

PART NO.	MALE THREAD	FEMALE THREAD	SEAT TYPE	A	B
BQ40	M10 x 1	M10 x 1	Y	13mm	13mm
BQ41	M10 x 1	M10 x 1.25	X	12mm	13mm
BQ42	M10 x 1.25	M10 x 1	X	12mm	13mm
BQ43	M12 x 1	M10 x 1	X	12mm	16mm
BQ44	M10 x 1	M12 x 1	X	12mm	16mm
BQ45	3/8" x 24NF	7/16" x 24NS	X	12mm	9/16"
BQ46	7/16" x 24NS	3/8" x 24NF	X	12mm	9/16"
BQ47	7/16" x 20NF	3/8" x 24NF	X	12mm	9/16"
BQ48	1/8" x 27NPT	3/8" x 24NF	X	12mm	1/2"
BQ49	M10 x 1	3/8" x 24NF	X	12mm	13mm
BQ50	3/8" x 24NF	M10 x 1	X	12mm	1/2"
BQ120	1/2" x 20NF	3/8" x 24NF	X	12mm	16mm
BQ121	9/16" x 20NS	3/8" x 24NF	X	12mm	11/16"
BQ122	1/2" x 20NF	7/16" x 24NS	X	12mm	16mm
BQ123	9/16" x 18NF	7/16" x 24NS	X	12mm	11/16"
BQ124	9/16" x 18NF	3/8" x 24NF	X	12mm	11/16"
BQ125	M10 x 1	3/8" x 24NF	Y	12mm	13mm
BQ126	7/16" x 20NF	M10 x 1	Y	12mm	9/16"
BQ127	7/16" x 24NS	1/2" x 20NF	X	12mm	5/8"
BQ156	3/8" x 24NF	3/8" x 24NF	X	12mm	9/16"
BQ187	<b>NEW</b> M10 x 1.5	1/8" x 27NPT	Y	11mm	9/16"
BQ246	1/8" x 27NPT	M12 x 1	Y	12mm	16mm
BQ247	3/8" x 24NF	1/8" x 27NPT	Y	11mm	9/16"
BQ248	1/2" x 20NF	1/8" x 27NPT	Y	11mm	9/16"
BQ260	3/8" x 24NF	1/2" x 20NF	X	12mm	16mm
BQ261	3/8" x 24NF	9/16" x 18NF	X	12mm	11/16"
BQ262	9/16" x 18NF	3/8" x 24NF	Y	12mm	11/16"

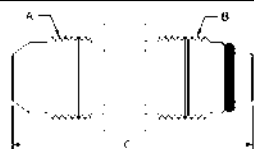

## Bump Tube Adapters

Handy, hard to get tube adapters for power steering & fuel systems.

### FEATURE S:

- Comes with a high temperature Viton O-Ring
- Imperial & Metric Threads

Assortment kit available.

To order see Part No.

BQ7003.

See page 8 for Assortment Kit

PART NO.	A	B	C
14MMBT-6MJ	9/16" x 18NF (No.6 JIC)	M14 x 1.5	39mm
16MMBT-6FI	5/8" x 18NF (Inverted Seat)	M16 x 1.5	32mm
16MMBT-6MJ	9/16" x 18NF (No.6 JIC)	M16 x 1.5	39mm
18MMBT-6MJ	9/16" x 18NF (No.6 JIC) <b>NEW</b>	M18 x 1.5	39mm
5MBT-5MJ	1/2" x 20NF (No. 5 JIC)	1/2" x 20NF	37mm
7MBT-6MJ	9/16" x 18NF (No.6 JIC)	11/16" x 18NF	41mm

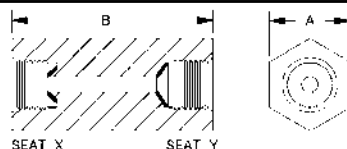

## Female Tube Joiners

The recommended way to legally join two tubes together. BrakeQuip tube joiners allow you to join tubes professionally & safely.

### FEATURE S:

- Imperial & Metric Threads
- Inverted seat & drill point seats available
- Zinc plated for corrosion resistance

Assortment kit available.

To order see Part No.

BQ7009.

See page 9 for Assortment Kit

PART NO.	THREAD	SEAT TYPE	A	B
BQ110	3/8" x 24NF	X	1/2"	22.2mm
BQ111	7/16" x 24NS	X	9/16"	25.0mm
BQ112	1/2" x 20NF	X	5/8"	25.0mm
BQ113	5/8" x 18NF	X	3/4"	29.0mm
BQ114	M10 x 1	Y	13.0mm	29.0mm
BQ115	3/8" x 24NF	Y	1/2"	29.0mm
BQ116	M12 x 1	X	5/8"	25.0mm
BQ117	M10 x 1	X	13.0mm	22.0mm
BQ119	9/16" x 18NF	X	3/4"	27.0mm
BQ147	<b>NEW</b> M12 x 1	Y	16.0mm	28.0mm

## Male Test Adapters

These handy test Adapters can be used for a variety of applications including tapping into your hydraulic system for pressure readings. Will fit most bleed screw openings.

### FEATURE S:

- Imperial & Metric Threads
- Take off point are universal JIC ends
- Zinc plated for corrosion resistance

Assortment kit available.  
To order see Part No.

BQ7010

See page 9 for Assortment Kit

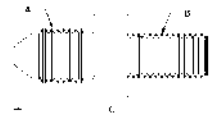

PART NO.	A	B	C
BQ128	3/8" x 24NF (No. 3 JIC)	M10 x 1.25	36mm
BQ129	3/8" x 24NF (No. 3 JIC)	M10 x 1.00	36mm
BQ130	3/8" x 24NF (No. 3 JIC)	M10 x 1.5	60mm
BQ131	7/16" x 20NF (No. 4 JIC)	3/8" x 24NF	37mm
BQ132	3/8" x 24NF (No. 3 JIC)	1/4" x 28NF	36mm
BQ133	3/8" x 24NF (No. 3 JIC)	5/16" x 24NF	36mm
BQ134	7/16" x 20NF (No. 4 JIC)	7/16" x 24NS	37mm
BQ135	3/8" x 24NF (No. 3 JIC)	3/8" x 24NF	36mm
BQ144	7/16" x 20NF (No. 4 JIC)	M12 x 1.00	37mm
BQ145	7/16" x 20NF (No. 4 JIC)	M10 x 1.00	30mm
BQ157	3/8" x 24NF (No. 3 JIC)	1/8" x 28BSPP	30mm

## Bleed Screws

These popular bleed screws makes replacement easy.

### FEATURE S:

- Heavy duty hex allows for good gripping
- Zinc plated for corrosion resistance
- Imperial & Metric Threads

Assortment kit available.  
To order see Part No.

BQ7014

See page 9 for Assortment Kit

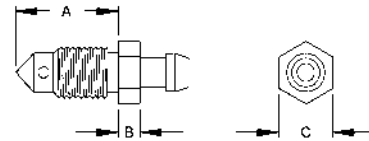

PART NO.	THREAD	A	B	C
BQ4433	3/8" x 24NF	20mm	5mm	10mm
BQ4434	M10 x 1	23mm	6mm	10mm
BQ4435	M10 x 1	19mm	6mm	10mm
BQ4438	5/16" x 24NF	17.5mm	5mm	5/16"
BQ4439	1/4" x 28NF	15mm	5mm	1/4"
BQ4440	M10 x 1.5	18mm	5mm	10mm
BQ4441	M7 x 1	22mm	5mm	1/4"
BQ4442	M8 x 1.25	22mm	5mm	8mm
BQ4443	M8 x 1	18mm	5mm	8mm
BQ4444	7/16" x 24NS	24mm	5mm	7/16"
BQ4445	7/16" x 20NF	21mm	5mm	7/16"
BQ4446	M10 x 1.25	21mm	5mm	10mm

## Bleeder Caps

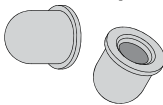

BQ315 (Small)  
BQ316 (Large)

## Bulkhead Nuts

The biggest range of brake hose bulkhead nuts in the country.

### FEATURE S:

- Zinc plated for corrosion resistance
- Imperial & Metric Threads
- Heavy duty construction

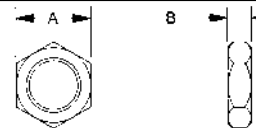

PART NO.	THREAD	A	B
BQ13	5/8" x 18NF	15/16"	8mm
BQ75	7/8" x 14NF	1-1/8"	8mm
BQ77	11/16" x 16NF	1"	8mm
BQ78	3/8" x 24NF	1/2"	5mm
BQ79	M10 x 1	13mm	5mm
BQ80	7/16" x 20NF	5/8"	6mm
BQ81	M12 x 1	19mm	6mm
BQ82	M12 x 1.5	19mm	6mm
BQ83	1/2" x 20NF	3/4"	6mm
BQ84	3/4" x 16NF	1-1/16"	8mm
BQ85	M20 x 1.5	27mm	8mm
BQ86	M18 x 1.5	25mm	8mm
BQ87	M16 x 1.5	22mm	7mm
BQ88	M14 x 1.5	19mm	6mm
BQ89	7/8" x 18NS	1-1/8"	8mm

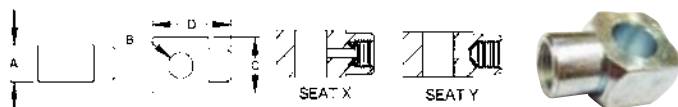

PART NO.	THREAD	SEAT TYPE	A	B	C	D
BQ60	3/8" x 24NF	X	1/2"	10mm	17mm	27mm
BQ61	M10 x 1	X	13mm	10mm	17mm	27mm
BQ62	7/16" x 24NF	X	14mm	7/16"	18mm	28mm
BQ63	1/2" x 20NF	X	16mm	1/2"	20mm	30mm



PART NO.	A	B	C	THREAD
BQ150	10mm	10mm	42mm	3/8" x 24NF (No. 3 JIC)
BQ151	10mm	10mm	21mm	3/8" x 24NF (No. 3 JIC)
BQ152	10mm	10mm	21mm x (2)	3/8" x 24NF (No. 3 JIC)
BQ155	10mm	10mm	42mm	7/16" x 20NF (No. 4 JIC)

## Banjo Unions & Adapters

These fittings allow you to convert most joints to a sharp 90° legally & professionally. The swivel feature of these fittings gives you more flexibility in installation.

### FEATURES:

- Imperial & Metric Threads
- Zinc plated for corrosion resistance

Assortment kit available.

To order see Part No.

BQ7001

See page 8 for Assortment Kit



PART NO.	NOMINAL ID	A	B	C
BQ813	8mm	8.1	13.00	1.3
BQ3858	3/8"	9.6	15.60	1.5
BQ1016	10mm	10.1	16.00	1.5
BQ1118	7/16"	11.2	18.00	1.5
BQ1218	12mm	12.1	18.00	1.5
BQ1320	1/2"	12.8	20.00	2.0
BQ1421	9/16"	14.3	22.00	2.0
BQ1522	15mm	15.1	22.00	2.0
BQ1624	16mm	16.1	24.00	2.0

## Copper Washers

Heavy duty copper washers for maximum sealing power. The legal & professional way to seal high pressure hydraulic braking systems.

### FEATURES:

- Sizes to fit all banjo bolts
- Reduced outer diameter for less interference

Assortment kit available.

To order see Part No.

BQ7000

See page 8 for Assortment Kit

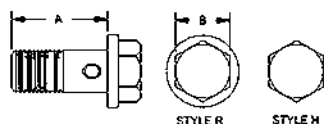

PART NO.	THREAD	HEAD STYLE	A	B
BQ8076	M8 x 1	R	17mm [11/16"]	10mm
BQ8077	M8 x 1.25	R	16mm [5/8"]	10mm
BQ8078	M12 x 1.25	R	25mm [1"]	14mm
BQ8083*	M10 x 1	H	34.5mm [1-3/8"]	14mm
BQ8084*	M10 x 1.25	H	34.5mm [1-3/8"]	14mm
BQ8085*	3/8" x 24NF	H	34.5mm [1-3/8"]	9/16"
BQ8086	M10 x 1.5	R	24mm [15/16"]	11mm
BQ8087	M11 x 1.25	R	24mm [15/16"]	5/8"
BQ8088	M10 x 1.5	R	27mm [1-1/16"]	10mm
BQ8089	7/16" x 20NF	R	24mm [15/16"]	7/16"
BQ8090	7/16 x 24NS	R	27mm [1-1/16"]	1/2"
BQ8092	M12 x 1.5	R	25mm [1"]	14mm
BQ8093	3/8" x 24NF	R	25mm [1"]	14mm
BQ8094	M10 x 1	R	26mm [1"]	14mm
BQ8095	M10 x 1	R	22mm [7/8"]	12mm
BQ8096	7/16" x 20NF	R	27mm [1-1/16"]	11mm
BQ8097	1/2" x 20NF	R	30mm [1-3/16"]	9/16"
BQ8098	M12 x 1	R	21mm [13/16"]	13mm
BQ8099	M10 x 1.25	R	22mm [7/8"]	12mm

## Banjo Bolts

A banjo bolt for every application.

### FEATURES:

- Reduced head size for appearance & less interference
- Zinc plated for corrosion resistance
- Imperial & Metric Threads

Assortment kit available.

To order see Part No.

BQ7007

See page 9 for Assortment Kit

\* Double Banjo Bolt



## Fitting Plugs

The ideal fitting for blanking off high pressure fluid ports. Fitting design has a universal seat so no sealing compounds necessary.

### FEATURE S:

- Zinc plated for corrosion resistance
- Imperial & Metric Threads

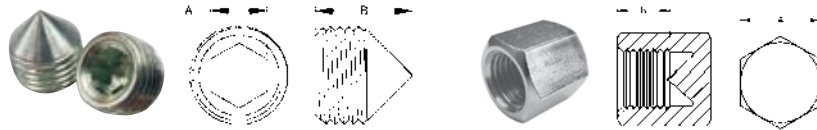

PART NO.	THREAD	A	B
BQ18	M10 x 1	5mm	10mm
BQ19	3/8" x 24NF	3/16"	10mm
BQ26	7/16" x 24NS	1/4"	11mm
BQ160	3/8" x 24NF	1/2"	8mm
BQ161	7/16" x 24NS	9/16"	8mm
BQ162	7/16" x 20NF	9/16"	8mm
BQ163	1/2" x 20NF	16mm	8mm
BQ164	M10 x 1	13mm	8mm
BQ165	M10 x 1.25	13mm	8mm
BQ166	M12 x 1	16mm	8mm
BQ167	M12 x 1.5	16mm	8mm

## 3 Way Tube Tee's with Mounting Hole

The ideal fitting for legally joining 3 tubes together. Also features a mounting hole for secure installation.

### FEATURE S:

- Imperial & Metric Threads
- Inverted seat & drill point seats available
- Zinc plated for corrosion resistance

Assortment kit available.

To order see Part No.

BQ7002

See page 8 for Assortment Kit

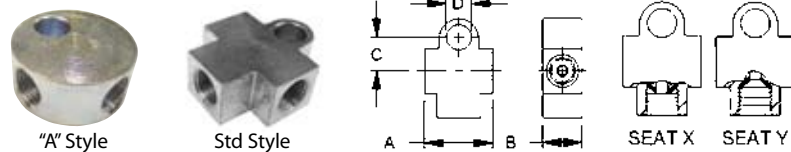

PART NO.	THREAD	SEAT TYPE	A	B	C	D
BQ56A	3/8" x 24NF	X	28mm	1/2"	7.70mm	5/16"
BQ90A	3/8" x 24NF	Y	1-1/4"	1/2"	9.00mm	5/16"
BQ91A	M10 x 1	X	1-1/4"	1/2"	9.00mm	8mm
BQ92A	7/16" x 24NS	X	1-1/4"	14mm	9.00mm	5/16"
BQ93	1/8" x 27NPT	Y	26mm	1/2"	10.75mm	5/16"
BQ94	7/16" x 20NF	Y	30mm	14mm	10.75mm	3/8"
BQ95A	M10 x 1	Y	1-1/4"	14mm	10.00mm	7mm

## Weld On Banjo Heads

Designed to make plumbing easy when banjo fittings are necessary.

Simply braze 3/16" (4.75mm) tube to banjo head.

Can also be countersunk for 1/4" tube.



PART NO.	A	B	C	D
BQ223	8mm	10mm	17mm	25mm
BQ224	10mm	10mm	18mm	25mm
BQ225	10mm	7/16"	19mm	25mm

## Aluminum Weld On Fittings

The ultimate convenience item for aluminum tubes found on air conditioning and oil cooler lines. This problem solver will make it easy to connect aluminum tube to flexible hose.

The pre-fluxed aluminum brazing rods BQ34 are ideal for brazing these fittings.

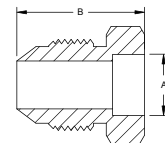
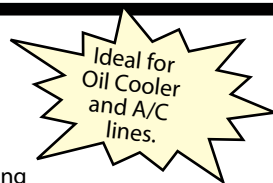

PART NO.	THREAD	SEAT ANGLE	B	A
BQ170	9/16" x 18NF	37°	20mm	3/8"
BQ171	5/8" x 18NF	45°	22mm	3/8"
BQ172	3/4" x 16NF	37°	23mm	1/2"
BQ173	7/8" x 14NF	37°	26mm	5/8"
BQ174	1-1/16" x 14	45°	34mm	3/4"

### Tandem Trailer Fitting

Universal (4 Way)



PART NO.  
BQ222

- 3/8" x 24NF x 4 (Inverted Seat)
- Secured by bulkhead mount (Use BQ13 bulkhead nut)
- Eliminates fittings and joins
- Any excess ports can be blanked off with a BQ19 plug

### Swivel Elbow

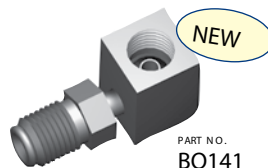

PART NO.  
BQ141

3/8" x 24NF - 3/8" x 24NF

This handy swivel fitting is ideal for a tight 90° situation where the connection needs to be seated on an inverted seat.

### Universal Mounting Bracket



PART NO.  
BQB06

Universal hole size allows most brake hoses to be securely mounted. Bracket can be screwed on, riveted or welded to frame. Rounded finish for professional looks.

### Brake Hose Retaining Clip



PART NO.  
BQ3052

Universal clip design secures most brake hoses to mounting surface.



PART NO.  
BQ3053

Suits Toyota vehicles.

### 3 Way Tee (with Bracket)



PART NO.  
BQ7812

FEATURE S:

- 3/8" x 24NF x 3 (Inverted Seat)
- All steel construction

### Weld On Fitting

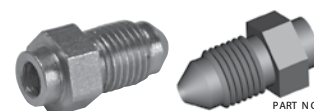

PART NO.  
BQ153

The ultimate problem solver for connecting metal tube to hose.

FEATURE S:

- Universal countersink hole for 3/16" & 1/4" tube sizes
- Popular No. 3 JIC take off point

### Transmission Line Adapters



PART NO.  
BQ182

5/8" x 18NF inverted - Straight



PART NO.  
BQ183

5/8" x 18NF inverted - 90°

Convert your push on connection transmission lines to a double flare connection. This enables you to make and repair these lines in your shop.

### Copper Seat Sealer

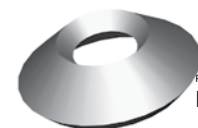

PART NO.  
BQ244

The ideal solution for sealing damaged seats. Suitable for all 3/8" and 10mm female fitting seats.

### Bleed Screw Repair Kit



PART NO.  
BQ181

This repair kit will rescue your brake component that has a stripped or broken bleed screw. Simply drill and tap to 1/8" x 27NPT thread. Works for all metals.

### Braze-On Fitting

PART NO.  
BQ226

Countersunk for 3/8" tube



PART NO.  
BQ227

Countersunk for 10mm tube

No. 6 JIC (9/16" x 18NF) male braze-on fitting for power steering tubes.

### Female Hose Joiner



PART NO.  
BQ266

3/8" x 24NF No.3 JIC (AN)

Joins 3/8" x 24NF female fittings – universal design for both seat types.

### 3-Way Tees



PART NO.  
BQ264

3/8" x 24NF x (3) inverted seat  
Compact steel fitting for joining 3 lines.

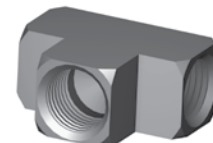

PART NO.  
BQ265

3/8" x 24NF x (2) inverted seat  
1/8" x 27NPT x (1)  
Compact steel fitting for installing brake pressure switch into system.



PART NO.  
BQ7000



PART NO.  
BQ7002



PART NO.  
BQ7004



PART NO.  
BQ7001



PART NO.  
BQ7003



PART NO.  
BQ7005

### Copper Washers

Part No. BQ7000

CONTENTS	DESCRIPTION	QTY.
BQ1016	10mm ID x 16mm OD x 1.5mm thick	20
BQ1118	7/16" ID x 18mm OD x 1.5mm thick	20
BQ1218	12mm ID x 18mm OD x 1.5mm thick	20
BQ1320	1/2" ID x 20mm OD x 2mm thick	20
BQ1421	9/16" ID x 21mm OD x 2mm thick	10
BQ1522	15mm ID x 22mm OD x 2mm thick	10
BQ1624	16mm ID x 24mm OD x 2mm thick	10
BQ3858	3/8" ID x 5/8" OD x 1.5mm thick	20

### Banjo Unions & Adapters

Part No. BQ7001

CONTENTS	DESCRIPTION	QTY.
BQ60	Union 10mm Hole x 1/2" (T) - 3/8" x 24NF (IS)	4
BQ61	Union 10mm Hole x 13mm (T) - M10x1 (IS)	4
BQ62	Union 7/16" Hole x 14mm (T) - 7/16" x 24NS (IS)	4
BQ63	Union 1/2" Hole x 16mm (T) - 1/2" x 20NF (IS)	4
BQ150	Adapter 10 x 10mm (Ext.) - 3/8" x 24NF (No. 3 JIC)	4
BQ151	Adapter 10 x 10mm - 3/8" x 24NF (No. 3 JIC)	4

T = Thickness IS = Inverted Seat

### 3-Way Tube Tee

with Mounting Hole

Part No. BQ7002

CONTENTS	DESCRIPTION	QTY.
BQ56A	3/8" x 24NF (IS) 5/16" Mount Hole	2
BQ90A	3/8" x 24NF (DPS) 5/16" Mount Hole	2
BQ91A	M10 x 1 (IS) 8mm Mount Hole	2
BQ92A	7/16" x 24NS (IS) 5/16" Mount Hole	2
BQ93	1/8" x 27NPT 5/16" Mount Hole	2
BQ94	7/16" x 20NF (DPS) 3/8" Mount Hole	2
BQ95A	M10 x 1 (DPS) 7mm Mount Hole	2

IS = Inverted Seat DPS = Drill Point Seat

### Bump Tube Adapters

Part No. BQ7003

CONTENTS	DESCRIPTION	QTY.
14MMBT-6MJ	M14 x 1.5 - 9/16" x 18NF (No. 6 JIC)	4
16MMBT-6FI	M16 x 1.5 - 5/8" x 18NF (Female Inverted)	4
16MMBT-6MJ	M16 x 1.5 - 9/16" x 18NF (No. 6 JIC)	4
18MMBT-6MJ	M18 x 1.5 - 9/16" x 18NF (No. 6 JIC)	4
5MBT-5MJ	1/2" x 20NF - 1/2" x 20NF (No. 5 JIC)	4
7MBT-6MJ	11/16" x 16NF 9/16" x 18NF (No. 6) JIC	4

### Male - Female Thread Adapters

Part No. BQ7004

CONTENTS	DESCRIPTION	QTY.
BQ40	(M) M10 x 1 (F) M10 x 1 (DPS)	4
BQ41	(M) M10 x 1 (F) M10 x 1.25 (IS)	4
BQ42	(M) M10 x 1.25 (F) M10 x 1 (IS)	4
BQ43	(M) M12 x 1 (F) M10 x 1 (IS)	4
BQ44	(M) M10 x 1 (F) M12 x 1 (IS)	4
BQ45	(M) 3/8" x 24NF (F) 7/16" x 24NS (IS)	4
BQ46	(M) 7/16" x 24NS (F) 3/8" x 24NF (IS)	4
BQ47	(M) 7/16" x 20NF (F) 3/8" x 24NF (IS)	4
BQ48	(M) 1/8" x 27NPT (F) 3/8" x 24NF (IS)	4
BQ49	(M) M10 x 1 (F) 3/8" x 24NF (IS)	4
BQ50	(M) 3/8" x 24NF (F) M10 x 1 (IS)	4
BQ120	(M) 1/2" x 20NF (F) 3/8" x 24NF (IS)	4
BQ121	(M) 9/16" x 20NS (F) 3/8" x 24NF (IS)	4
BQ122	(M) 1/2" x 20NF (F) 7/16" x 24NS (IS)	4
BQ123	(M) 9/16" x 18NF (F) 7/16" x 24NS (IS)	4
BQ124	(M) 9/16" x 18NF (F) 3/8" x 24NF (IS)	4
BQ125	(M) M10 x 1 (F) 3/8" x 24NF (DPS)	4
BQ156	(M) 3/8" x 24NF (F) 3/8" x 24NF (IS)	4

IS = Inverted Seat DPS = Drill Point Seat (M) Male (F) Female

### Metric Tube Nuts

Part No. BQ7005

CONTENTS	DESCRIPTION	QTY.
BQ72	Male M10 x 1 - 3/16" Tube (DIN)	4
BQ4511	Male M10 x 1 - 3/16" Tube	10
BQ4512	Male M10 x 1.25 - 3/16" Tube	6
BQ4513	Male M12 x 1 - 1/4" Tube	6
BQ9174	Female M12 x 1 - 3/16" Tube	4
BQ9175	Female M10 x 1 - 3/16" Tube	4
BQ9178	Female M12 x 1.5 - 1/4" Tube	4
BQ9179	Female M12 x 1 - 1/4" Tube	4
BQ9180	Male M12 x 1 - 3/16" Tube	4
BQ9182	Male M12 x 1.5 - 1/4" Tube	4
BQ9183	Male M14 x 1.5 - 6mm Tube	4
BQ9188	Male M10 x 1.5 - 3/16" Tube	4
BQ9191	Male M11 x 1.5 - 3/16" Tube	4
BQ9192	Male M12 x 1.25 - 3/16" Tube	4
BQ9193	Male M12 x 1.5 - 3/16" Tube	4



PART NO.  
BQ7006PART NO.  
BQ7009PART NO.  
BQ7012PART NO.  
BQ7007PART NO.  
BQ7010PART NO.  
BQ7014

## Imperial Tube Nuts

Part No. BQ7006

CONTENTS	DESCRIPTION	QTY.
BQ57	Female 7/16" x 20NF – 1/4" Tube	4
BQ2577	Male 7/16" x 24NS – 1/4" Tube	10
BQ2578	Male 1/2" x 20NF – 5/16" Tube	6
BQ4276	Male 3/8" x 20BSF – 3/16" Tube	4
BQ4277	Male 7/16" x 20NF – 1/4" Tube	4
BQ4285	Male 3/8" x 24NF – 3/16" Tube	4
BQ5555	Male 3/8" x 24NF – 3/16" Tube	10
BQ5842	Male 7/16" x 24NS – 3/16" Tube	10
BQ6118	Male 7/16" x 20NF – 3/16" Tube	6
BQ9176	Female 3/8" x 24NF – 3/16" Tube	4
BQ9177	Female 1/2" x 20NF – 5/16" Tube	4
BQ9184	Male 1/2" x 20NF – 3/16" Tube	4
BQ9185	Male 9/16" x 18NF – 3/16" Tube	4
BQ9186	Male 9/16" x 18NF – 1/4" Tube	4
BQ9187	Male 1/2" x 20NF – 1/4" Tube	4

## Banjo Bolts

Part No. BQ7007

CONTENTS	DESCRIPTION	QTY.
BQ8086	M10 x 1.5 L = 23mm	4
BQ8087	M11 x 1.25 L = 23mm	4
BQ8088	M10 x 1.5 L = 29mm	4
BQ8089	7/16" x 20NF L = 15/16"	4
BQ8090	7/16" x 24NS L = 1-1/16"	4
BQ8092	M12 x 1.5 L = 25mm	4
BQ8093	3/8" x 24NF L = 1"	6
BQ8095	M10 x 1 L = 22mm	6
BQ8096	7/16" x 20NF L = 1-1/16"	4
BQ8097	1/2" x 20NF L = 1-3/16" L	4
BQ8098	M12 x 1 L = 21mm	4
BQ8099	M10 x 1.25 L = 22mm	4

## Female Tube Joiners

Part No. BQ7009

CONTENTS	DESCRIPTION	QTY.
BQ110	3/8" x 24NF (IS)	4
BQ111	7/16" x 24NS (IS)	4
BQ114	M10 x 1 (DPS)	
BQ115	3/8" x 24NF (DPS)	4
BQ116	M12 x 1 (IS)	4
BQ117	M10 x 1 (IS)	4

IS = Inverted Seat DPS = Drill Point Seat

## Male Test Adaptors

BQ7010

CONTENTS	DESCRIPTION	QTY.
BQ129	M10 x 1.0 - 3/8" x 24NF (No. 3 JIC)	
BQ130	M10 x 1.5 - 3/8" x 24NF (No. 3 JIC)	4
BQ131	3/8" x 24NF - 7/16" x 20NF (No. 4 JIC)	4
BQ134	7/16" x 24NS - 7/16" x 20NF (No. 4 JIC)	4
BQ135	3/8" x 24NF - 3/8" x 24NF (No. 3 JIC)	4
BQ144	M12 x 1.0 - 7/16" x 20NF (No. 4 JIC)	

## Brake Hose Plugs

Part No. BQ7012

CONTENTS	DESCRIPTION	QTY.
BQ18	Male M10 x 1	2
BQ19	Male 3/8" x 24NF	2
BQ26	Male 7/16" x 24NS	2
BQ160	Female 3/8" x 24NF	2
BQ161	Female 7/16" x 24NS	2
BQ162	Female 7/16" x 20NF	2
BQ163	Female 1/2" x 20NF	2
BQ164	Female M10 x 1	2
BQ165	Female M10 x 1.25	2
BQ166	Female M12 x 1	2
BQ167	Female M12 x 1.5	2
BQ1020	Blocking off Tool (Fits banjo holes 3/8" to 5/8")	

## Bleed Screws

Part No. BQ7014

CONTENTS	DESCRIPTION	QTY.
BQ315	Bleeder Cap - Small	10
BQ316	Bleeder Cap - Large	10
BQ4433	Bleed Screw 3/8" x 24NF	6
BQ4434	Bleed Screw M10 x 1 Long	4
BQ4435	Bleed Screw M10 x 1 Short	4
BQ4438	Bleed Screw 5/16" x 24NF	4
BQ4439	Bleed Screw 1/4" x 28NF	4
BQ4440	Bleed Screw M10 x 1.5	4
BQ4441	Bleed Screw M7 x 1	4
BQ4442	Bleed Screw M8 x 1.25	4
BQ4443	Bleed Screw M8 x 1	4
BQ4444	Bleed Screw 7/16" x 24NS	4
BQ4445	Bleed Screw 7/16" x 20NF	4
BQ4446	Bleed Screw M10 x 1.25	4



### EziBend Tube

PART NO.	OD SIZE	WALL THICKNESS	LENGTH
T187-25CN	3/16"	.028"	25'
T250-25CN	1/4"	.028"	25'
T312-25CN	5/16"	.028"	25'
T375-25CN	3/8"	.028"	25'
T375-25CN-35	3/8"	.035"	25' <b>NEW</b>

### Metal Tubing



#### Convert steel tubes to non rusting EziBend tube:

- Exceeds International Standards.
- Doesn't rust or corrode.
- Easy to flare and bend.
- Able to bend tube by hand on the vehicle
- OEM on luxury European vehicles.
- Polishes to a brilliant finish.
- Long term safety benefits
- Made in the USA
- Available in sizes 3/16", 1/4", 5/16", 3/8".

### Polished Stainless Steel Tube

PART NO.	OD SIZE	WALL THICKNESS	LENGTH
T187-20SS	3/16"	.028"	20'
T250-20SS	1/4"	.028"	20'
T312-20SS	5/16"	.028"	20'
T375-20SS	3/8"	.028"	20'

### Brake Tube Protector

No rust Stainless Steel Spring protects your brake tube from gravel & debris – Easy to install – Just cut to length – Available in sizes 3/16" & 1/4" ID in 3 feet lengths – Can be polished to shine.



### Remote Reservoir Hose

This brake fluid compatible hose connects any remote brake fluid reservoir to the master cylinder. These are black in color and purchased in 10' increments.

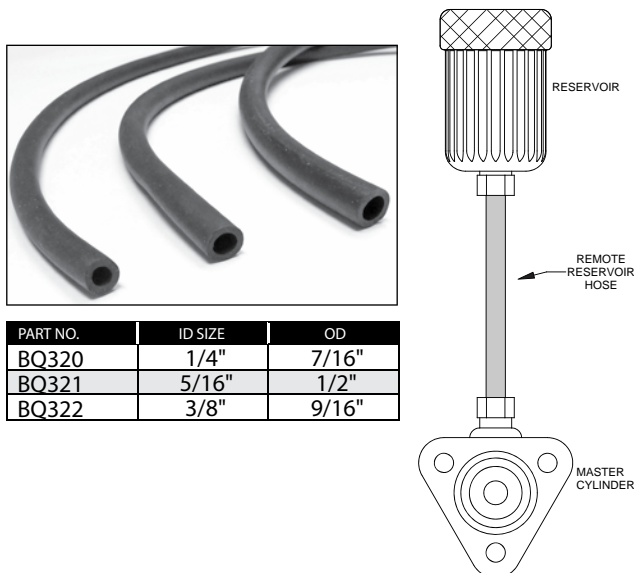

PART NO.	ID SIZE	OD
BQ320	1/4"	7/16"
BQ321	5/16"	1/2"
BQ322	3/8"	9/16"

### "The" Automotive Thread Gauge

Instantly identifies at least 99% of brake plumbing threads.

- Includes the 16 most popular Male and Female threads used on braking systems
- Includes both Male & Female size gauging
- Includes both Metric and Imperial
- Gauge can be used to plug fluid ports
- Color coded in groups for fast selection
- All threads are hardened for long life
- Comes in a sturdy black carrying case



Each gauge is available separately.

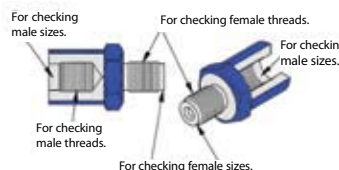

PART NO.	DESCRIPTION
BQ2100	Kit
BQ2100A	3/8 x 24NF
BQ2100B	7/16 x 24NS
BQ2100C	7/16 x 20NF
BQ2100D	1/2 x 20NF
BQ2100E	M10 x 1.0
BQ2100F	M10 x 1.25
BQ2100G	M12 x 1.0
BQ2100H	M12 x 1.5
BQ2100J	9/16 x 18NF
BQ2100K	9/16 x 20NS
BQ2100L	M9 x 1.0
BQ2100M	M10 x 1.5
BQ2100N	M12 x 1.25
BQ2100P	M11 x 1.25
BQ2100Q	M14 x 1.5
BQ2100R	3/8 x 20BSF

Blue - Most popular Metric threads  
 Red - Most popular Imperial threads  
 Gold - Less popular Metric threads  
 Green - Less popular Imperial threads

## Straightens Coiled Tube...Fast

At Last...A Tool To Straighten Tube That's Economical

Easily straightens light wall tubing from 3/16" to 1/2." Simply feed your coiled tube into the straightener and it comes out straight on the other side.

- Fully adjustable
- Smooth operation (roller bearing guides)
- Vice or bracket mounted
- Can be used on all types of annealed tubing (even stainless)

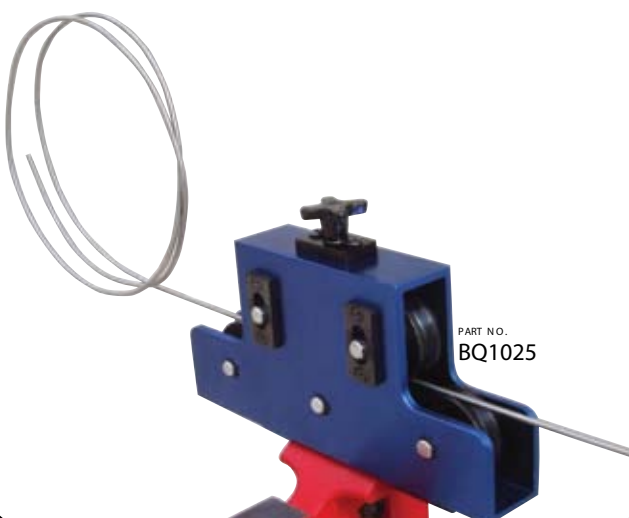

## Remove Frozen Bleeder Screws like a Pro ... Easily

No more... heating up, hammering, drilling and tapping.

- Can save you a lot of time.
- Pays for itself very quickly.
- Works on both cast iron and aluminum.



Bleeder Buster Kit

PART NO.  
BQ2200

It is as simple as 1, 2, 3.  
Works every time.

1. Place filler wire into end of bleeder and cut to length.
2. Install tool into your air chisel and shock bleeder from the top.
3. Unscrew bleed screw with conventional tool.

How does it work? Installing the wire plug into the bleed screw prevents the walls of the bleed screw from collapsing when removing. Applying impact to the bleed screw for about three to four seconds will compress and work harden the bleeder screw and "shock" the threads free.

Note: The "compressed" bleed screw will need to be replaced after removal.

## The Handiest Tool in a Brake Mechanic's Toolbox

### Brake Tube Pliers

For use on 3/16" and 1/4" brake tube.

Convenient and Quality Crafted

Brake mechanics often testify that this tool is the handiest tool in their tool boxes. Brake Tube Pliers are lightweight, yet strong enough for any brake job.

Brake Tube Pliers are designed to work efficiently, securely, and accurately in tight spaces, without damaging the brake tube. So, when the job calls for working with 3/16" or 1/4" brake tube, Brake Tube Pliers will make life as easy as 1, 2, 3.

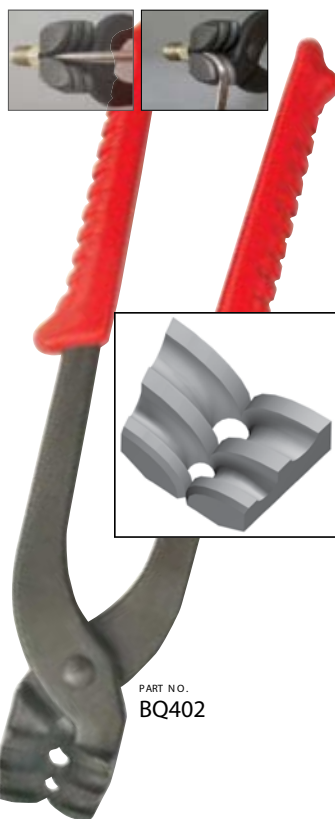

PART NO.  
BQ402

### Distinguishing Features

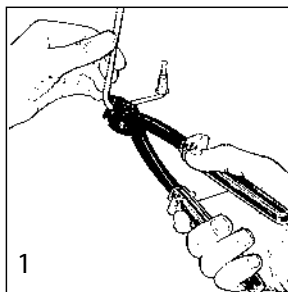
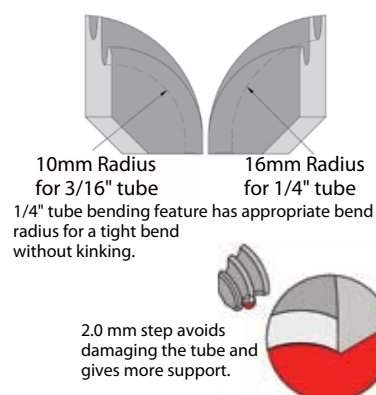

Brake Tube Pliers allows a tight 90° bend on the brake tube, right at the tube nut.

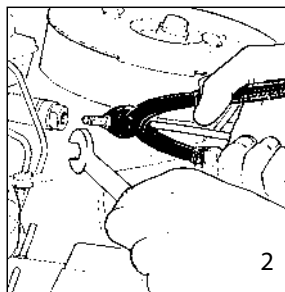

Brake Tube Pliers allow you to align the tube nut during assembly. In addition, it grips 3/16" or 1/4" brake tube securely without damaging it.

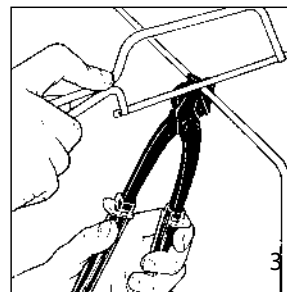

The hardened, square face on the back of Brake Tube Pliers acts as a guide to cut 3/16" or 1/4" brake tube squarely.

# Five convenient locations - same great service

## Fremont

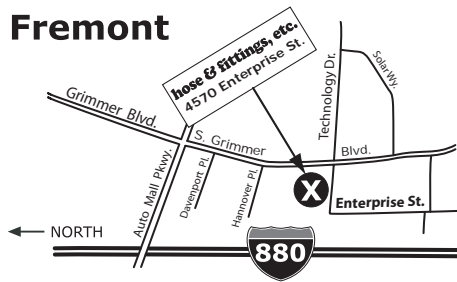

4570 Enterprise St.  
Fremont, CA 94538  
Phone: 510.661.0151  
Hours: 7 a.m. - 5 p.m. (M-F)

### QR Code

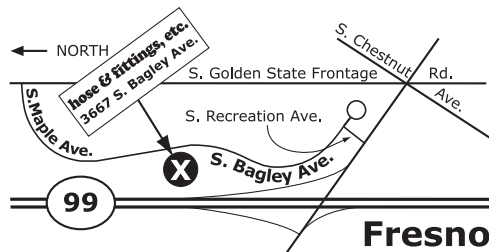

3667 South Bagley Ave., #102  
Fresno, CA 93725  
Phone: 559.495.1220  
Hours: 7 a.m. - 5 p.m. (M-F)

### QR Code

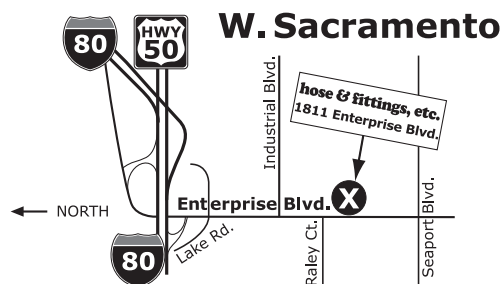

1811 Enterprise Blvd.  
West Sacramento, CA 95691  
Phone: 916.372.3888  
Hours: 7 a.m. - 5 p.m. (M-F)

### QR Code



## San Leandro

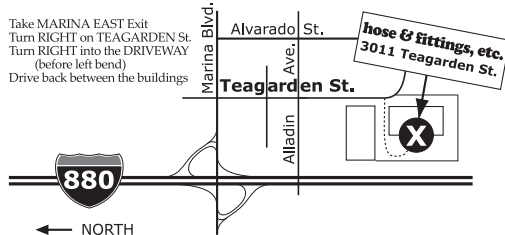

3011 Teagarden St.  
San Leandro, CA 94577  
Phone: 510.352.1514  
Hours: 7 a.m. - 5 p.m. (M-F)

### QR Code

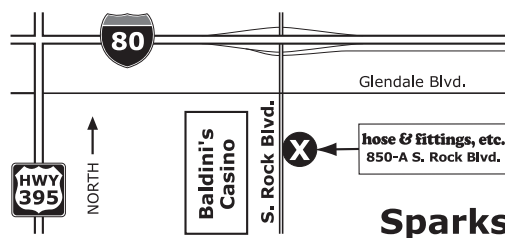

850-A South Rock Blvd.  
Sparks, NV 89431  
Phone: 775.331.4673  
Hours: 7 a.m. - 5 p.m. (M-F)

### QR Code



Phone: 888.715.4673  
E-mail: hfe@hfeweb.com  
**hfeweb.com**

**hose & fittings, etc.**  
Parker In California & Nevada

