

- HOSEBED CAPACITIES
- ① 500' OF 3.00" D.J. POLY HOSE
  - ② 1000' OF 4.00" D.J. POLY HOSE
  - ③ 1000' OF 3.00" D.J. POLY HOSE

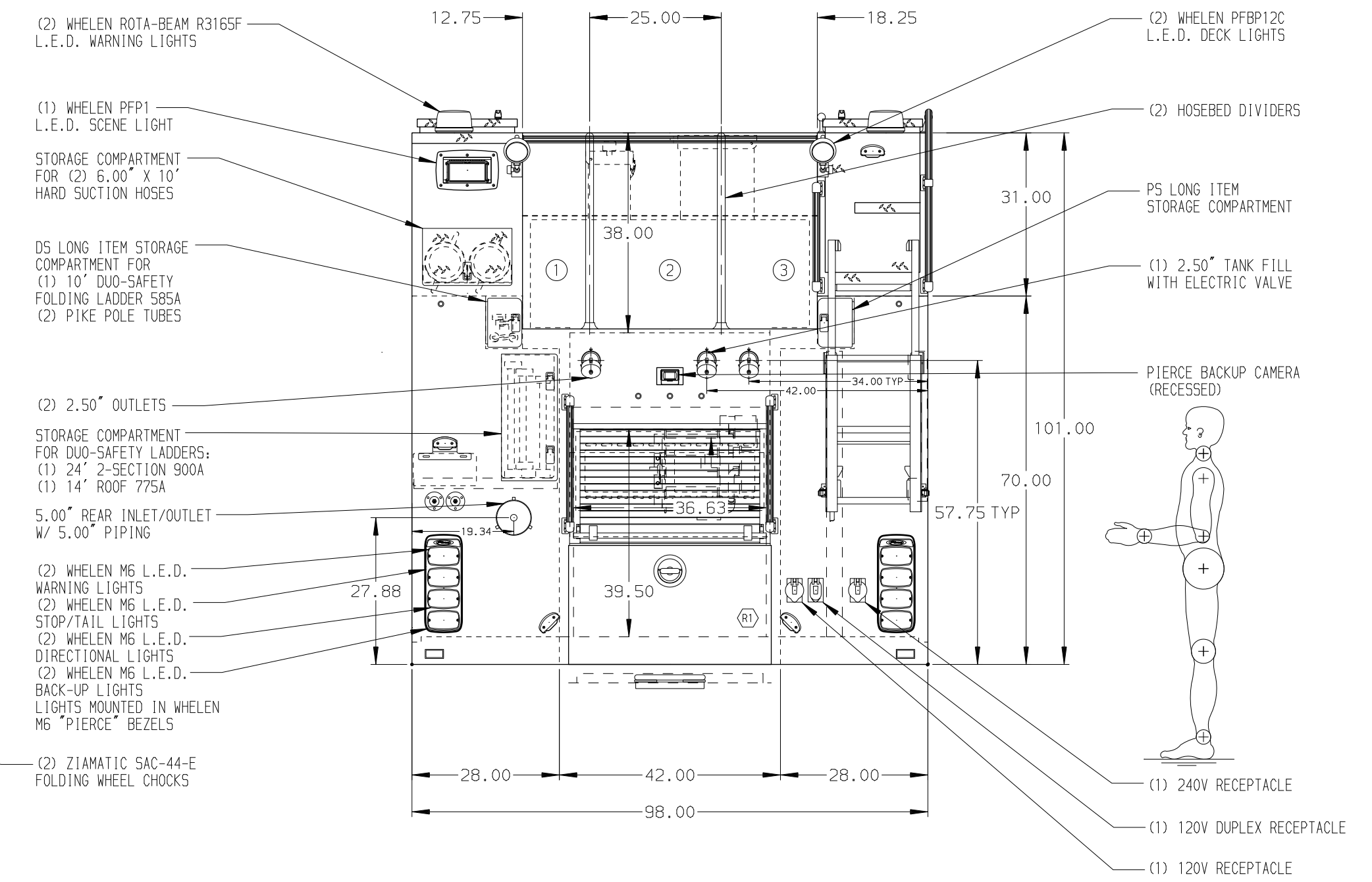
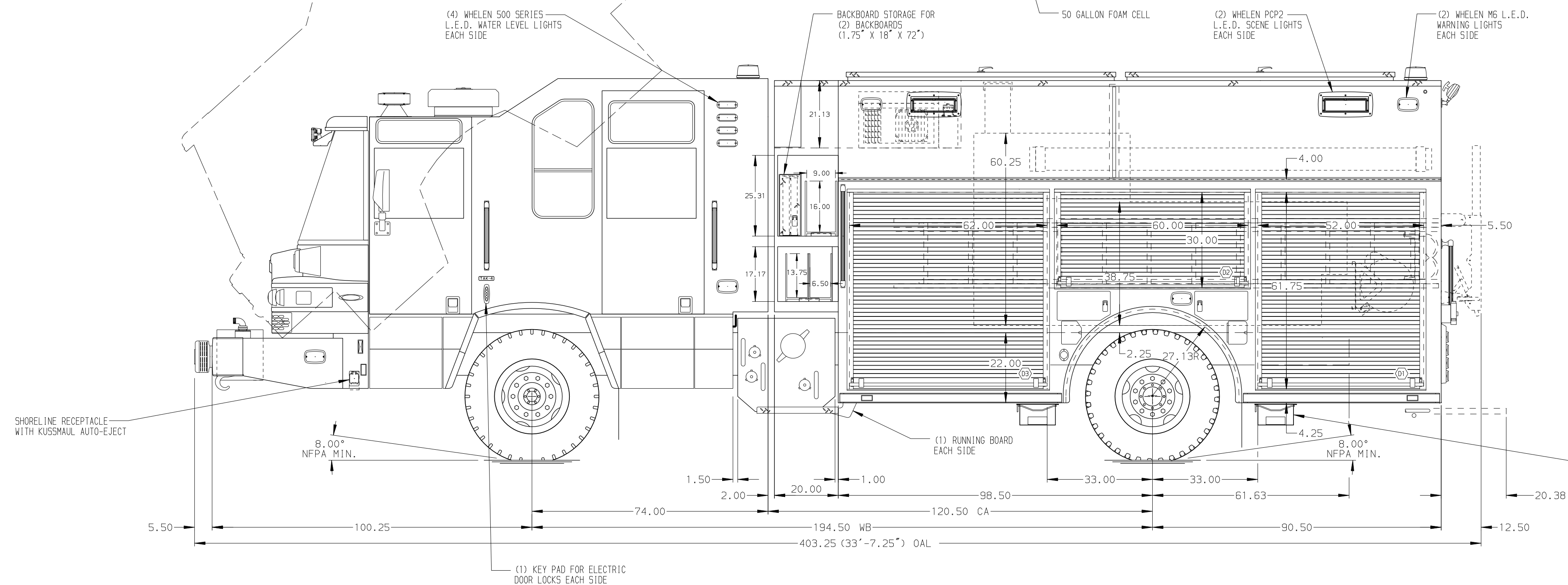
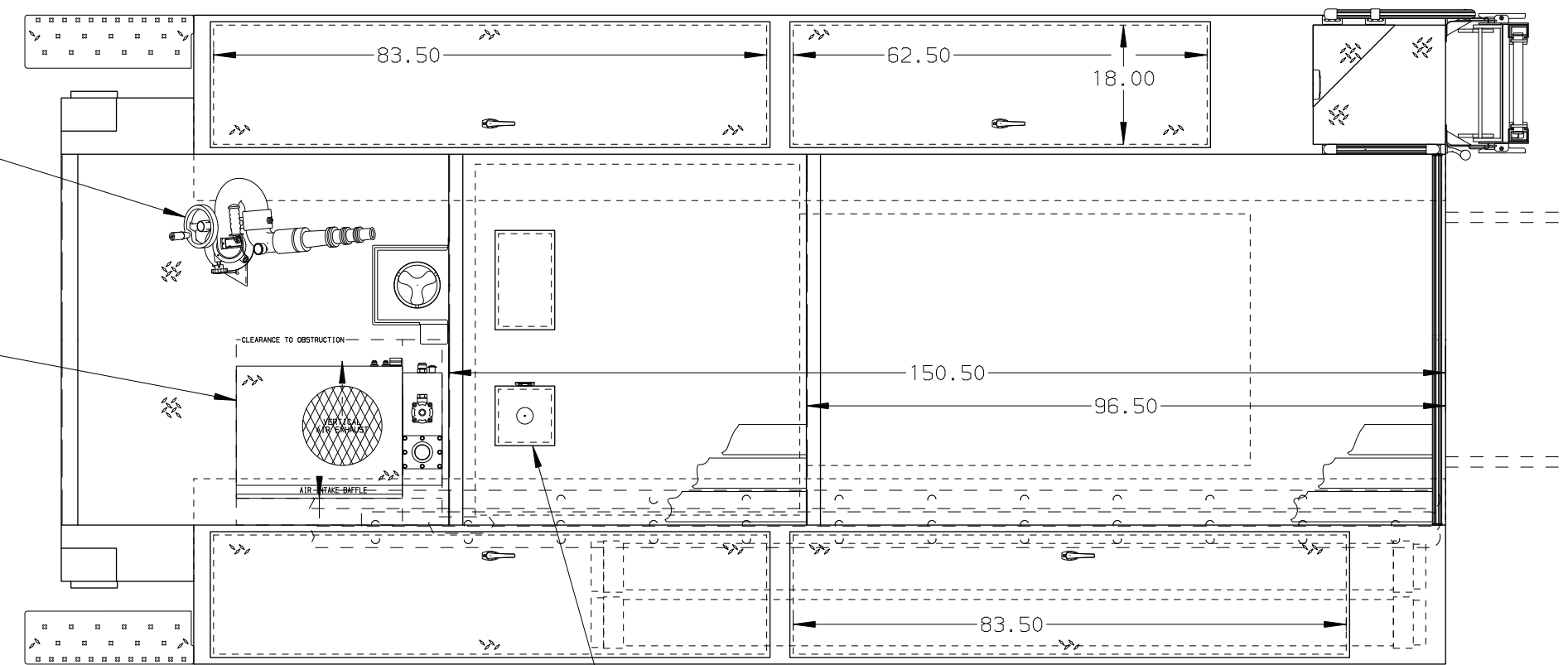

ALUMINUM BODY

SIDE ROLL AND FRONTAL IMPACT PROTECTION

**NOTE**  
DIMENSIONS SHOWN ARE APPROXIMATE AND ARE SUBJECT TO MINOR DEVIATIONS AS MAY OCCUR OR BE NECESSARY IN CONSTRUCTION. MINOR DETAILS NOT SHOWN.

1. AIR TOOL OUTLET WITH METERING VALVE LOCATED ON THE DRIVER SIDE PUMP PANEL
2. BATTERY CHARGE INDICATOR LOCATED ON D.S. SEAT RISER
3. BRUSHED STAINLESS STEEL SCUFFPLATE ON FRONT BULKHEADS
4. ONE ADJUSTABLE FULL WIDTH/FULL DEPTH SHELF IN COMPARTMENTS D1 & D3
5. ONE ADJUSTABLE SLIDE-OUT TRAY IN COMPARTMENTS D1, P1, P3, & R1
6. ONE ADJUSTABLE TILTING SLIDE-OUT TRAY IN COMPARTMENTS P2 & P3
7. ONE FLOOR MOUNTED SLIDE-OUT TRAY IN COMPARTMENTS D1, P1, P3, & R1
8. TWO ALUMINUM SWING-OUT TOOLBOARDS WITH PAC TRAC IN COMPARTMENT D2
9. BATTERY CHARGER LOCATED IN COMPARTMENT D3
10. 1400 GPM AROUND THE PUMP FOAM SYSTEM
11. CIRCUIT BREAKER PANEL IN COMPARTMENT D3
12. ONE HANNAY ELECTRIC REWIND CORD REEL MODEL 1618-17-18 WITH 200' OF 10/4 CABLE LOCATED IN COMPARTMENT R1
13. ONE 120V WATERPROOF RECEPTACLE LOCATED IN CAB

REV	DATE	BY	CH	QUANTUM
04DEC15	COL	PJP		MAKE
17NOV15	COL	PJP		PIERCE
16SEP15	COL	SMA		MODEL

		JOB NO.	29289
		SCALE	1:24
<b>TITLE</b> 1500-D-750 GAL POLY W/50 GAL FOAM CELL, 189" RESCUE (3) X LAYS, DELUGE, GENERATOR, LADDERS THRU BODY	<b>FOR</b> HONOLULU INTERNATIONAL AIRPORT HONOLULU, HAWAII	DRAWN BY	COL
		CHECKED BY	SM
<b>DWG NO.</b> 29289AD	<b>DATE</b> 	SHEET SIZE	D
		SHEET NO.	1 OF 1