

NOTE:  
 BOTTOM LAYER OF INSULATION SHALL BE LAID DOWN IN  
 A STAGGERED PROFILE. STAGGER AND OFFSET TOP LAYER  
 OF INSULATION FROM BOTTOM LAYER TO PREVENT  
 ALIGNED EDGES.

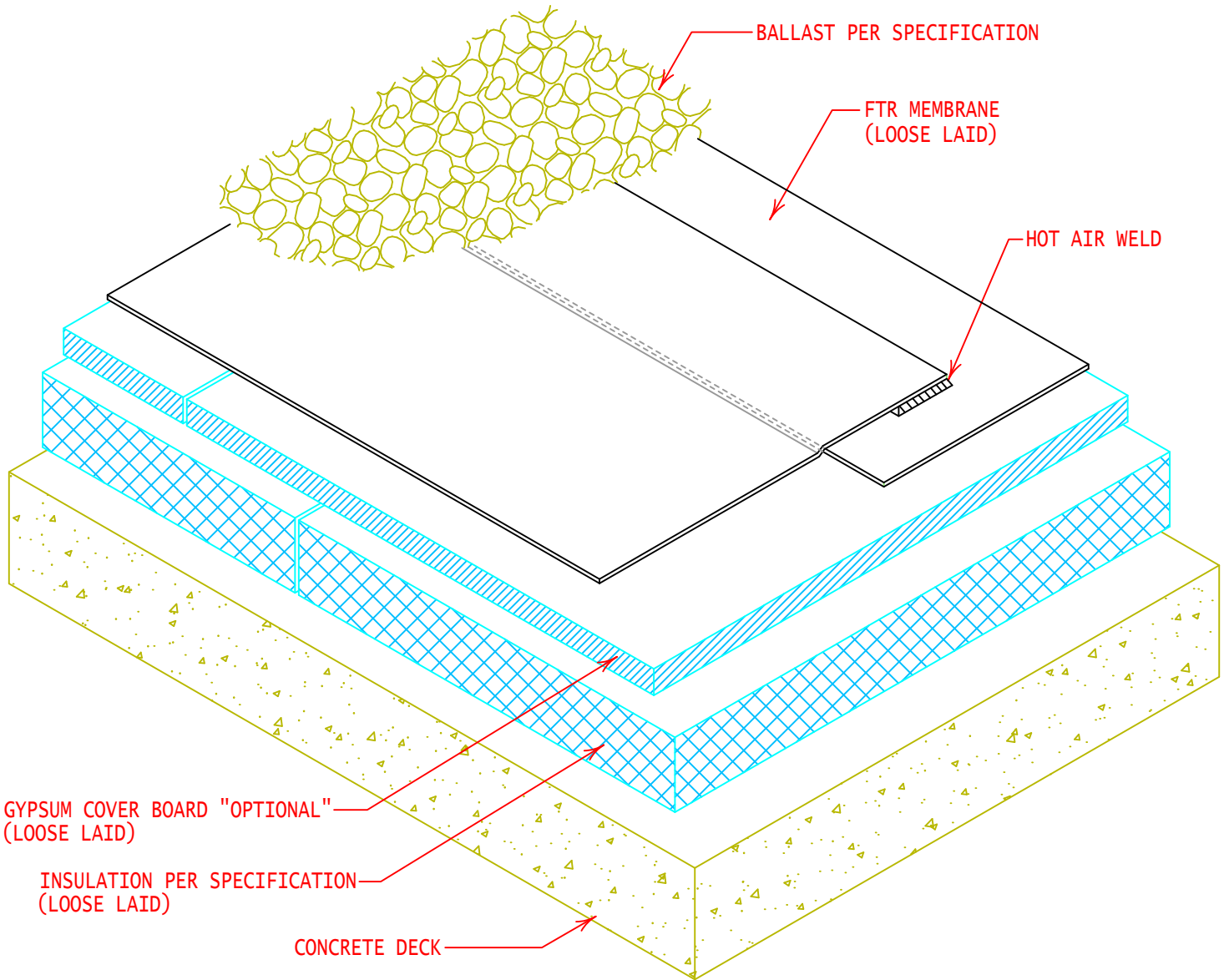

GYPSUM COVER BOARD "OPTIONAL"  
 (LOOSE LAID)

INSULATION PER SPECIFICATION  
 (LOOSE LAID)

CONCRETE DECK



GENERAL REFERENCE:  
 "FTR GS 01/21"  
 APPLICABLE SYSTEMS:  
 "FTR BA 01/21"

COMPOSITE ROOF SYSTEM CROSS SECTION  
 (BALLASTED SYSTEM)

REVISES DETAIL  
 ALL PREVIOUS

ISSUE DATE  
 03-15-21

DRAWING NUMBER  
 FTR-DBS1