

NOTE:  
 BOTTOM LAYER OF INSULATION SHALL BE LAID DOWN IN  
 A STAGGERED PROFILE. STAGGER AND OFFSET TOP LAYER  
 OF INSULATION FROM BOTTOM LAYER TO PREVENT  
 ALIGNED EDGES.

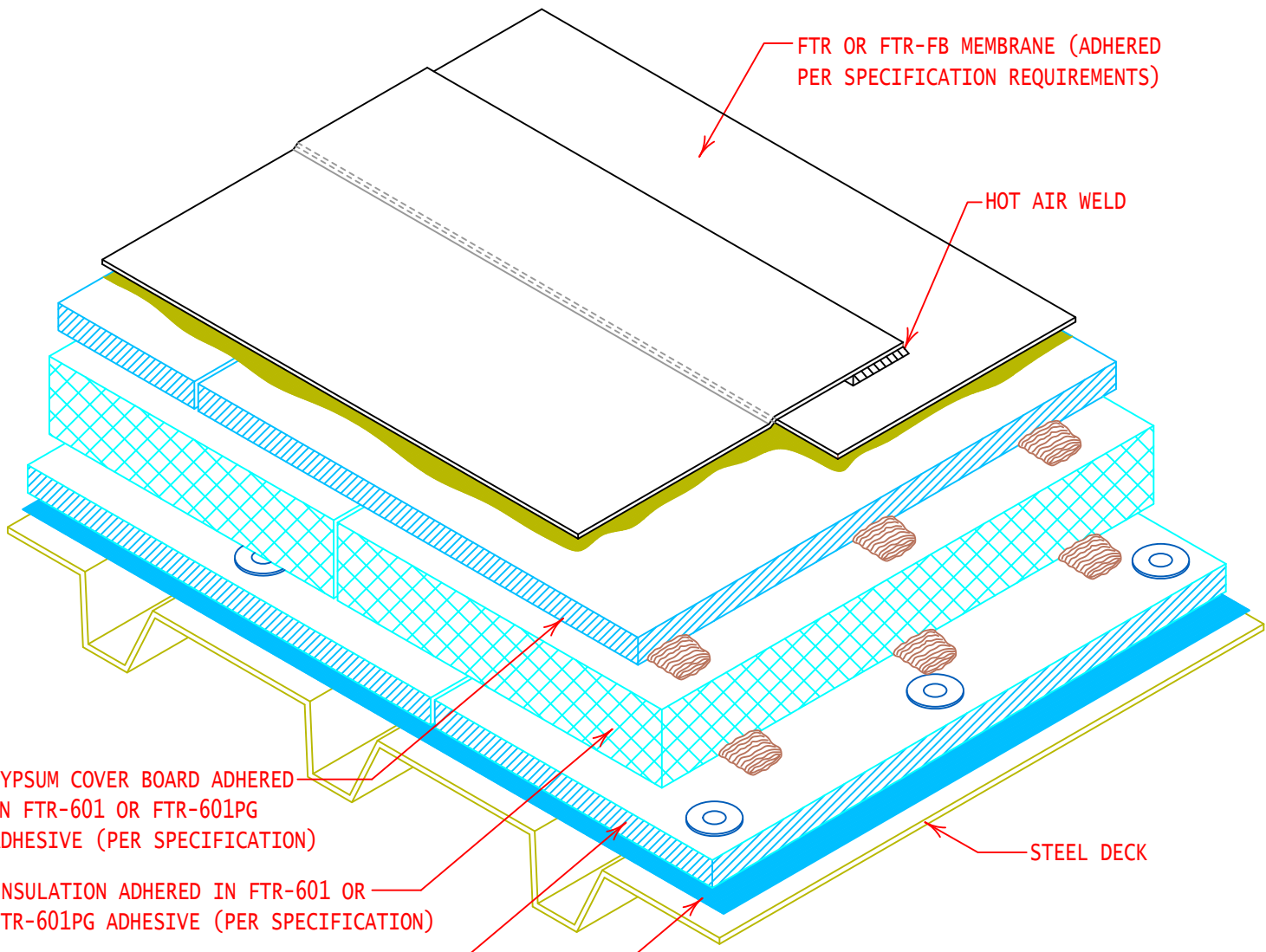

GYPSUM COVER BOARD ADHERED  
 IN FTR-601 OR FTR-601PG  
 ADHESIVE (PER SPECIFICATION)

INSULATION ADHERED IN FTR-601 OR  
 FTR-601PG ADHESIVE (PER SPECIFICATION)

GYPSUM THERMAL BARRIER BOARD  
 MECHANICALLY FASTEN (PER SPECIFICATION)

AIR BARRIER OR VAPOR RETARDER  
 (PER SPECIFICATION)

STEEL DECK



GENERAL REFERENCE:  
 "FTR GS 01/21"  
 APPLICABLE SYSTEMS:  
 "FTR AD 01/21"

**ROOF SYSTEM CROSS SECTION  
 (MECH. FAST. COVERBOARD & ADHERED INSUL.)**

REVISES DETAIL	ISSUE DATE	DRAWING NUMBER
ALL PREVIOUS	03-15-21	FTR-DAS12SP