

NOTE:  
 BOTTOM LAYER OF INSULATION SHALL BE LAID DOWN IN  
 A STAGGERED PROFILE. STAGGER AND OFFSET TOP LAYER  
 OF INSULATION FROM BOTTOM LAYER TO PREVENT  
 ALIGNED EDGES.

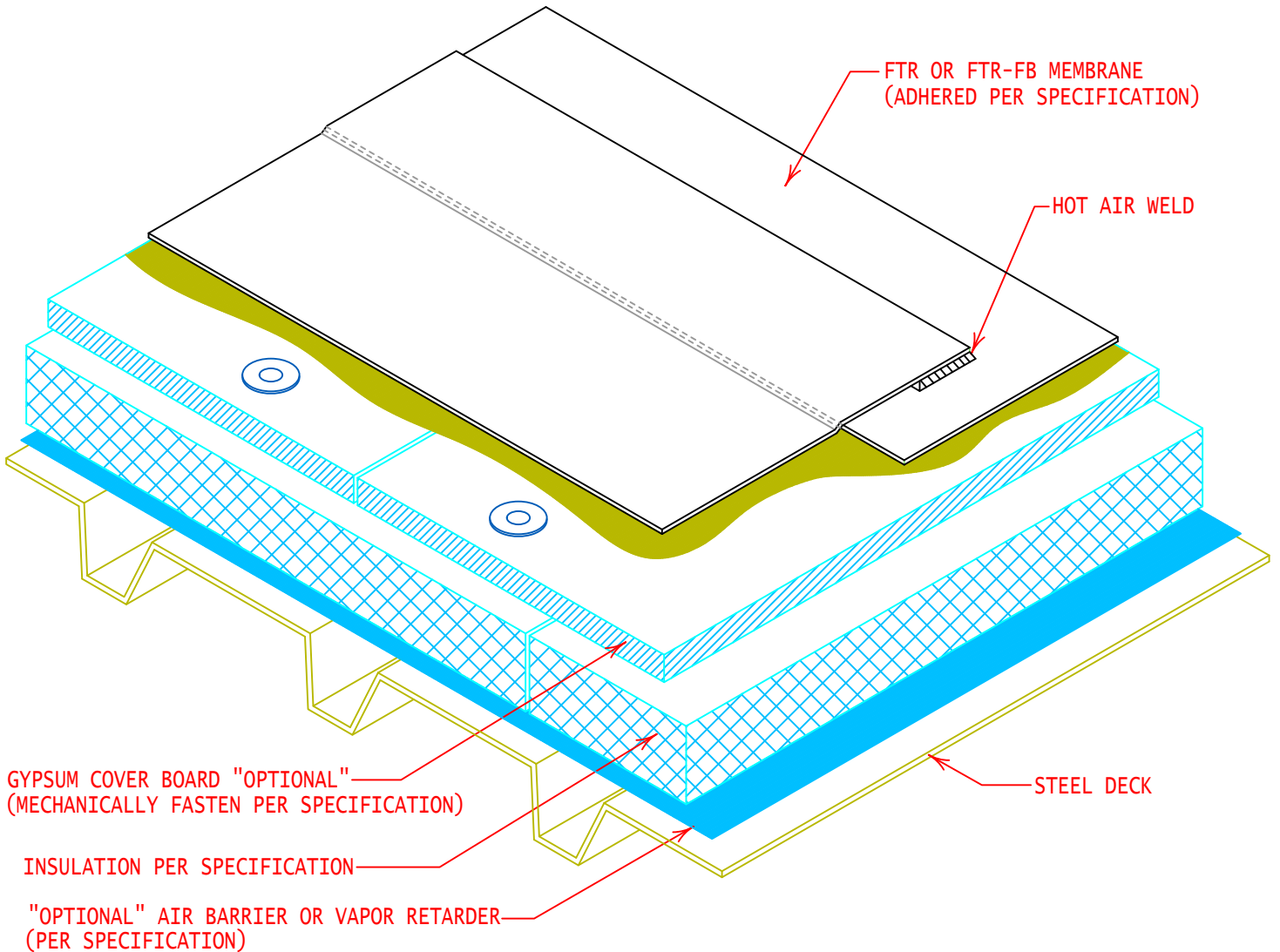

GENERAL REFERENCE:  
 "FTR GS 01/21"  
 APPLICABLE SYSTEMS:  
 "FTR AD 01/21"

COMPOSITE ROOF SYSTEM CROSS SECTION  
 (MECHANICALLY FASTENED INSULATION)

REVISES DETAIL  
 ALL PREVIOUS

ISSUE DATE  
 03-15-21

DRAWING NUMBER  
 FTR-DAS4