

A cutout is made in the ceiling tile tracing the shape of the access point. A steel backbox is placed above the ceiling tile, and a white trim is placed around the access point. The access point is attached to a universal mounting T-bar which is pressed into the backbox. The access point recesses into the ceiling tile and the trim creates a professional finished appearance. The access point is now recessed into the ceiling much like a recessed light fixture, making for an aesthetic installation, and providing ideal, unobstructed wireless coverage. Access point trim can be easily swapped out for new trim if the access point brand or model is changed in the future.



Features

- Conveniently and quickly install wireless access points in suspended ceiling environment
- Galvanized steel back box fills opening behind access point, includes firestop foam for cable egress
- White, powdercoated, aluminum access point trim provides a professional finish

Specifications

- Ceiling mounts must be supported by the building structure
- White powder coated steel trim
- 18 ga. galvanized steel backbox

Configurations

- 1044-CCOAP Cisco 1700/2600/2700/3600/3700 access points
- 1044-AP110 Aruba Networks AP110 series access points
- 1044-AP220 Aruba Networks AP220 series access points
- 1044-AP210 Aruba Networks AP210 series access points
- 1044-AP200 Aruba Networks AP200 series access points
- Other access points, please contact your Oberon representative

Measurements *(Maximum values):*

- Height: 12.5 in.
- Width: 12.5 in.
- Depth: 2 in.
- Item Weight: 8 lbs.
- Shipping Weight: 9 lbs. {hide-if-empty Includes}

Includes

- (1) 12.5" x 12.5" x 2" deep galvanized back box
- (1) 18" x 23.75" ceiling tile bridge

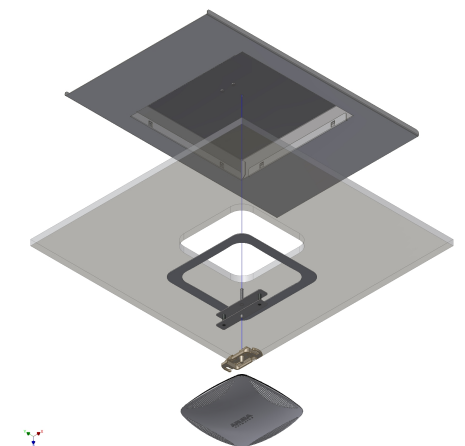

- (1) access point vendor specific white powder coated trim (See Configurations)
- (1) Universal access point mounting T-Bar
- (1) Firestop foam cable egress kit, large enough for 2 category 6A cables
- Installation Instructions

Documentation Links



[Spec Sheet](#)



[Installation Instructions](#)



[Customer Prints](#)