

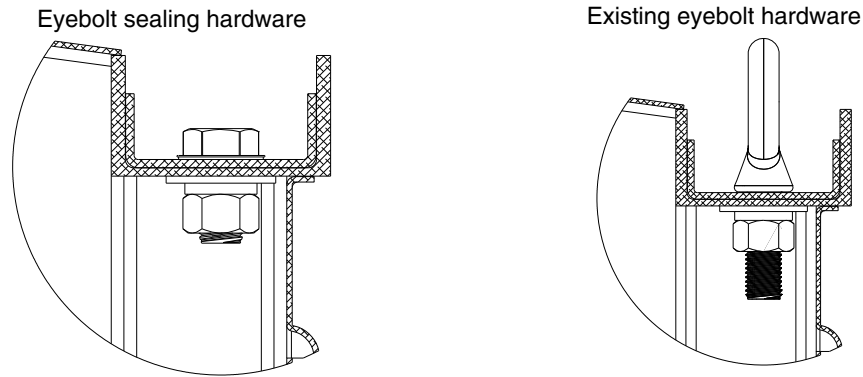





Eyebolt Replacement Kit (pn 1509250101)

About the Eyebolt Replacement Kit

The Eyebolt Replacement Kit contains the hardware for sealing the four eyebolt holes on the top of the walk-in sign.



Contents

Part #	Quantity	Picture	Description
61230709	4		Screw, 1-8 X2 Hex, SS
61620030	4		Nut, 1-8 Hex, SS
61820040	4		Washer, Flat, 1.062" ID X 2.5" OD X .136" THK, SS
61820041	4		Washer, Split-Lock, 1" SS
61820042	4		Sealing washer, 1.05" ID x 2" OD, Neoprene Bond, SS
1509610305A	1	N/A	Eyebolt Replacement Kit Instructions

Tools Required

You will need a 1 1/2-inch wrench to remove the existing eyebolts and attach the new hardware.

Installation instructions

WARNING! Hazardous voltage. Contact with high voltage may cause death or serious injury. Always disconnect power to unit prior to servicing.

1 Disconnect all power to the sign at the power source.

2 Remove existing eyebolts and hardware and replace with new hardware.

Notice: Do not allow existing hardware to fall in the walk-in enclosure or damage to internal components may occur.

Side view:
Two eyebolts are located on each end, one toward the front and one toward the back.

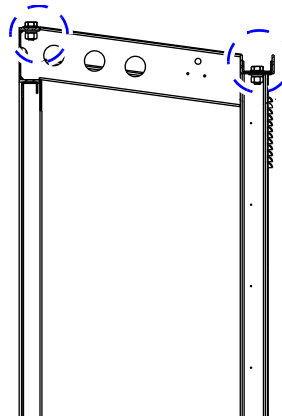

If necessary, use additional clear silicon (not provided) to seal holes.

