

# Rolling Counter Door Systems



Product Line

METAL CURTAIN  
INTEGRAL FRAME  
WOOD

SERIES

650	651	652	
655	656	657	658
	665		



INDUSTRY LEADING  
COMMERCIAL & INDUSTRIAL SOLUTIONS

# Rolling Counter Doors: Smart-Looking Solutions for Small-Opening Applications

---

## THE TURNKEY SOURCE FOR COMMERCIAL AND INDUSTRIAL SOLUTIONS AND SERVICE

---

Selection of Overhead Door products automatically includes the unequalled expertise and experience of Overhead Door Ribbon Distributors. Nationwide coverage by our over 400 Ribbon Distributors is unique in our industry—providing a single source for design and application consulting, installation, service and ongoing maintenance. Turnkey services to maximize the lasting value of your product choice. Your Overhead Door Distributor is also your only source for a full line of commercial and industrial door and operator systems specifically designed



for integrated applications. For over four generations, our Ribbon Distributors have been committed to providing commercial and industrial door solutions. Combined with Overhead Door product design and manufacturing superiority, our distributors are a proud part of the Overhead Door family, sharing our name, our Red Ribbon logo and our commitment to industry leading innovation and excellence.

---

## GENERAL FEATURES & BENEFITS

---

### A Rolling Counter Door for Any Environment

- Choice of aluminum, steel or stainless steel offers durable, attractive, and versatile solutions for retail and commercial/industrial applications and openings to 20' wide and 9' high (6096 mm and 2743 mm)
- Integral frame and sill counter doors in sizes up to 12¼" wide and 6' high (3759 mm and 1828 mm) provide the convenience of a factory-assembled unit and an attractive finished look
- Wood curtains in Douglas fir, red oak, white oak, birch, or exotic species for openings to 12' wide and 8' high (3658 mm and 2438 mm) complement interior design features

### Options Provide Design Flexibility and Simplify Operation

- Choice of curtain materials and a variety of finish options for enhanced design flexibility
- Motor operation option and an array of operator controls simplifies door operation (not available on integral frame and sill counter doors)

### Built to Last

- Top-quality materials, excellent field service and optional maintenance program contribute to extended door life, low maintenance costs and maximum productivity
- Up to 24-month limited warranty

---

## Up to 215 Powder Coat Finishes

---

**The Color Palette for Rolling Counter Doors** specifying from powder coat finishes in up to 215 colors is available from your Overhead Door Ribbon distributor. Color may also be matched to architect's specifications to best compliment the look of the facility.







Overhead Door Corporation's rolling counter doors provide a multitude of attractive solutions for smaller openings to 20' wide and 9' high (6096 mm and 2743 mm). Ideal for a host of applications in commercial, retail, corporate and professional environments, our comprehensive system of counter doors encompasses three basic door types — metal curtain, wood curtain, or integral frame and sill. Metal curtains — fabricated of aluminum, steel, stainless steel — are suitable for a variety of applications, and afford nearly unlimited design versatility, affordable good looks and optimal durability. Our integral frame and sill counter doors offer the convenience and precision assembly of a factory-welded unit, and provide an attractive, finished appearance for applications such as food service counters. Our line of natural wood counter doors features the warmth and beauty to lend unsurpassed elegance for applications in hotels, libraries, banks, churches, and offices.

*Installation and Service: Overhead Door Company of Dallas-Commercial*



# Rolling Counter Doors Selection Chart



Metal Curtain Rolling Counter Door

Rolling Counter		GENERAL SPECIFICATIONS											
	SERIES			Standard mounting	Standard operation	Curtain material				Frame material		Sill material	
		Standard Maximum width	Standard Maximum height			Painted steel	Stainless steel	Aluminum	Wood	Stainless steel		Stainless steel	
Metal Curtain (Pg. 4 – 7)	650	20' (6096 mm)	9' (2743 mm)	face of wall	push up	•							
	651	20' (6096 mm)	9' (2743 mm)	face of wall	push up		•						
	652	20' (6096 mm)	9' (2743 mm)	face of wall	push up			•					
Integral Frame and Sill (Pg. 8)	655	12'4" (3759 mm)	6' (1828 mm)	between jambs	push up			•		•		•	
	656	12'4" (3759 mm)	6' (1828 mm)	between jambs	push up			•				•	
	657	12'4" (3759 mm)	6' (1828 mm)	between jambs	push up		•			•		•	
	658	12'4" (3759 mm)	6' (1828 mm)	between jambs	push up	•						•	
Wood Curtain (Pg. 9 – 11)	665	12' (3658 mm)	8' (2438 mm)	face of wall	push up				•				

Information is subject to change. Please call your local Overhead Door distributor for special applications or if your application is not listed.



Integral Frame and Sill Rolling Counter Door

							AVAILABLE OPTIONS										
	Frame material	Guide	Painted steel	Stainless steel	Aluminum	Slat profile type	Standard finish	Lock	Electric operator	Crank	Cylinder lock	Wood species	Douglas Fir	Red oak	Birch	White oak	Exotic
			•		•	F-158	Primed paint	Interior Slide Bolt	•	•	•						
				•	•	F-158	No. 4 Finish Stainless Steel	Interior Slide Bolt	•	•	•						
					•	F-158	Clear Anodized Aluminum	Interior Slide Bolt	•	•	•						
						*	Clear Anodized Aluminum	Interior Slide Bolt		•	•						
	•					*	Clear Anodized Aluminum	Interior Slide Bolt		•	•						
						*	No. 4 Finish Stainless Steel	Interior Slide Bolt		•	•						
	•					*	Primed paint	Interior Slide Bolt		•	•						
						WS		Thumbturns	•	•	•	•	•	•	•	•	•

\*Integral Frame and Sill Slat



# Metal Curtain Rolling Counter Doors

## SERIES 650 651 652

### Technical Data

Application	Commercial, retail, corporate and professional environments. These doors are ideal for a host of small-opening applications where security is important. Common applications include concession areas, cafeterias, pharmacies, parts-storage areas, and ticket windows.
Mounting position	Face of wall, between jambs
Operation	Standard: Manual push up; Optional: Crank, Electric
Warranty	24-month limited

### Curtain

Max. standard width	20' (6096 mm)
Max. standard height	9' (2743 mm)
Slats	Interlocking flat profile slats with endlocks. Slat profile type F-158, fabricated of galvanized steel (650 Series); stainless steel (651 Series); aluminum (652 Series)
Finish	650 Series: galvanized steel primed with choice of baked-on polyester top coat in gray or tan 651 Series: No. 4 finished stainless steel 652 Series: Aluminum, clear anodized; Option: bronze anodized; Option: powder-coat paint finish in 197 standard colors, or color-matched to specification

### Other

Guides	Standard: extruded aluminum Option: 11-gauge roll-formed steel guides (650/652 Series); stainless steel guides (651 Series)
Counterbalance	Helical torsion springs housed in a steel tube or pipe barrel
Brackets	Steel plate to support curtain, counterbalance, and hood
Hood	650 Series: galvanized steel; 651 Series: stainless steel; 652 Series: aluminum
Locking Options	Standard: Interior slide bolt Optional: cylinder lock <ul style="list-style-type: none"> <li>Vision lites</li> <li>Perforated slats</li> <li>Fenestrated slats with uniformly spaced openings of 5/8" x 3" (16 mm x 76 mm)</li> <li>PowderGuard™ premium powder coat paint finish in 197 standard colors, or color-matched to specification</li> <li>PowderGuard™ Zinc and PowderGuard™ Weathered finishes</li> </ul>

### Slat Data

F-158 Slat

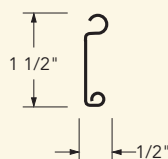

Series	Slat	Opening Width	Standard
650	F-158	Thru 20'0" (6096 mm)	22 ga.
651	F-158	Thru 20'0" (6096 mm)	22 ga. ss
652	F-158	Thru 20'0" (6096 mm)	aluminum

Distinguished by their metal slat curtain finish, the 650, 651 and 652 Series rolling counter doors are designed to fit openings to 20' wide and 9' high (6096 mm and 2473 mm). Finishes available include galvanized, painted steel (650), No. 4 finish stainless steel (651), and clear anodized aluminum (652). These doors are ideal for a host of small-opening applications where security is important and a non-rated door\* is appropriate. Common applications include concession areas, cafeterias, pharmacies, parts-storage areas, and ticket windows.

### Door Selection Guide

	Curtain	Slat	Finish	Hood	Guides	Bottom Bar
<b>Series 650</b>	Galv. steel	F-158	Gray or Tan	Galv. steel	Aluminum/Primed Steel	Primed Steel
<b>Series 651</b>	Stainless	F-158	#4	Stainless	Aluminum/Stainless	Stainless
<b>Series 652</b>	Aluminum	F-158	Clear Anodized	Aluminum	Aluminum	Aluminum

### The color palette for rolling steel products

PowderGuard™ finish offers full spectrum of up to 215 colors as well as color matching to specification.

### Headroom Clearance Dimensions

Dimension A F-158 Slat	
Opening Height	A Dimension – headplate width
Thru 5'0" (1524 mm)	9 1/2" (241 mm)
Thru 8'4" (2540 mm)	11 1/2" (292 mm)

\*Ask our distributors for more information on our fire-rated door offering.



### Door Clearance Elevations

#### Face-of-Wall Mounted

Operation: Push-up, chain hoist or electric.\*

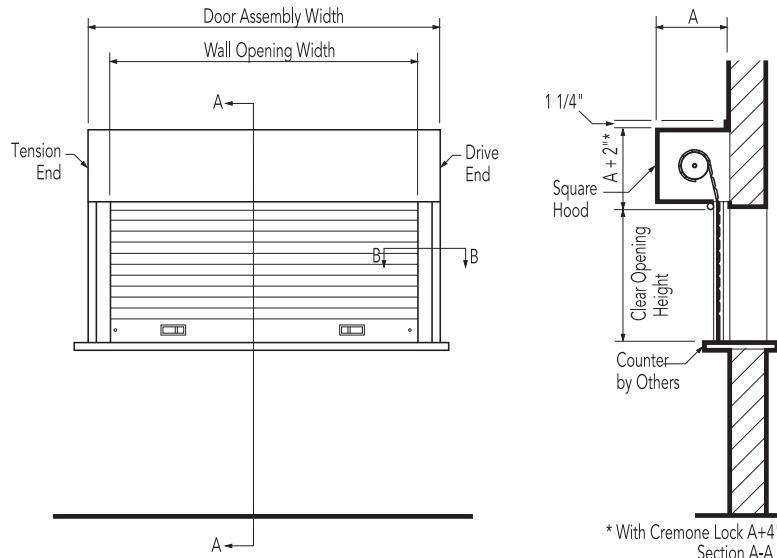

\*Operator details on Page 12

#### Between Jambs Mounted

Operation: Push-up, chain hoist or electric.\*

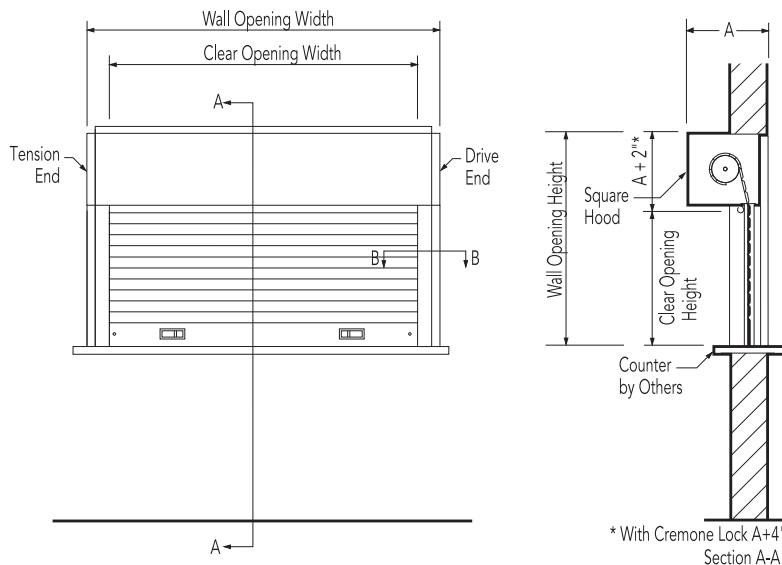

\* With Cremone Lock A+4"  
Section A-A

**Dimension A** Series 650, 651 and 652

Opening Height	A Dimension – headplate width
0'0" to 5'3"	9 1/2" (241 mm)
5'3" to 9'0"	10 1/2" (267 mm)

# Metal Curtain Rolling Counter Doors

**SERIES** 650 651 652

## Guides

### Face-of-Wall Mounted

#### Rolled Steel/Stainless Steel

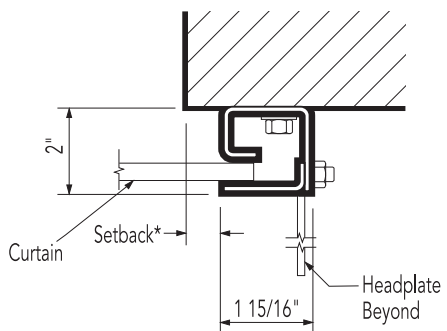

\*15/16" for Masonry, Wood studs, or Steel studs.  
1/4" for Steel jambs.

#### Extruded Aluminum

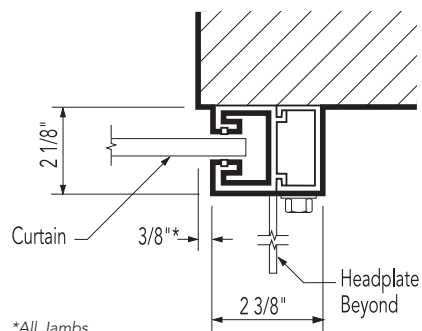

\*All Jambs

#### Extruded Aluminum – RTM Operator

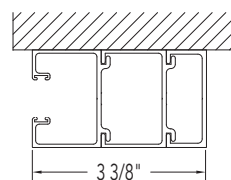





## Guides

### Between Jambs Mounted

#### Extruded Aluminum Guides

**Push-up: Tension & Drive Side**  
**Crank or Electric:**  
**Tension Side Only**

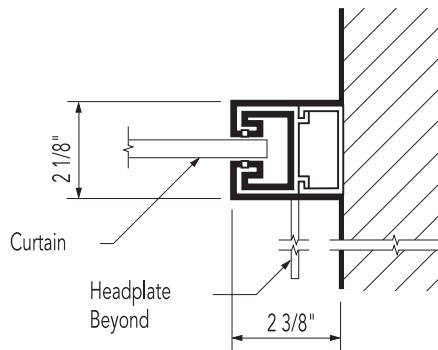

**Crank or Electric:**  
**Drive Side Only**

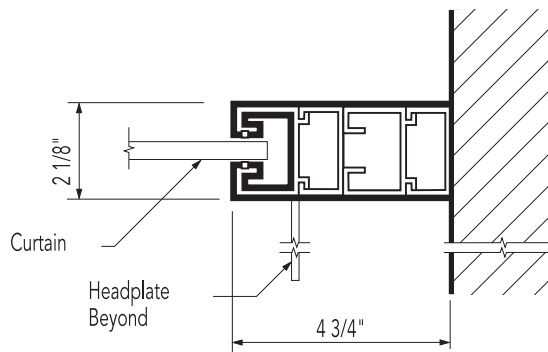

#### RTM Operator

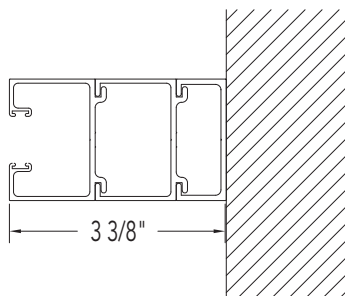

#### Rolled Steel/Stainless Steel

**Push-up: Tension Side**  
**Push-up: Tension & Drive Side**  
**Crank or Electric:**  
**Tension Side Only**

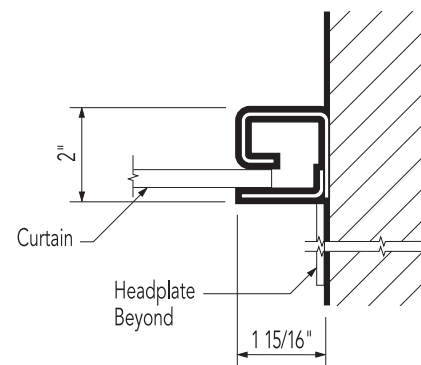

**Crank or Electric:**  
**Drive Side Only**

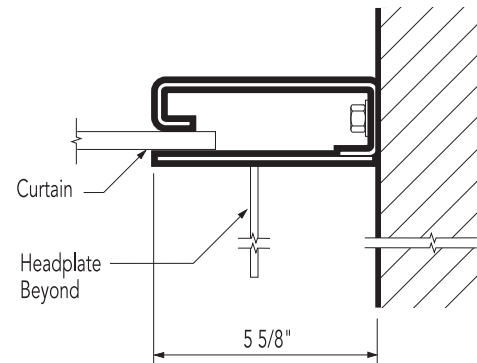

# Integral Frame Rolling Counter Doors

## SERIES 655 656 657 658

### Standard Features At a Glance

Max. standard width	12'4" (3759 mm)
Max. standard height	6' (1828 mm)
Curtain	.051" (1 mm) aluminum slats (655 and 656 Series). Interlocking 22-gauge stainless steel slats (657 Series). Interlocking 22-gauge galvanized steel slats (658 Series).
Integral frames	16-gauge primed steel or stainless steel
Sill	14-gauge stainless steel
Hood	Stainless steel (655 and 657 Series). Primed steel (656 and 658 Series)
Mounting	Between jambs
Operation	Push-up
Lock	Interior slide bolt
Warranty	15-month

### Options

- Crank operation
- Cylinder lock

### Slat Data

#### Integral Frame and Sill Slat

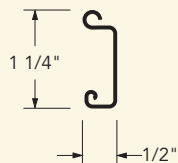

Maximum Clearance Height = 4'0"

Series	Opening Width	Slat	Frame
655	Thru 9'0" (2743 mm)	Aluminum	Stainless Steel
656	Thru 9'0" (2743 mm)	Aluminum	Galvanized
657	Thru 9'0" (2743 mm)	22 ga. ss	Stainless Steel
658	Thru 9'0" (2743 mm)	22 ga.	Galvanized

Slats are galvanized and painted or stainless steel (ss).

The 655, 656, 657 and 658 Series combine an attractive finished appearance with the convenience of a factory-assembled unit. These non-rated doors\*\* feature a high-quality 16-gauge steel or stainless steel frame, hood and fascia complemented by a 14-gauge sill. Available to fit openings up to 12'4" wide and 6' high (3759 mm and 1828 mm), these rolling counter doors have a variety of applications, including food service areas.

### Door Selection Guide

	Frame	Curtain	Sill	Hood
 <b>Series 655</b>	Stainless Steel	Aluminum	Stainless Steel	Stainless Steel
<b>Series 656</b>	Primed Galv. Steel	Aluminum	Stainless Steel	Primed Galv. Steel
<b>Series 657</b>	Stainless Steel	Stainless Steel	Stainless Steel	Stainless Steel
<b>Series 658</b>	Primed Galv. Steel	Primed Galv. Steel	Stainless Steel	Primed Galv. Steel

### Door Clearance Elevations

Operation: Push-up or crank.

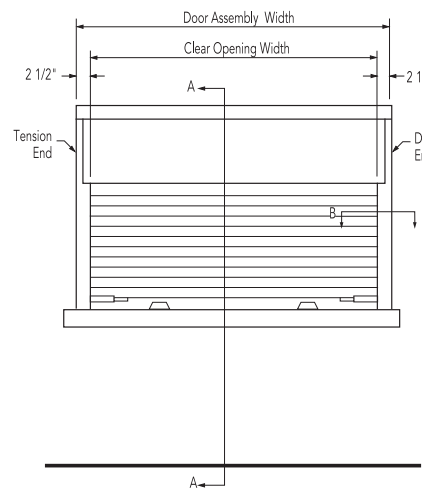

\* 5" for crank-operated doors

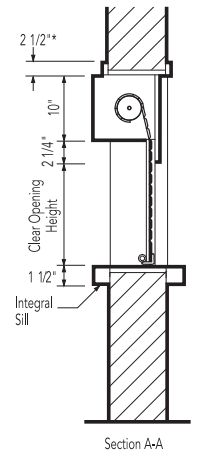

### Jamb Section

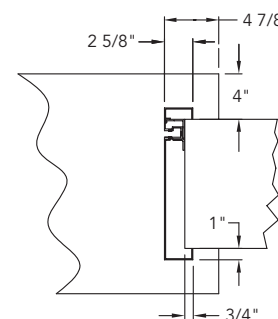

Note: This unit is designed to be installed as wall is being built. Refer to Overhead Door's Architectural Design Manual [www.overheaddoor.com/adm/base.html](http://www.overheaddoor.com/adm/base.html) or your local Overhead Door distributor for a unit designed for existing openings.



### Standard Features At a Glance

Max. standard width	12' (3658 mm)
Max. standard height	8' (2438 mm)
Curtain	Red oak (Standard)
Slats	Wood slats, 1 3/4" (16 mm) high by 1/2" (13 mm) thick
Finish	Unfinished
Guides	Wood to match slats
Bottom bar	Wood to match slats
Mounting	Face of wall, between jambs
Operation	Push-up
Lock	Thumbturns
Warranty	15-month limited

### Options

- Crank operation
- Electric operation
- Additional wood species: Douglas fir, white oak, birch, or exotic
- Hood in wood to match slats or aluminum
- Aluminum guides
- Cylinder lock

### Slat Data

#### Wood Slat

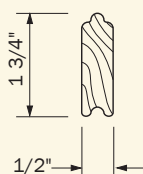

#### Dimension A

Opening Height	A Dimension – headplate width
Thru 4'6" (1370 mm)	10" (254 mm)
Thru 6'4" (1930 mm)	11" (279 mm)
Thru 8'4" (2540 mm)	13" (330 mm)

The 665 Series offers the richness of natural wood to enhance the beauty of any application. Manufactured of high-quality wood — in Douglas fir, red oak, white oak, birch or a material you specify — these doors are ideal for use in hotels, banks, churches, libraries, offices, restaurants, and schools.

### Guides

#### Face Mounted Wood Guide

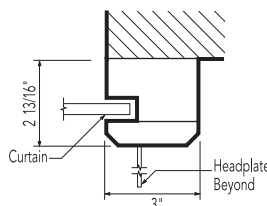

#### Face Mounted Aluminum Guide

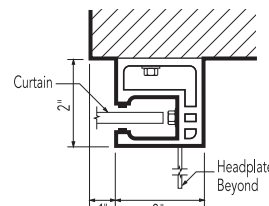

#### Between Jambs Wood Guide

**Push-Up Operation:**  
Tension & Drive Side  
**Crank or Electric Operation:**  
Tension Side Only

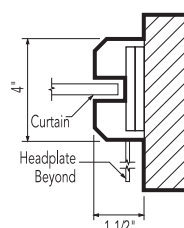

#### Between Jambs Aluminum Guide

**Push-Up Operation:**  
Tension & Drive Side  
**Crank or Electric Operation:**  
Tension Side Only

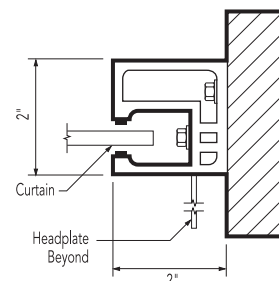

#### Between Jambs Wood Guide

**Crank or Electric Operation:**  
Drive Side Only

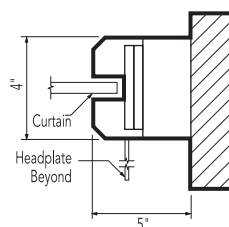

#### Between Jambs Aluminum Guide

**Crank or Electric Operation:**  
Drive Side Only

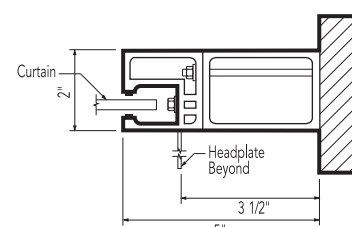



## Wood Curtain Rolling Counter Doors

**SERIES 665**

*Rolling Wood Counter Door*





### Door Clearance Elevations

#### Face-of-Wall Mounted

Operation: Push-up, crank or electric

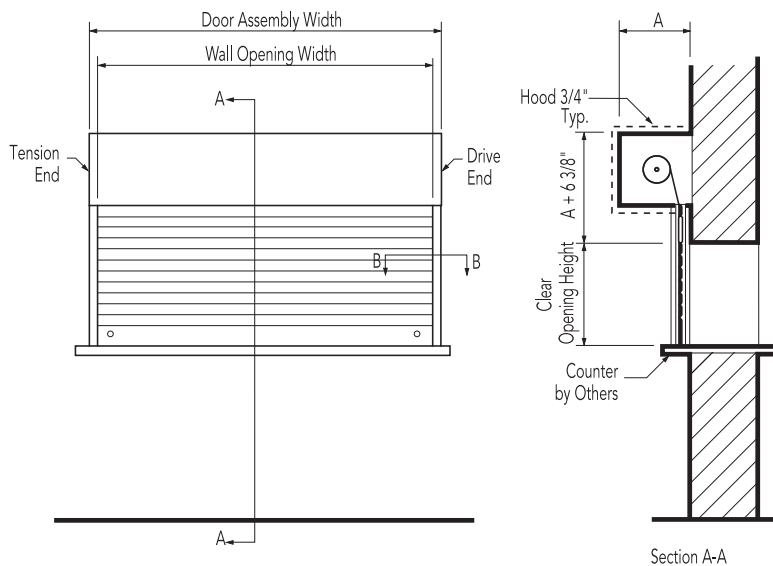

#### Between Jambs Mounted

Operation: Push-up, crank or electric

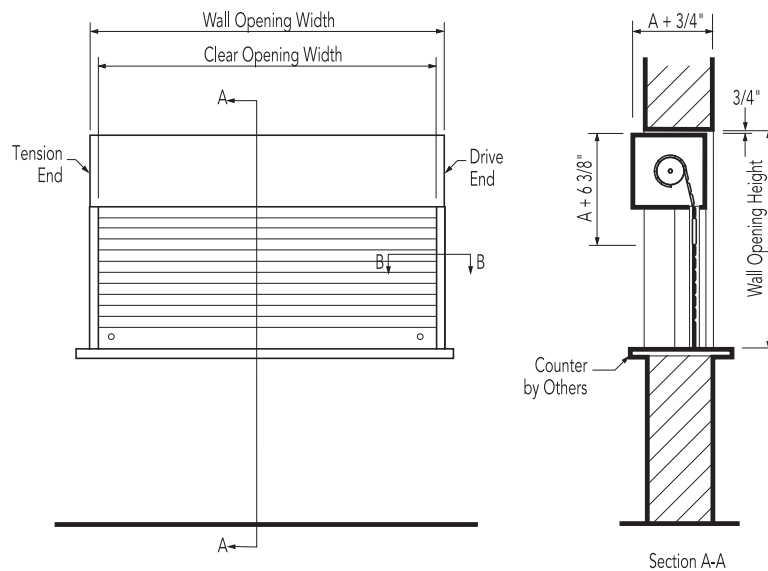

#### Dimension A Series 665

Opening Height	A Dimension – headplate width
0'0" to 4'4"	9 1/2" (241 mm)
4'4" to 6'4"	10 1/2" (267 mm)
6'4" to 8'0"	14" (356 mm)

---

## Operator Control Options

---

- Entrapment protection: electric sensing edge

---

## Safety Recommendations

---

Overhead Door Corporation strongly recommends the use of interlock switches, and an electric safety edge for all electrically operated rolling service doors. We recommend a self-monitoring, electric sensing edge.

### Entrapment Protection

The installation of an external reversing device for all electrically operated commercial doors is recommended. If a sensing edge or other reversing device is not installed, a constant-contact control switch must be used to close the door. We recommend a self-monitoring, electric sensing edge or photo cells required for all momentary contact applications.

Overhead Door Corporation offers the broadest line of electric operators to suit new construction and retrofit applications, as well as unusual or special requirements. Manufactured by Overhead Door Corporation to meet the exacting performance requirements of Overhead Door's upward-acting doors, our ribbon branded operators afford precise control of door action for years of trouble-free operation.

In order to improve safety and enhance door and motor life, industry quality assurance guidelines recommend the choice of a single manufacturer for both door and operator applications. Overhead Door Corporation is the only national manufacturer of a full line of commercial and industrial doors and operators specifically designed for integral applications.

---

## Operator Models

---

### Model CDX™

Model CDX™ is a gear-reduced commercial operator with a 1/2 HP motor. The CDX™ operator may be used for doors up to 140 sq. ft. (13006 sq.mm). Mounting is front-of-hood only.



### Model RMX®

Model RMX® is an advanced medium-duty operator. It is designed for quicker installation and hassle-free operation and operates doors up to 14' (4267 mm) in height and 620 pounds (282 kg). It is available as a trolley-type or side-mounted unit.



### Model RSX®

Model RSX® is a standard duty commercial operator designed to operate doors up to 24' (7315 mm) in height and 1450 pounds (657 kg) in weight. It offers unique features like LimitLock™, SuperBelt™, dual frequency radio system and 16 digit menu setup.



### Model RTM

Model RTM is a tubular motor designed for counter doors. Mounting is in the barrel only.







## Mounting Details

### Model RMX®/RSX® For 650/651/652 and 665 Series doors

#### Wall Mounted (Above Shaft)

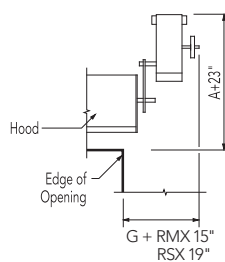
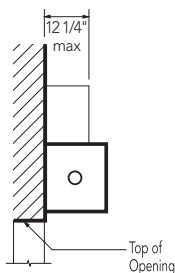

#### Wall Mounted (Below Shaft)

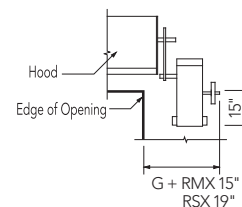
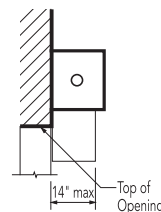

Note:  
For "A" and "G" dimensions, refer to Headroom and Guide Clearance Dimension charts applicable to door type selected.

### Model CDX™ For 650/651/652/665 Series doors

#### Front-of-Hood Mounted\*

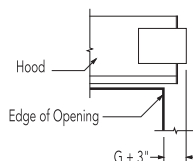
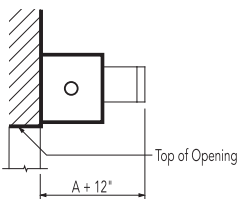

Note:  
For "A" and "G" dimensions, refer to Headroom and Guide Clearance Dimension charts applicable to door type selected.  
\* Front-of-Hood mounted also available on between jambs mounted doors.

### Model RTM

#### Barrel Mounted

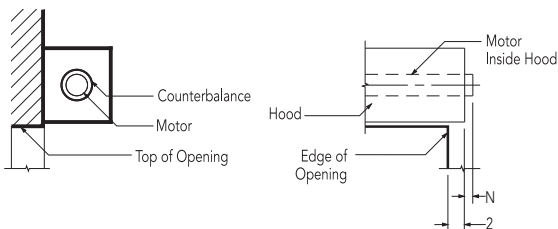

Note:  
N = 2" without manual override.  
N = 3 1/2" with built-in manual override.  
Consult factory for project application. Operator models have height and torque limits.

---

## The Original, Innovative Choice for Unequalled Quality and Service

---

Overhead Door Corporation pioneered the upward-acting door industry, inventing the first upward-acting door in 1921 and the first electric door operator in 1926. Today, we continue to be the industry leader through the strength of our product innovation, superior craftsmanship and outstanding customer support, underscoring a legacy of quality, expertise and integrity. That's why design and construction professionals specify Overhead Door Corporation products more often than any other brand.

The Overhead Door Red Ribbon is a mark of quality that also reflects the pride we take in the people who support our products. Our family of over 400 Overhead Door Distributors across the country not only share our name and logo, but also our commitment to excellence. Your Overhead Door Distributor will work with you in a consultative role to ensure that product selections achieve your design and application requirements — in addition to offering expert installation, professional field service and ongoing maintenance. From project design and manufacturing to installation and service, the Overhead Door Red Ribbon is your guarantee of genuine quality and turnkey service excellence.

**Together with our distributors, we offer comprehensive technical information and resource materials to support your project, including:**

- Architectural Design Manual – a comprehensive guide to selecting, specifying and detailing all commercial and industrial Overhead Door products can be found at [www.OverheadDoor.com/ADM/base.html](http://www.OverheadDoor.com/ADM/base.html)
- Operation & Maintenance Manual – detailed product information, customized for your project, to ensure reliable, long-life door system operation
- Custom application and technical assistance through ordering plants' customer service and technical services respectively
- Visit our Architect's Corner at [www.OverheadDoor.com](http://www.OverheadDoor.com)



Advanced Rolling Steel Door  
RapidSlat



Thermacore® Sectional Doors



Rolling & Side Folding  
Security Grilles & Closures



Rolling Service Doors



Commercial Operators

Today, Overhead Door Corporation – along with our Horton Automatics division, for automated pedestrian entrances – is recognized as the leading, single-source manufacturer of integrated door and operator systems for commercial, industrial and residential applications. With multiple manufacturing locations throughout the United States, a state-of-the-art TREQ (Testing, Reliability, Engineering, and Quality) Center for design and engineering, and a national network of authorized Overhead Door Distributors, our capabilities are leading-edge and our field service and technical support second to none. Built best and backed best, Overhead Door is the industry's leading choice for quality that shows and lasts.

**To talk with the Overhead Door Distributor nearest you, call 1-800-929-DOOR.**

### Overhead Door Corporation

2501 S. State Hwy. 121 Bus., Suite 200

Lewisville, Texas 75067

1-800-929-DOOR

[www.OverheadDoor.com](http://www.OverheadDoor.com)



INDUSTRY LEADING  
COMMERCIAL & INDUSTRIAL SOLUTIONS

The Overhead Door Corporation family of quality commercial and industrial products includes:



A part of Sanwa Holdings Corporation