

# PREMIER STEEL GUTTER SYSTEM™

Superior Gutters Made Simple



Tel: (814) 455-7430 | Fax (814) 464-8838 | Email: sales@slateandcopper.com | Web: www.premiersteelgutters.com

## Ground Level Elbow with reinforced bead 72° degree

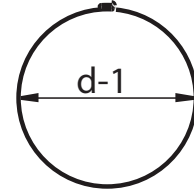
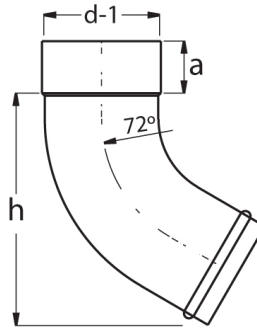

Size	d-1	a	h
3.5"	3.1"	1.5"	6.00"
5"	4.0"	1.5"	7.50"

24 Gauge Zinc Magnesium Steel and sprayed with a proprietary scratch and fade resistant paint.

### Beaded Ground Level Elbow 72°

Color	Part #	3"	4"	5"
WHITE		WTZ372B	WTZ472B	n/a
DARK BRONZE		DBZ372B	DBZ472B	n/a
BLACK		BKZ372B	BKZ472B	
DARK CHARCOAL		DCZ372B	DCZ472B	
NATURAL GRAY METALIC		NGZ372B	NGZ472B	
UNPAINTED G-90 GALVANIZED		UZ372B	UZ472B	



Date	Invoice#	Project	Company	Architect