

# CO<sub>2</sub> Component Description



## Pneumatic Detection System Tubing Fittings

Effective: April 2002

K-81-7060



3/16" TUBING NUT  
P/N 2007648



3/16" UNION WITHOUT NUTS  
P/N 5281-0360

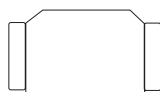

3/16" TEE WITHOUT NUTS  
P/N 5281-0370

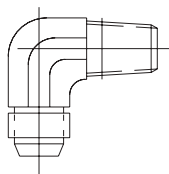

MALE ELBOW  
1/8" NPT X 5/16" TUBING  
P/N 6992-0503

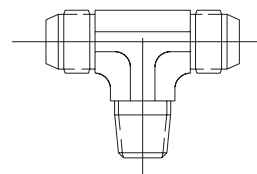

MALE BRANCH TEE  
1/8" NPT X 5/16" TUBING  
P/N 6992-0505

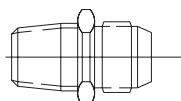

MALE CONNECTOR  
1/8" NPT X 5/16" TUBING  
P/N 6992-0501

**MATERIAL: BRASS**  
**ALL FITTINGS S.A.E. INVERTED FLARE**

This literature is provided for informational purposes only. KIDDE-FENWAL, INC. assumes no responsibility for the product's suitability for a particular application. The product must be properly applied to work correctly. If you need more information on this product, or if you have a particular problem or question, contact KIDDE-FENWAL INC., Ashland, MA 01721. Telephone: (508) 881-2000

Kidde Fire Systems  
400 Main Street  
Ashland, MA 01721 USA  
Tel: (508) 881-2000  
Fax: (508) 881-8920  
<http://www.kiddefiresystems.com>