

Panel Overlap Detail

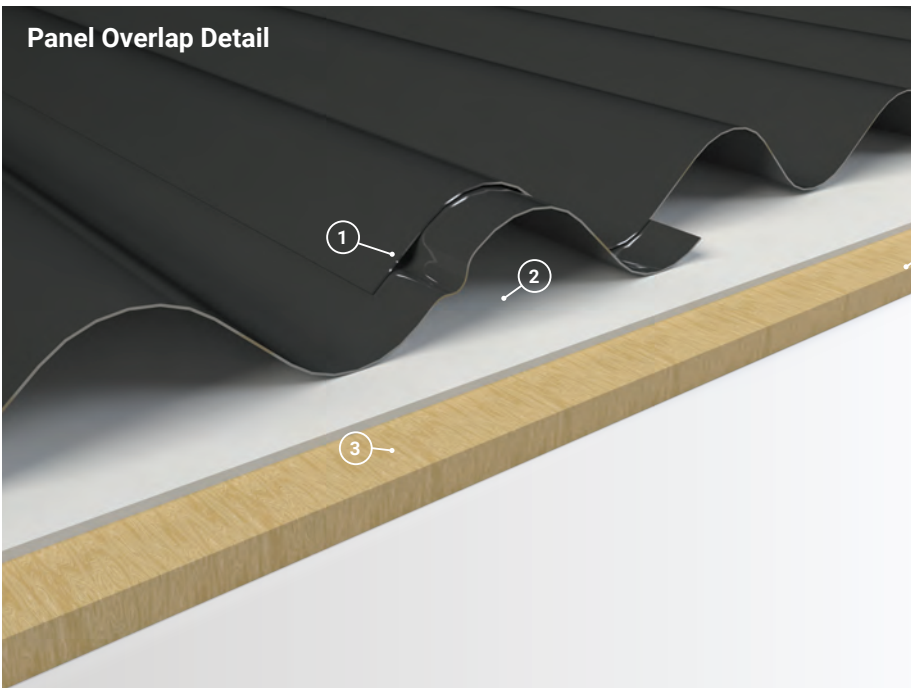

1. **Anti-Siphon Groove:** In order to help prevent water from penetrating the overlap, the anti-siphon groove creates an internal air gap at the panel overlap.
2. **Underlayment:** High Temp Ice & Water shown. For use at eaves and valleys.
3. **Substrate:** Plywood substrate material shown

Roof Coverage	33 5/8"
Wall Coverage	33 5/8"
Panel Gauges	26*, 29*
Fastener Options	Exposed
Panel Length	3' to 40'
Rib Height	0.75" at 2.88" Centers
Roof Slope	Minimum 1:12 or Greater with Mastic
Impact Rating	UL 2218
Wind Uplift Rating	ASTM 1592, UL 580
Warranty	Based on Paint System
For more information	1.877.783.3568

* Grade 80

Version 3.2, 4/2018

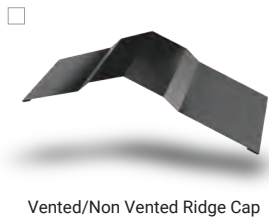

Vented/Non Vented Ridge Cap



Hip Ridge

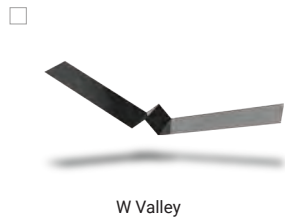

W Valley



Transition - High to Low



Transition - Low to High

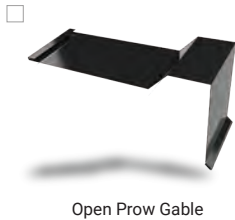

Open Prow Gable



Closed Prow Gable



4" Mini Gable

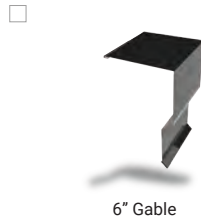

6" Gable



Snowbreak



4" Eave



6" Eave



Style D Eave



J Trim



Double J Trim

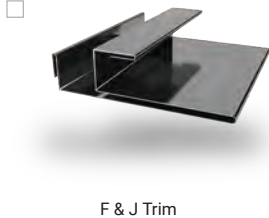

F & J Trim

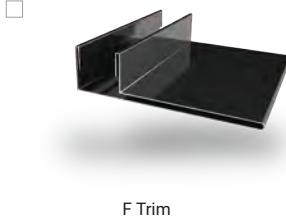

F Trim



Head Trim



Side Wall



End Wall

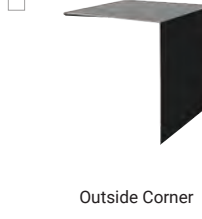

Outside Corner



Inside Corner



Door Cap



Base Drip



Double Base Drip



Broom Base



Wainscot



Fascia

Additional Trim Profiles Available By Request

