

- HOSEBED CAPACITIES
- ① 1500' OF 2.50" D.J. POLYESTER HOSE
 - ② 400' OF 1.50" D.J. POLYESTER HOSE
- (1) 0.25" SINGLE SHEET HOSEBED DIVIDER

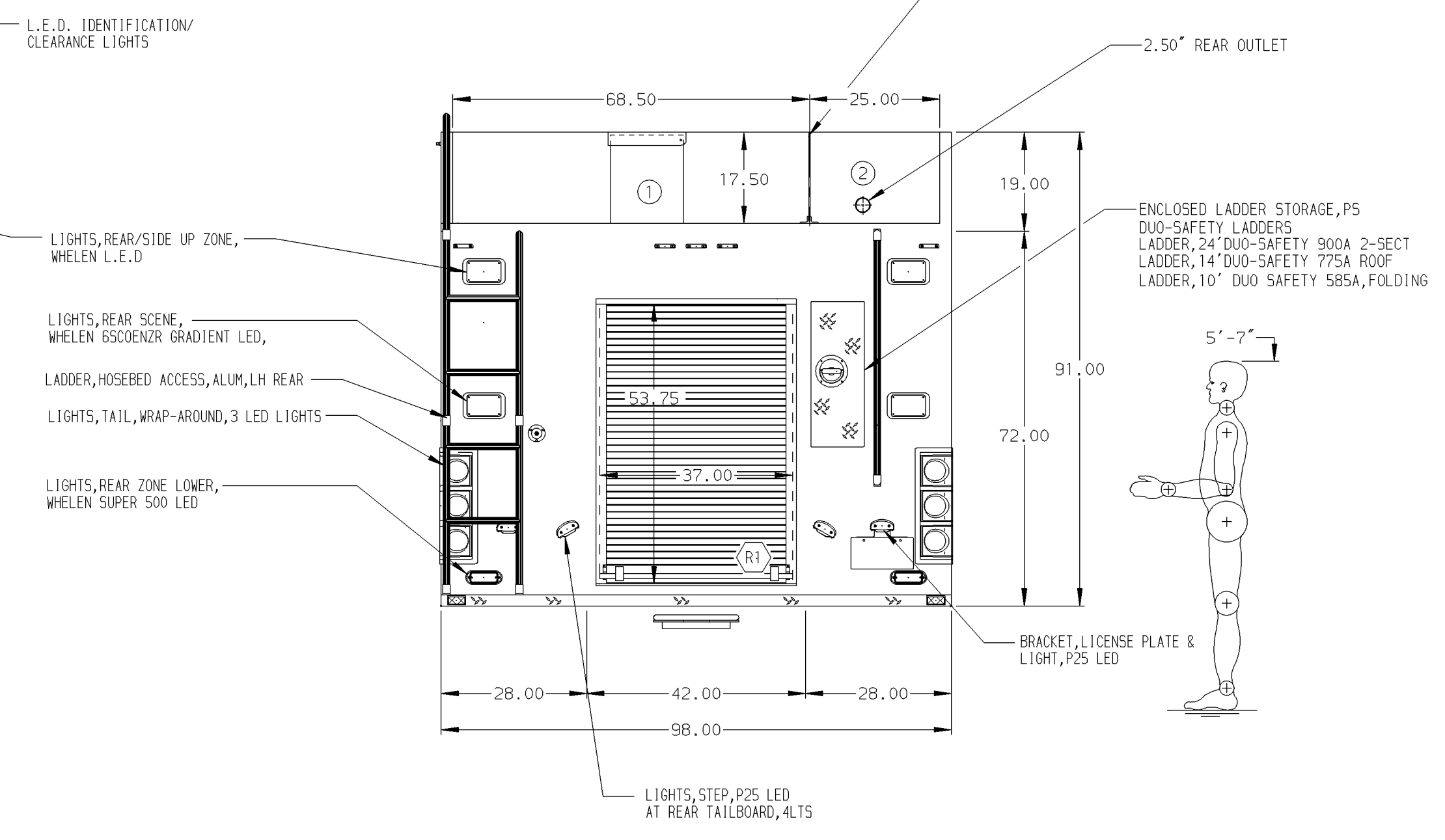
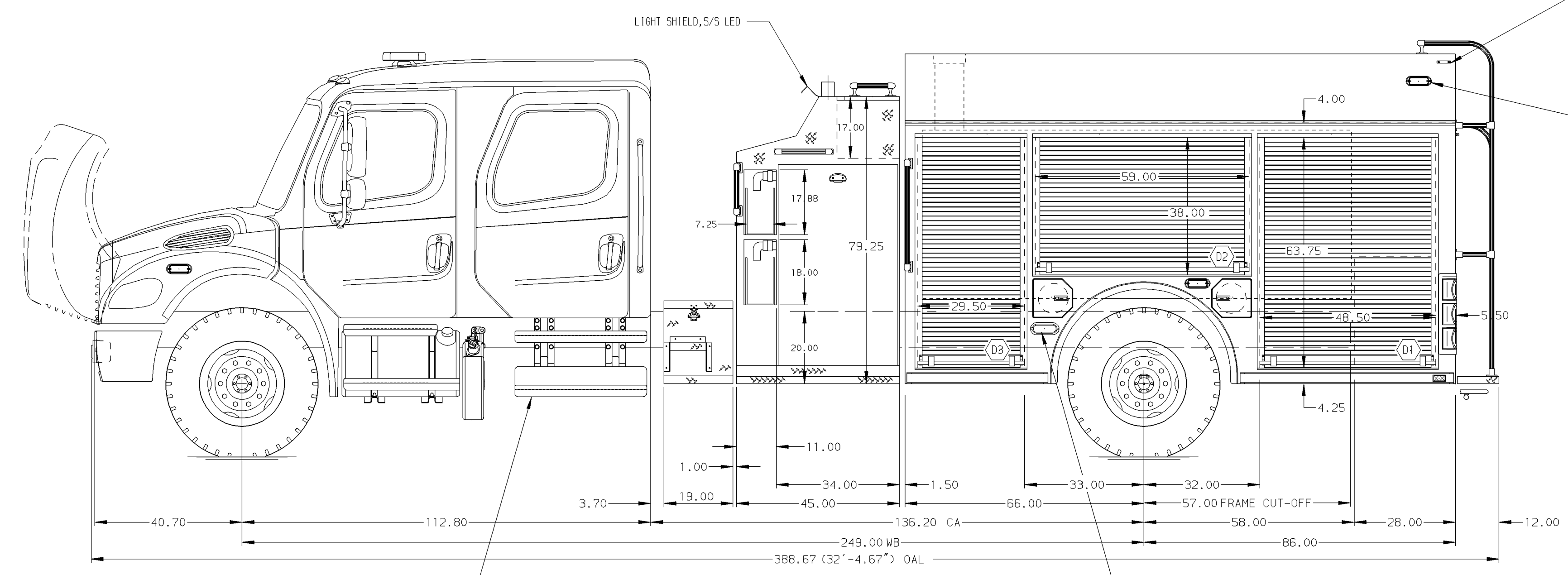

ALUMINUM BODY

FUEL TANK, 50GAL, ALUM, LH ONLY, FL DEF TANK 6.0 GALLON, LH, FL STEPS, CAB, AS SUPPLIED BY FREIGHTLINER

NOTE
DIMENSIONS SHOWN ARE APPROXIMATE AND ARE SUBJECT TO MINOR DEVIATIONS AS MAY OCCUR OR BE NECESSARY IN CONSTRUCTION. MINOR DETAILS NOT SHOWN.

1. CTF WHEEL CHOCKS AND MOUNTING BRACKETS
2. EXHAUST SYSTEM, HORIZONTAL, RH STEP MOUNTED DPF/SCR, 2013 FL
3. PERIMETER SCENE LIGHTS LOCATED PER SHOP ORDER
4. BATTERY CHARGING RECEPTACLE LOCATED ON THE DRIVER SIDE PUMP PANEL
5. AIR INLET LOCATED LOCATED DS PUMP PANEL
6. CONCEPTUAL DRAWING STAGE

REV	DATE	BY	CH	CHASSIS DATA	TITLE
26NOV14	JCH	CAG		DATA	
28JUL14	DTA	CAG		MAKE	
08MAY14	DTA	DTA		FL	
13MAR14	DTA	CAG		MODEL	
				M2-106	

PIERCE MANUFACTURING INC.
BRADENTON, FLORIDA

JOB NO. SF-1204

SCALE 1:24

DATE

DRAWN BY	DTA	DATE	19FEB14
CHECKED BY	CAG	DATE	20FEB14
SHEET SIZE	D	SHEET NO.	1 OF 1

1250-D-1000 1000 GAL WATER, 152" FULL HT FRONT & REAR 34" TOP MOUNT PH, (2) SPEEDLAYS & LADDERS THRU TANK

FOR PIERCE MANUFACTURING INC. BRADENTON, FLORIDA

DWG NO. **SF-1204AD**