

HOSEBED CAPACITIES  
 ① -1000' OF 5.00\"/>

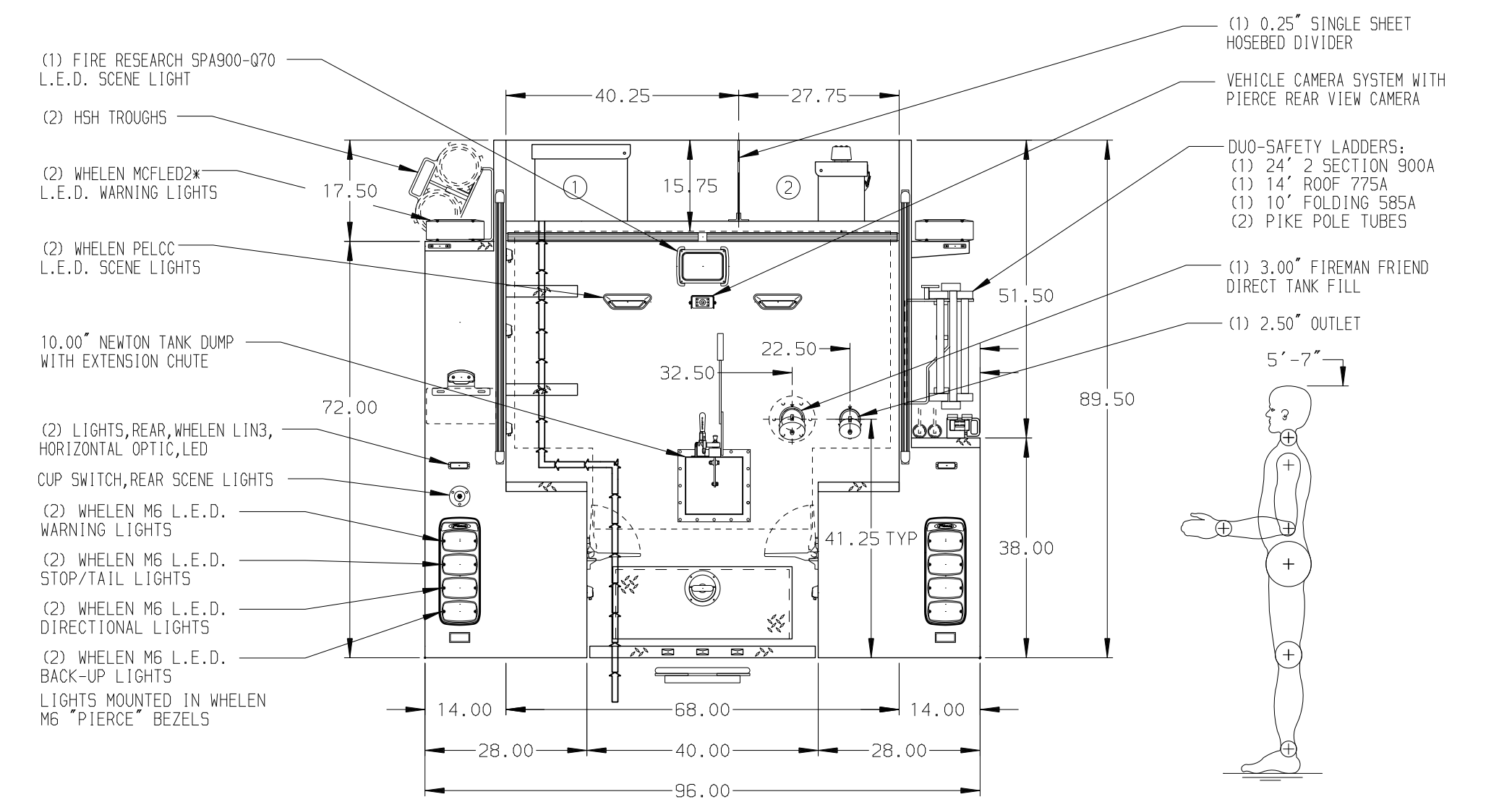
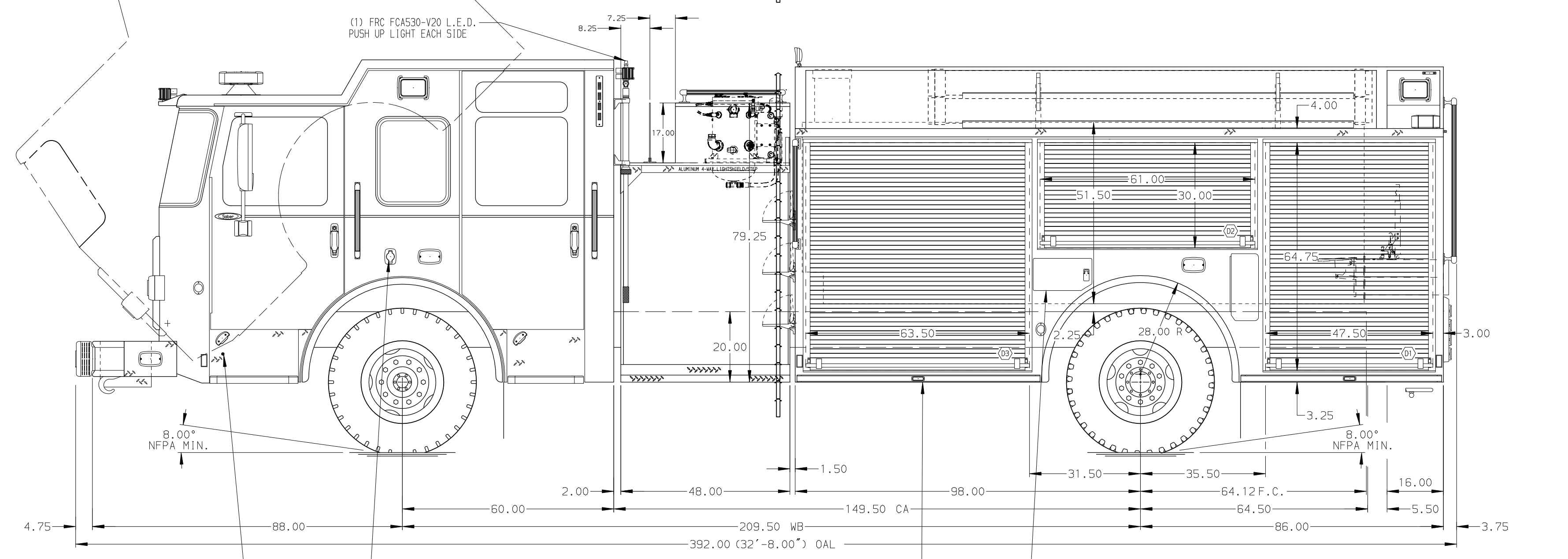

**ALUMINUM BODY**

**NOTE**  
 DIMENSIONS SHOWN ARE APPROXIMATE AND ARE SUBJECT TO MINOR DEVIATIONS AS MAY OCCUR OR BE NECESSARY IN CONSTRUCTION. MINOR DETAILS NOT SHOWN.

		JOB NO.	31307
		SCALE	1:24
TITLE 1500-D-1800P, 1780GAL WATER, 20 GAL FOAM, 184\"/>		DATE	
		DRAWN BY	AMI
FOR RENO VOLUNTEER FIRE DEPARTMENT RENO, TEXAS		CHECKED BY	CDU
		SHEET NO.	1 OF 1
REV	DATE	BY	CH
25AUG17	JLA	DDR	
11AUG17	JLA	DDR	
SABER FR		D	

31307AD