

120.50  
(10'-1")  
APPROX  
O.A.H.

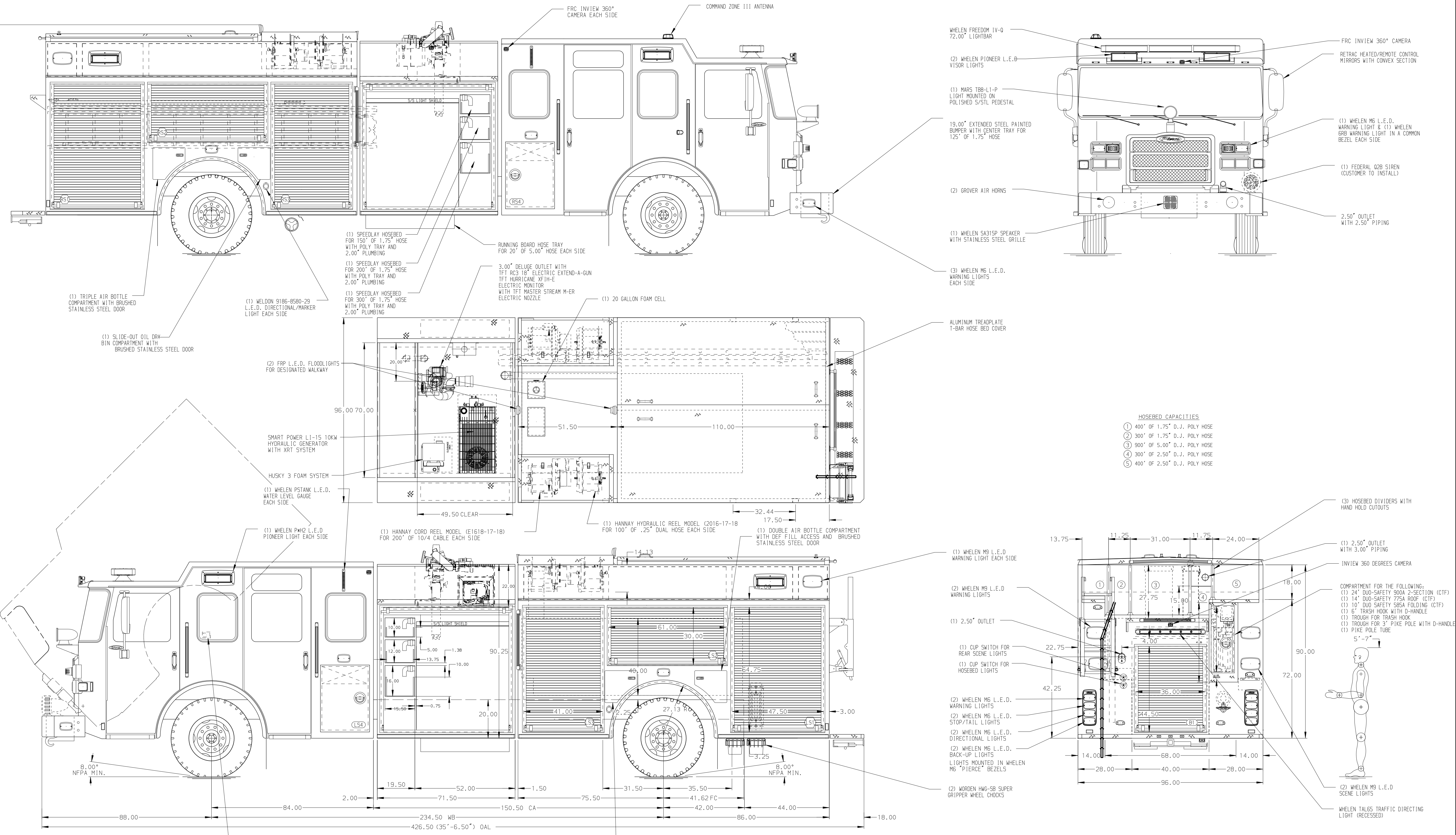

**ALUMINUM BODY**

**NOTE**  
DIMENSIONS SHOWN ARE APPROXIMATE AND ARE SUBJECT TO MINOR DEVIATIONS AS MAY OCCUR OR BE NECESSARY IN CONSTRUCTION. MINOR DETAILS NOT SHOWN.

- ONSPOT AUTOMATIC TIRE CHAINS TO BE PROVIDED AT REAR
- VOGEL LUBE SYSTEM PUMP LOCATED PER SHOP ORDER
- BATTERY CHARGER LOCATED IN COMPARTMENT BEHIND DRIVER SEAT RISER
- DUAL L.E.D. LIGHT STRIPS LOCATED IN HOSE BED
- DRIP PAN GUARD FOR ROLL-UP DOOR LOCATED ON ALL (9) ROLL UP DOORS
- ONE ADJUSTABLE SLIDE-OUT TRAY IN COMPARTMENT T8D
- ONE FULL WIDTH/DEPTH ADJUSTABLE SHELF LOCATED IN COMPARTMENT T8D
- ONE SMOOTH ALUMINUM TOOL BOARD WITH TRACKS IN COMPARTMENT L51, L52, L53, R51, R52, & R53
- DRAIN HOLE WITH SPLASH GUARD LOCATED REARWARD IN ALL (8) COMPARTMENTS
- ALL BODY COMPARTMENTS WITH LOUVERS SHALL HAVE A REMOVABLE FILTER
- HORIZONTAL EQUIPMENT MOUNTING TRACKS IN COMPARTMENT T8D

- CIRCUIT BREAKER PANEL IN COMPARTMENT L5
- AIR INLET WITH KUSSEMAIL AIR EJECT LOCATED IN DS STEP WELL
- AIR OUTLET WITH SHUT OFF VALVE LOCATED ON DS PUMP PANEL
- ONE HANNAY MODEL 2016-17-18 HYDRAULIC REEL LOCATED IN HOSEBED ARE WITH A CAPACITY FOR 100' OF .25" DUAL HOSE
- LITTLE GIANT LADDER MODEL 17 IN COMPARTMENT L51, B1, & R51

		JOB NO.	32575
		SCALE	1:24
<b>TITLE</b> 2000-D-770P 750 GAL WATER W/20 GAL FOAM, 161" BODY FH FDLER, (2) XLAYS, LADRS BTWN S/S AND TANK, DELUGE		DATE	
		DRAWN BY	MMF
<b>FOR</b> BENNINGTON FIRE DEPARTMENT BENNINGTON, NEBRASKA		CHECKED BY	NPE
		DATE	28JUN18
<b>DWG NO.</b> 32575AD		SHEET SIZE	
		SHEET NO.	1 OF 1

REV	DATE	BY	CH	ENFORCER
12MAR19	MMF	RWA		CHASSIS DATA
14JAN19	MMF	PJP		MAKE
03JAN19	MMF	MSA		PIERCE
28SEP18	MMF	PJP		MODEL
09JUL18	MMF	NPE		