

PUMPER BODY

Long Aluminum 2nd Gen Pumper

CHASSIS

Sober FR Chassis

CHASSIS AXLE, FRONT, CUSTOM
18,000 Lb Dana Axle

AXLE, REAR
27,000 Lb Dana Axle

ENGINE
380 HP Cummins L9 Engine

TRANSMISSION
Allison 5th Gen, 3000 EVS P

BUMPER
26" Extended Stainless Steel

CAB

7010 Sober FR Cab

BODY WATER TANK
1000 Gallon Poly Water Tank

COMPT, PUMPER, REAR
51.25" FF RoLLup Rear Compt

COMPT, PUMPER, LEFT SIDE
161" RoLLup Full Height & Depth Front & Rear

COMPT, PUMPER, RIGHT SIDE
161" RoLLup Full Height Front & Rear FDLER

FIRE SUPPRESSION PUMPHOUSE
45" Control Zone Top Mount

PUMP

1500 GPM Hale QMAX

CROSSLAYS, 1.50"
1.50" Crosslays Not Required

CROSSLAYS, 2.50"
2.50" Crosslay Not Required

SPEEDLAYS

(2) 1.50" W/Tray Std. Capacity

GENERATOR

Generator Not Required

Foam System

Husky 3 Single Agent Foam System

Foam Cell

30 Gallon Foam Cell, Not Reduced Water

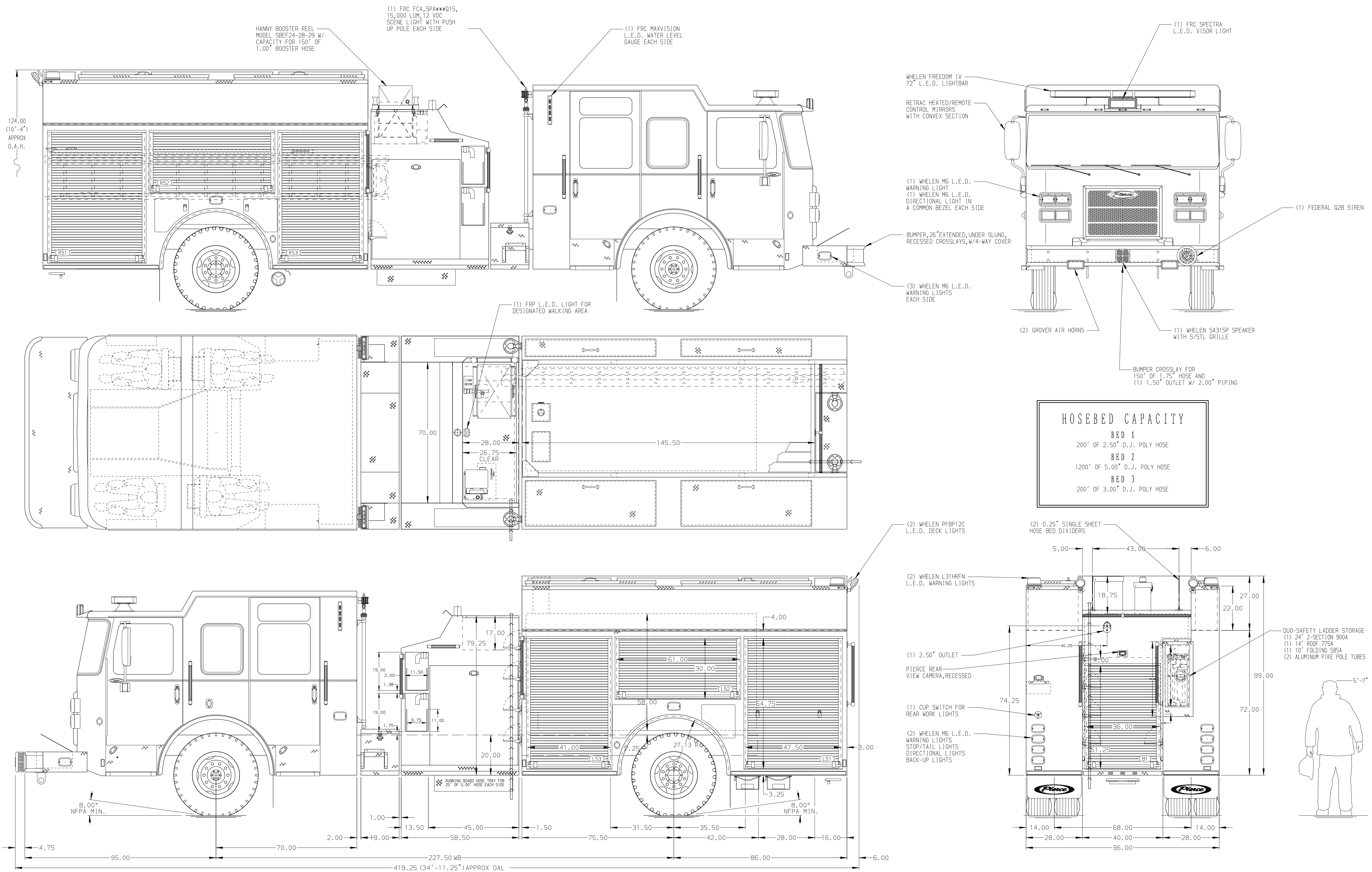

HOSEBED CAPACITY	
BED 1	200' OF 2.50" D.J. POLY HOSE
BED 2	1200' OF 5.00" D.J. POLY HOSE
BED 3	200' OF 3.00" D.J. POLY HOSE

NOTE
DIMENSIONS SHOWN ARE APPROXIMATE AND ARE SUBJECT TO MINOR DEVIATIONS AS MAY OCCUR OR BE NECESSARY IN CONSTRUCTION. MINOR DETAILS NOT SHOWN.

REV	DATE	BY	CH	SABER FR
15NOV18	JLA	RW1		PIERCE
13SEP18	JLA	RW1		MODEL

Pierce MANUFACTURING INC.		JOB NO.	33005
TITLE		SCALE	DATE
Pierce Pumper Approval Drawing		1:24	
MAKE		DRAWN BY	COL
FOR		14AUG18	
Palatka Fire Department		CHECKED BY	KBO
DWG NO.		22AUG18	
33005AD		SHEET SIZE	SHEET NO.
		D	1 OF 1