

**PUMPER  
BODY**

Long Aluminum 2nd Gen Pumper

**CHASSIS**

Enforcer Chassis

**CHASSIS  
AXLE, FRONT, CUSTOM**

22,800 Lb TAK-4 Axle

**AXLE, REAR**

27,000 Lb Dana Axle

**ENGINE**

450 HP Cummins L9 Engine

**TRANSMISSION**

Allison 5th Gen, 3000 EVS P

**BUMPER**

22" Extended Painted Steel

**CAB**

8410 Enforcer Cab

**BODY  
WATER TANK**

750 Gallon New York Style Water Tank

**COMPT, PUMPER, REAR**

30.75" FF RollUp Rear Compt

**COMPT, PUMPER, LEFT SIDE**

161" RollUp Full Height Front & Rear FDLR

**COMPT, PUMPER, RIGHT SIDE**

161" RollUp Full Height Front & Rear FDLR

**FIRE SUPPRESSION  
PUMPHOUSE**

45" Control Zone Top Mount

**PUMP**

2000 GPM Waterous CSU

**CROSSLAYS, 1.50"**

(2) 1.50" Standard Capacity

**CROSSLAYS, 2.50"**

2.50" Crosslay Not Required

**SPEEDLAYS**

SpeedLays Not Required

**GENERATOR**

Generator Not Required

**Foam System**

Foam System Not Required

**Foam Cell**

Foam Cell Not Required

Frontal Impact Protection

**NOTE**

DIMENSIONS SHOWN ARE APPROXIMATE AND ARE SUBJECT TO MINOR DEVIATIONS AS MAY OCCUR OR BE NECESSARY IN CONSTRUCTION. MINOR DETAILS NOT SHOWN.

- ONE 1.50" OUTLET WITH 2.00" PIPING AND SWIVEL LOCATED IN CENTER BUMPER TRAY
- SHORELINE RECEPTACLE WITH KUSSMAUL SUPER AUTO-EJECT LOCATED ON DRIVER SIDE OF THE CAB
- AIR INLET/OUTLET WITH DISCONNECT COUPLING ON DRIVER SIDE PUMP PANEL
- BATTERY CHARGER LOCATED BEHIND DRIVER'S SEAT
- BATTERY CHARGE INDICATOR LOCATED ON THE DRIVER SIDE SEAT RISER
- FIVE ADJUSTABLE SHELVES LOCATED PER SHOP ORDER
- THREE FLOOR MOUNTED SLIDE-OUT TRAYS LOCATED PER SHOP ORDER
- TWO SLIDE-OUT TOOLBOARDS LOCATED PER SHOP ORDER
- TWO SWING-OUT TOOLBOARDS LOCATED PER SHOP ORDER
- HANNAY BOOSTER REEL MODEL EF34-23-24 WITH CAPACITY FOR 200' OF 1.00" BOOSTER HOSE LOCATED IN COMPARTMENT B1

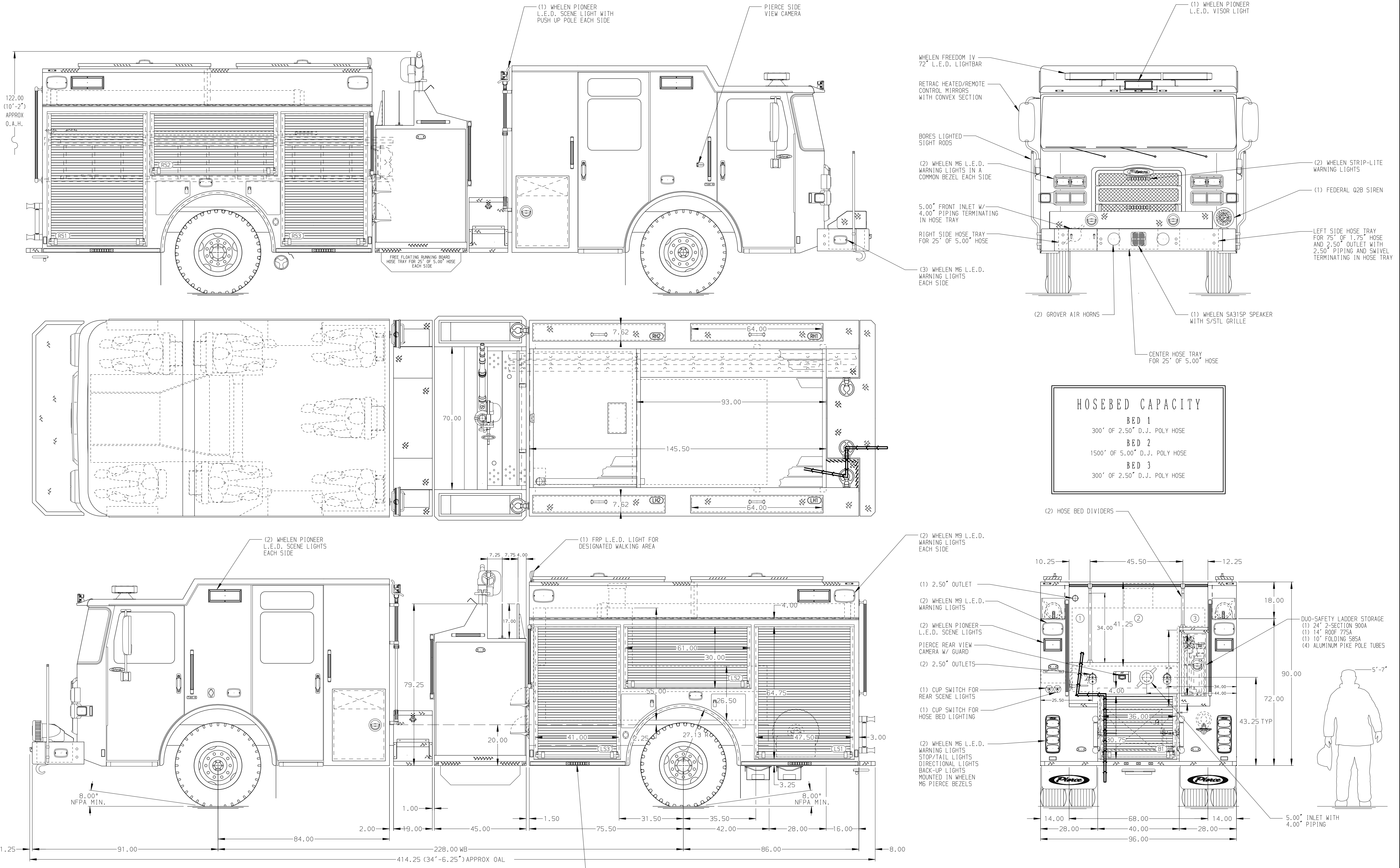

		JOB NO.	33017																
		SCALE	DATE																
<b>Pierce MANUFACTURING INC.</b>		TITLE	Pierce Pumper Approval Drawing																
		FOR	Yaphank Fire District																
<table border="1"> <tr> <td>19NOV18</td> <td>COL</td> <td>KBO</td> <td>MAKE</td> </tr> <tr> <td>23OCT18</td> <td>COL</td> <td>KBO</td> <td>PIERCE</td> </tr> <tr> <td>18OCT18</td> <td>COL</td> <td>KBO</td> <td>MODEL</td> </tr> <tr> <td>REV</td> <td>DATE</td> <td>BY</td> <td>CH</td> </tr> </table>		19NOV18	COL	KBO	MAKE	23OCT18	COL	KBO	PIERCE	18OCT18	COL	KBO	MODEL	REV	DATE	BY	CH	DWG NO.	33017AD
		19NOV18	COL	KBO	MAKE														
23OCT18	COL	KBO	PIERCE																
18OCT18	COL	KBO	MODEL																
REV	DATE	BY	CH																
<table border="1"> <tr> <td>19NOV18</td> <td>COL</td> <td>KBO</td> <td>MAKE</td> </tr> <tr> <td>23OCT18</td> <td>COL</td> <td>KBO</td> <td>PIERCE</td> </tr> <tr> <td>18OCT18</td> <td>COL</td> <td>KBO</td> <td>MODEL</td> </tr> <tr> <td>REV</td> <td>DATE</td> <td>BY</td> <td>CH</td> </tr> </table>		19NOV18	COL	KBO	MAKE	23OCT18	COL	KBO	PIERCE	18OCT18	COL	KBO	MODEL	REV	DATE	BY	CH	SHEET NO.	1 OF 1
		19NOV18	COL	KBO	MAKE														
23OCT18	COL	KBO	PIERCE																
18OCT18	COL	KBO	MODEL																
REV	DATE	BY	CH																