

- HOSEBED CAPACITIES
- ① 200' OF 1.75" D.J. HOSE WITH POLY TRAY
  - ② 750' OF 3.00" D.J. HOSE
  - ③ 1000' OF 5.00" D.J. HOSE
  - ④ HOTEL PACK
  - ⑤ UNDEFIND HOSE BED

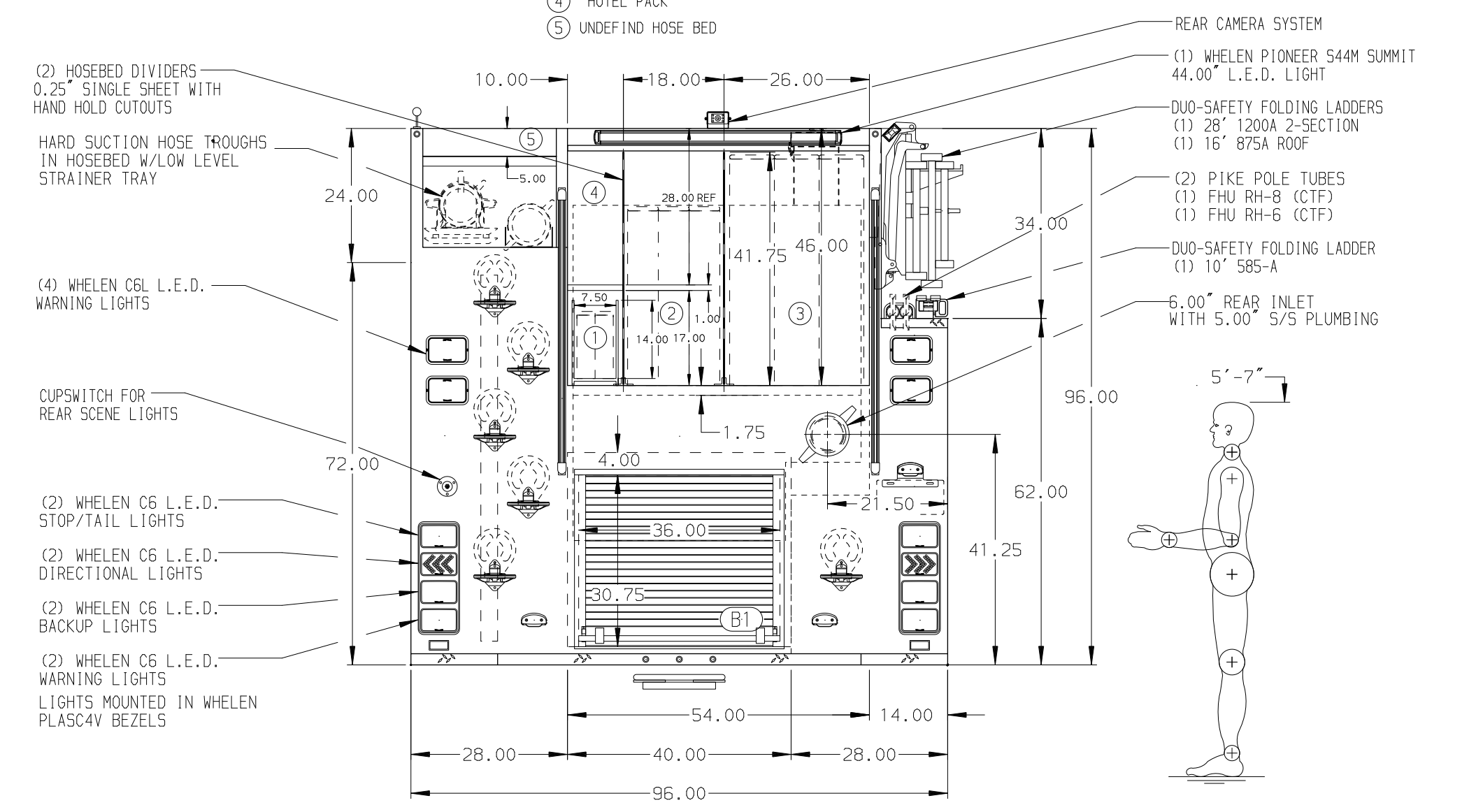
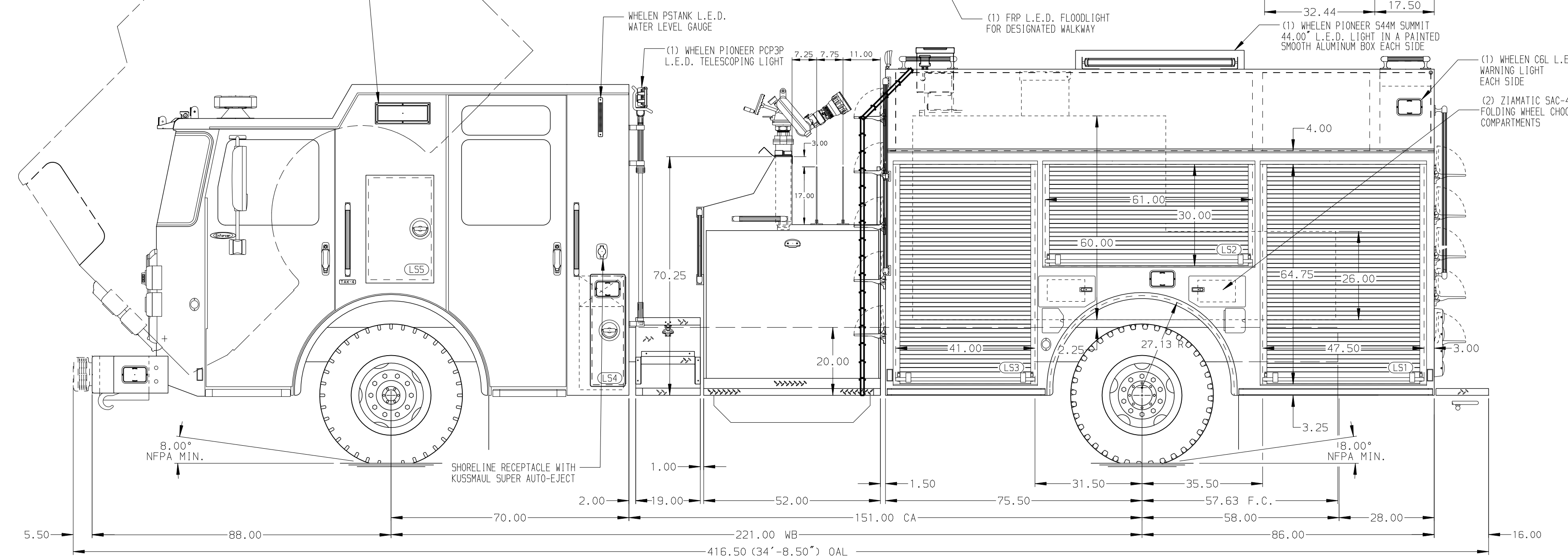

ALUMINUM BODY

MAXIMUM O.A.H. 130.00"

FRONTAL IMPACT PROTECTION

NOTE  
DIMENSIONS SHOWN ARE APPROXIMATE AND ARE SUBJECT TO MINOR DEVIATIONS AS MAY OCCUR OR BE NECESSARY IN CONSTRUCTION. MINOR DETAILS NOT SHOWN.

1. KUSMAUL BATTERY CHARGER LOCATED BEHIND CAB SEAT RISER
2. BATTERY CHARGE INDICATOR LOCATED ON DRIVER'S SEAT RISER
3. AIR INLET WITH DISCONNECT COUPLING RECESSED IN CAB STEP
4. DRIP PAN GUARD FOR ROLL-UP DOOR LOCATED L51, L52, L53, R51, R52, R53 AND B1
5. ONE FULL WIDTH DEPTH ADJUSTABLE SHELF IN COMPARTMENTS L51, L52, R51, R52 AND B1
6. ONE HORIZONTAL PARTITION IN COMPARTMENT L53
7. ONE FLOOR MOUNTED SLIDE-OUT TRAY W/SIDE SLIDES IN COMPARTMENTS R51 AND B1
8. SWING-OUT TOOL BOARDS WITH PEGBOARD PATTERN IN COMPARTMENT L52 AND R52
9. TWO SLIDE-OUT TOOL BOARDS WITH PEGBOARD PATTERN IN COMPARTMENTS L51 AND L53
10. ONE VERTICAL DIVIDER IN COMPARTMENT L51 AND L52
11. VANNER BRAVO INVERTER LOCATED IN COMPARTMENT L53
12. ONE CTECH DRAINER ASSEMBLY IN COMPARTMENT L53
13. PEGBOARD ON BACK WALL OF COMPARTMENT R53
14. TWO ROLLED HOSE DIVIDERS IN COMPARTMENT L53
15. AIR COMPRESSOR LOCATED IN COMPARTMENT L53
16. ONE 120V NEMA DUPLEX RECEPTACLE IN COMPARTMENTS L52, L53 AND R53

REV	DATE	BY	CH	ENFORCER
22APR19	LME	PJP		
15MAR19	LME	RWA		
22JAN19	LME	WKL		

CHASSIS DATA	MAKE	TITLE	FOR	DWG NO.
2250-D-1030P, 1000G WATER/30G FOAM, 161" BODY TOP MOUNT, (3) CROSSLAYS, DELUGE, ZICO QUIC-LIFT	PIERCE	1250-D-1030P, 1000G WATER/30G FOAM, 161" BODY TOP MOUNT, (3) CROSSLAYS, DELUGE, ZICO QUIC-LIFT	WEST BEND FIRE DEPARTMENT WEST BEND, WISCONSIN	33151AD

**Pierce MANUFACTURING INC.**

JOB NO. 33151

SCALE 1:24 DATE

DRAWN BY LME 12JAN19

CHECKED BY WKL 14JAN19

SHEET SIZE D SHEET NO. 1 OF 1