

PUMPER BODY

Long Aluminum 2nd Gen Pumper

CHASSIS

Velocity Chassis (Medium Block)

CHASSIS AXLE, FRONT, CUSTOM
19,500 Lb TAK-4 Axle

AXLE, REAR
24,000 Lb Meritor Axle

ENGINE
450 HP Cummins L9 Engine

TRANSMISSION
Allison 5th Gen, 3000 EVS P

BUMPER
19" Extended Stainless Steel

CAB

7010 Velocity FR Cab

BODY WATER TANK

500 Gallon Poly Water Tank

COMPT, PUMPER, REAR
34.75" FF RollUp Rear Compt

COMPT, PUMPER, LEFT SIDE
161" RollUp Full Height Front & Rear FDLR

COMPT, PUMPER, RIGHT SIDE
161" RollUp Full Height Front & Rear FDLR

FIRE SUPPRESSION PUMPHOUSE

48" Control Zone Side Mount

PUMP

1500 GPM Waterous CSU

CROSSLAYS, 1.50"
(2) 1.50" Standard Capacity

CROSSLAYS, 2.50"
2.50" Crosslay Not Required

SPEEDLAYS

Speedlays Not Required

GENERATOR

Generator Not Required

Foam System

Husky 12 Single Agent Foam System

Foam Cell

30 Gallon Foam Cell, Not Reduced Water

Side Roll and Frontal Impact Protection

NOTE
DIMENSIONS SHOWN ARE APPROXIMATE AND ARE SUBJECT TO MINOR DEVIATIONS AS MAY OCCUR OR BE NECESSARY IN CONSTRUCTION. MINOR DETAILS NOT SHOWN.

1. BATTERY CHARGER LOCATED IN CREW CAB SEAT RISER
2. TEN ADJUSTABLE SHELVES LOCATED PER SHOP ORDER

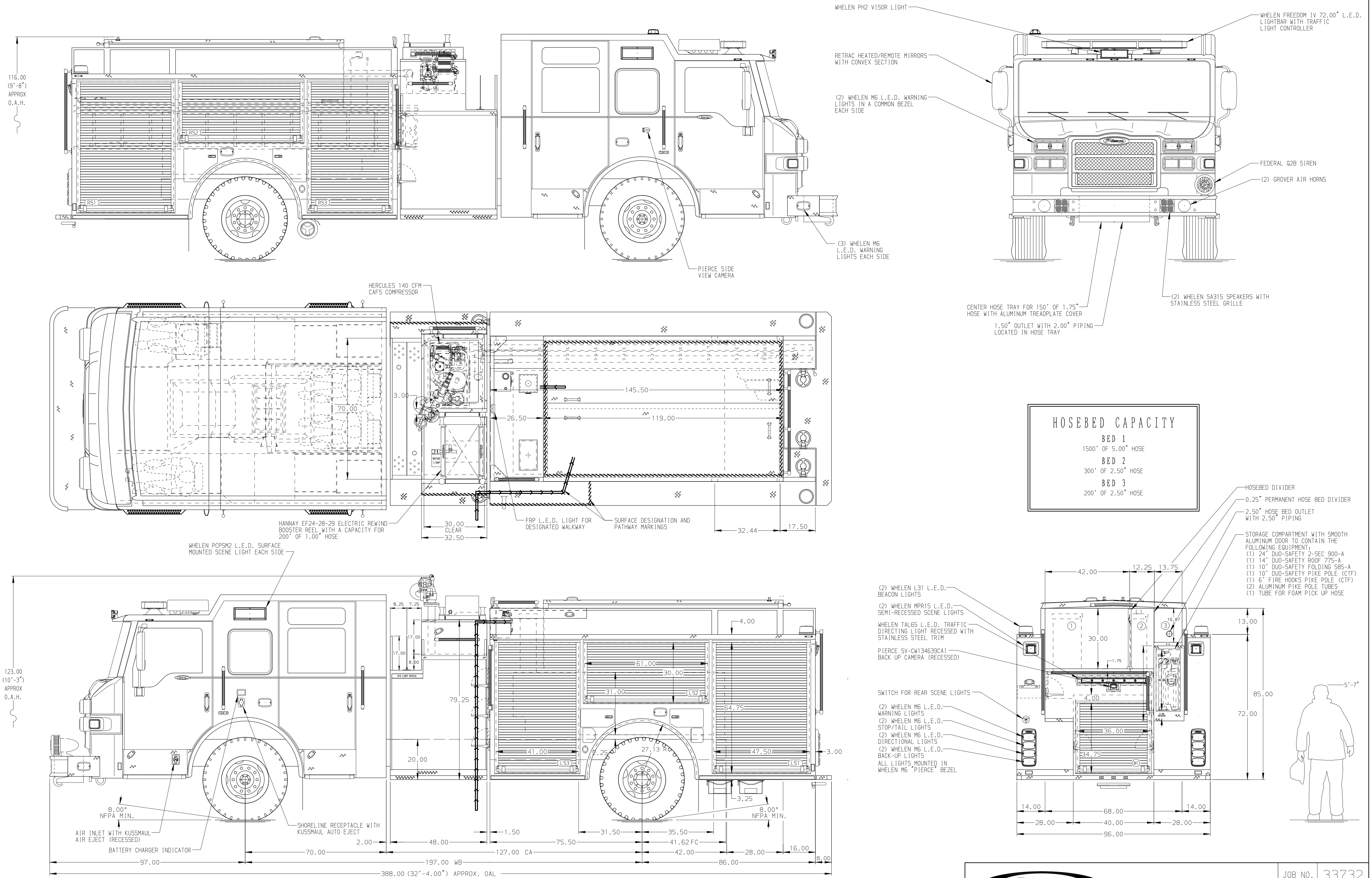

HOSEBED CAPACITY	
BED 1	1500' OF 5.00" HOSE
BED 2	300' OF 2.50" HOSE
BED 3	200' OF 2.50" HOSE

		JOB NO.	33732																				
		SCALE	1:24																				
Pierce MANUFACTURING INC.		TITLE	Pierce Pumper Approval Drawing																				
		FOR	Fort Smith Fire Department																				
<table border="1"> <tr> <th>REV</th> <th>DATE</th> <th>BY</th> <th>CH</th> <th>VELOCITY</th> </tr> <tr> <td>12JUN19</td> <td>KLE</td> <td>KW1</td> <td></td> <td></td> </tr> <tr> <td>06JUN16</td> <td>COL</td> <td>CW1</td> <td></td> <td></td> </tr> <tr> <td>25APR19</td> <td>COL</td> <td>CW1</td> <td></td> <td></td> </tr> </table>		REV	DATE	BY	CH	VELOCITY	12JUN19	KLE	KW1			06JUN16	COL	CW1			25APR19	COL	CW1			DWG NO.	33732AD
		REV	DATE	BY	CH	VELOCITY																	
12JUN19	KLE	KW1																					
06JUN16	COL	CW1																					
25APR19	COL	CW1																					
<table border="1"> <tr> <th>CHASSIS DATA</th> <th>MAKE</th> <th>MODEL</th> </tr> <tr> <td>PIERCE</td> <td></td> <td></td> </tr> </table>		CHASSIS DATA	MAKE	MODEL	PIERCE			CHECKED BY	KBO														
		CHASSIS DATA	MAKE	MODEL																			
PIERCE																							
<table border="1"> <tr> <th>DATE</th> <th>BY</th> <th>CH</th> <th>VELOCITY</th> </tr> <tr> <td>08APR19</td> <td></td> <td></td> <td></td> </tr> </table>		DATE	BY	CH	VELOCITY	08APR19				SHEET NO.	1 OF 1												
		DATE	BY	CH	VELOCITY																		
08APR19																							
<table border="1"> <tr> <th>DATE</th> <th>BY</th> <th>CH</th> <th>VELOCITY</th> </tr> <tr> <td>08APR19</td> <td></td> <td></td> <td></td> </tr> </table>		DATE	BY	CH	VELOCITY	08APR19				SHEET SIZE	D												
		DATE	BY	CH	VELOCITY																		
08APR19																							