

123.00
(10'-3")
APPROX
O.A.H.

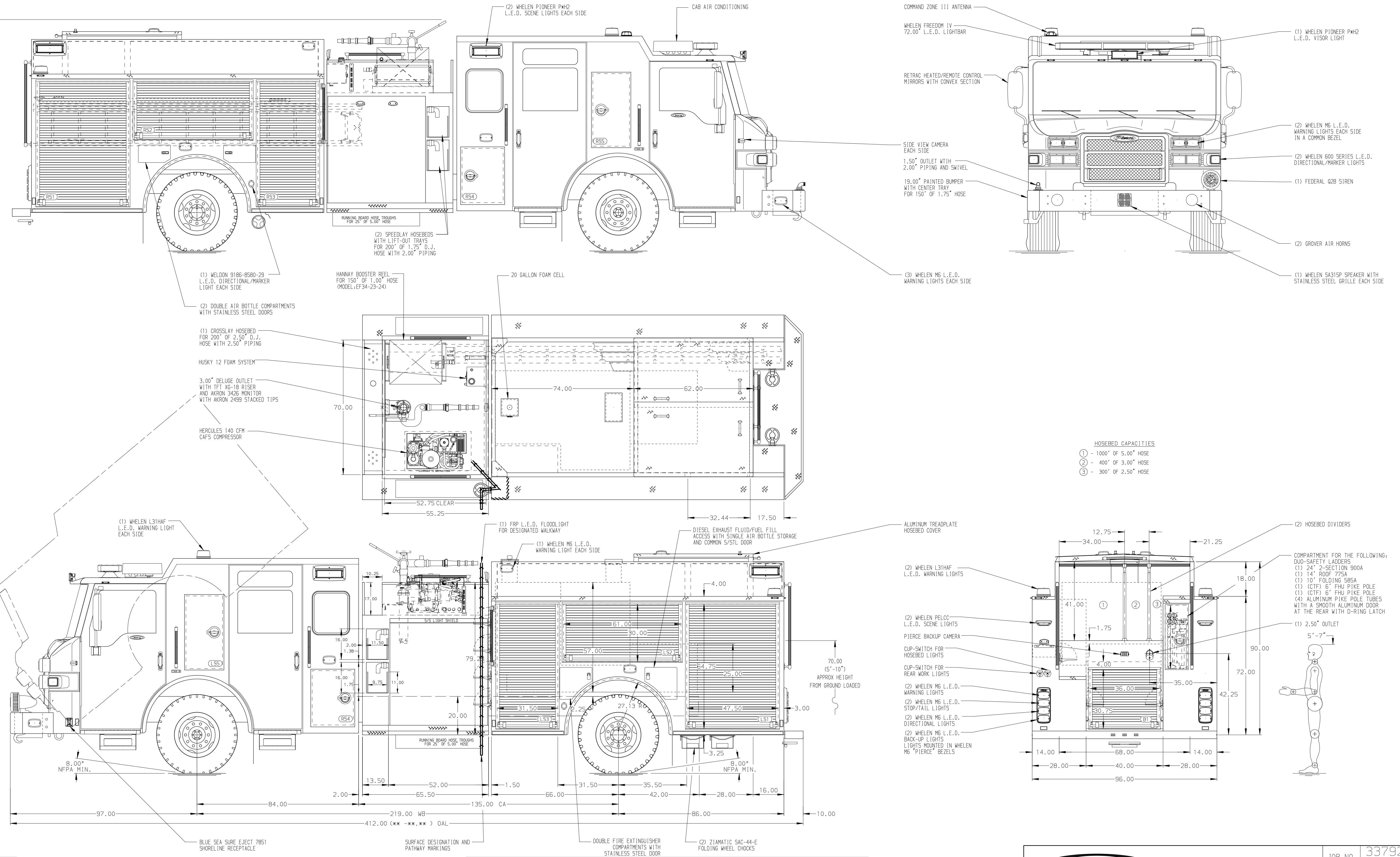

GALVANNEAL

SIDE ROLL AND FRONTAL IMPACT PROTECTION

		JOB NO.	33792
		SCALE	1:24
PIERCE MANUFACTURING INC.		DATE	26APR19
		DRAWN BY	AMI
TITLE 2000-D-750P, 730 WATER, 20 FOAM, 152" PUMPER BODY (1)XLAYS, (2)SPEEDLAYS, DELUGE, HUSKY 3, CAFS 140		CHECKED BY	CDU
		FOR	DFW INTERNATIONAL AIRPORT DFW AIRPORT, TEXAS
DWG NO.		SHEET SIZE	D
		SHEET NO.	1 OF 2

NOTE
DIMENSIONS SHOWN ARE APPROXIMATE AND ARE SUBJECT TO MINOR DEVIATIONS AS MAY OCCUR OR BE NECESSARY IN CONSTRUCTION. MINOR DETAILS NOT SHOWN.

1. KUSMUL AIR COMPRESSOR LOCATED BEHIND DRIVER'S SEAT
2. BATTERY CHARGER LOCATED IN COMPARTMENT L53
3. BATTERY CHARGER INDICATOR LOCATED AT DRIVER'S SIDE STEP AREA
4. DUAL L.E.D. LIGHT STRIPS LOCATED IN HOSE BED
5. AIR INLET WITH DISCONNECT COUPLING LOCATED IN DRIVER'S SIDE STEP AREA

REV	DATE	BY	CH	VELOCITY FR
1	18NOV19	AMI	CHR	CHASSIS DATA
2	04NOV19	KLE	CHR	MAKE
3	01NOV19	KLE	MSA	PIERCE
4	13JUN19	KLE	KW1	MODEL