

PUMPER BODY
Medium Aluminum 2nd Gen Pumper

CHASSIS
Sober FR Chassis

CHASSIS AXLE, FRONT, CUSTOM
18,000 Lb Dana Axle

AXLE, REAR
27,000 Lb Dana Axle

ENGINE
380 HP Cummins L9 Engine

TRANSMISSION
Allison 5th Gen, 3000 EVS P

BUMPER
19" Extended Stainless Steel

CAB
7010 Sober FR Cab

BODY WATER TANK
1000 Gallon Poly Water Tank

COMPT, PUMPER, REAR
58.00" FF RollUp Rear Compt

COMPT, PUMPER, LEFT SIDE
152" RollUp Full Height Front & Rear FDLR

COMPT, PUMPER, RIGHT SIDE
152" RollUp Full Height Front & Rear FDLR

FIRE SUPPRESSION PUMPHOUSE
45" Control Zone Top Mount

PUMP
1250 GPM Hale QMAX

CROSSLAYS, 1.50"
1.50" Crosslay Not Required

CROSSLAYS, 2.50"
2.50" Crosslay Not Required

SPEEDLAYS
(2) 1.50" W/Tray Std. Capacity

GENERATOR
Generator Not Required

Foam System
Hale Foam Logix 2.1 Single Agent, SmartFOAM Controller

Foam Cell
20 Gallon Foam Cell, Not Reduced Water

NOTE
DIMENSIONS SHOWN ARE APPROXIMATE AND ARE SUBJECT TO MINOR DEVIATIONS AS MAY OCCUR OR BE NECESSARY IN CONSTRUCTION. MINOR DETAILS NOT SHOWN.

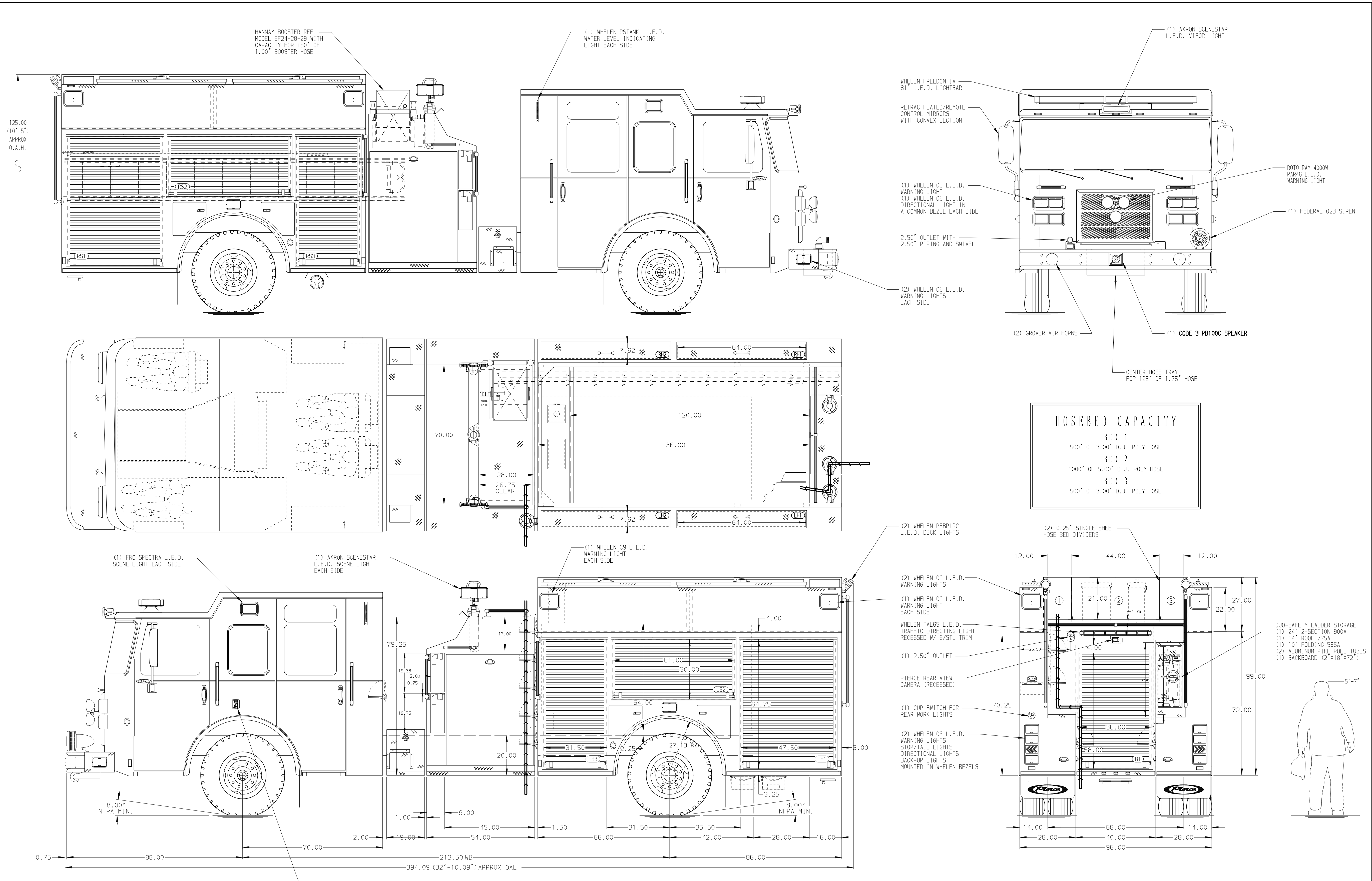

| | | | | |
|---------|--------------------------------|---------|------------|---------|
| | | JOB NO. | 33894 | |
| | | SCALE | DATE | |
| TITLE | Pierce Pumper Approval Drawing | | DRAWN BY | 28MAR19 |
| FOR | Talladega Fire Department | | CHECKED BY | 28MAR19 |
| DWG NO. | 33894AD | | SHEET NO. | 1 OF 1 |

| REV | DATE | BY | CH | SABER FR |
|---------|------|-----|----|--------------|
| 12JUN19 | KLE | KW1 | | CHASSIS DATA |
| 30MAY19 | RW1 | JAF | | MAKE |
| 12APR19 | RW1 | JAF | | PIERCE |
| | | | | MODEL |