

HOSEBED CAPACITIES

- ① 300' OF 3.00" HOSE
- ② 1075' OF 4.00" HOSE
- ③ OPEN HOSEBED

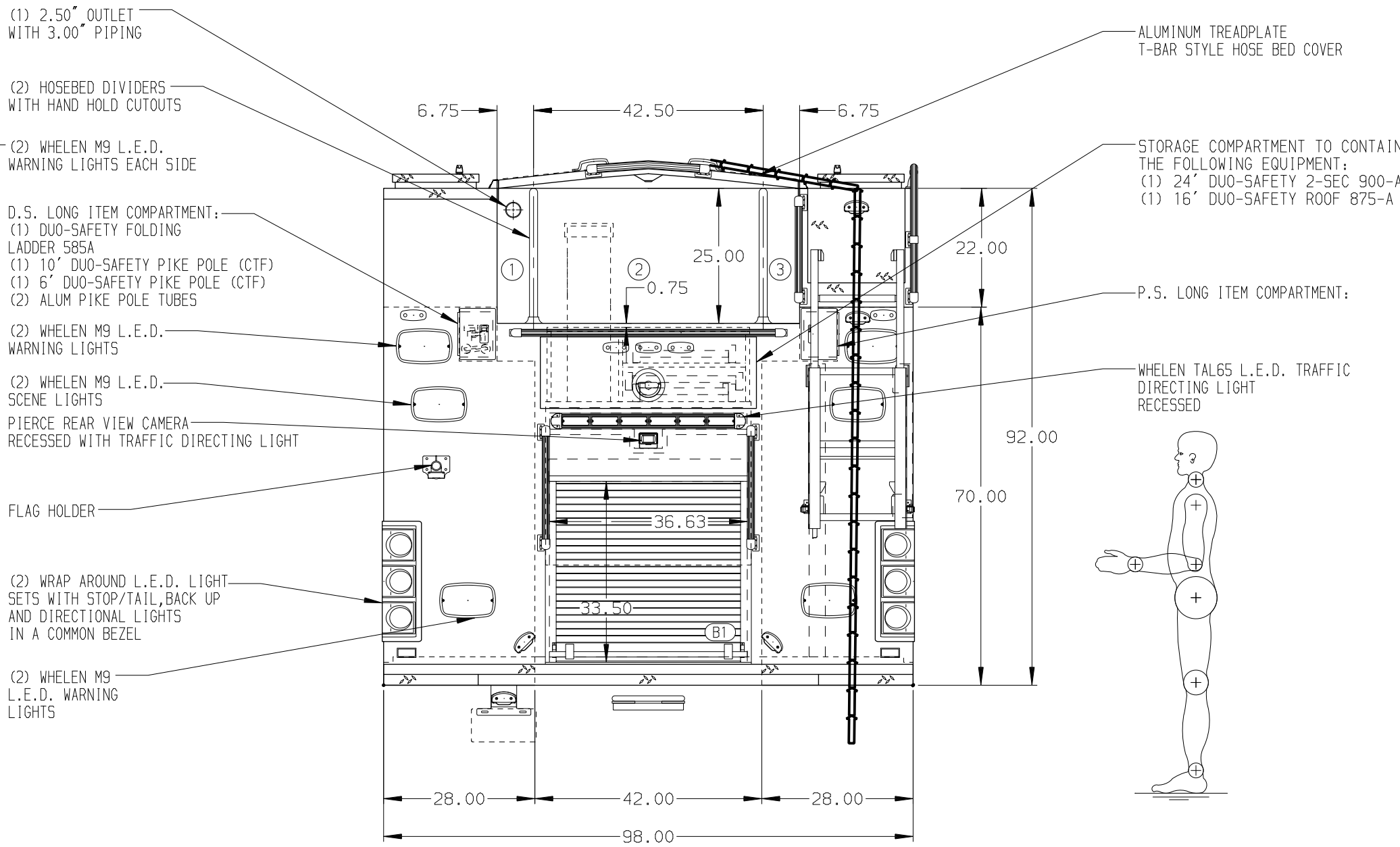
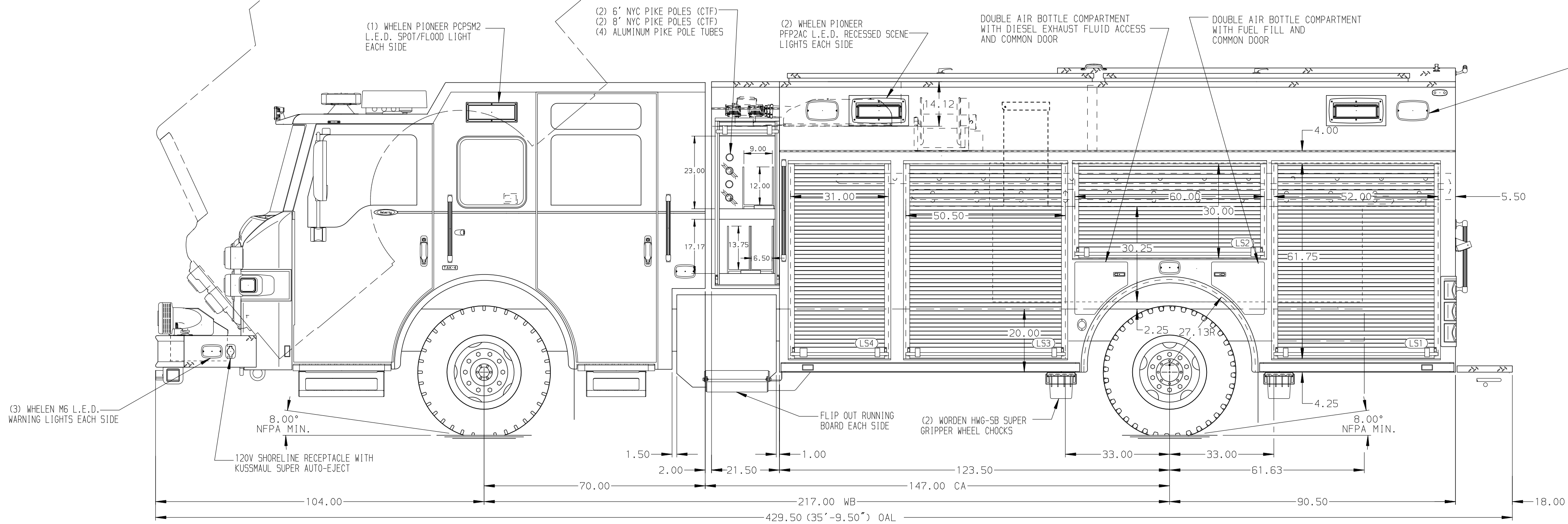

ALUMINUM BODY

MAXIMUM O.A.H. 123.00"

SIDE ROLL AND FRONTAL IMPACT PROTECTION

**NOTE**  
DIMENSIONS SHOWN ARE APPROXIMATE AND ARE SUBJECT TO MINOR DEVIATIONS AS MAY OCCUR OR BE NECESSARY IN CONSTRUCTION.  
MINOR DETAILS NOT SHOWN.

- AIR INLET W/ DISCONNECT COUPLINGS ON THE D.S. STEP WELL
- BATTERY CHARGER LOCATED BEHIND THE DRIVER'S SIDE CAB SEAT AND THE COMPRESSOR LOCATED BEHIND THE PASSENGER'S SIDE CAB SEAT
- (1) AIR OUTLET WITH SHUT OFF VALVE ON D.S. PUMP PANEL
- BATTERY CHARGER INDICATOR BEHIND DRIVER'S SEAT DISPLAYED THROUGH WINDOW
- DUAL L.E.D. LIGHT STRIPS LOCATED IN HOSE BED
- FULL WIDTH/DEPTH ADJUSTABLE SHELVES TWO IN L51 AND R53 AND ONE IN L52 AND L54
- ONE ADJUSTABLE SLIDE-OUT TRAY IN L51, L54, B1, R53, AND R54
- CABLE RELEASE LATCH WITH SINGLE HAND OPERATION FOR TRAY IN ALL TILT/ SLIDE-OUT TRAYS
- ADJUSTABLE TILTING SLIDE-OUT TRAYS THREE IN R51, TWO IN R53, AND ONE IN L53 AND R54
- SLIDE-OUT TOOL BOARDS WITH PEGBOARD PATTERN TWO IN L53 AND R52 AND ONE IN R53

- SLIDE-OUT FLOOR MOUNTED 200# OIL DRY HOPPER IN L51
- ONE VERTICAL PEGBOARD PARTITION IN L53 AND R53
- ALUMINUM PEGBOARD WITH TRACKS ON THE LEFT SIDE WALL OF R53
- S/SIL SCUFFPLATE ON ALL SIDES OF CROSSLAY OPENINGS
- NORCOLD REFRIGERATOR IN L51
- CIRCUIT BREAKER IN L53
- ONE AKRON MODEL ERW-15-10 ELECTRIC REWIND CORD REEL IN LH2 AND RH2 WITH 200' OF 10/3 CABLE
- ONE 120 4-PLACE DUPLEX RECEPTACLE MOUNTED BEHIND THE DRIVER'S SEAT ON THE ENGINE HOUSE, IN L51, L52, L53, R51, R52, R53, AND R54
- ONE HANWAY MODEL 2016-17-18 HYDRAULIC REEL WITH A CAPACITY FOR 100' OF 0.25" DUAL HOSE IN RH1

- GROVER 1275 TRAIN HORN LOCATED BEHIND THE BUMPER
- ONE 240V TWIST LOCK WEATHERPROOF RECEPTACLE IN RH1

REV	DATE	BY	CH	VELOCITY
1	27SEP19	LST	DTs	CHASSIS DATA
2	09SEP19	LST	DTs	MAKE
3	29JUL19	LST	DTs	PIERCE
4	17JUN19	LST	AZA	MODEL

		JOB NO.	34009
		SCALE	1:24
		DATE	
		DRAWN BY	LST
		CHECKED BY	AZA
		SHEET SIZE	SHEET NO.
		D	1 OF 1

TITLE	FOR	DWG NO.
1500-D-500 GAL POLY, 214" PUC RESCUE LADDERS BELOW HOSE BED, (3) X-LAYS, DELUGE	STANFORD HEIGHTS FIRE DISTRICT SCHENECTADY, NEW YORK	34009AD