

### PUMPER BODY

Long Aluminum 2nd Gen Pumper

### CHASSIS

Enforcer Chassis

### CHASSIS AXLE, FRONT, CUSTOM

19,500 Lb TAK-4 Axle

### AXLE, REAR

27,000 Lb Dana Axle

### ENGINE

380 HP Cummins L9 Engine

### TRANSMISSION

Allison 5th Gen, 3000 EVS P

### BUMPER

22" Extended Steel Pointed

### CAB

7010 Enforcer Cab

### BODY WATER TANK

750 Gallon Poly Water Tank

### COMPT, PUMPER, REAR

51.25" FF RollUp Rear Compt, 41.88" Deep FLush Rear

### COMPT, PUMPER, DRIVER SIDE

161" Lap Full Height & Depth Front & Rear

### COMPT, PUMPER PASS. SIDE

161" Lap Full Height Front & Rear FDLER

### FIRE SUPPRESSION PUMPHOUSE

45" Control Zone Top Mount

### PUMP

1250 GPM Waterous CSU

### CROSSLAYS, 1.50"

1.50" Crosslays Not Required

### CROSSLAYS, 2.50"

2.50" Crosslays Not Required

### SPEEDLAYS

(2) 1.50" Standard Capacity

(1) 2.50" Standard Capacity

### GENERATOR

Generator Not Required

### Foam System

Foam System Not Required

### Foam Cell

Foam Cell Not Required

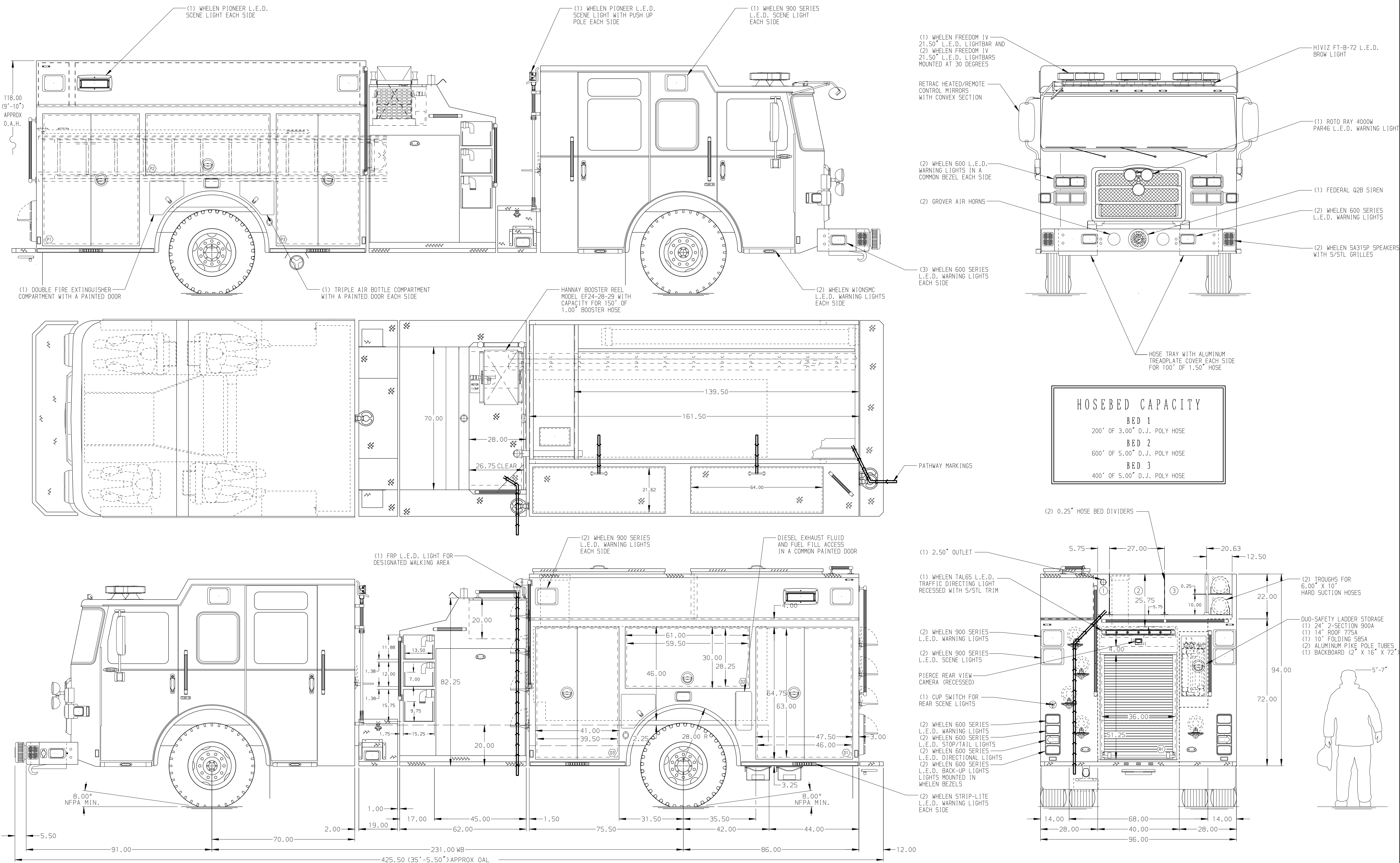

HOSEBED CAPACITY	
BED 1	200' OF 3.00" D.J. POLY HOSE
BED 2	600' OF 5.00" D.J. POLY HOSE
BED 3	400' OF 5.00" D.J. POLY HOSE

**NOTE**  
DIMENSIONS SHOWN ARE APPROXIMATE AND ARE SUBJECT TO MINOR DEVIATIONS AS MAY OCCUR OR BE NECESSARY IN CONSTRUCTION. MINOR DETAILS NOT SHOWN.

- ONE 1.50" OUTLET WITH 2.00" PIPING AND SWIVEL LOCATED IN LEFT AND RIGHT BUMPER TRAYS
- SHOULDER RECEPTACLE WITH KUSMAUL SUPER AUTO-EJECT LOCATED ON DRIVER SIDE BUMPER EXTENSION
- AIR INLET WITH DISCONNECT COUPLING ON DRIVER SIDE BUMPER EXTENSION
- BATTERY CHARGER LOCATED IN COMPARTMENT D3
- BATTERY CHARGE INDICATOR LOCATED ON D.S. SEAT RISER
- TWO 120V DUPLEX RECEPTACLES LOCATED IN CAB
- ONE FLOOR MOUNTED SLIDE-OUT TRAY LOCATED IN COMPARTMENTS D1, P1, & R1
- ONE ADJUSTABLE SHELF LOCATED IN COMPARTMENTS P1 & P3; TWO IN D1
- ONE ADJUSTABLE SLIDE-OUT TRAY LOCATED IN COMPARTMENTS D3 & R1
- ONE TILTING/SLIDE-OUT TRAY LOCATED IN COMPARTMENTS D2 & D3
- ONE SWING OUT TOOLBOARD WITH PAC TRAC LOCATED IN COMPARTMENT P2
- PAC TRAC LOCATED PER SHOP ORDER
- VERTICAL PARTITION LOCATED IN COMPARTMENT D1
- PARTITION BETWEEN COMPARTMENTS D1/R1 AND P1/R1
- ONE SLIDE OUT TOOLBOARD WITH PAC TRAC LOCATED IN COMPARTMENT D1

REV	DATE	BY	CH	ENFORCER
1	11OCT16	COL	JGO	PIERCE
2	16SEP16	COL	JGO	MODEL

		JOB NO.	30545
		SCALE	DATE
TITLE	Pierce Pumper Approval Drawing		
MAKE	-		
FOR	Holly Springs Fire Rescue		
DWG NO.	30545AD		
CHECKED BY	COL	DRAWN BY	31AUG16
SHEET SIZE	D	CHECKED BY	02SEP16
SHEET NO.	1 OF 1		