

PUMPER BODY

Long Aluminum 2nd Gen Pumper

CHASSIS

Sober FR Chassis

CHASSIS AXLE, FRONT, CUSTOM

18,000 Lb Dana Axle

AXLE, REAR

27,000 Lb Dana Axle

ENGINE

450 HP Cummins L9 Engine

TRANSMISSION

Allison 5th Gen, 3000 EVS P

BUMPER

22" Extended Steel Pointed

CAB

7010 Sober FR Cab

BODY WATER TANK

1000 Gallon Poly Water Tank

COMPT, PUMPER, REAR

44.50" FF RollUp Rear Compt, 25.88" Deep Flush Rear

COMPT, PUMPER, DRIVER SIDE

161" RollUp Full Height Front & Rear FDLR

COMPT, PUMPER PASS. SIDE

161" RollUp Full Height Front & Rear FDLR

FIRE SUPPRESSION PUMPHOUSE

45" Control Zone Top Mount

PUMP

1500 GPM Waterous CSU

CROSSLAYS, 1.50"

1.50" Crosslays Not Required

CROSSLAYS, 2.50"

2.50" Crosslays Not Required

SPEEDLAYS

(2) 1.50" Standard Capacity

(1) 2.50" Standard Capacity

GENERATOR

Harrison 8kW MAS-D Hydraulic Generator

Foam System

Husky 3 Single Agent Foam System

Foam Cell

30 Gallon Foam Cell, Not Reduced Water

Side Roll and Frontal Impact Protection

NOTE

DIMENSIONS SHOWN ARE APPROXIMATE AND ARE SUBJECT TO MINOR DEVIATIONS AS MAY OCCUR OR BE NECESSARY IN CONSTRUCTION. MINOR DETAILS NOT SHOWN.

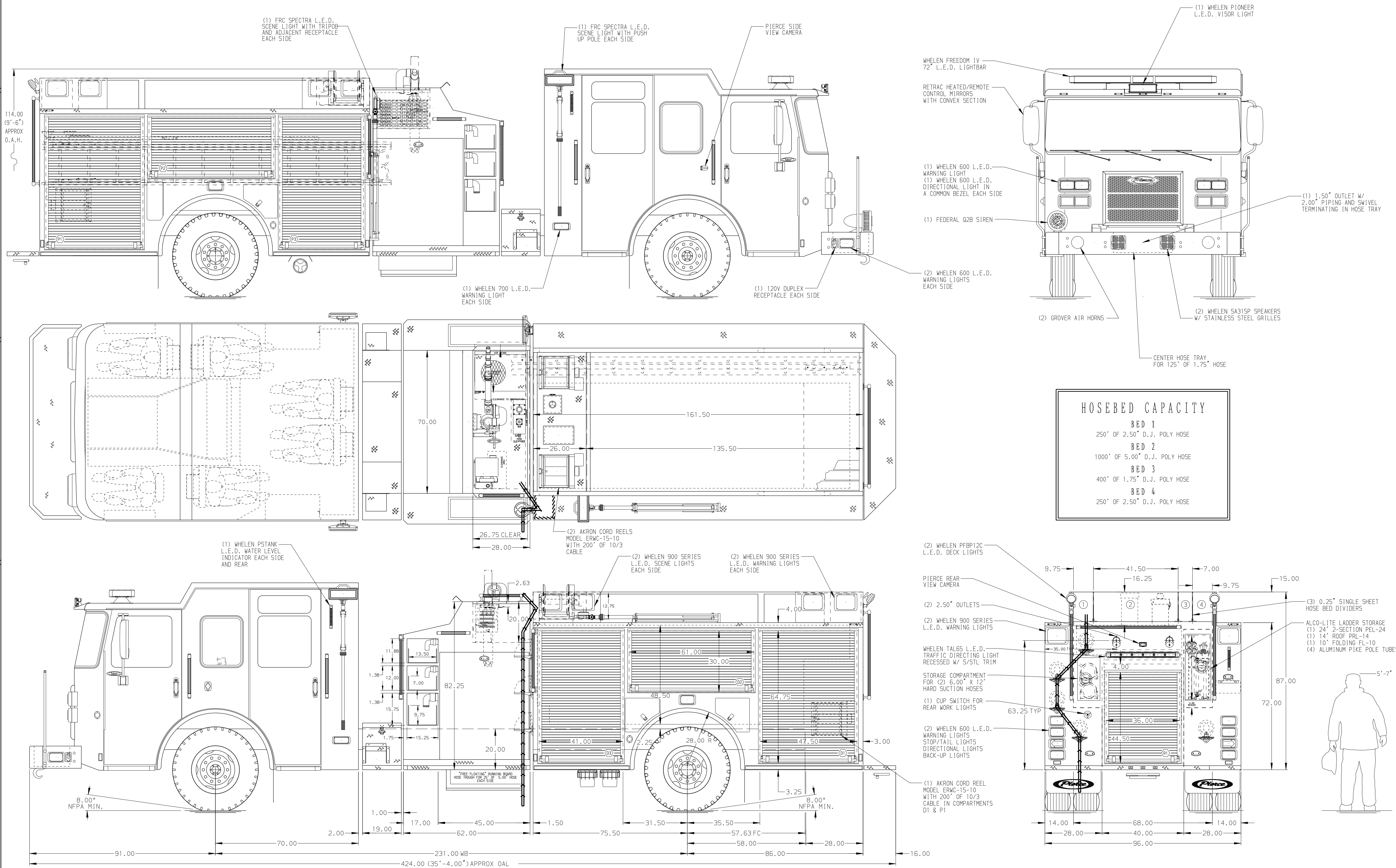

HOSEBED CAPACITY	
BED 1	250' OF 2.50" D.J. POLY HOSE
BED 2	1000' OF 5.00" D.J. POLY HOSE
BED 3	400' OF 1.75" D.J. POLY HOSE
BED 4	250' OF 2.50" D.J. POLY HOSE

MAXIMUM O.A.H. 114.00"

Pierce MANUFACTURING INC.		JOB NO.	30909
		SCALE	DATE
		DRAWN BY	07DEC16
		CHECKED BY	13DEC16
		SHEET SIZE	SHEET NO.
		D	1 OF 1

CHASSIS DATA	TITLE	Pierce Pumper Approval Drawing
MAKE	FOR	Northeast Allen County Fire & EMS
MODEL	DWG NO.	30909AD
SABER FR	REV	