

The practice contacted HJT to assist them in creating their new vision. A multi-practitioner practice had purchased a large vacant lot and wanted to build from the ground up a single stand-alone building that would house their bustling dental practice.

They only wanted to use a small portion of the lot, to allow the other area of the lot to be used for future development for their own expansion or future tenant development.

Flow and direction was very important to the practice. They wanted the building to be easily accessible and visible from the road and also allow their patients to have a view of the outdoors while receiving treatment.

## Design Solutions

- We located the building as close as possible to the road
- Treatment rooms along the outside of building
- Centralized clinical support areas
- Dedicated and ample parking for patients
- Separate parking and entrance for staff
- Nursery on-site for staff to utilize as well

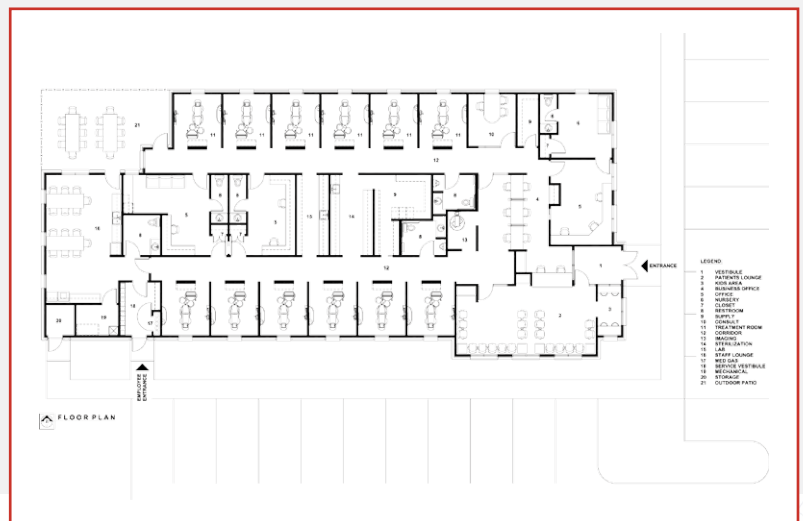

## Unique Solutions

HJT was able to create a design and layout that met the unique needs of a multi-doctor practice. We were able to exceed expectations by constructing a floor plan that optimized traffic flow and left room for future development.

## Why Choose HJT?

HJT Dental Design Consultants can design your dental practice layout to create unique spaces for your patients. If you are looking for something non-traditional in your next practice space, call HJT Dental Design Consultants. Find out how we can collaborate to design your practice space with the amenities you need.



## Dental Design Consultants

118 W. Wayne St., Maumee, OH 43537  
(419) 517-5370

PO Box 8194 Madeira Beach, FL 33738  
(419) 410-1562