

## instructions for use

### Mitra<sup>®</sup> device clamshell format

Follow these steps to correctly collect microsamples with a Mitra device.  
Questions? [support@neoteryx.com](mailto:support@neoteryx.com)

#### Step 1

Open clamshell by pulling apart the sides and pressing them together to create handle.

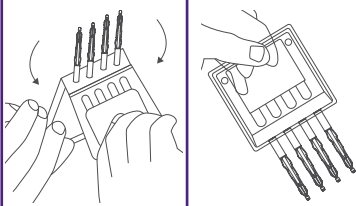

#### Step 2

Apply micro-sampler tip to surface of fluid sample.

##### for blood

Watch sampler tip turn FULLY red and then count 2 additional seconds. SLOWLY and SMOOTHLY remove sampler tip from blood.

##### for clear fluids (e.g. urine, tears, saliva)

Count 6 seconds while holding the sampler tip in the fluid then SLOWLY and SMOOTHLY remove it.

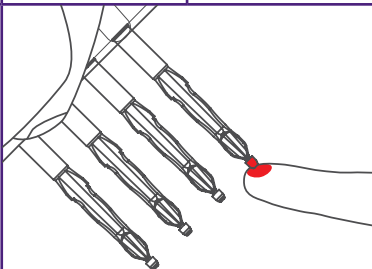

#### IMPORTANT!

- Do NOT submerge the entire micro-sampler tip in fluid
- Tip should always point downward towards floor
- Do NOT drop blood/fluid onto the tip from above

#### Step 3

Repeat step 2 with remaining micro-samplers in clamshell.

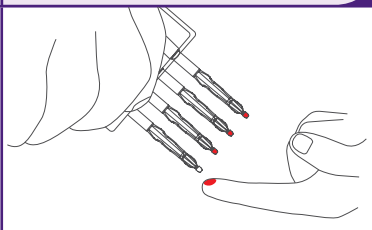

#### Step 4

Unfold clamshell to cover micro-samplers and press firmly on both sides of clamshell until a click is heard.

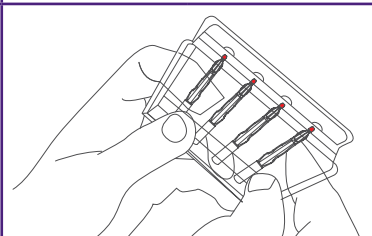

#### Step 5

Micro-samplers secured in clamshell can be immediately placed in bag with desiccant (1 g per each 10 µL micro-sampler or 2 g per each 20 µL micro-sampler) or dried in the open air under ambient conditions (~3 hrs).

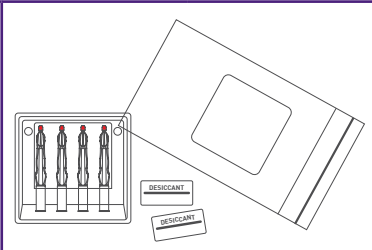

#### Step 6

Dried micro-samplers can be stored, transported, or extracted for analysis.

The Mitra Microsampling Device is a FDA listed Class 1 device (D254956). Neoteryx complies with FDA good manufacturing practices, CFR 820 regulations, and ISO 13485.

#### Disclaimer

The Mitra Microsampler class I medical device is for direct specimen collection of blood and other biological fluids. It is not specific to any clinical test nor does it provide a clinical diagnostic outcome of any nature. Clinical diagnostic laboratories, using the Mitra device for specimen collection, must validate tests according to their organizational needs.



Neoteryx LLC  
421 Amapola Avenue  
Torrance, CA 90501, USA  
310-787-8747  
[www.neoteryx.com](http://www.neoteryx.com)



Neoteryx LLC  
C/O - DBSL  
De Asselen Kuil 12  
6161RD Geleen  
The Netherlands