

Akamai
Westford Office
Westford, MA

Project Partners
Packard Design
STV | DPM

Trends
Attract + Retain
Brand + Culture
Sustainability
Wellbeing

Solutions
Furniture



Casual Lounge | Photos © Damianos Photography

In a fast-forward world, Akamai's Westford office celebrates their connected culture.

Akamai, a leading provider of content delivery network and cloud services, pushes the envelope of workplace design at their satellite office in Westford, MA—not only to engage the people working in this space but also to help them to feel part of the team. From the Central Hub, for casual and social gatherings, to the Mobility Area, with a variety of work settings, the space combines Akamai's techy culture with a casual residential atmosphere. The result is a vibrant and inspirational place for people to work, collaborate and socialize with colleagues.

Brand presence unites

Located 25 miles west of their Cambridge headquarters, Akamai wanted their people to feel welcomed and connected to the company culture. Unique signage in the Central Hub using the "smoot" unit of measurement (a non-standard, humorous unit of length created as part of an MIT fraternity prank) illustrates the distance between Westford and Cambridge, and pays homage to the founders' background at MIT. To foster communication and reinforce their inclusive culture, leadership streams "All Hands" meetings in the training/meeting room and each worldwide satellite location. The Central Hub is the social gathering place, offering beverages, grab-and-go snacks and a ping pong table. So whether you visit the office in Westford or Munich, the global standards ensure that everyone has a consistent experience—from interfacing with technology to working at adjustable-height worksurfaces.

Pushing the boundaries

Akamai's Westford office successfully blends corporate worksettings with a residential aesthetic and bold color palette, creating a relaxed and inviting environment that celebrates company culture. Reclaimed wood accents, a living plant wall and plant troughs reflect their commitment to sustainability. The Mobility Area, designated for people without assigned workspaces, offers digital daily-use lockers, Steelcase Gesture ergonomic seating, standing-height tables and stools for collaboration, and private huddle spaces for intimate conversations, quiet thinking or focused work.

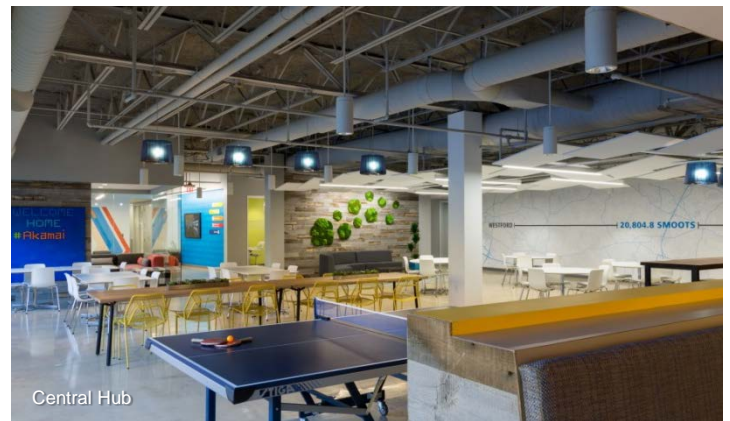

Central Hub



Mobility Area