

2600 HANDLAMP ON -XPI P/N'S

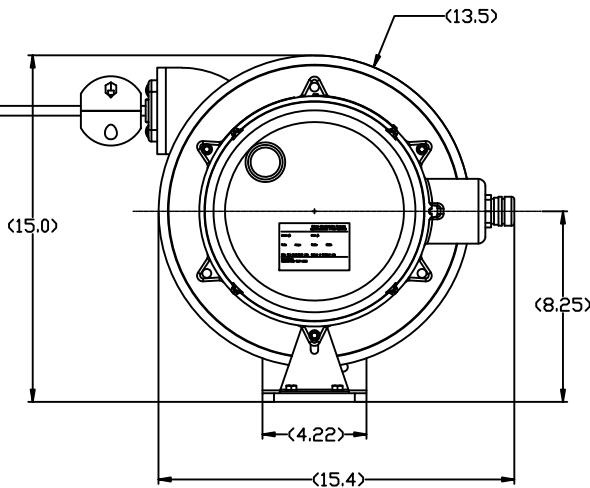
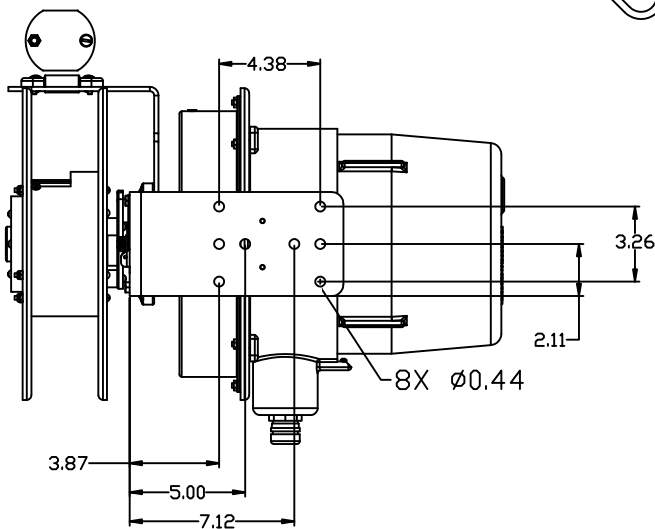
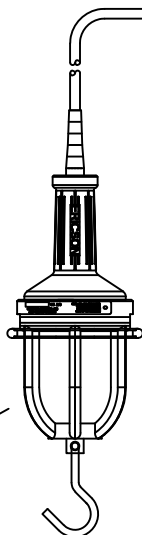

NOTES:

- 1) GRAY EPOXY PAINT FINISH STANDARD.
- 2) OVERALL SIZE 15.00H X 13.5 DIA.
(SPOOL WIDTH VARIES BY CABLE LENGTH)
- 3) ONE CONDUCTOR GROUNDED TO REEL.
- 4) INCLUDES RATCHET AND BALLSTOP.
- 5) 12 POSITION ADJUSTABLE CABLE GUIDE
- 6) TYPE SOOW EXTRA HARD SERVICE CORD STANDARD.
- 7) REEL RATING NEMA 9 AND NEMA 4 (IP56)
CLASS I DIVISION 1 GROUPS C&D
CLASS II DIVISION 1 GROUPS E,F&G
CLASS III DIVISION 1 FIBERS & FLYINGS
CLASS I ZONE 1: AEx d IIB, EX d IIB
- 8) UL LISTED FOR 3 & 4 CONDUCTOR CABLE
SEE CHART FOR UL STATUS.
- 9) APPROX WEIGHT 75 LBS LESS CABLE.
- 10) 6 FT BLUNT FEEDER CORD INCLUDED.
- 11) SLIP RING MAX RATING 600V 35A.
SEE CHART FOR ELECTRICAL RATING.

CONTRACTOR/ END USER DESIGN APPROVAL
COMPANY:
APPROVAL ENGR/ELECTRICIAN (PRINT NAME):
SIGNATURE:
DATE:

REV	REVISION DESCRIPTION	DATE	BY	CHKD	ECN NO.
A	INITIAL DESIGN				

TOLERANCES
 FRAC. ± 1/64
 .X ± .015
 .XX ± .010
 .XXX ± .005
 ANGLES ± 1°
UNLESS OTHERWISE SPECIFIED
DO NOT SCALE
 B SIZE

DWG. APPROVALS	DATE	REV.

DRAWN RWH 5/2/18
 CHK'D _____



ERICSON
 SAFETY IS OUR STANDARD

ERICSON MANUFACTURING COMPANY
 1-800-ERICSON • www.ericson.com

DWG. TITLE 8000 SERIES CABLE REEL FAMILY DRAWING		
SCALE NTS	PROJ NO. --/--	SHEET 1 OF 2
DWG. UNIT NO. 8000 SERIES FAMILY		REV A

STANDARD REELS

EMC PN	REV	DESCRIPTION	UL	NEMA	VOLTS	AMPS	WATTS
8103-80	A	CBL REEL, XP, 80' #10/3 SO	YES	9/4	600	15	9000
8123-30	A	CBL REEL, XP, 30' #12/3 SO	YES	9/4	600	15	9000
8143-20	A	CBL REEL, XP, 20' #14/3 SO	YES	9/4	600	15	9000
8143-30	A	CBL REEL, XP, 30' #14/3 SO	YES	9/4	600	15	9000
8143-40	A	CBL REEL, XP, 40' #14/3 SO	YES	9/4	600	15	9000
8143-50	A	CBL REEL, XP, 50' #14/3 SO	YES	9/4	600	15	9000
8143-100	A	CBL REEL, XP, 100' #14/3 SO	YES	9/4	600	15	9000
8144-20	A	CBL REEL, XP, 20' #14/4 SO	YES	9/4	600	12	7200
8144-40	A	CBL REEL, XP, 40' #14/4 SO	YES	9/4	600	12	7200
8144-50	A	CBL REEL, XP, 50' #14/4 SO	YES	9/4	600	12	7200
8163-20	A	CBL REEL, XP, 20' #16/3 SO	YES	9/4	600	10	6000
8163-40	A	CBL REEL, XP, 40' #16/3 SO	YES	9/4	600	10	6000
8163-50	A	CBL REEL, XP, 50' #16/3 SO	YES	9/4	600	10	6000
8164-20	A	CBL REEL, XP, 20' #16/4 SO	YES	9/4	600	8	4800
8164-40	A	CBL REEL, XP, 40' #16/4 SO	YES	9/4	600	8	4800
8164-50	A	CBL REEL, XP, 50' #16/4 SO	YES	9/4	600	8	4800

REELS WITH 2600 HANDLAMPS

EMC PN	REV	DESCRIPTION	UL	NEMA	VOLTS	AMPS	WATTS
8143-20-XPI	B	CBL REEL, XP, 20' #14/3 SO W/ 2600 HANDLAMP	NO	9/4	125	0.8	100
8143-40-XPI	B	CBL REEL, XP, 40' #14/3 SO W/ 2600 HANDLAMP	NO	9/4	125	0.8	100
8143-50-XPI	B	CBL REEL, XP, 50' #14/3 SO W/ 2600 HANDLAMP	NO	9/4	125	0.8	100
8163-20-XPI	B	CBL REEL, XP, 20' #16/3 SO W/ 2600 HANDLAMP	NO	9/4	125	0.8	100
8163-40-XPI	B	CBL REEL, XP, 40' #16/3 SO W/ 2600 HANDLAMP	NO	9/4	125	0.8	100
8163-50-XPI	B	CBL REEL, XP, 50' #16/3 SO W/ 2600 HANDLAMP	NO	9/4	125	0.8	100

REV	REVISION DESCRIPTION	DATE	BY	CHKD	ECN NO.
A	INITIAL DESIGN				

TOLERANCES
 FRAC. ± 1/64
 .X ± .015
 .XX ± .010
 .XXX ± .005
 ANGLES ± 1°
 UNLESS OTHERWISE SPECIFIED
DO NOT SCALE
 B SIZE

DWG. APPROVALS	DATE	REV.
_____	_____	_____
_____	_____	_____
_____	_____	_____

DRAWN RWH 5/2/18
 CHK'D _____



ERICSON
 SAFETY IS OUR STANDARD
 ERICSON MANUFACTURING COMPANY
 1-800-ERICSON • www.ericson.com

DWG. TITLE
**8000 SERIES CABLE REEL
 FAMILY DRAWING**

SCALE NTS	PROJ NO. --/--	SHEET 1 OF 2
DWG. UNIT NO. 8000 SERIES FAMILY		REV A