

ST. FRANCIS CENTER FOR ASSISTED LIVING

At the **St. Francis Center for Assisted Living**, you have the best of all worlds: privacy and the reassurance that experienced, compassionate team members are always nearby.

APARTMENT STYLE	MONTHLY FEE
Deluxe studio	\$3,440
Deluxe efficiency	\$3,740
One-bedroom	\$4,180
Second person	\$800

*Expanded Services \$450



The Esquiline
A Life Plan Community at the Shrine

AMENITIES

- Spacious, bright, private apartments with full baths, kitchenettes and expansive picture windows
- Medication administered by licensed nurses
- Friendly reminders for events and appointments
- Dietary planning consulting
- Medical Director
- Care Consultation Team
- On-site dentist and mobile eye care, podiatry and hearing aid clinic
- All utilities and cable television (except telephone), including audio descriptions for the visually impaired
- Temperature control in apartments
- Three delicious meals per day
- Bathing assistance
- 24/7 support
- Weekly housekeeping, with linen service
- Scheduled transportation
- Emergency response system with personal pendant
- Enriching programming seven days per week
- Free Wi-Fi

726 Community Drive, Belleville, IL 62223
Toll-free: 800-533-6279 | Local: 618-394-6400
TheEsquiline.org

FLOOR PLANS

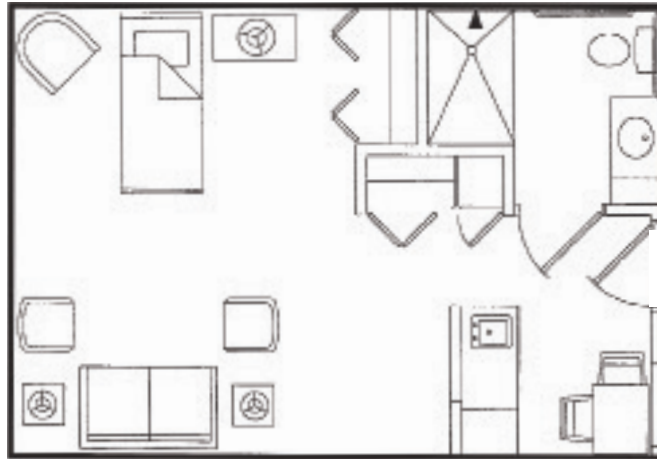

DELUXE STUDIO

369 square feet

DELUXE EFFICIENCY

438 square feet

ONE-BEDROOM

556 square feet

