

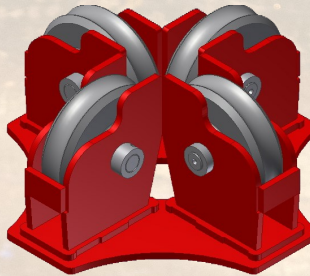

## RADIO CONTROLLED SINGLE LINE - MODEL PLSLR-7

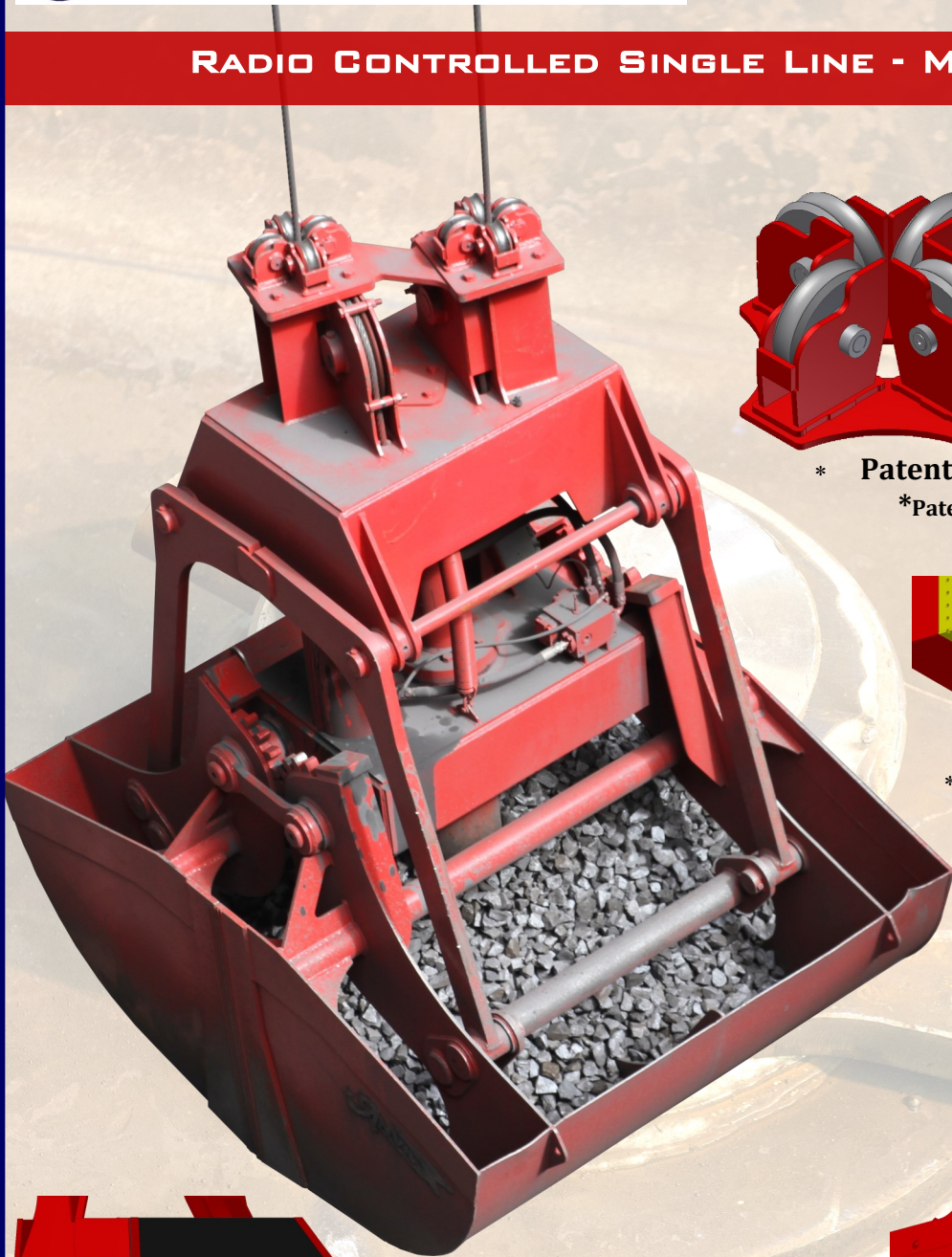

\* **Patented Cluster Sheaves**  
\*Patent No. 7,607,643

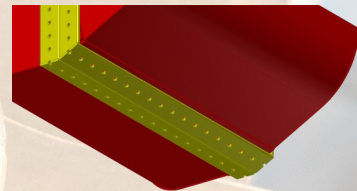

\* **Bolt-On Reversible Edges**

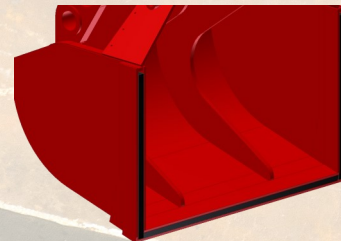

\* **Bolt-On Sealed Lip**  
\*Patent No. 9,388,023\*

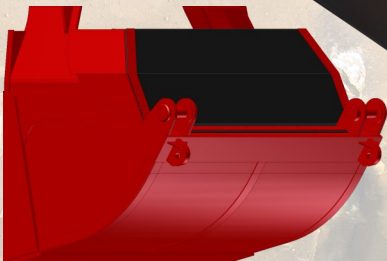

\* **Bolt-On Rubber Covers**

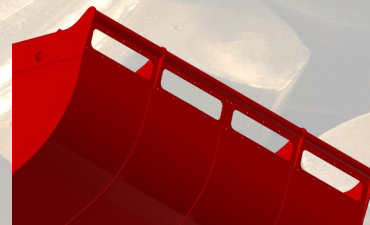

\* **Removable Spillways**  
\* **Bolt-On Stop Wedges**

— Material upgrades available for pins, bushings, lips and bowl plates

**ONE YEAR WARRANTY AGAINST MANUFACTURER DEFECTS**



**RADIO CONTROLLED SINGLE LINE CLAMSHELL BUCKET - MODEL PLSLR-7**

Capacity (Heaped)	Length Open	Length Closed	Height Open	Height Closed	Width	Deck Area (Sq Ft.)	Sheave Diam. O.D.	Max Oper. Ht.	Standard Wt. (lbs)	Light Wt. (lbs)
7 cubic yard	12' 3"	9' 5"	13' 1"	12' 0"	7' 2"	88	16"	24' 0"	13,000	11,800
8 cubic yard	12' 3"	9' 5"	13' 9"	12' 9"	7' 8"	94	16"	24' 0"	14,800	13,500
9 cubic yard	12' 3"	9' 5"	13' 9"	12' 9"	8' 1"	99	16"	24' 0"	15,400	14,200
10 cubic yard	11' 1"	9' 8"	13' 9"	12' 9"	8' 7"	107	18"	28' 0"	17,500	15,500
11 cubic yard	11' 3"	9' 8"	13' 9"	12' 9"	9' 3"	115	18"	28' 0"	17,580	15,850
12 cubic yard	11' 5"	9' 8"	13' 9"	12' 9"	10' 1"	125	18"	28' 0"	18,700	16,200
13 cubic yard	11' 7"	9' 11"	13' 9"	12' 9"	10' 3"	136	18"	28' 0"	18,850	16,550
14 cubic yard	12' 3"	11' 2"	13' 9"	12' 9"	10' 10"	145	18"	28' 0"	19,250	16,900
15 cubic yard	12' 10"	11' 4"	13' 9"	13' 6"	11' 5"	155	18"	28' 0"	19,500	17,250
20 cubic yard	14' 4"	10' 6"	15' 2"	14' 6"	12' 6"	179	20"	35' 0"	21,200	18,850

- Designed for ships-gear or overhead cranes with a single point hook.
- Simple "hook-on" style with no cable to reeve.
- Unit is shipped complete with transmitter and battery charger, ready to use.
- State of the art electronics ensures safety from outside radio interference
- Lip and bowl plates are made of T-1 (514) steel for greater wear resistance.
- One piece manifold reduces hydraulic hoses
- Simple hydraulic system eliminates motors and pumps
- Back up manual rope pull is included
- Quick cycle times with non-jarring opening motion
- Unit has the ability to be partially opened in mid-air for filling hoppers, trucks, etc. of varying sizes

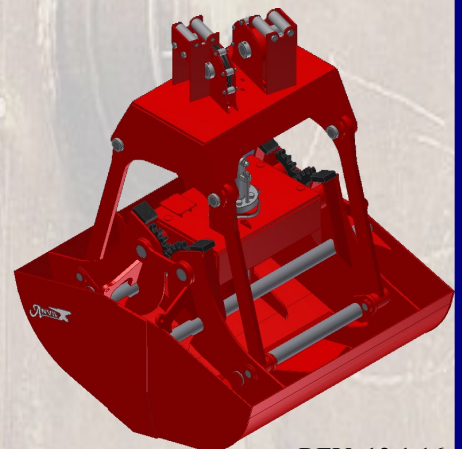

REV. 12.1.16