

CP-ONE PLUS



Thinking of All

Thinking of Communication

Thinking of Patient Comfort

Thinking of Operator Comfort

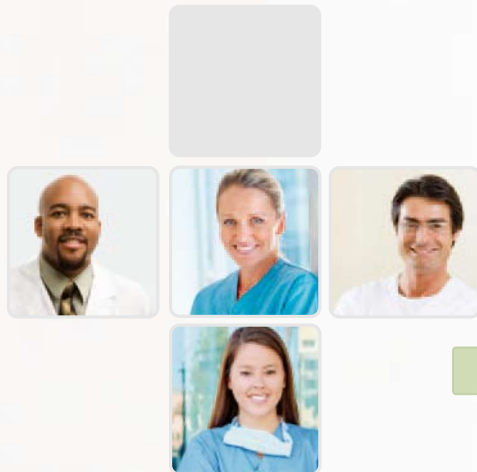

CP-ONE PLUS: Thinking of All

A dental unit thought out from all perspectives.

The dental chair and unit are the key factors in ensuring safe care with accurate diagnosis, precise treatment, and reliable counseling.

The CP-ONE PLUS was designed by incorporating doctors' requirements and desires one by one, from the treatment space all the way down to minute details that will be recognized through doctors' fingertips.

An ideal treatment environment, the CP-ONE PLUS is the **Thinking of All** dental chair and unit, the answer to doctors' aspirations, made possible only through the fusion of the expertise and technological leadership of Takara Belmont.

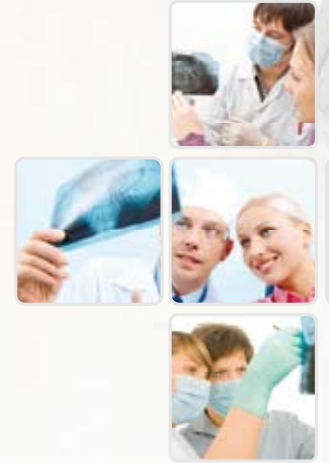

Thinking of Communication

The CP-ONE PLUS is the successor to the CP-ONE, or Communication Product No. 1.

What is communication through the CP-ONE PLUS?

Relaxing the patient is the first step towards providing efficient treatment and facilitating informed consent.

The CP-ONE concept allows for communication in any position. Patients are able to communicate their needs and level of comfort, and doctors are able to communicate their intentions and explanations.

The CP-ONE PLUS succeeds in taking the concept of the CP-ONE and improving it with the latest functionality.



Monitor bracket (optional)

A monitor mounted on the doctor table will encourage more effective communication, especially in terms of informed consent.

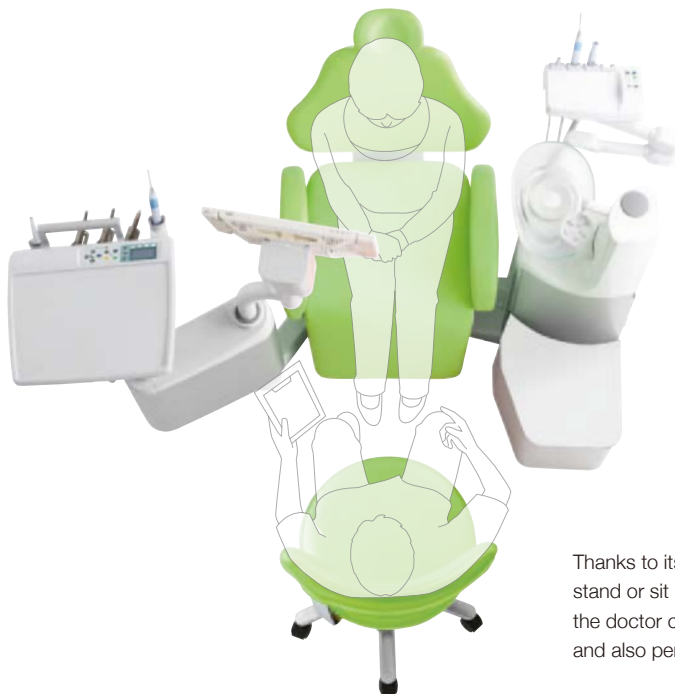

Thanks to its folding legrest chair, the doctor can stand or sit directly in front of the patient, the doctor can take a face to face communication and also perform an accurate check-up.

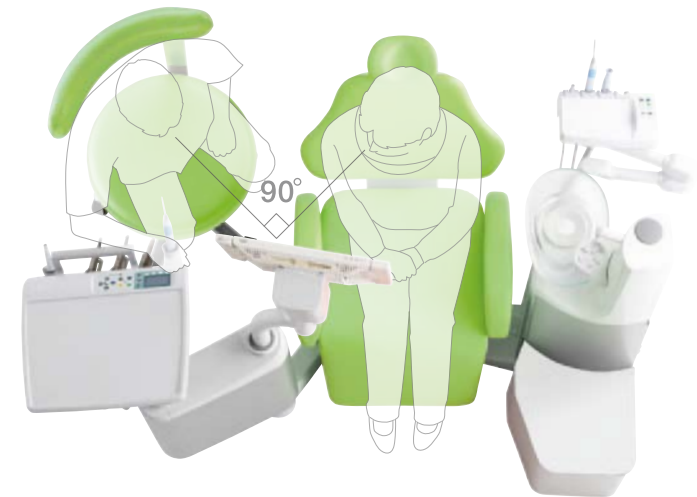

The CP-ONE PLUS, like the CP-ONE, provides a 90-degree eye-contact position that allows the viewpoints of both the patient and the doctor to converge. The 90-degree eye-contact position is conducive to a natural, stress-free atmosphere for discussion and provides for relaxed, thorough communication.



Thinking of Patient Comfort

The dental chair is the medium through which the patient entrusts him/herself. The CP-ONE PLUS chair has been ergonomically and luxuriously designed to provide true comfort for all patients in addition to reliability.

The CP-ONE PLUS is not only a dental chair and unit, but a communication tool that builds trust.

Folding legrest chair with a low initial height of 400 mm

Sitting down and getting up is easier for children, the elderly, and those with limited mobility, as the chair can be accessed either from the side or directly from the front. A legrest heater is available as an option.

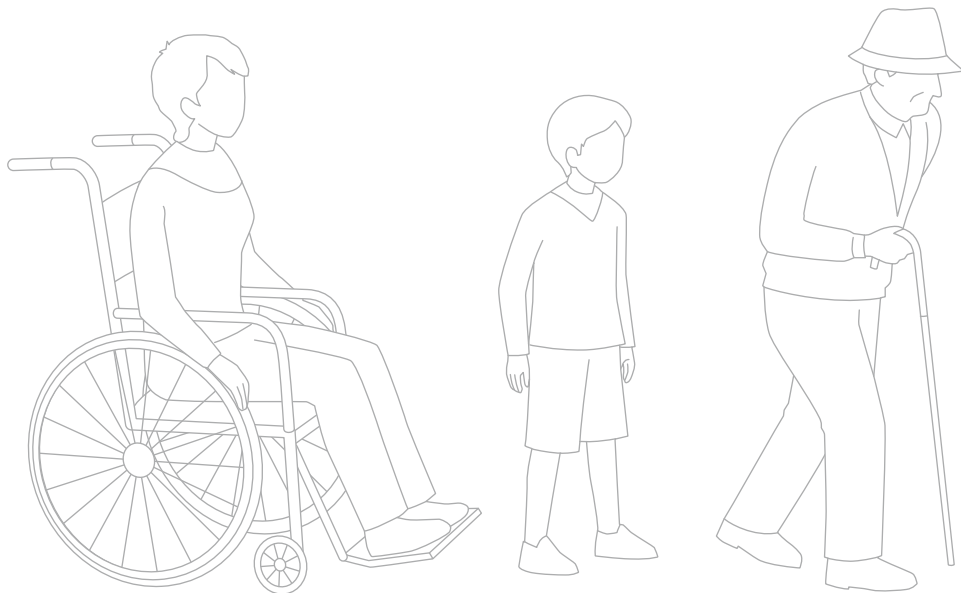

New shockless system

The new shockless system (slow slide valve) eliminates any jarring movements of the chair, keeping the patient calm and comfortable for a stress-free treatment.

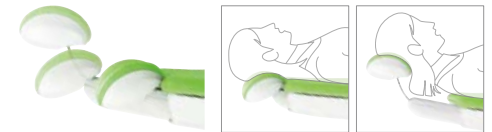

Hydraulic-powered headrest

The axis headrest is designed based on ergonomic analysis of the head and its movement. The doctor can adjust the headrest position from the table or stick switch.



Slim type armrest (optional)

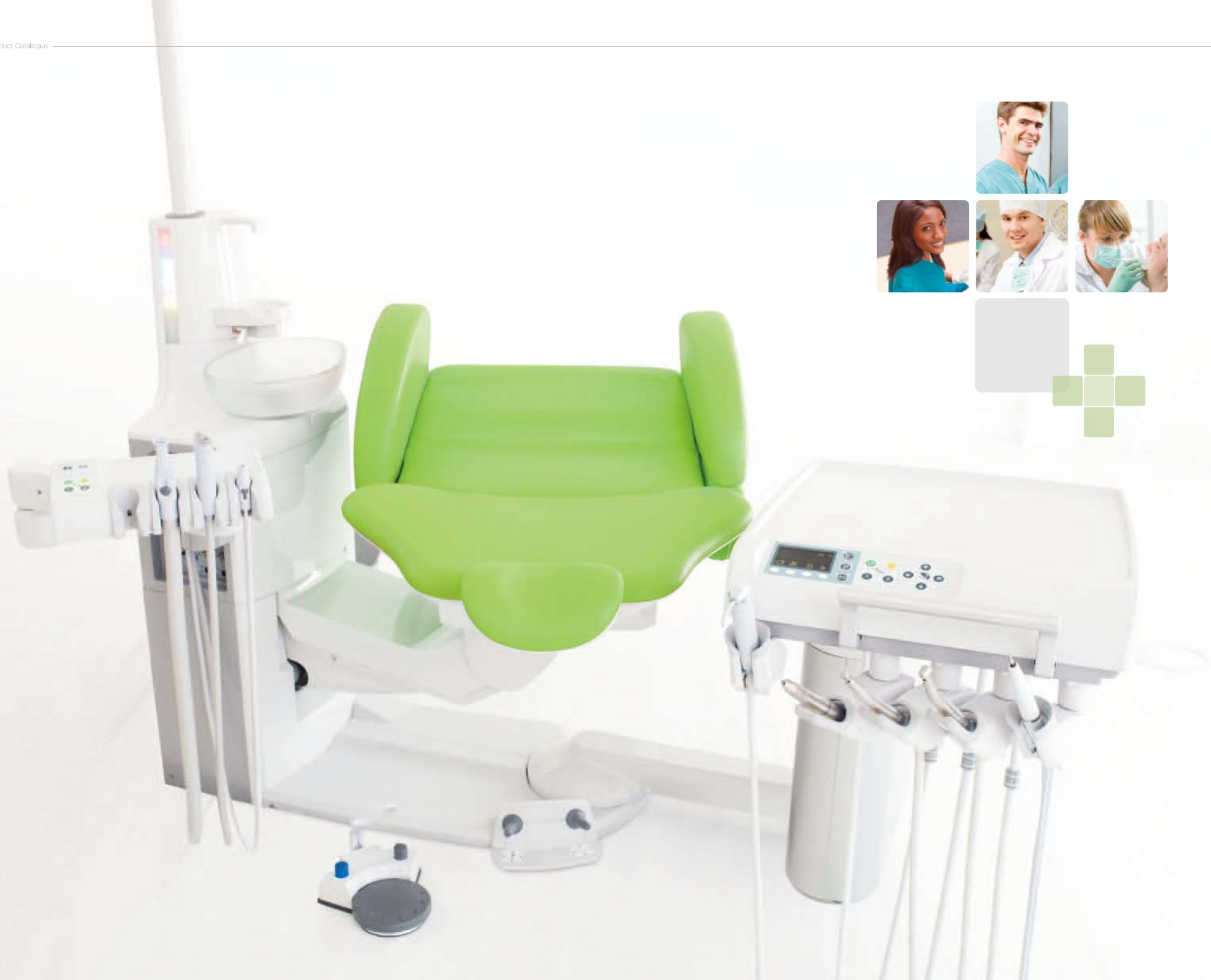

Thinking of Operator Comfort

The CP-ONE PLUS not only addresses operators' daily requirements, but also meets unfulfilled demands. The doctor table provides an extra smooth transfer of instruments into and from the holder, a high level of visibility with the organic EL display, and a simple interface for various controls that encourage the doctor to concentrate his/her treatment without stress.

Wide range of positioning

Inherited from the CP-ONE is the arc delivery system; the doctor table can be smoothly moved for the 6 to 2 o'clock position. Furthermore, with the expanded assistant's area, it is compatible with 2-hand, 4-hand, and 6-hand operations.



2-hand

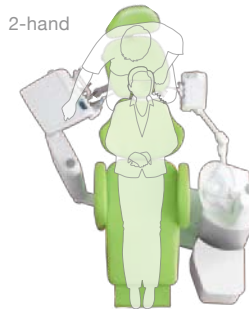

4-hand



6-hand



Newly developed foot controller

It is controlled by pressing and/or turning the disk, which provides precise handpiece control.



New stick switch for chair and/or headrest control

Easy to operate chair (manual and/or preset position) and/or headrest controls keep hands sterile. One is standard, and an extra is optional to provide further functionality.

Doctor Table

HANDPIECE



HANDPIECE DELIVERY

The redesigned handpiece holder is adjustable horizontally and vertically, which ensures that the doctor always has his tools within easy reach. Two types of handpiece storage are available, holder type and place type. Both types are detachable and autoclavable for hygiene control. The height of the new doctor table is easily adjustable (100 mm) without any special tools.

New control panel

Versatile function with a simple, intuitive control panel and highly viewable organic EL display

SIMPLE INTERFACE

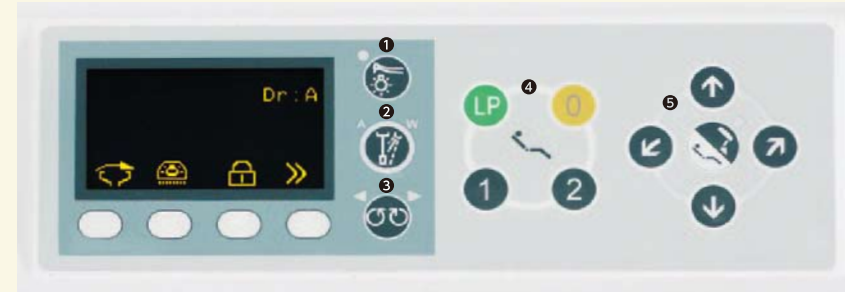

Membrane Switch

- ① Handpiece light On/Off
- ② Handpiece air/water control
- ③ Micromotor direction control
- ④ Chair control (preset position)
- ⑤ Chair and headrest manual control

DIGITAL INDICATOR



Hi-speed turbine control
4 types of power modes are available.
(LL→LOW→STD→HI)

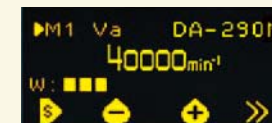

Micromotor control
Highly configurable power control between 100 to 40,000 rpm.



Ultrasonic scaler control
Power control by 10 steps (1→10) for Scaling/Perio/Endo mode respectively

Cuspidor Bowl and Assistant Holder



Motorized cuspidor bowl (optional)

New cup filler sensor

Various types of cups (paper, plastic, stainless) can be used by weight sensor.

New assistant table with intuitive control panel

Handpiece holder is detachable and autoclavable.



- 1 Chair preset switch
- 2 Chair auto return switch
- 3 Chair last position switch
- 4 Cup filler switch
- 5 Bowl flush switch
- 6 Dental light switch
- 7 Extra switch

Optional Features



*Articulate balance arm
for assistant holder*

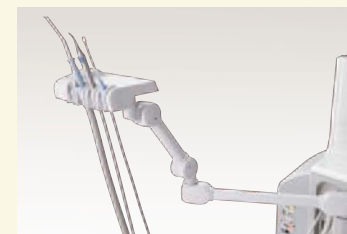

Longer arm for doctor table



*Large cuspidor unit cover
for amalgam separator*



Dental Light

Monitor bracket on light post



Monitor bracket



Amenity box on junction



Slim type armrest



Clean water system



900 Dental Light Type 920 (LED)



Basic Specifications

- **Focal distance:** 650 mm
- **Color temperature:** 5,000 Kelvin at any intensity
- **Color rendering index:** more than 90
- **Light intensity:** 4,000–32,000 lux
stepless control
- **Light intensity composite mode:** 5,500 lux
- **LED modules:** 10
- **Power requirement:** 100–240 VAC
- **Light pattern:** 85 x 155 mm



Halogen Bulb Dental Light

io5000TA triple-axis dental light



Lineup

LINEUP

BASE MOUNT TYPE



CART TYPE



COLOR VARIATION



CP-ONE PLUS DIMENSIONS

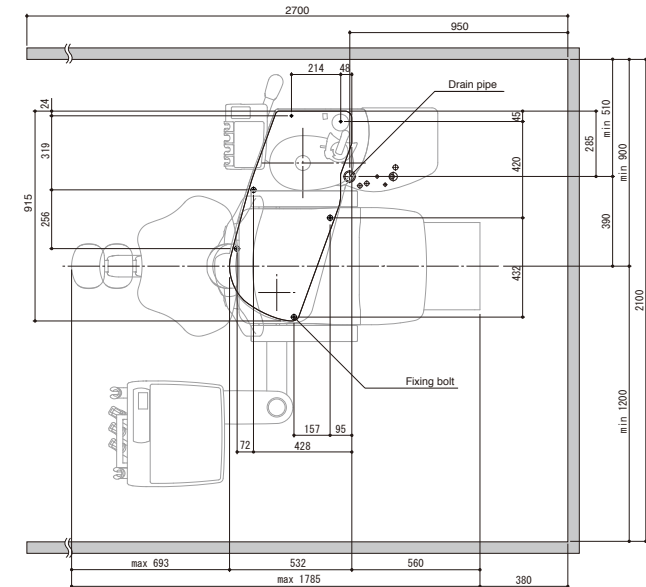
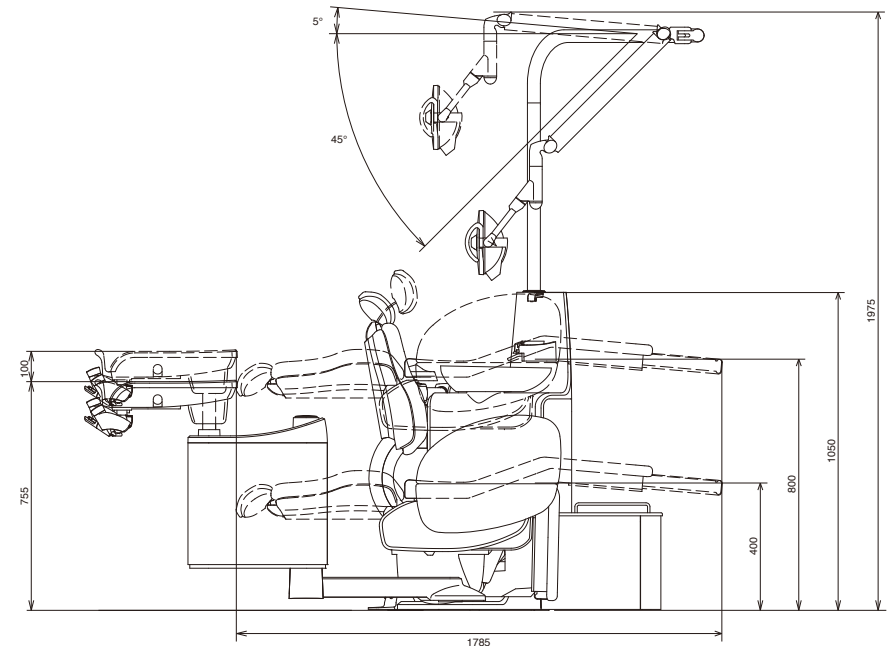



Takara Belmont Corporation

2-1-1, Higashi-shinsaibashi, Chuo-ku, Osaka 542-0083, Japan
TEL: +81-6-6213-5945 FAX: +81-6-6212-3680

The specification and colors are subject to change without notice.
The handpieces depicted throughout this brochure are not necessarily included.