

Amerec's Auxiliary Switch option for the AX steamer.

The Auxilliary kit contains an R30i control with a 50ft [15,2 m] cable and an adapter assembly for connection to the steamer circuit board. This switch works with the the A6 Touch Control or the A3 control to provide an extra steam bath on/off control.

The A6 or A3 control is used to set the bath temperature and the length of the bath before the steamer is turned off automatically.

When used with an A3 control (and without an A6):

The Aux. switch will start and stop a steam bath using the same bath time and temperature as previously set by the A3.

When used with an A6 control:

1. Go to the tools menu on the A6 then
2. Select the External Switch menu then
3. Set the Bath time to the desired time before the bath automatically stops. This time will be unique to the Aux. switch. The bath times set by the A6 for baths it starts and stops will still be adjustable by the A6 users. Press the green check mark to save the new bath time setting.
4. Select Function
 - a) Set the Function to On/Off:
 - * the switch will start or stop a bath
 - * if the A6 has started a bath, pressing the Aux. switch will stop that bath, pressing it again will start a new bath using the External switch time setting. *The A6 may be used to stop a bath started by the Aux. switch.*
 - * the bath temperature will be the same as previously set by the A6.
 - b) Set the Function to Renew:
 - * the Aux. switch will start a steam bath for the External switch's bath time setting time setting. The bath will run until it automatically times out.
 - * if the A6 has started a bath, pressing the Aux. switch in Renew mode will do nothing. Once the A6's bath is stopped, the Aux. switch may be used to start a bath. *The A6 may be used to stop a bath started by the Aux. switch.*
 - * the bath temperature will be the same as previously set by the A6.
5. When the Aux switch set up is complete, return to the Home menu.

Aux. switch light:

- * Whenever the steam bath is on and working normally, the Aux. switch should light.
- * Whenever the system is in an error mode, the Aux. switch should be blinking on and off.

Also see Amerec document 4211-146 Installation and Operating instructions

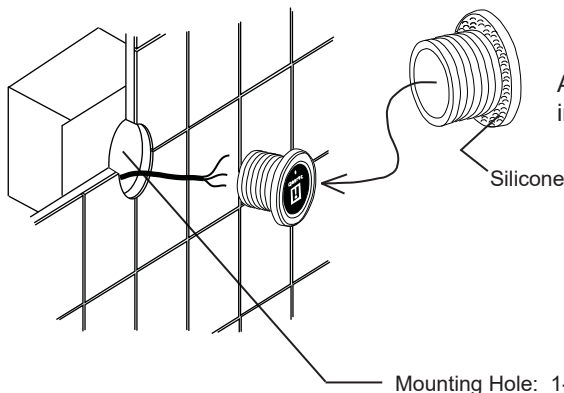
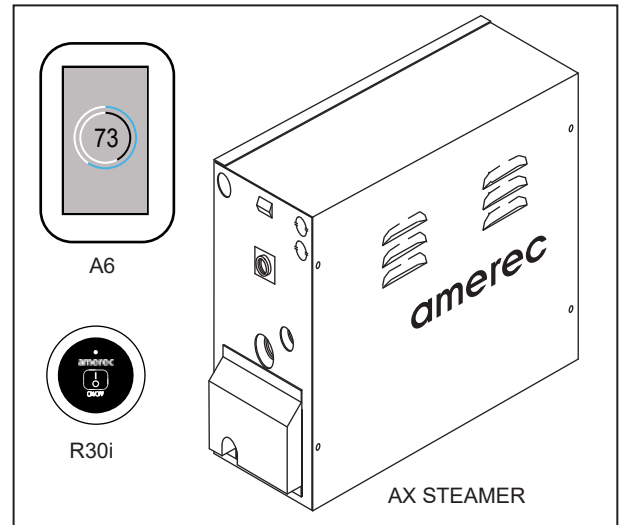

After installing and test the switch and its cabling, insert the switch in the wall and seal it in place with 100% silicone as shown.

amerec

Technical Support
 PO Box 2258
 Woodinville, WA 98072
 Phone 1-800-363-0251
 FAX 425-951-1130
 email: support@amerec.com

INSTALLATION

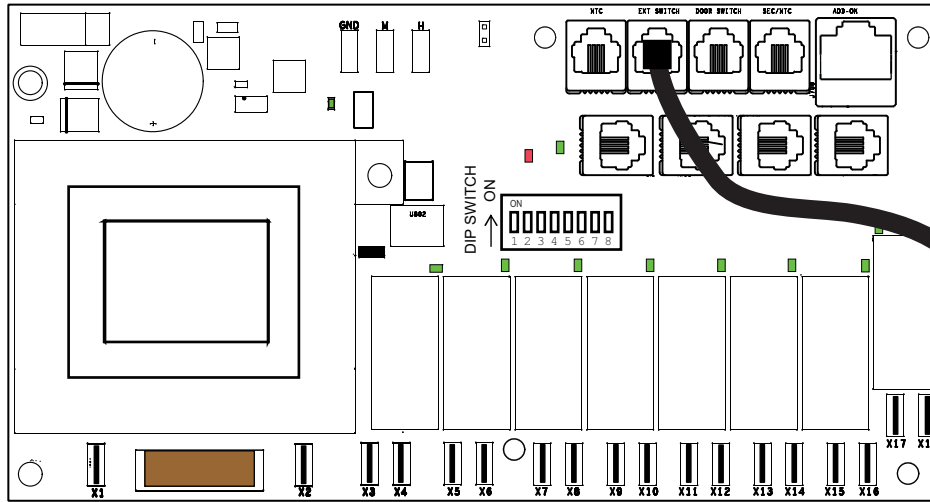

1. Connect the cable from the Aux switch's terminal block to the EXT SWITCH jack as shown above.

2. Mount the terminal block to its mounting holes in the shelf using the two #4 x 3/4 inch self threading screws (provided).

3. Place the terminal block label (provided) in front of the terminal block as shown below.

4 connect the three conductor cable (provided) to the terminal block as shown. Note the wire color for each position - you will need this information when connecting the cable to the Aux switch.

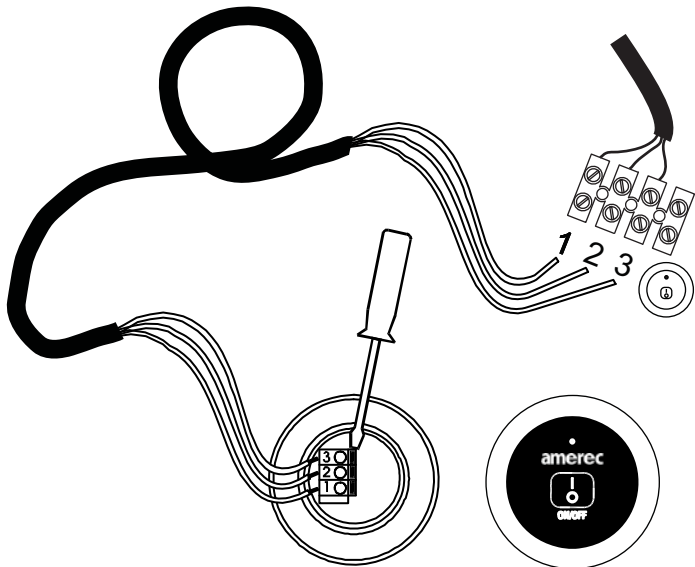
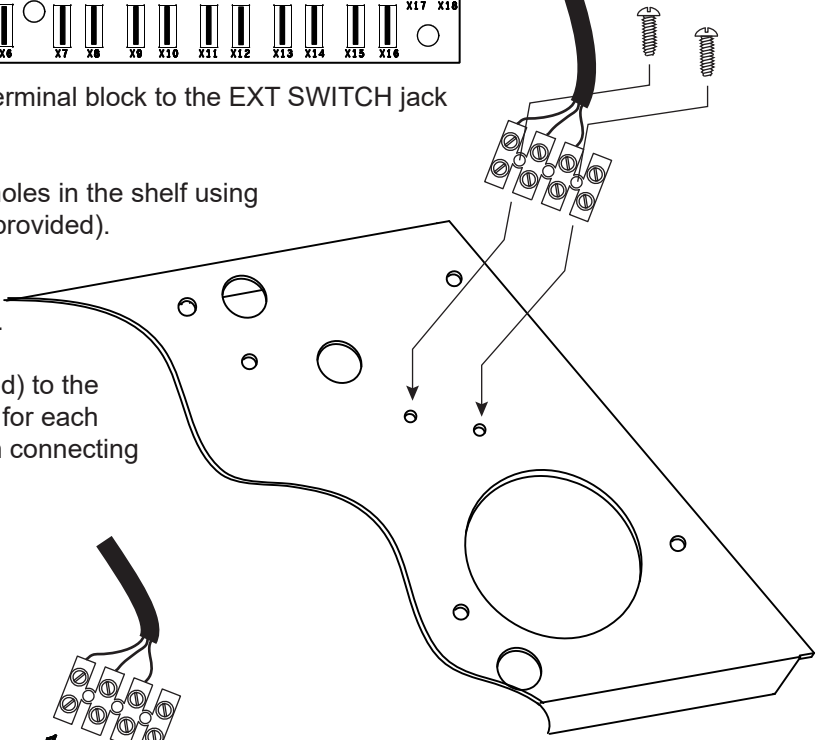

At the Aux switch:

5. With the cable end sticking through the control mounting hole, connect the cable's conductors to the terminal block on the back of the control.

Be sure to match colors and position number to the connections in the steamer!

6 Test the control. If it is working properly, install the control in its mounting hole.