

INSERTION LEVEL SWITCHES

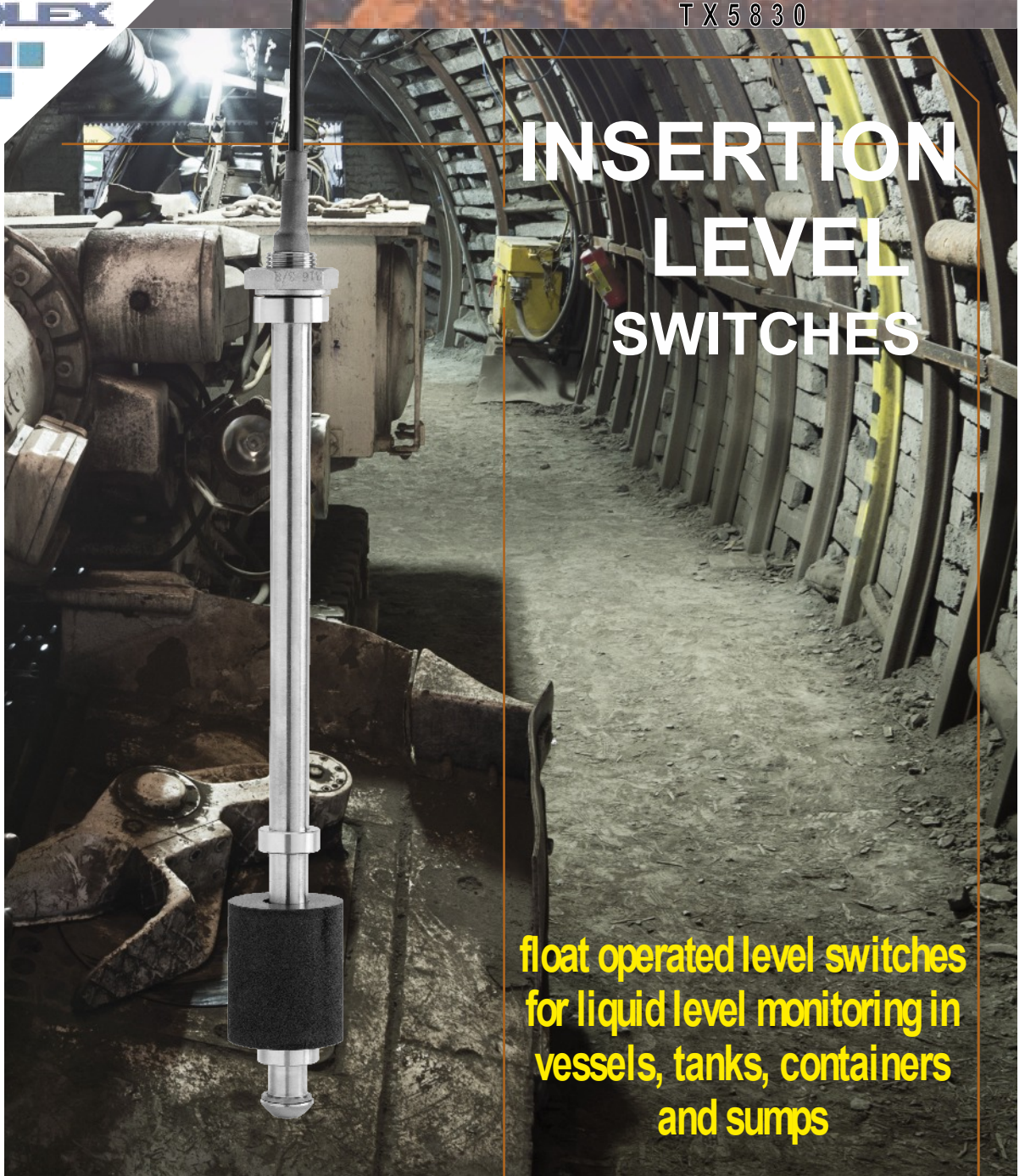

float operated level switches for liquid level monitoring in vessels, tanks, containers and sumps

- TUNNELS
-
- MINING
-
- RESERVOIRS
-
- PUMPING
INDUSTRY

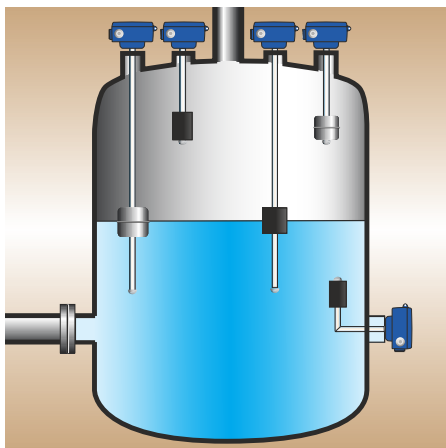

versatile

- Top-of-tank insertion with a choice of mounting options for fuel tanks, storage containers, power packs, cooling systems, process vessels and food processing.
- Stainless steel construction, available in two sizes for medium and heavy duty applications.
 - Up to five output contacts.



standard level switches...

with a choice of **FLEXIBLE CABLE CONNECTION OR TERMINAL HOUSING**

12mmØ CONTACT TUBE up to 2000 metres long

...simple
safety
monitoring

TX5831
G 3/8" BUSH MOUNTING
(Supplied with fixing nut)



Flexible Cable

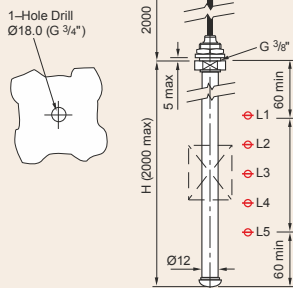

Terminal Housing

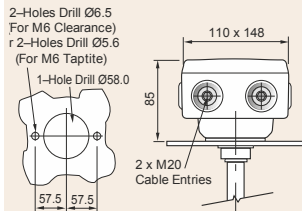

Recommended Floats

- 37mm Ø Phenolic Foam (32)
- 55mm Ø Stainless Steel (34)

TX5832
G1 1/2" BUSH MOUNTING



Flexible Cable

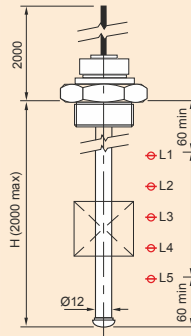

Terminal Housing

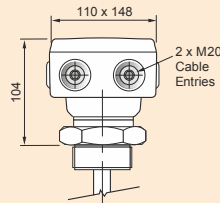

Recommended Floats

- 37mm Ø Phenolic Foam (32)

TX5833
G2" BUSH MOUNTING



Flexible Cable

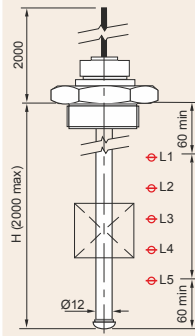

Terminal Housing

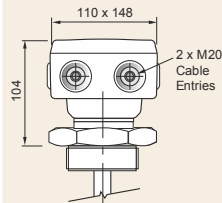

Recommended Floats

- 37mm Ø Phenolic Foam (32)
- 55mm Ø Stainless Steel (34)

TX5834
BS4504 FLANGE MOUNTING
(Other Flange Formats Available)



Flexible Cable

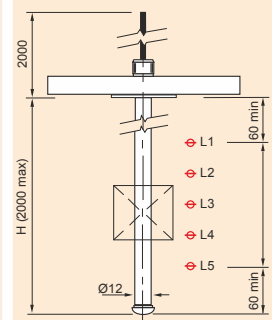

Terminal Housing

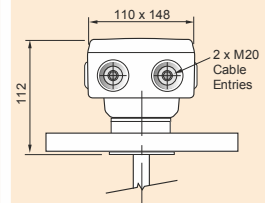

Recommended Floats

- 37mm Ø Phenolic Foam (32)
- 55mm Ø Stainless Steel (34)

ALL DIMENSIONS IN MM



...simple
safety
monitoring

technical details...

Temperature Limits:	-10...80°C with phenolic foam float.	-10...150°C with stainless steel float.
Maximum Static Pressure:	5 bar with phenolic foam float.	20 bar with stainless steel float.
Switching Point Accuracy:	±3mm.	
Mounting Attitude:	Vertical ±30°C.	
Protection Classification:	Dust and waterproof to IP66.	
Body Material:	Stainless steel 316.	
Terminal Housing Material:	Stainless steel filled Polyamide 6.	
Electrical Connections:	Flexible Cable:	2 to 6 core flexible PVC cable, 0.75mm ² x 2m.
	Terminal Housing:	4mm barrier terminals.
Maximum Number of Contacts:	5 (sealed magnetic reed).	
Minimum Spacing Between Adjacent Contacts:	65mm.	
Contact Operation:	Close on RISING float or Close on FALLING float.	

electrical details...

Magnetic Reed Contacts: 240V ac, 0.5 Amp, 25 Watts.

N.B. Contact protection is recommended to ensure that these instantaneous ratings are not exceeded during peak in-rush or surge conditions.

Our Technical Applications Department will be pleased to assist with circuit applications.

connections...

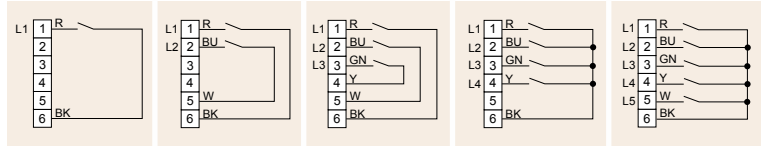

floats...

TX5801

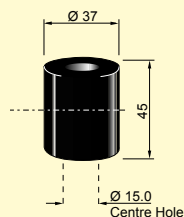

Material: Rigid Phenolic Foam.

Maximum Temperature: 80°C.

Maximum Pressure: 5 bar.

Specific Gravity: 0.4.

- Rigid, closed cell, polyester foam for general purpose applications.
- Excellent resistance to oils, seawater, acids, alkalis and solvents.

TX5802

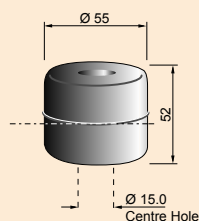

Material: Stainless Steel 316.

Maximum Temperature: 150°C.

Maximum Pressure: 20 bar.

Specific Gravity: 0.45.

- Electron beam welded and pressure tested.
- High impact strength, high temperature rating and high pressure tolerance with excellent chemical resistance.
- Food industry and petrochemical applications.



...simple
safety
monitoring

order reference...

PLEASE PHOTOCOPIY THIS SECTION AND TICK YOUR REQUIREMENTS

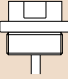
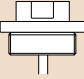
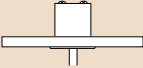
TX5831 INSERTION LEVEL SWITCH 	12mmØ CONTACT TUBE G3/8" BUSH MOUNTING	
TX5832 INSERTION LEVEL SWITCH 	12mmØ CONTACT TUBE G1 1/2" BUSH MOUNTING	
TX5833 INSERTION LEVEL SWITCH 	12mmØ CONTACT TUBE G2" BUSH MOUNTING	
TX5834 INSERTION LEVEL SWITCH 	BS4504 FLANGE MOUNTING (Please specify alternative flange format required)	

ELECTRICAL DETAILS	Flexible Cable	.11
	Stainless Steel filled Polyamide 6	.12
TYPE OF FLOAT	Rigid Phenolic Foam Ø37mm	.32
	Stainless Steel Ø55mm	.34
TYPE OF LIQUID (or specific gravity of liquid)		

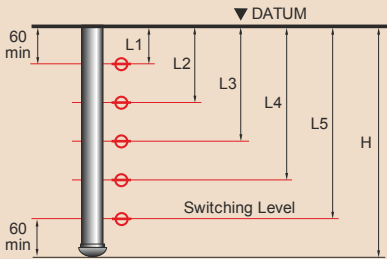
CONTACT FORMAT	Switching Level	Open on Rising	Close on Rising
 <p>Minimum spacing between adjacent contacts: 65mm</p>	L1.....mm		
	L2.....mm		
	L3.....mm		
	L4.....mm		
	L5.....mm		
	H.....mm (Standard height H= L1+60mm). Please specify preferred height if greater than L1+60mm.		

CUSTOMER:
CONTACT:
ORDER/ENQ REF:
DATE:

TROLEX LIMITED
 NEWBY ROAD, HAZEL GROVE, STOCKPORT,
 CHESHIRE SK7 5DY, UK
+44 (0)161 483 1435
sales@trolex.com
www.trolex.com