

QUALITROL TWP and JBox2

2nd Generation Junction Box and Tank Wall plate



The easiest way to get your fiber sensors out of your oil-filled power transformer tank

- Easy installation and cost-effective, elegant, solution
- Quick and secure access to fiber connections
- Universal JBox2 design: will mate with all Qualitrol / Neoptix tank wall plates (TWP)
- New rugged JBox2 design is back compatible with all tank wall plates
- Recessed bolting to TWP plate insure cover is removed first, avoiding any possible damages to internal fibers
- Now has ample room to coil all unused extension cable lengths... No more messy fiber coils in your transformer control cabinet
- Internal retaining legs allow for clean and convenient fiber coiling
- JBox2 is made of 316-Stainless Steel
- New TWP design can accommodate up to 24 OFTs (12 inch plate) or 20 OFTs (10 inch plate)

Product Summary

Description Designed for prolonged protection of fiber optic components in any environments, including off-shore. Removable cover for easy access to connections without removing the whole junction box and conduit offers optimal protection to internal fiber cables. Tank wall plates (TWP) are available in bolt-on and weld-on versions. New larger body diameter allows for convenient long term storage of extra cable length, eliminating messy fiber coils hanging anywhere in the control cabinet.

Application Protection of fiber optic connections at the tank wall interface of oil-filled power transformers.

Fibers by 



QUALITROL[®]
Defining Reliability

OFT feedthrough – TWP tank wall plate – JBox2 junction box

TWP Transformer tank wall plate, a perfect match for Neoptix optical feedthroughs (OFT)

Up to 24 OFTs on one TWP plate

- The TWP plate accommodates from 1 to 24 optical feedthroughs and plugs are available to seal any unused holes. OFTs have standard 1/4" NPT ANSI threads

Made of carbon steel or stainless steel

- As a standard item, the TWP is made of cold finished 1018 steel (carbon steel ASTM A108). It is also offers in 316 stainless steel

Can be welded or bolted

- Various versions are available: welded or bolted

Available in hundreds of combinations

- Neoptix has an extensive bank of CAD drawings, for different plate size, different number of OFT holes, different material and different sealing strategies (welding, gasket or O-ring)

Compatible corona rings are available

- Corona rings are available to make the TWP plate installation even simpler. Weld the corona ring to your transformer tank, and bolt the TWP plate to the corona ring. We even supply the sealing O-ring (viton)

Can be supplied with pre-installed OFTs

- For a small fee and for your peace of mind, TWP plates can be supplied with the OFTs pre-installed and leak tested (NXP-611)

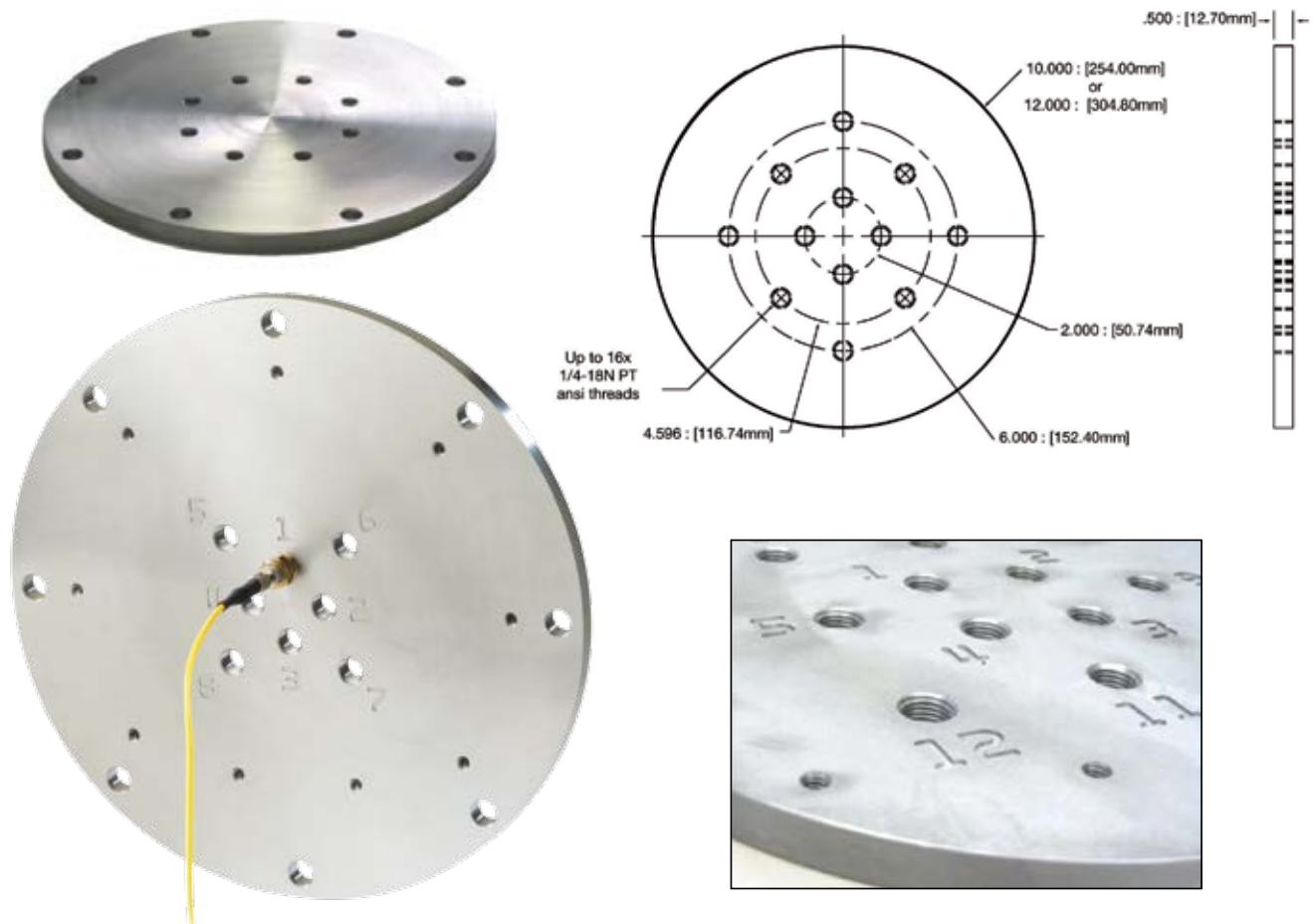



JBox2 – Junction Box

Reliable protection of fiber optic connections

- Eliminates need for drilling additional holes or welding to create a “do-it-yourself” solution for protection of fiber optic connections
- Two specially designed 1/8 inch (3.2 mm) thick neoprene gaskets (one for access cover and one for base of junction box isolate optical feedthroughs (OFT) and fiber extension cables (EXT-xxx) from harsh environmental conditions

Stainless Steel construction

- No more rusting
- No more painting required

New design with space to coil extra cable

- No more messy fiber cables hanging around in your control cabinet

Easy installation

- Access cover makes installation and fiber connections easy
- Flat surface for quick, industry-standard conduit installation

JBox2 mates with all Qualitrol / Neoptix tank wall plates

- JBox2 junction box is designed to perfectly fit with either bolt-on or weld-on tank plates

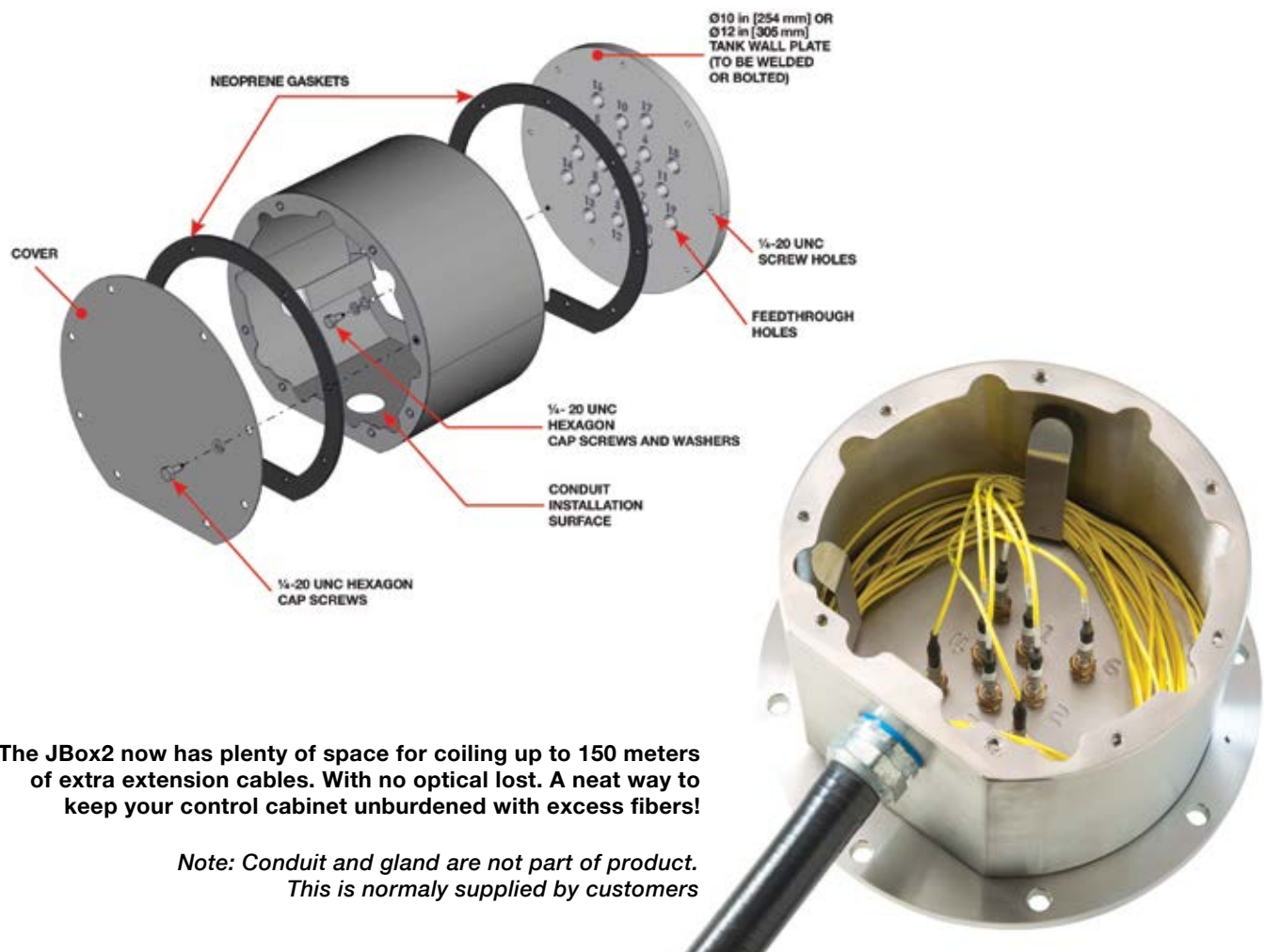

The JBox2 now has plenty of space for coiling up to 150 meters of extra extension cables. With no optical loss. A neat way to keep your control cabinet unburdened with excess fibers!

Note: Conduit and gland are not part of product. This is normally supplied by customers



TECHNICAL SPECIFICATIONS

Tank wall plate	Material	<ul style="list-style-type: none"> Standard: 1018 cold rolled steel, 0.5 inch (12.5 mm) thick Optional: Other material, such as Stainless Steel 316
	Number of feedthroughs	<ul style="list-style-type: none"> Up to 20 (10 inch version); up to 12 if corona ring is used Up to 24 (12 inch version)
	Dimensions	<ul style="list-style-type: none"> Standard: Ø 10 inches, 0.5 inch (12.5 mm) thick Optional: Ø 12 inches, 0.5 inch (12.5 mm) thick
	Mounting	<ul style="list-style-type: none"> Standard: Direct welding on tank wall Optional: Bolting pattern, for gasket or O-ring sealing
	NPT type	<ul style="list-style-type: none"> Standard: NPT 1/4-18, ANSI threads
	Compatibility	<ul style="list-style-type: none"> Compatible with Neoptix OFT optical feedthroughs
	Options	<ul style="list-style-type: none"> NXP-611: OFT installation on TWP plate (with high pressure leak testing)

Ordering code (TWP):

<p>Material: 0 = Carbon steel (Standard) 1 = Stainless steel (optional) 2 = Aluminum (optional) 3 = Other</p>	<p>Diameter: 10 = 10 inches (standard) 12 = 12 inches (optional) n = other diameters</p>	<p>Junction box holes: 0 = No (standard) 1 = Yes (optional)</p>
--	--	--

TWP- [] - M [] - D [] - F [] - J []

<p>Number of OFT: 0 = Welded (standard) 1 = 1 feedthrough n = n feedthrough 24 = 24 feedthrough</p>	<p>Fastening: 0 = Welded (standard) 1 = Bolted without O'Ring groove (optional) 2 = Bolted with O'Ring groove (optional)</p>
--	--

Corona ring	TWP compatibility	<ul style="list-style-type: none"> Designed to mate with TWP-...-F2-... 			
	Ordering code (COR):	<table border="0"> <tr> <td style="vertical-align: top;"> <p>0 = Carbon Steel 1 = Stainless Steel</p> </td> <td style="vertical-align: top;"> <p>10 = 10 inches 12 = 12 inches</p> </td> <td style="vertical-align: top;"> <p>0 = No O-ring groove 1 = With O-ring groove</p> </td> </tr> </table> <p>COR- M [] - D [] - F []</p>	<p>0 = Carbon Steel 1 = Stainless Steel</p>	<p>10 = 10 inches 12 = 12 inches</p>	<p>0 = No O-ring groove 1 = With O-ring groove</p>
<p>0 = Carbon Steel 1 = Stainless Steel</p>	<p>10 = 10 inches 12 = 12 inches</p>	<p>0 = No O-ring groove 1 = With O-ring groove</p>			

Junction box	Material	<ul style="list-style-type: none"> 14 gauge stainless steel
	Mounting	<ul style="list-style-type: none"> Bolted to tank wall plate (1/4-20-UNC SS bolts, supplied)
	Dimensions	<ul style="list-style-type: none"> Diameter: 10 inch (254 mm) Height: 6 inch (plus cover and gasket thickness)
	Finish	<ul style="list-style-type: none"> Stainless steel: unpainted
	Access cover	<ul style="list-style-type: none"> Removable. Bolted with 9 x 1/4-20 UNC SS bolts (supplied)
	Sealing	<ul style="list-style-type: none"> 2 x Neoprene gaskets, 1/8 inch (3.2 mm) thick
	Fiber capacity	<ul style="list-style-type: none"> Can safely coiled up to 150 meters of standard Neoptix extension cables (EXT-3MP-xxx)
	Conduit installation flat	<ul style="list-style-type: none"> 5 x 6 inches (125 x 150 mm) Hole must be made by user, as required
	Ordering code:	JB2-SS

About QUALITROL®:
 QUALITROL® manufactures substation and transformer monitoring and protection devices used by electric utilities and manufacturing companies. It is the global leader in sales and installations of transformer asset protection equipment, fault recorders, and fault locators. Established in 1945, QUALITROL® produces thousands of different types of products on demand, each customized to customers' unique requirements.

© 2008-2014 Qualitrol Company LLC. All rights reserved. Information subject to change without notice. Qualitrol Company LLC is an ISO 9001 system certified company. AP-M09-16L-03E-1408