



Grass Roots

www.cmcustomlawn.com

4151 S. 84 St. Omaha, NE 68127 402.738.1718

Volume 2015 Issue 3

Visit CM's at the 2015 Home Show!



Spring is around the corner, so it must be time for the Omaha Home Show. Our designers will be available to discuss your landscape projects and ideas and walk you through our design process. Stop by our booth and meet the CM's Professionals!

Where:

CenturyLink Center of Omaha
455 North 10th St.

Hours:

March 27th 11 AM– 9 PM
March 28th 10 AM– 9 PM
March 29th 10 AM– 5 PM



Reminders

1. Schedule spring clean ups and deep root feedings for trees and shrubs.
2. Prune ornamental grasses and perennials.
3. Submit your ask the arborist questions.
4. Visit CM's at the 2015 Omaha Home Show!

Is Time on Your Side?

Oh, how the days are packed! You are possibly a parent, a grandparent, a cook, a chauffeur, an employee, an employer, a coach, a volunteer and an all-around, master-mind scheduler. The thought of it all is just exhausting! Do you really have time to be a landscape designer, general contractor and crew too?

Visit www.cmcustomlawn.com to see how CM's was able to work with Mike and Paula's hectic schedule to install a project that can be a gathering place to create memories with family and friends for years to come.

At CM's, it's our job to create the best project for you without placing a burden on your time. CM's can create a design for you to review at your own pace, help with selections, pull permits, serve as the general contractor and reduce the amount of time you need to spend on the project.

[Contact CM's to schedule your consultation!](#)

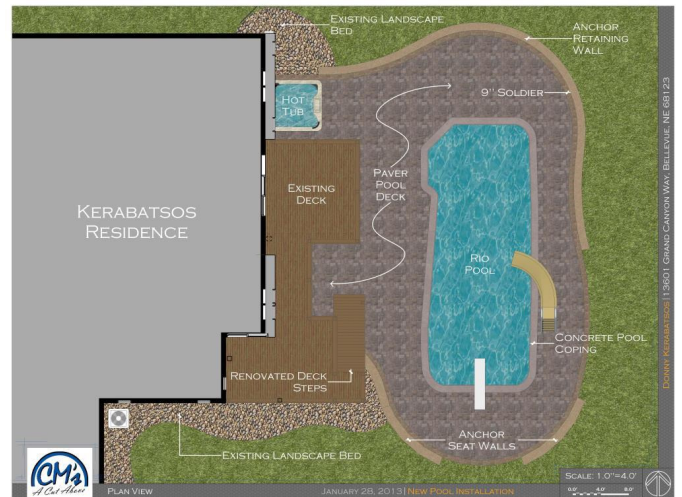

Spring Pruning Tips

In general any time from February

through early April, before new growth begins is an ideal time to prune trees and shrubs. Pruning a tree or shrub while it is in the process of putting on new growth (pushing out new leaves, opening buds, and stem elongation) can be too stressful for the plant. It is also easier to identify which branches need to be removed and prune them while there are no leaves on the trees or shrubs. Limbs that are broken, show signs of disease, or are crossing and rubbing against another branch or structure should be removed.



Northern Catalpa

DO NOT prune any spring flowering trees or shrubs, such as lilacs at this time. Pruning of spring flowering trees and shrubs should be done soon after the plant has finished flowering.



River Birch

Several species of trees will "bleed" heavily when pruned during this season. The sap of the tree is flowing throughout the tree as it prepares for spring growth. The bleeding is not harmful to the tree but can be unsightly. Some trees that bleed heavily are maples, birch, hornbeam, and walnut trees. To avoid excessive bleeding, prune these trees in the spring after the leaves have matured to full size.

[See the Ask the Arborist on page 2 for additional spring tips](#)



Ask The Arborist

Is there anything I should be doing for my trees or shrubs right now to get ready for spring?

Spring is the perfect time to sign up for CM's 4-step tree preservation program!

Steps 1 and 4: Deep Root Feedings

Fertilizing this time of year is helpful because the tree and shrub roots are actively growing and taking nutrients from the soil. It is important to read and follow label instructions for fertilizer, as misuse can cause more harm than good. CM's offers a deep root fertilizer application that has few important advantages to the over the counter fertilizers:

- Professional-grade fertilizer is formulated to balance root growth and top growth. If a fertilizer is used that focuses too much on top growth, the root system will suffer.
- Professional-grade fertilizer is applied with equipment that pressure injects the liquid formula into the soil at a depth of 4-6 inches. This depth is ideal because the majority of the tree's roots responsible for nutrient uptake are found at that depth. When fertilizer is applied to the top layer of the soil, a good portion of the nutrients are intercepted and used by grass roots, never making it down to the intended tree roots.
- Pressure injecting fertilizer aerates the soil in the root zone of the tree. This makes it easier for the tree roots to grow and expand into the surrounding soil. This process can go a long way in improving the overall health of your trees and shrubs.



Tri-color Beach

Step 2: Insecticide Injection

This is a systematic injection that offers year-long protection against most destructive pests. Injection occurs in the spring prior to the start of insect activity, protecting your trees from the following:

- | | | |
|--------------------------|----------------------|-----------------------|
| • Native Flathead Borers | • Bagworms | • Tent Caterpillars |
| • Aphids | • Japanese Beetles | • Zimmerman Pine Moth |
| • Elm Leaf Beetles | • Leafminers | |
| • Lacebugs | • Soft Scale Insects | |

Step 3: Fungicide Injection

This is a systematic injection which occurs in the late summer/ early fall that provides year-long protection from most common diseases such as:

- | | | |
|------------------|---------------------|-----------------------|
| • Anthracnose | • Flower Blight | • Ash Gall |
| • Rust Disease | • Rust | • Diplodia Tip Blight |
| • Powdery Mildew | • Crabapple Disease | |

[Contact a CM's licensed arborist for an evaluation!](#)



E-mail: admin@cmstustomlawm.com
Phone: 402.738.1718
Fax: 402.614.2771

CM's
4151 S. 84 St.
Omaha, NE 68127