



NOMAD
 **YACHTS**

The elegantly designed Nomad 55 is perfect for long-distance travelling without the need to make frequent fuel stops – allowing for an uninterrupted, luxurious cruising experience for boaters.

The Nomad 55 also offers extraordinary views and exceptional piloting from its fly-bridge area where there are numerous seating options. Meanwhile, the lower deck is spacious and airy, boasting four guest cabins and one crew cabin.

Although the 55 Fly is the smallest boat in the Nomad range, it still displays the same outstanding performance characteristics as the larger models, with the ability to cross huge distances and cope with anything the sea can throw at her. The boat still provides extraordinary space for a 55-foot boat due to the volume in the semi displacement hull design and enjoys all the attributes that Nomad Yachts are famous for.



NOMAD 55





Saloon





Owner's Cabin





Forward VIP Guest Cabin



Forward VIP Guest Head | Guest Cabin



Fly-bridge



Bow Seating | Fly-bridge



DECK PLANS

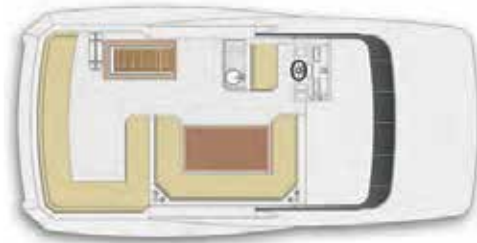

FLY-BRIDGE OPTION 1

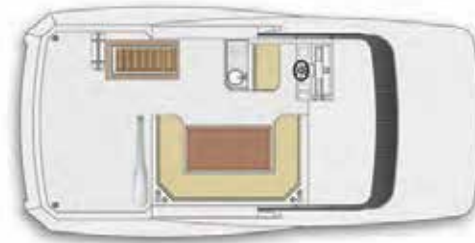

FLY-BRIDGE OPTION 2



MAIN DECK



LOWER DECK

TECHNICAL SPECIFICATIONS

LENGTH OVERALL	:	57 ft 8.5 in (17.59 m)	ACCOMODATION	:	4 Cabins (6 Berths)
BEAM	:	16 ft 2.5 in (4.94 m)		:	1 Crew Cabin
DRAFT	:	4 ft 5 in (1.35 m)	HEADS	:	3 Guest Heads + 1 Crew Head
DISPLACEMENT	:	28 t Approx.	GENERATORS	:	20 kW, 50 Hz
FUEL CAPACITY	:	820 US gal (3,104 l)	POWER OPTIONS	:	2 x 800 hp
WATER CAPACITY	:	150 US gal (567 l)			
BLACK WATER CAPACITY	:	42 US gal (158.7 l)			
GREY WATER CAPACITY	:	22 US gal (83 l)			

CLASSIFICATION: CE (Design Category A)



by *Gulf Craft*

PO Box 666 Ajman, UAE | T. +971 6 7406060 | F. +971 6 7406062
gci@gulfcraftinc.com | www.gulfcraftinc.com