

INSOL TECHNICAL DATA SHEET

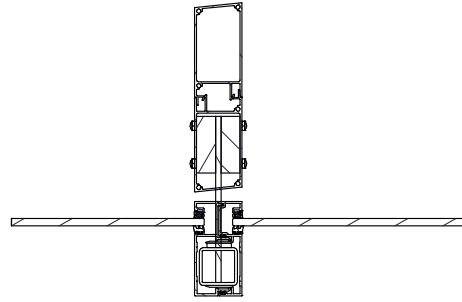

PLAN VIEW

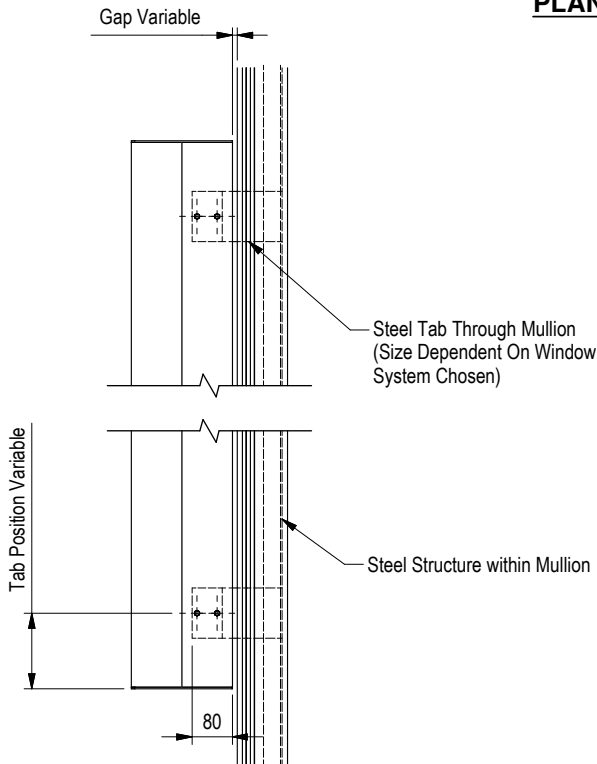

SECTIONED VIEW

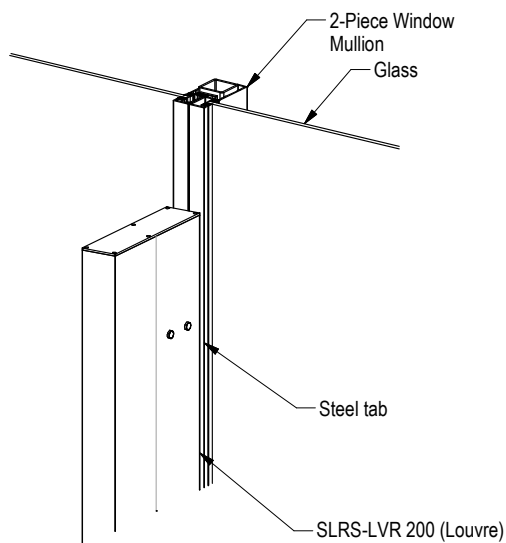

Pictorial

Configuration and layout:

- This fixing method enables vertical louvres to be set close to window mullions with no obvious support structure.
- Blades are restricted to being set perpendicular to the window joinery.

Assembly and Installation:

- The louvre blades are machined on the back edge to receive the steel tab and plastic packers which prevent crushing of the blade.
- Insol does not provide or install the steel structure and tabs fitted to the window mullions, but can assist with the design of these items.
- The louvre blades are fixed to the steel tabs using stainless steel button-head fastenings, with decorative dome nuts on the outside.

Structural Requirements:

- This fixing method can result in significant torsional load being applied to the window mullion from wind action on the louvre blade, and must be discussed with the manufacturer of the window joinery.
- Location and number of steel tabs is typically governed by the requirements of the joinery manufacturer. Care must also be taken to account for the span ability of the louvre blade. See Span Data Table for spans relative to wind zones.

Componentry and Finishes:

- All the aluminium components (the louvre blades and end caps) can be finished with any exterior powder coat or grade of anodising.
- Exposed ends of the louvre blades are fitted with a 3mm aluminium end cap, finished to match the louvre.
- All fixings are stainless steel.

Not sure if this is the correct fixing detail for your project? Contact Insol to discuss your requirements - we will be able to recommend the most suitable fixing methods for your specific scenario.

**SOLARIS™ 200
FIXED TO WINDOW MULLION**



© 2014 All rights reserved
Insol Ltd
Ph: 0800 34 6000
www.insolnz.co.nz

Scale: N.T.S.
Date: 13/03/2014

SLRS-LVR 200 FM Ver. 1