

STEP 1:

Attach PD181-601 tray mount to PD181-018 keyboard tray using (4) PDINILNS1032 nuts.

STEP 2:

Attach (2) PD133-037 enclosure to PD181-018 with f(4) PDIPFHMS63225 screws and (1) PDIPPHMS63225 screw.

STEP 3:

Attach PD133-610 wire cover to the (2) PD133-037's with (4) PDIPFHMS63225 screws.

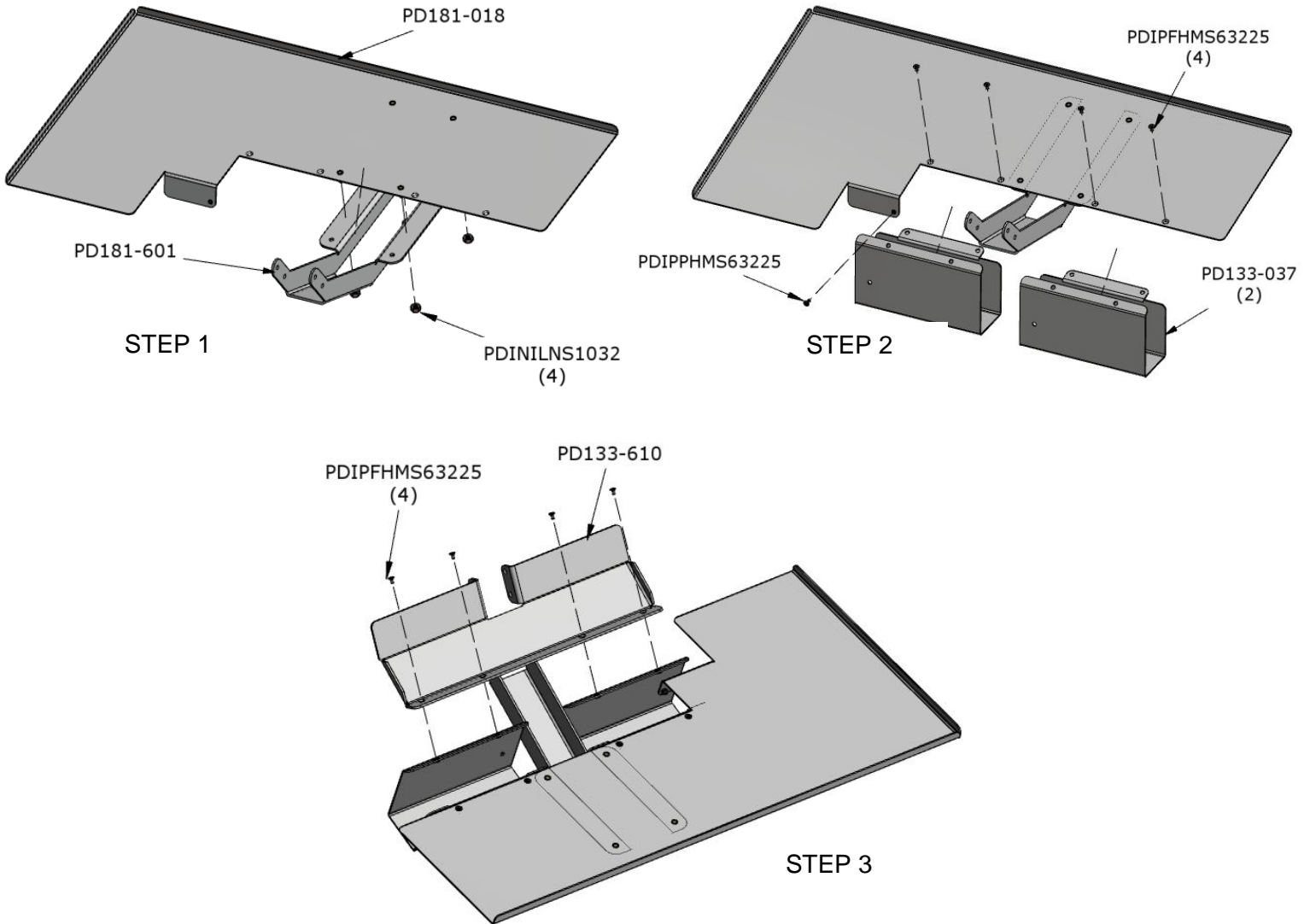

QTY	PART NUMBER	DESCRIPTION
1	PD181-018	KEYBOARD TRAY
1	PD181-601	KEYBOARD TRAY MOUNT
4	PDINILNS1032	10-32 NYLOC NUT
2	PD133-037	ACCESSORY ENCLOSURE
8	PDIPFHMS63225	6-32 X 1/4 PFHMS SCREW
1	PDIPPHMS63225	6-32 X 1/4 PPHMS SCREW
1	PD133-610	WIRE COVER