

	This symbol indicates that dangerous voltage constituting a risk of electric shock is present within this unit.
	This symbol indicates that there are important operating and maintenance instructions in the literature accompanying this unit.

	CAUTION RISK OF ELECTRIC SHOCK, DO NOT OPEN!	
CAUTION: TO REDUCE THE RISK OF ELECTRIC SHOCK, DO NOT REMOVE COVER. NO USER SERVICEABLE PARTS INSIDE. REFER SERVICING TO QUALIFIED SERVICE PERSONNEL		

THIS INSTALLATION SHOULD BE MADE BY A QUALIFIED SERVICE PERSON AND SHOULD CONFORM TO ALL LOCAL CODES. READ AND FOLLOW THE SAFETY INSTRUCTIONS BEFORE ATTEMPTING THIS INSTALLATION.

NOTE to CATV system installer: This reminder is provided to call the CATV system installer's attention to Article 820-40 of the NEC that provides guidelines for proper grounding and, in particular, specifies that the cable ground shall be connected to the grounding system of the building, as close to the point of cable entry as practical.

GUIDELINES

- A. **LOCATION** – This wall plate is designed to mount over a single-gang electrical box. The access hole in the casting allows AC line and coax wires to enter the enclosure (see figure 1). Both the electrical box and wall plate should be positioned at a mounting height of 47±2 inches for optimal arm performance. See Figure 2.
- B. **WALL STRENGTH** – The wall bracket mounting instruction cover the most desirable mounting method using a back-up plate. Other methods may work depending upon wall construction. **IN ALL CASES** the wall construction must be able to support a minimum loading of **350 PSI** applied perpendicular to the mounting hole locations by compression or tension. Some wall construction may require internal bracing to accept the minimum loading required.
- C. **HARDWARE REQUIREMENTS** – Use the following hardware for all wall bracket installations. Hardware is NOT supplied with the wall bracket.
 - 1. All threaded rods, bolts or machine screws should be (minimum) ¼"-20UNC-2A thread or equivalent.
 - 2. The back-up plate is a 6-1/2" x 10", 11 gauge metal plate, with four 9/32" holes that coincide with the wall bracket. A pre-fabricated backing plate, PDI-218, is available directly from PDI.
 - 3. All threaded rods will be finished off with an acorn nut.
- D. **TOTAL WEIGHT** of the PDI-Z9TV receiver and support arm system is 41 pounds approximately.

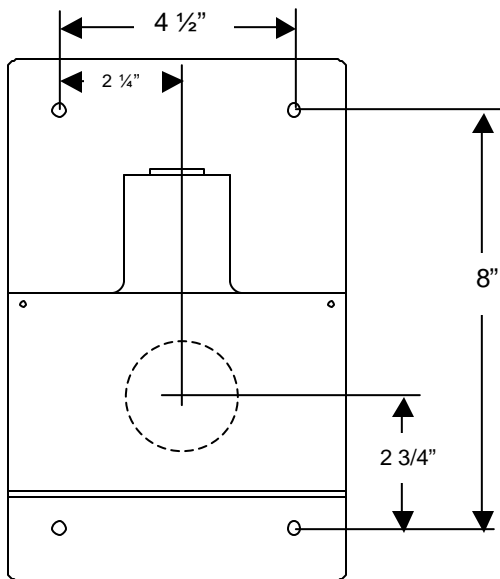

Mounting Hole Pattern
Figure 1.

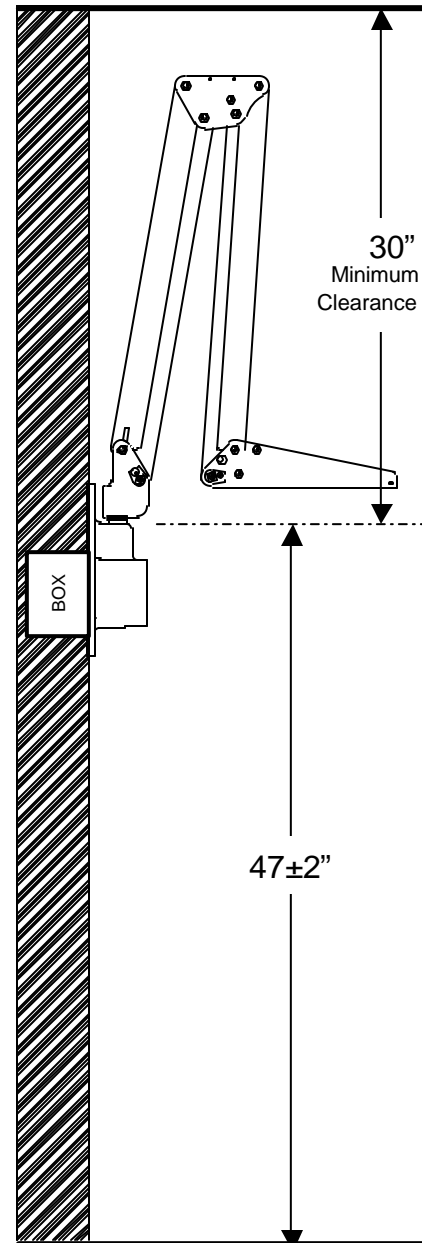

Mounting Height
Figure 2.

BACK-UP PLATE MOUNTING

A check with the contractor/architect or Hospital Engineering Department regarding hidden objects behind the wall should be made before proceeding with this installation and final operation of the arm assembly.

Refer to Figure 3 and 4.

1. Position the mount so the bolt pattern straddles the interior electrical box and wall casting access hole is over the box opening.
2. Place a spirit level along the top surface of wall mount pivot hole and adjust for a true horizontal position. Then mark the location of the mounting holes.
3. Drill the top holes completely through the wall with 9/32" bit.
4. Drill the bottom mounting holes half-way through the wall and complete the holes from the opposite side.
NOTE: All holes must be drilled perpendicular to the wall so that they are spaced 4-1/2" on horizontal centers and 8" on vertical centers on the opposite side of the wall.
5. Place a hex nut 5/16" from one end of threaded rod. Tighten cap nuts on rods so that the nut faces are even. Insert the threaded rods through the top and bottom mounting holes.
6. Hold the rods in place and have an assistant place and secure the back-up plate to the opposite wall using hex nuts. Cut the threaded rods 5/16" from the outside surface of the hex nuts. Install and tighten cap nuts on rods.

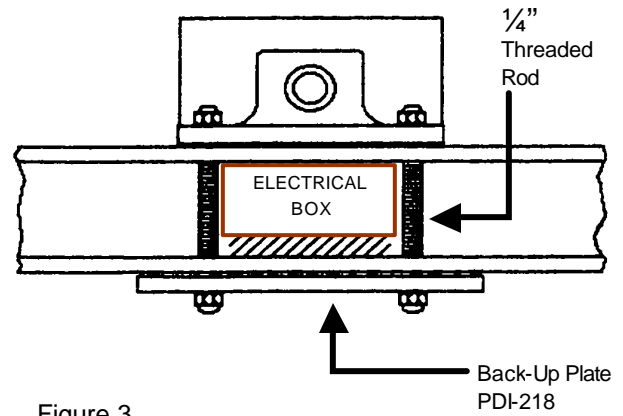
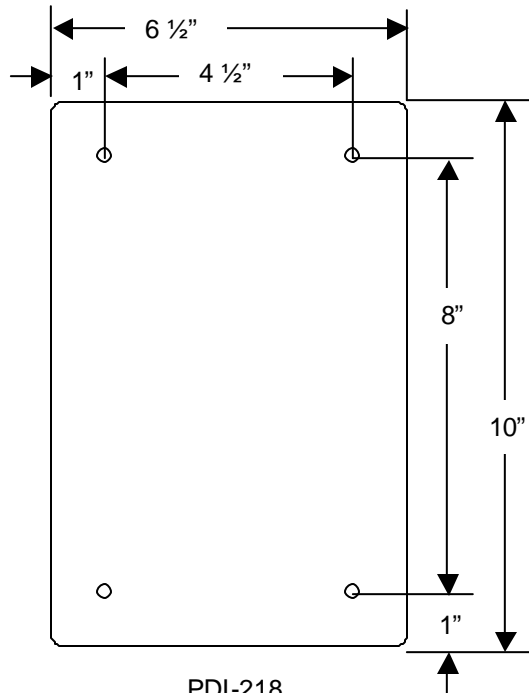

Figure 3.



PDI-218
Back-Up Plate

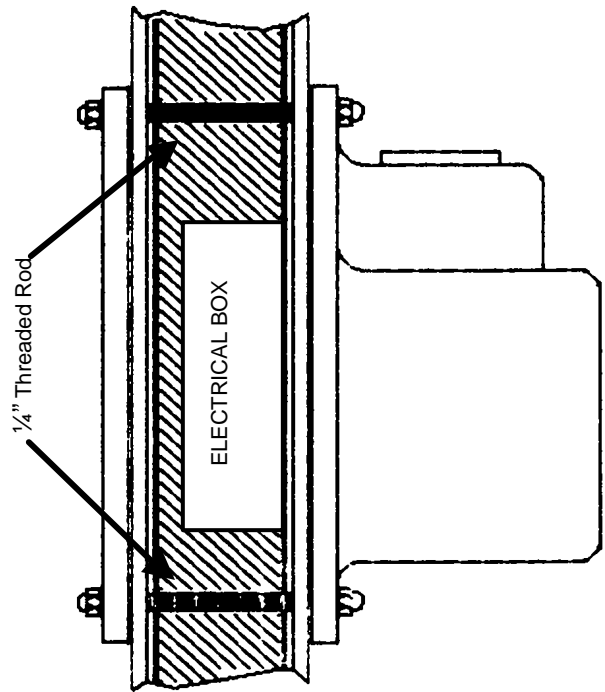

Figure 4.

WIRING

The actual power supply is mounted to the front cover of the wall casting.

1. Remove the front cover.
2. Connect the three flying wire leads provided to the AC line input.

COLOR CODE	
Black	Hot
White	Neutral
Green	Ground

3. Connect the RF signal coax to the “F” fitting located next to the transformer. Wrench tighten.
4. Attach the cover back onto the wall casting.
5. Mount the support arm into the pivot hole on top of the casting.
6. Attach the arm coax pig tail cable to the exposed “F” fitting on the bottom of the supply. Wrench tighten. See Figure 5.

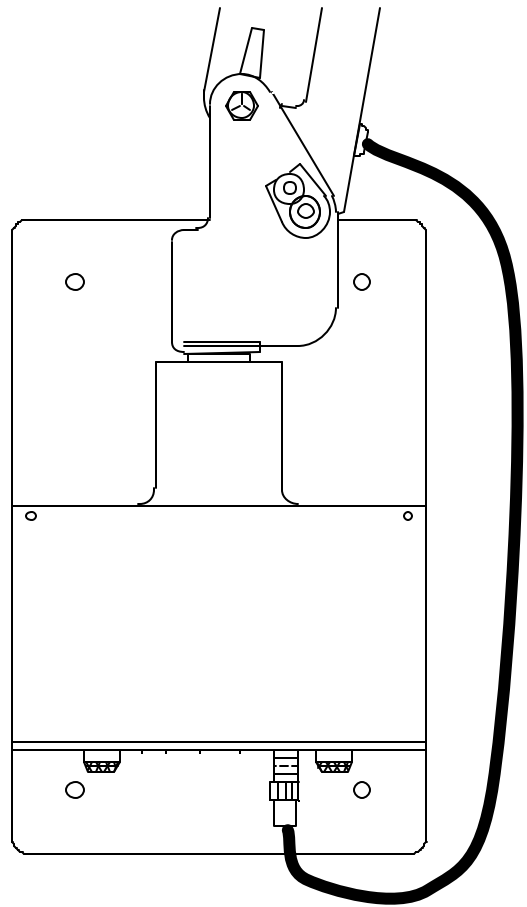

Figure 5.

OPERATION & SAFETY INSTRUCTIONS

IMPORTANT SAFETY INSTRUCTIONS

Save these instructions for future reference.

Turn OFF power to this unit before cleaning. Do not use liquid cleaners or aerosol cleaners. Use a damp cloth for cleaning.

This unit does not require periodic maintenance other than cleaning.



WARNING: TO REDUCE RISK OF FIRE OR ELECTRIC SHOCK, DO NOT EXPOSE THIS POWER SUPPLY TO RAIN OR MOISTURE



THIS SUPPLY FOR USE ONLY WITH UL LISTED TV RECEIVER MARKED TO INDICATE USE WITH THIS POWER SUPPLY.



CAUTION: TO REDUCE THE RISK OF ELECTRIC SHOCK, DO NOT REMOVE COVER. NO USER SERVICEABLE PARTS INSIDE. REFER SERVICING TO QUALIFIED SERVICE PERSONNEL.

ACCESSORIES

- PDI-244 ARM ROTATIONAL STOP KIT - SINGLE
- PDI-244D ARM ROTATIONAL STOP KIT - DUAL
- PDI-270 BOLT CAP COVER KIT
- PDI-218 BACK UP PLATE