

**SCOPE:**

To install a PDI rotational stop onto a PDI wall brackets of PDI-886.

**TOOL LIST:**

1. Safety glasses/goggles
2. Phillips screwdriver
3. 3/8" wrench or socket
4. 1/8" hex key (Allen wrench)
5. 5/32" hex key (Allen wrench)

**Safety Steps:**

1. Always wear safety glasses/goggles to prevent injury from debris.
2. Follow the installation/removal instructions for your existing products.

**(Instructions for PDI-244D)**

**PROCEDURE:**

**STEP 1:**

Place the PDI-242(-B,-C,-G) Rotational Stop Plate on the wall bracket, so the large hole in the rotational stop is around the top of the bushing and the straight edge to the rear.

**STEP 2:**

Next, install the arm (sold separately) into the mount, taking care to properly align the base pin with the bushing to prevent damage to the bushing during installation.

Use the 5/32" hex key to reinstall the pilfer proofing screw.

Rotate the arm from side to side to verify that it moves smoothly and does not bind on the pilfer proofing screw.

Lift up on the arm to confirm that the arm cannot be removed while the pilfer proofing screw is installed.

**STEP 3:**

Place a 10-32 x 1 screw thru the PDI-243, plastic stop. Rotate the arm to the left or right until the desired position is found.

**STEP 4:**

Place the screw/stop thru the closest hole in the PDI-242 and next to the arm base that will not allow the arm to rotate beyond the desired position.

**STEP 5:**

Now, place a 10-32 Nylock insert lock nut on the screw and tighten until the stop is secure. Repeat for the opposite side if needed.

Parts List		
QTY	PART NUMBER	DESCRIPTION
1	PDI-242 (-B, -C, -G)	Rotational Stop Plate
2	PDI-243	Rotational stop
2	PDIPPHMS1032100	10-32 x 1 Phillips Pan head machine screw
2	PDINILN1032	10-32 Nylon insert locknut

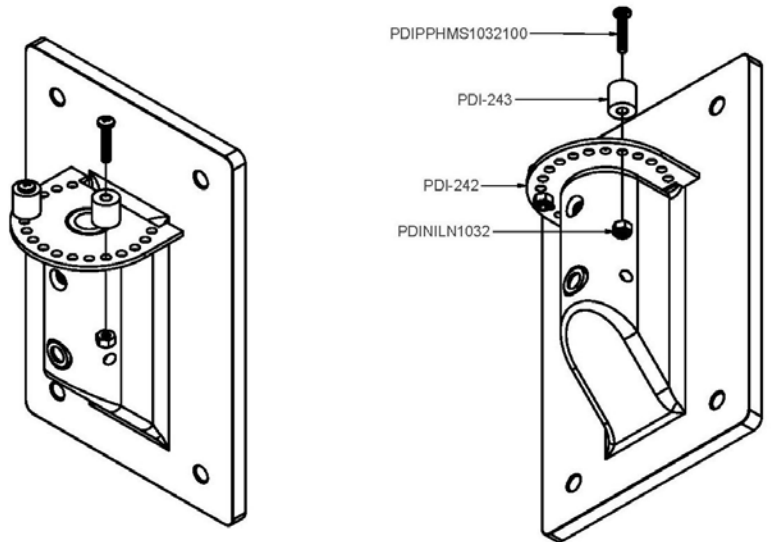

**NOTES:**

- Will work with PDI-119, 172, 178 series, and PDI-771C wall brackets.
- Will not work with PDI-179 or PDI-771B wall brackets.
- When used, the arm base covers must be removed.

**(Instructions for PDI-179RS)**

**PROCEDURE:**

**STEP 1:**

Place the PDI-179RS (-B,-C,-G) Rotational Stop Plate on the wall bracket, so the large hole in the rotational stop is around the top of the bushing and the straight edge to the rear.

**STEP 2:**

Next, install the arm (sold separately) into the mount, taking care to properly align the base pin with the bushing to prevent damage to the bushing during installation.

Use the 5/32" hex key to reinstall the pilfer proofing screw.

Rotate the arm from side to side to verify that it moves smoothly and does not bind on the pilfer proofing screw.

Lift up on the arm to confirm that the arm cannot be removed while the pilfer proofing screw is installed.

**STEP 3:**

Place a 10-32 x 1 screw thru the PDI-243, plastic stop. Rotate the arm to the left or right until the desired position is found.

**STEP 4:**

Place the screw/stop thru the closest hole in the PDI-179RS and next to the arm base that will not allow the arm to rotate beyond the desired position.

**STEP 5:**

Now, place a 10-32 Nylock insert lock nut on the screw and tighten until the stop is secure. Repeat for the opposite side if needed.

Parts List		
QTY	PART NUMBER	DESCRIPTION
1	PDI-179RS (-B, -C, -G)	Rotational Stop Plate
2	PDI-243	Rotational stop
2	PDIPFHMS1032100	10-32 x 1 Phillips flathead machine screw
2	PDINILN1032	10-32 Nylon insert locknut

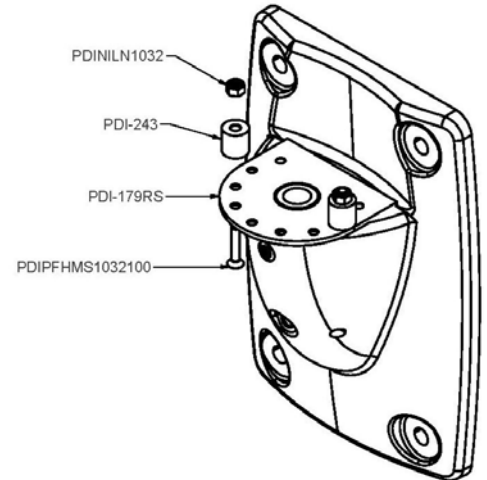
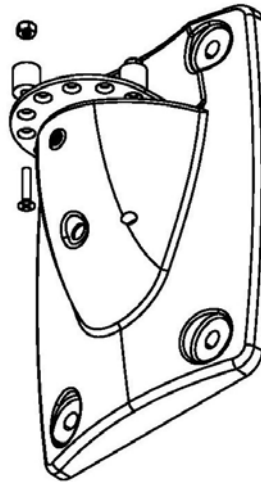

**NOTES:**

- Will work with PDI-179 or PDI-771B wall brackets.
- Will not work with PDI-119, 172, 178 series, and PDI-771C wall brackets.
- When used, the arm base covers must be removed.

**(Instructions for PDI-244DBF)**

**PROCEDURE:**

**STEP 1:**

Place the PDI-242SBF (-B, -C, -G) Rotational Stop Plate on the floor mount, so the large hole in the rotational stop is around the top of the bushing and the straight edge to the rear.

**STEP 2:**

Secure the PDI-242SBF with the two 10-32 x 3/8 flathead screws

**STEP 3:**

Next, install the arm (sold separately) into the mount, taking care to properly align the base pin with the bushing to prevent damage to the bushing during installation.

Use the 1/8" hex key to reinstall the pilfer proofing screw and spacer.

Rotate the arm from side to side to verify that it moves smoothly and does not bind on the pilfer proofing screw.

Lift up on the arm to confirm that the arm cannot be removed while the pilfer proofing screw is installed.

**STEP 4:**

Place a 10-32 x 1 screw thru the PDI-243, plastic stop. Rotate the arm to the left or right until the desired position is found.

**STEP 5:**

Place the screw/stop thru the closest hole in the PDI-242SBF and next to the arm base that will not allow the arm to rotate beyond the desired position.

**STEP 6:**

Now, place a 10-32 Nylock insert lock nut on the screw and tighten until the stop is secure. Repeat for the opposite side if needed.

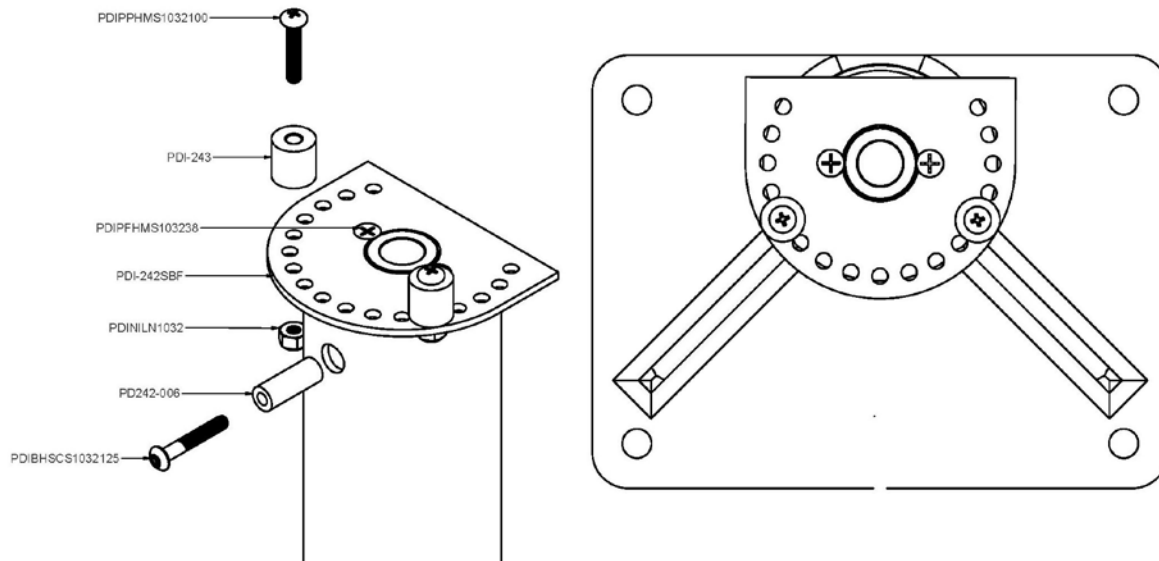

Parts List		
QTY	PART NUMBER	DESCRIPTION
1	PDI-242SBF (-B, -C, -G)	Rotational Stop Plate
2	PDI-243	Rotational stop
2	PDIPPHMS1032100	10-32 x 1 Phillips Pan head machine screw
2	PDINILN1032	10-32 Nylon insert locknut
2	PDIPFHMS103238	10-32 x 3/8 Phillips Flat head machine screw

**NOTES:**

- Will work with PDI-886, floor mounts.
- Will not work with PDI-119, 172, 178 series, PDI-179, and PDI-771C or PDI-771B wall brackets.
- When used, the arm base covers must be removed.