	MODEL NUMBER: PD168-226	Document Number: PD196-365R1
	50" TV Wall Mount Kit Installation Instructions	Page 1 of 3

SCOPE:

TO MOUNT A TV USING A PDI PD168-226 WALL MOUNT KIT.

TOOL LIST

1. P1 OR P2, PHILLIPS SCREW DRIVER
2. SAFETY GLASSES/GOGGLES
3. LEVEL

SAFETY STEPS:

1. ALWAYS WEAR SAFETY GLASSES/GOGGLES TO PREVENT INJURY FROM DEBRIS.
2. FOLLOW THE INSTALLATION/REMOVAL INSTRUCTIONS FOR YOUR EXISTING PRODUCTS.

MOUNTING DISTANCE

16.6" MINIMUM FROM CLEVIS TO CEILING FOR **50" PLASTIC LED TV.**

PROCEDURE TO MOUNT AN E50 LED TV:

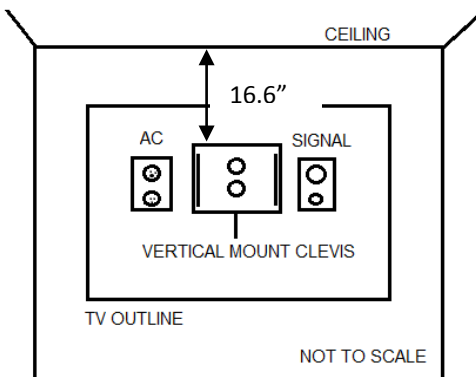

STEP 1:

ATTACH THE (4) PD181-825 MOUNTING BRACKETS (#11) TO THE BACK OF THE E50 LED TV USING FOUR PDIPPHMSM6X110 SCREWS (#9).

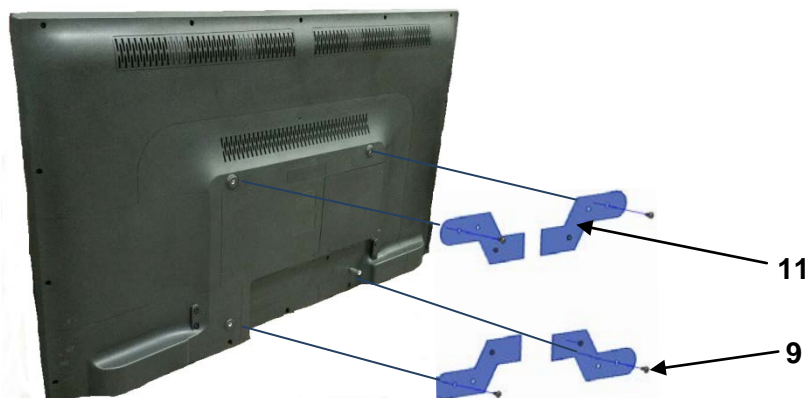

STEP 2:

ATTACH THE PD181-596 MOUNTING BRACKET (#3) TO THE PD181-672 PLATE (#1) FOR E50 LED TV USING FOUR PDIPPHMSM4X76 SCREWS (#6) AND FOUR PDIITLW10 WASHERS (#5). MAKE SURE THE PD181-596 MOUNTING BRACKET (#3) IS ATTACHED TO THE SIDE OF THE CHOSEN PLATE WITH THE FOUR ROUND ENDS OF THE M4 INSETS. THE SIDE WITH THE FOUR HEX ENDS WILL GO TOWARDS THE BACK OF THE SET.

STEP 3:

ATTACH PARTS PREVIOUSLY ASSEMBLED ON STEP #2 TO TV USING FOUR PDIPPHMSM6X18 SCREWS (#10).



ITEM	PART NUMBER	DESCRIPTION	QTY
1	PD181-672	200mm TO 100mm ADAPTER PLATE	1
2	PD181-674	VERTICAL WALL MOUNT CLEVIS	1
3	PD181-596	MOUNTING BRACKET	1
4	PDIPPHMS103238	10-32 X .375 PHILLIPS PAN HEAD MACHINE SCREW	2
5	PDIITLW10	#10 INTERNAL TOOTH LOCK WASHER	6
6	PDIPPHMSM4X76	M4-.7 X 6mm PPHMS	4
7	PDIFW25	1/4" FLAT WASHER	2
8	PDISLW25	1/4" LOCK WASHER	1
9	PDIPPHMSM6X110	M6 X 1 10mm PHILLIPS SCREW	4
10	PDIPPHMSM6X18	M6 x 1 8mm PHILLIPS SCREW	4
11	PD181-825	50" TV MOUNTING BRACKET	4

	MODEL NUMBER: PD168-226	Document Number: PD196-365R1
	50" TV Wall Mount Kit Installation Instructions	Page 3 of 3

STEP 3:

ATTACH THE PD181-674 (#2) TO THE WALL USING CUSTOMER SUPPLIED 1/4" FASTENERS FOLLOWING THE MOUNTING DISTANCE DIAGRAM DIMENSIONS. PLACE ONE PDIFW25 FLAT WASHER (#7) AND ONE PDISLW25 LOCK WASHER (#8) ON THE TOP FASTENER AND THROUGH TOP SLOT IN THE BRACKET. PLACE THE REMAINING PDIFW25 FLAT WASHER (#7) IN THE BOTTOM MOUNTING FASTENER. LEVEL THE BRACKET USING TOP LEVELING SLOT AND FINISH TIGHTENING FASTENERS.

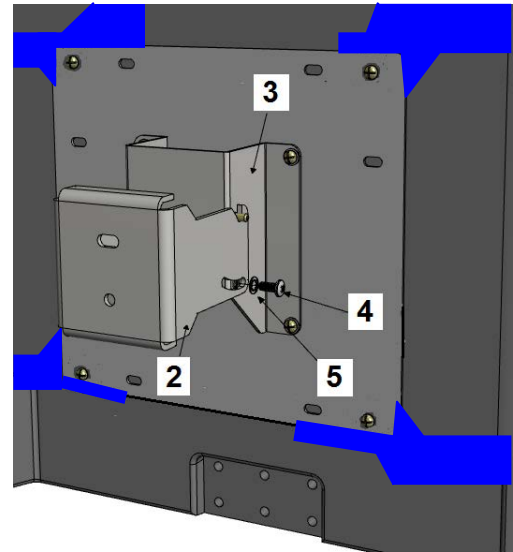
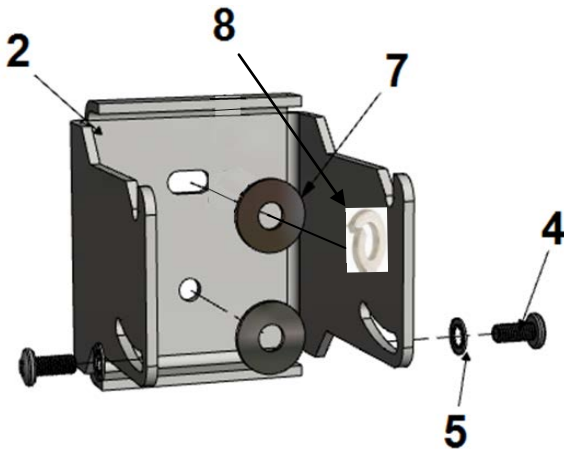

STEP 4:

CAREFULLY LIFT THE SET UP AND POSITION THE PD181-596 MOUNTING BRACKET (#3) INSIDE THE SIDES OF THE SELECTED MOUNT ALLOWING THE TWO SIDE SUPPORT PINS OF THE PD181-596 MOUNTING BRACKET TO REST IN THE TWO NOTCHES AT THE FRONT OF THE MOUNT. TIGHTEN USING (2) PDIPPHMS103238 SCREWS (#4) AND (2) PDIITLW10 WASHERS (#5).

VESA PATTERNS:

- 100MM X 100MM WITH M4 THREADS
- 100MM X 200MM FOR M5 FASTENERS
- 200MM X 200MM FOR M6 FASTENERS

PD181-674

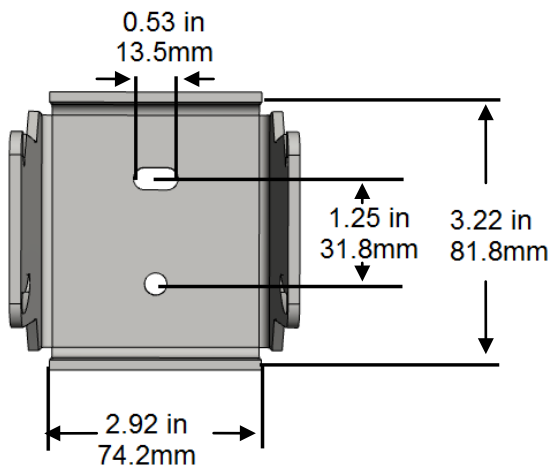

PD181-672

