

**Technical
Bulletin**

**500 Series Arm with TV
Field Adjustment Procedure**

PDi

Communication
Systems, Inc.

40 Greenwood Lane
Springboro, Ohio
45066

PH: 937-743-6010

FX: 937-743-5664

<http://www.pdiarm.com>

	MODEL NUMBER: 500 Series Arm with TV	Document Number: PDITCH-001R2
	Field Adjustment Procedure	Page 2 of 7

Adjustment Procedure for 500 Series Arm with TV

This procedure should be used to adjust the springs in the 500 Series Arms in the field. Please read the entire document before performing any adjustments on the TV arm.

PDI claims proprietary right to the material disclosed herein. This manual and associated drawings are issued in confidence for engineering information only and may not be used to manufacture anything shown herein without permission from PDI to the user.

- **Tools needed** (flathead screwdriver, 7/16 socket reduced length, ¼ extension w/clearance, 7/16 socket driver, and two 7/16 nut-drivers, 5/32 Allen wrench and a ratchet)



CAUTION: Do not attempt to modify this product in any way without written authorization from PDI. Unauthorized modifications will not only void the warranty, but may lead to your being liable for any resulting property damage or user injury.

Procedure

- Arm may be re-adjusted in the current bracket system, with the T.V. mounted.
- To adjust the Arm the PDI-148 safety pin must be removed if it is in the lock position (see Illustration)

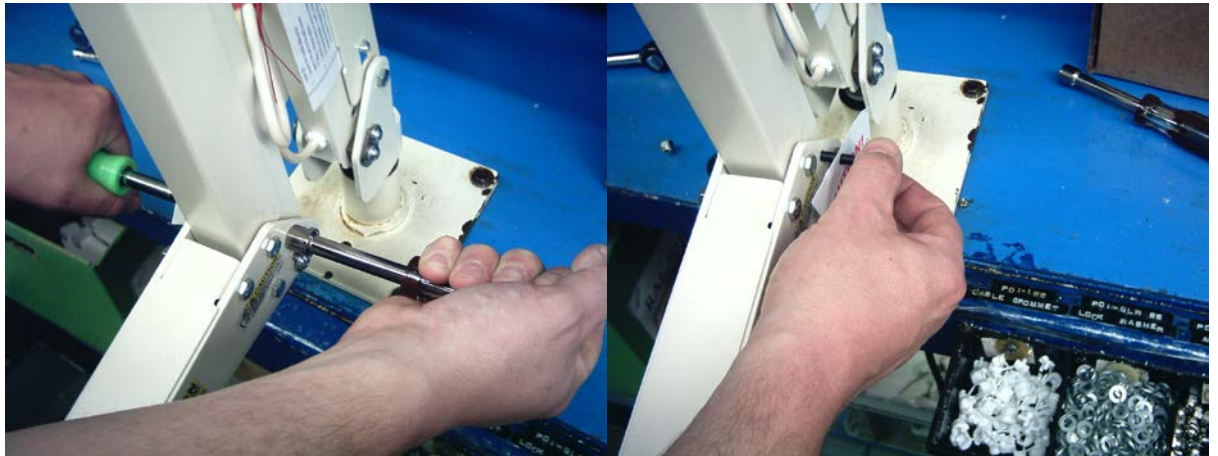

- Loosen brakes: back off the brake tension screws about ½ a turn

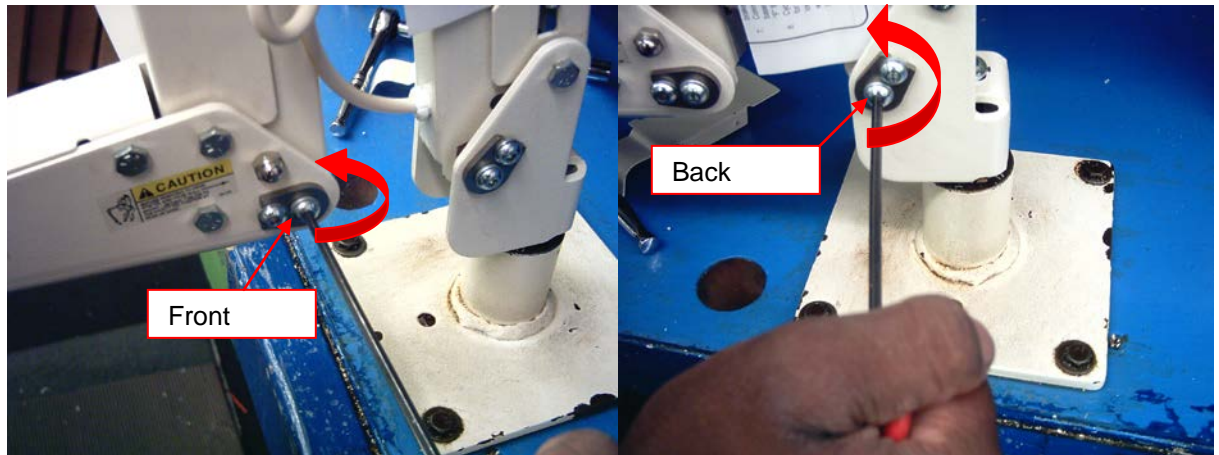

- Next remove the PDI-525 elbow plate with the screwdriver

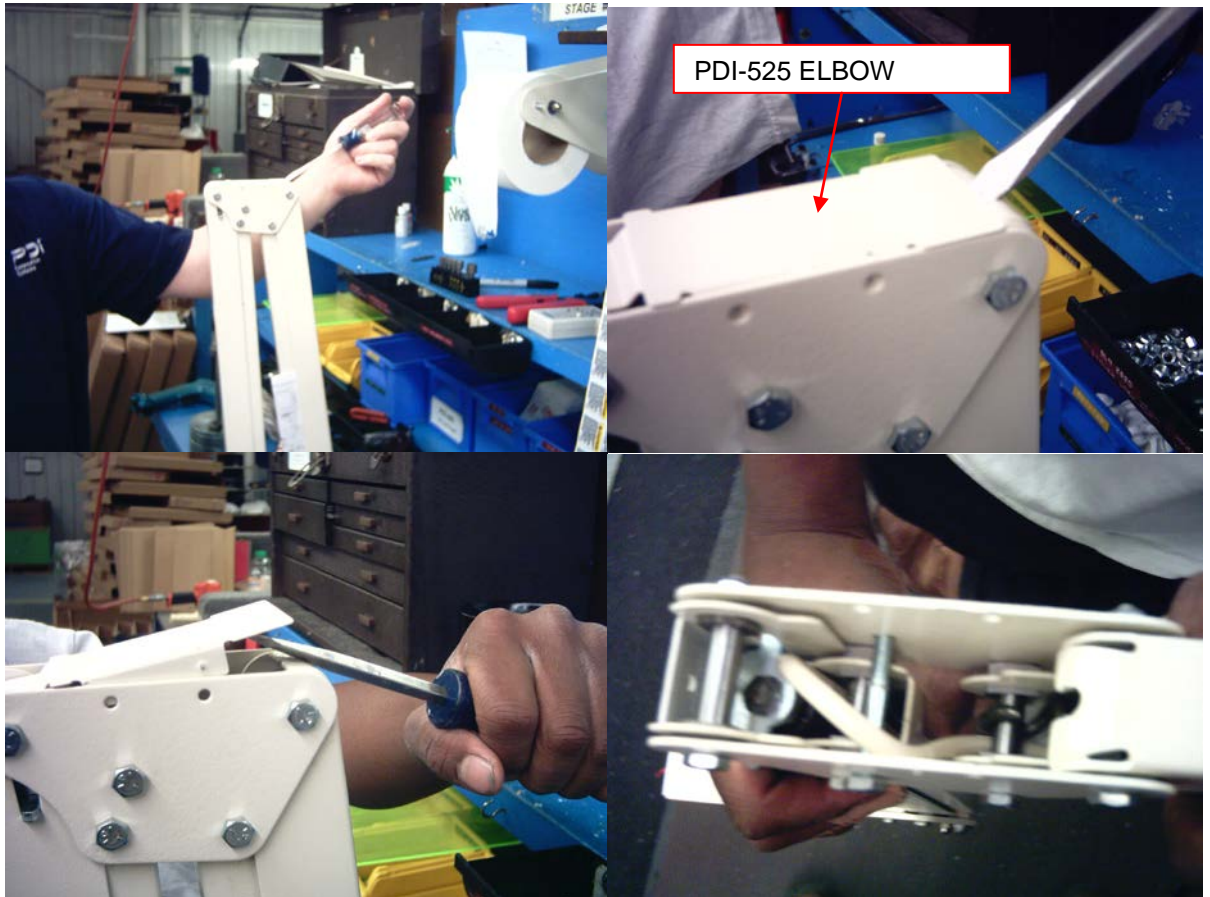

Front Arm spring adjustment:

- Locate the ¼-20 bolt with the 7/16 hex head inside the front of the arm
- Loosen bolt, to decrease lift force, tighten bolt, to increase lift force, use the 7/16 socket and ratchet, ½ turn then check arm for adjustment.
- Continue process until you reach the desired adjustment
Be careful not to back off the bolt more than 10 complete turns, anymore than that could result in disconnecting the spring

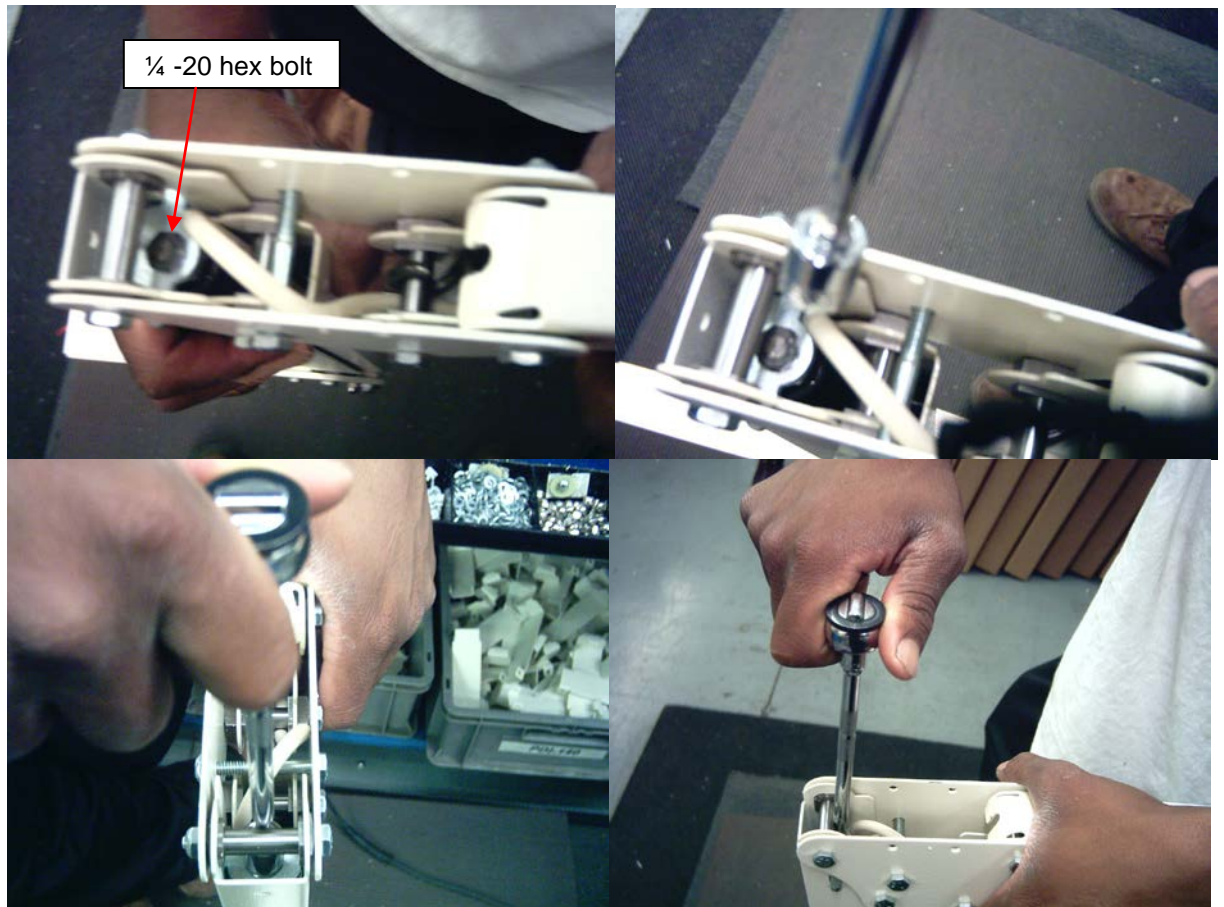

Rear Arm spring adjustment:

- Bend back arm section down so that it is parallel to the floor
- Look in the back end of the arm and locate the ¼-20 hex bolt head
- Loosen bolt, to decrease lift force, tighten bolt, to increase lift force, use the 7/16 socket and ratchet, ½ turn then check arm for adjustment.
- Continue process until you reach the desired adjustment
- Be careful not to back off the bolt more than 10 complete turns, anymore than that could result in disconnecting the spring

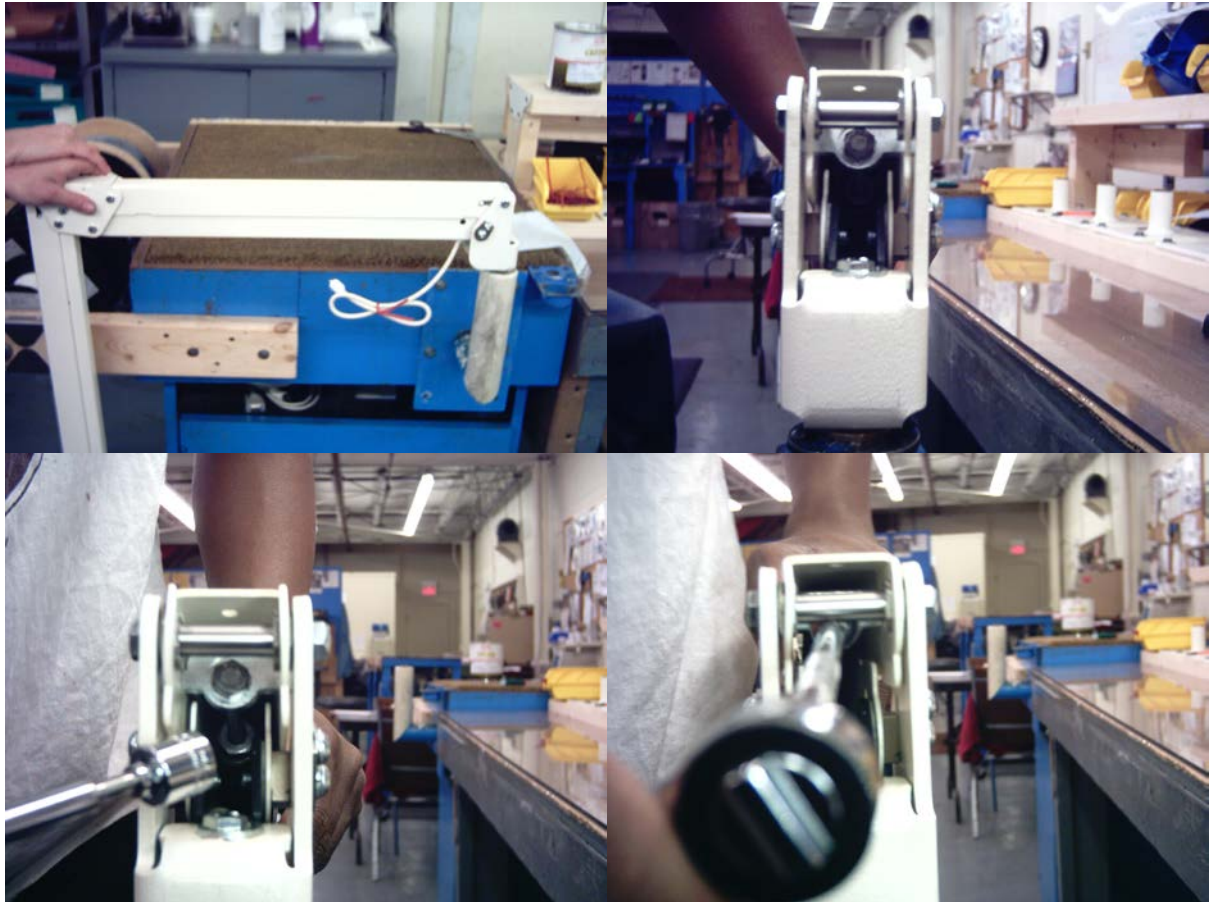

- After reaching the desired adjustment, re-tighten the brakes.

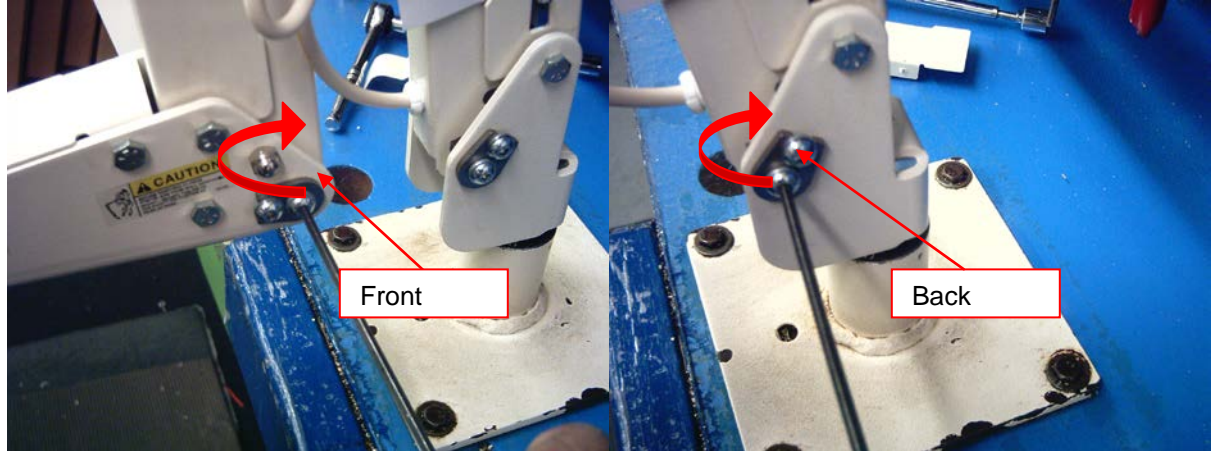

- Next replace the PDI-525 elbow cover

