

**Scope:**

To install two large screen TV's using a PD168-053 dual large screen mount.

**Tool List:**

1. Safety glasses/goggles
2. 9/16 Socket and ratchet
3. 9/16 Wrench
4. Drill
5. 3/8 Drill bit
6. P1 or P2 Phillips screwdriver
7. 1/4" Hex bit driver
8. 5/32 Hex key or Apex bit

**Safety Steps:**

1. Always wear safety glasses/goggles to prevent injury from debris.
2. Follow the installation/removal instructions for your existing products.

**PROCEDURE**

**Step 1:**

Determine proper mounting location in ceiling and prepare attachment structure within ceiling.

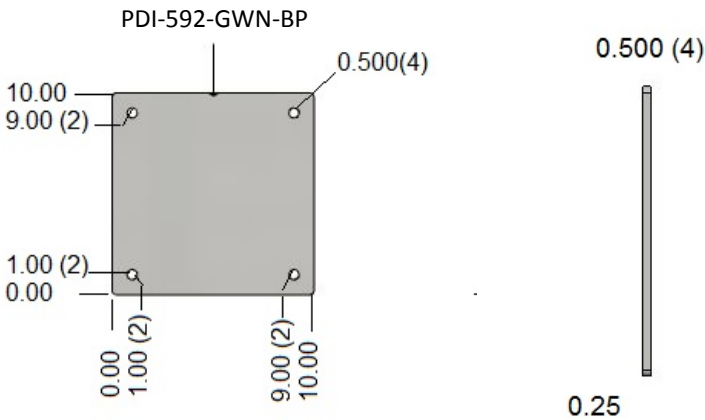
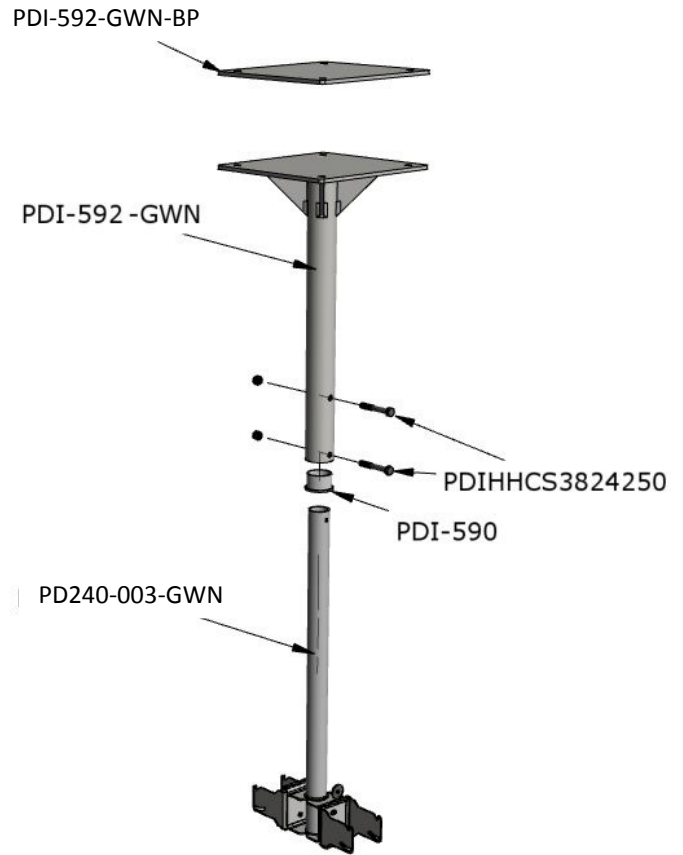

ITEM	QTY	PART NUMBER	DESCRIPTION
1	1	PDI-590	CMT SLEEVE
2	2	PD168-033	200mm WALL MOUNT KIT FOR LCD TV'S
3	1	PDI-592-GWN	ASSEMBLY: DUAL MOUNT OUTER TUBE
4	1	PDI-592-GWN-BP	BASE PLATE: DUAL MOUNT
5	1	PD240-003-GWN	DUAL MOUNT EXTENSION TUBE
6	2	PDIHHCS3824250	3/8-24 2-1/2" HHCS
7	2	PDINILN3824	3/8-24 NYLOC

 <small>Communication Systems, Inc.</small> <i>A Leader in Patient Communication Solutions®</i>	MODEL NUMBER: <b>PD168-053</b>	Document Number: PD196-268R2
	Dual Large Screen Ceiling Mount Installation Instructions	Page 2 of 3

**Step 2:**

Determine the desired viewing height for the TV and drill the top mounting hole through the PD240-003-GWN inner tube.

**Step 3:**

Following the mounting instructions of the supplied PD168-033 brackets, test mount the TV's to verify the desired viewing position has been set.

**Step 4:**

If the viewing angle is correct, remove the TVs, drill the second mounting hole through PDI-590 sleeve and inner tube and install second mounting bolt through the assembly. Tighten both bolts securely.

**Step 5:**

Following the mounting instructions of the supplied PD168-033 brackets, remount the TVs and finish the installation and connections.

