

# QUIK-CAN™

## INSTALLATION GUIDE

STEP 1 - Place L-867B base can upright with top flange facing upwards. Use bolts supplied with L-867B base can to bolt Quik-Can with sloped side towards the ground, to the can.

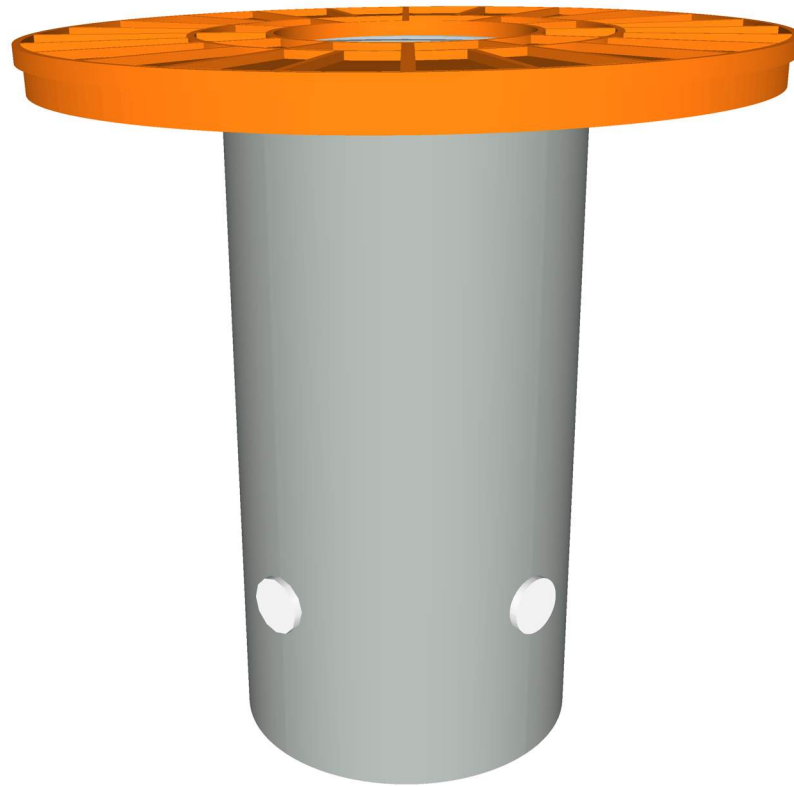

STEP 2 - Install your conduit sleeves to the can. Use either the threaded hub or grommet conduit openings provided by base can manufacturer. Ensure that you have a coupling installed towards the outside of the form tube (sono tube).

STEP 3 - Install external grounds to outside of base can as required per contract specifications.

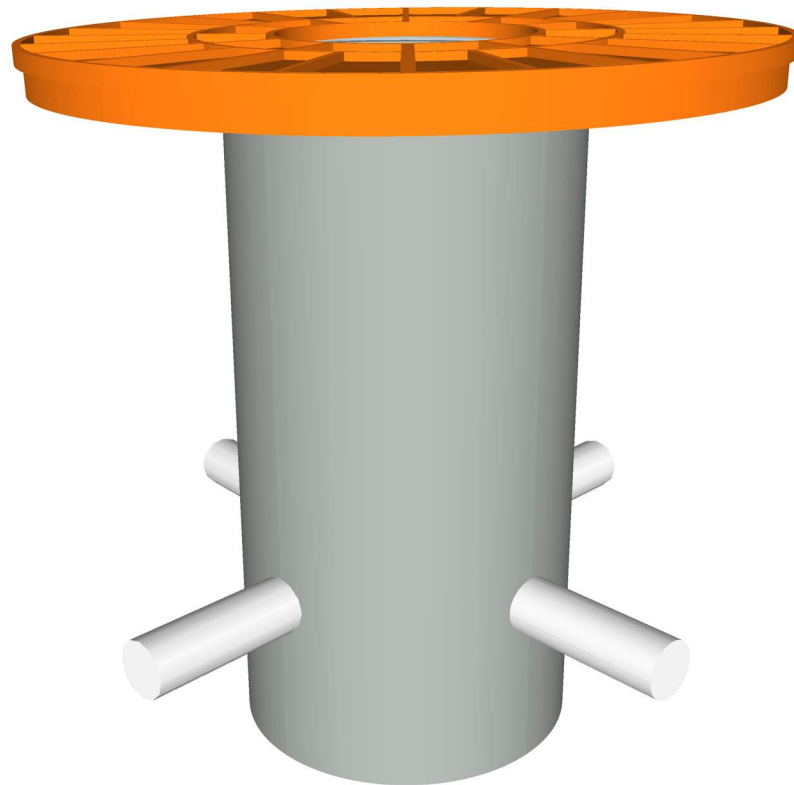

STEP 4 - Flip the base can over so that the bottom side of the Quik-Can is on the ground with the bottom of the L-867B base can facing upwards.

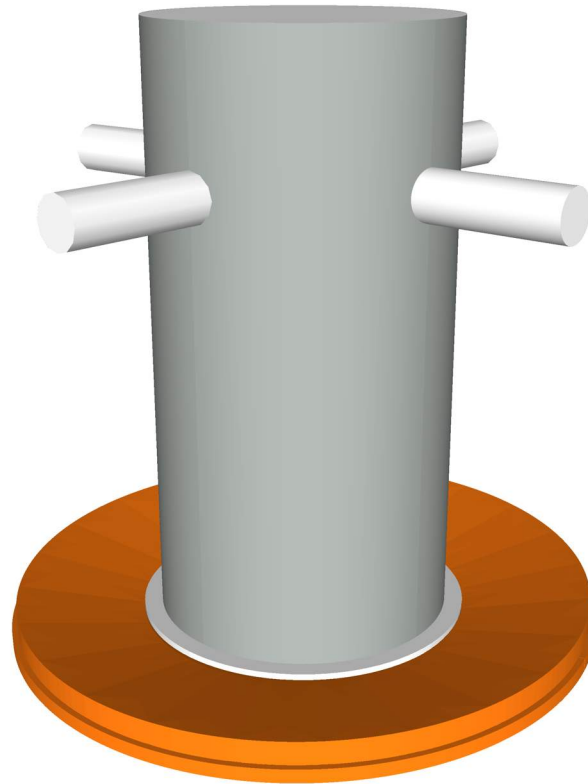

STEP 5 - Install 24" inside diameter form tube down onto Quik-Can.

STEP 6 - Ensure conduits are installed tightly to the outside of form tube.

STEP 7 - Push the external ground wire through the side of the form tube allowing for future attachment of external ground as required per contract specifications.

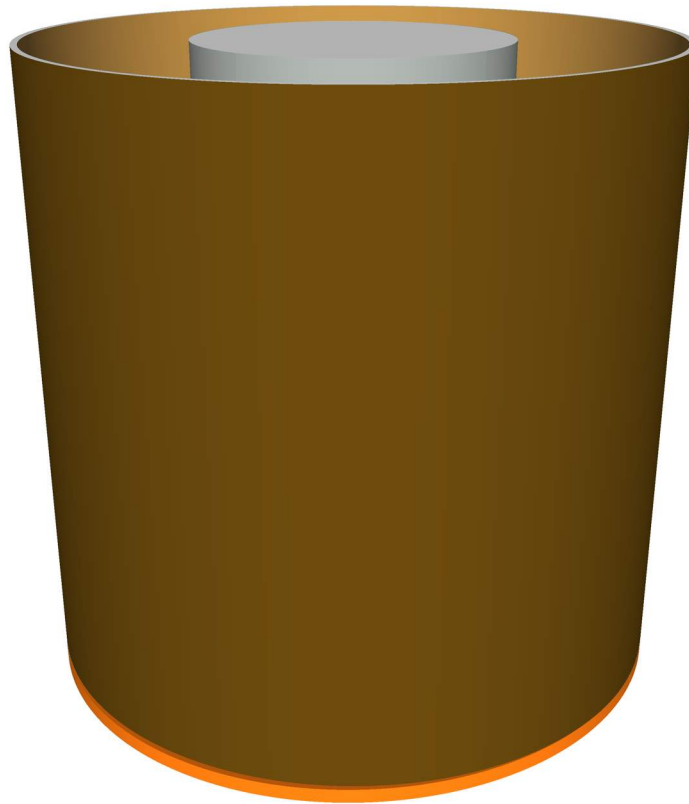

STEP 8 - Slowly pour concrete inside form tube and use concrete vibrator to evenly distribute concrete. Do not touch vibrator to plastic.

STEP 9 - Strike concrete level at top of form tube.

STEP 10 - Let concrete cure

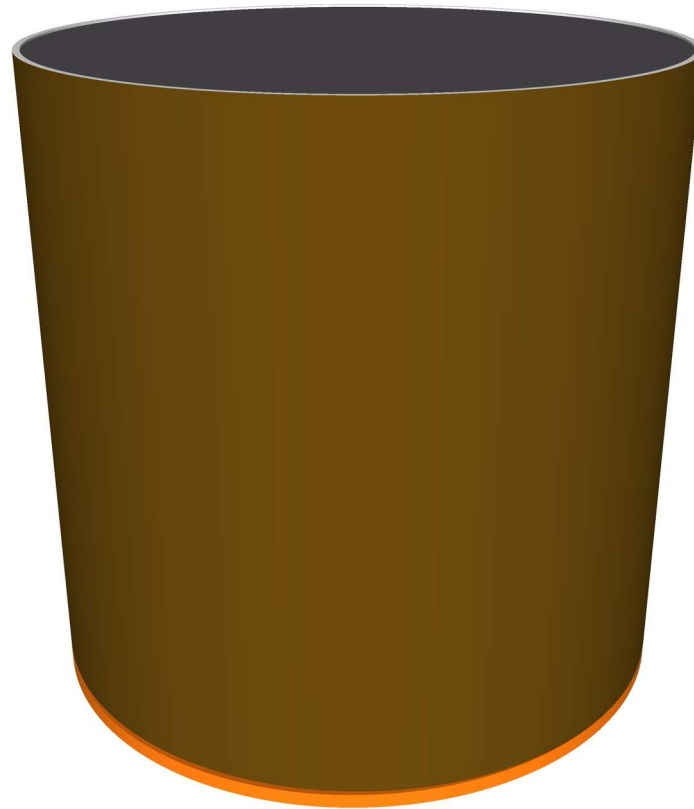

STEP 11 - Flip form upright so concrete base is on the ground and Quik-Can is on top.

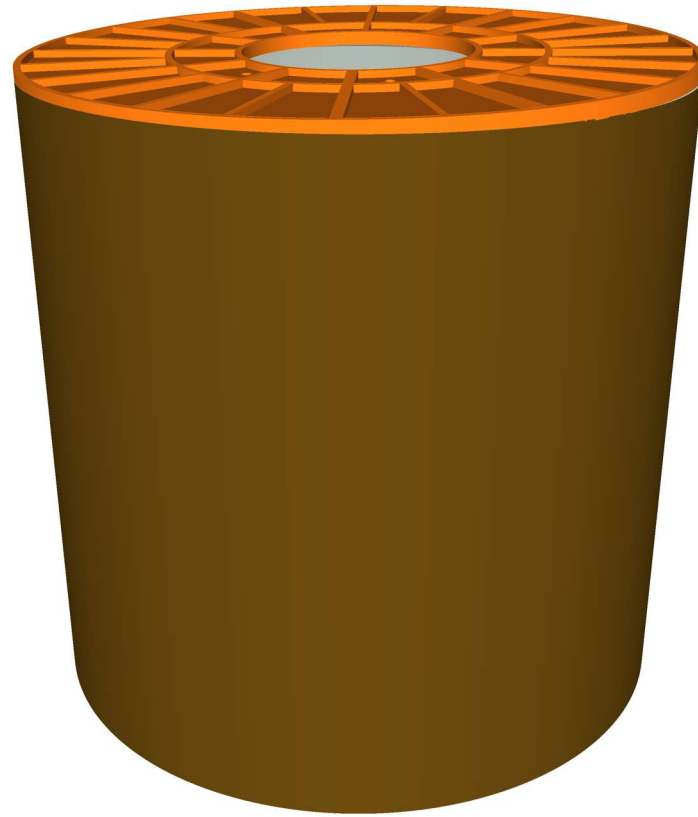

STEP 12 - Unbolt and remove Quik-Can from concrete base.

STEP 13 - Remove form tube from concrete base.

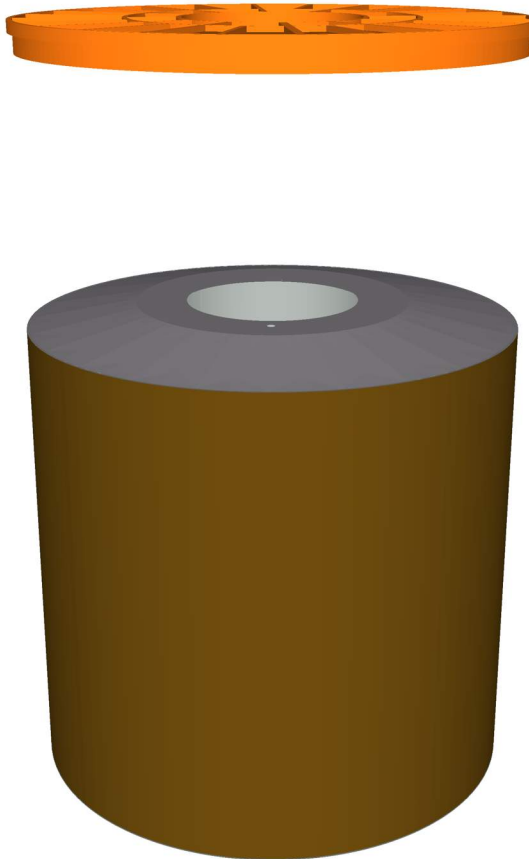



STEP 14 - Install precasted airport base in final location per contract specifications

