

MyFlyability

my.flyability.com is your support platform. You will find there the latest news, updates and the latest version of the user manual.

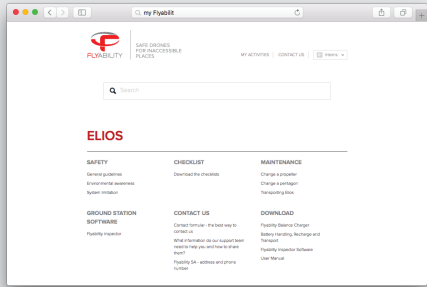

Missing your invitation?

support@flyability.com

0. Safety



Before performing any operation with the Elios system, read carefully the user manual.

Fly responsibly, protect yourself and people around you.



wear eye protection



wear head protection



keep protective gloves in vicinity

1. System description

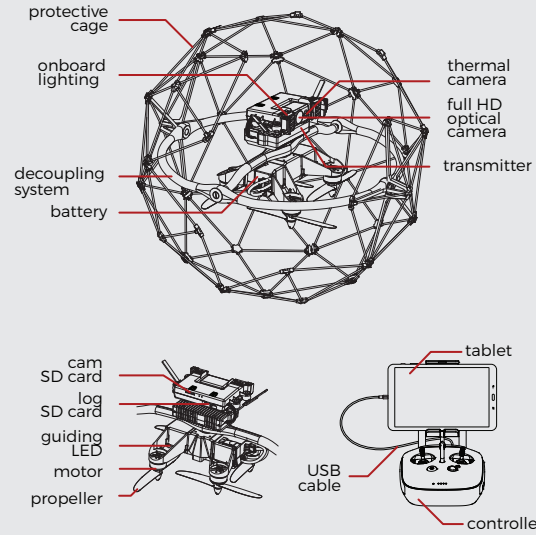

2. Charge your batteries



Shipped batteries are not full charged

Elios battery

10 min flight (may vary)
1.5h charge



GCS RC

3h of charge
5h of use



GCS Tablet

4h of charge
13h of use

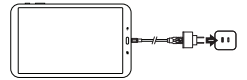

3. GCS set-up

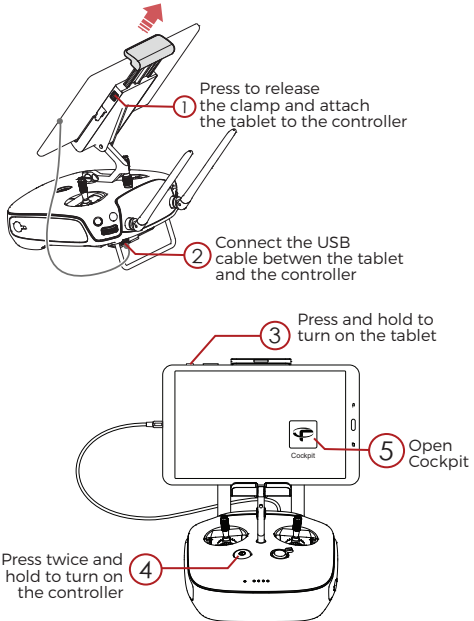

4. Battery set-up

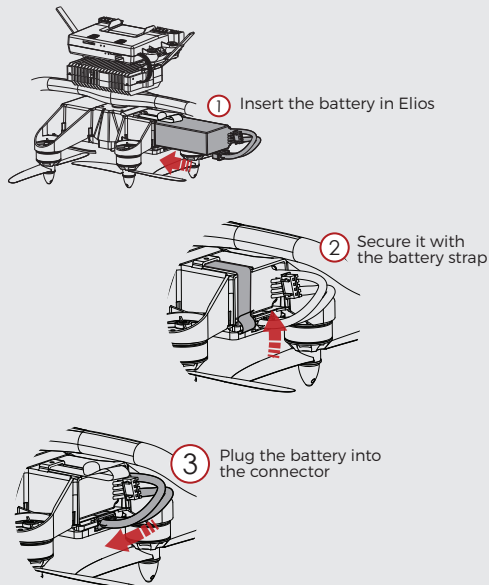

5. Control of Elios

Arming sequence
Perform quickly

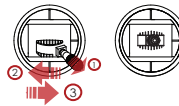

Disarming sequence

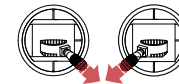

left stick



altitude

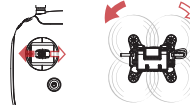

heading

right stick

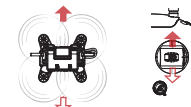

forward/backward

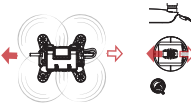

left/right

6. Payload control

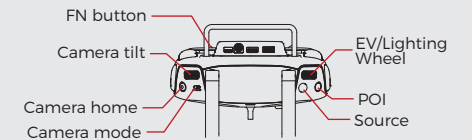

Camera mode

A = auto | C1 = Man low ISO | C2 = Man high ISO

EV/Lighting wheel

In camera mode C1 and C2, set exp. time
In camera mode A, set EV

EV/Lighting wheel + FN Button

Set LED intensity

Camera tilt

Wheel ↑, camera tilt ↑
Wheel ↓, camera tilt ↓

Camera home

Reset the camera's tilt

POI

Save point of interest

Source

Switch between Optical an Thermal streaming

Change a propeller

Required*:
- 8mm hex 1.4Nm torque controlled wrench

R marked propellers goes with R marked motor arms

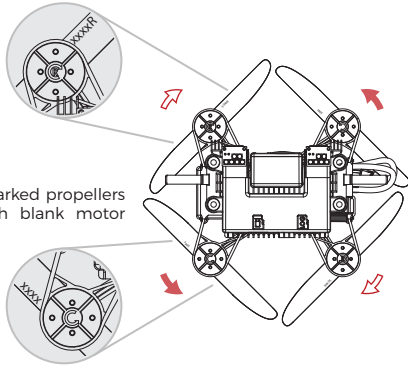

non R marked propellers goes with blank motor arms

The propeller marking and the motor's arm marking should be visible at the same time

* use only tools provided by Flyability

Clean your Elios



Compressed air can be used. Pay a special attention to the motors when cleaning. Dust or other particles may damage the motors if stuck inside.



Isopropanol alcohol (IPA) can be applied on a dry cloth to clean the protective cage. Clean on regular basis LEDs' surfaces with IPA as it may reduce lighting capability.



Avoid the use of water. It may damage the electronic.

Store your Elios



Keep Elios and its accessories away from sun light. If possible, always store them in the transportation case.



Keep Elios and its accessories away from water or humidity.

23°C

Store Elios and its accessories at room temperature. Better results for 23°C.



If not used for 3 days, store the batteries at 40%-60% of charge.

Quick Start Guide What's in the Box

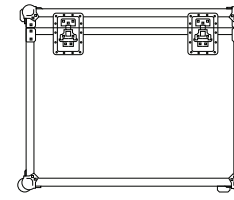

1x transport case

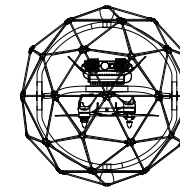

1x Elios



1x GCS RC



1x GCS Tablet

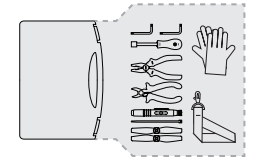

1x Toolbox



2x Battery safe bag



6x Pentagon



5x Battery



1x Battery charger



1x RC charger



1x USB charger



1x Battery Cell Checker



1x USB cable



3x Power cord



1x Manuals
- Quick start guide
- Original instruction
- Battery Safety Guidelines



1x Transport strap



1x Micro SD card reader



2x Micro SD card



1x Return folder

Options



1x Camera Operator GCS



1x Range Extender with GCS

Change a Pentagon

Required*:
- Cutting plier
- Gripping plier
- 2.5mm zip ties x5

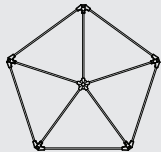

1. Cut the surrounding zip ties with the cutting plier and remove the damaged pentagon.

2. Place the new pentagon and attach it with new zip ties. Be careful to place the zip ties' ratchet on the inner side of the cage. As shown on the right.

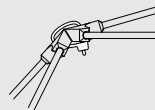

3. Using the gripping plier tighten the zip ties.

4. Using the cutting plier, trim the zip ties' tape.

Change a Suspension

Required*:
- Suspension
- M3x16 screw with threadlock
- Bearing x2
- Bearing spacer
- T10 hex key
- Cutting plier
- Gripping plier

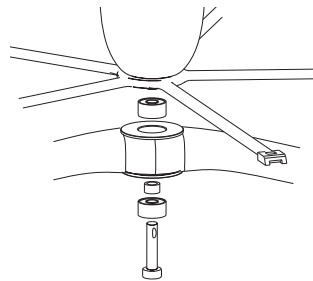

1. Cut the surrounding zip ties using the cutting plier.

2. Remove the screw using the T10 hex key. Be careful to not lose any parts.

3. Install the bearings separated by the bearing spacer into the insert situated on the ring's curved part.

4. Insert the M3 screw from the ring interior and tighten the suspension to the ring using a T10 screw-driver. Apply a torque by hand until there is no more play with the cage.

5. Attach the suspension with zip ties as shown on the right.

6. Tighten the zip ties and trim the zip ties' tape.

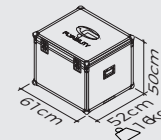
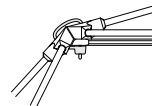

Transport your Elios system

Required*:
- Transport strap

1. Make sure no battery is inside the aircraft

2. Close the battery strap

3. Pass the transportation strap through the battery strap, the ring and a pentagon as shown.

Don't tighten the strap too much

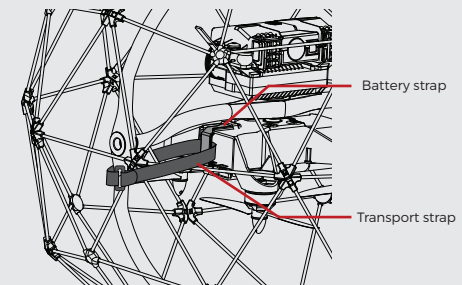

If you are traveling with your Elios by plane, have your Elios and its accessories placed in checked bags. Always keep the batteries as carry-on.



No batteries in checked bags.

Remove the Battery Caution label from the transport case



Have the batteries discharge below 30%



If you intend to ship your Elios, remove the batteries from the package and follow the instruction from the Return Folder



No batteries in shipping package

Remove the Battery Caution label from the transport case.



Have the GCS RC and GCS tablet batteries discharged below 30%